

0+00 = Pt. 31 feet N20
From NW Cor of Bridge

9

Survey Map
of

Proposed Whisky Ck. Chrom
Josephine County, Oregon

ANNES ENGINEERING C
CONSULTING MINING & GEOLOGICAL E
SURVEYORS ASSAYERS

GRANTS PASS, OREGON



SURVEYED	DATE
E. C. Annes Jr.	July
DRAWN	SCALE 1 inch
	Flow ref.

6

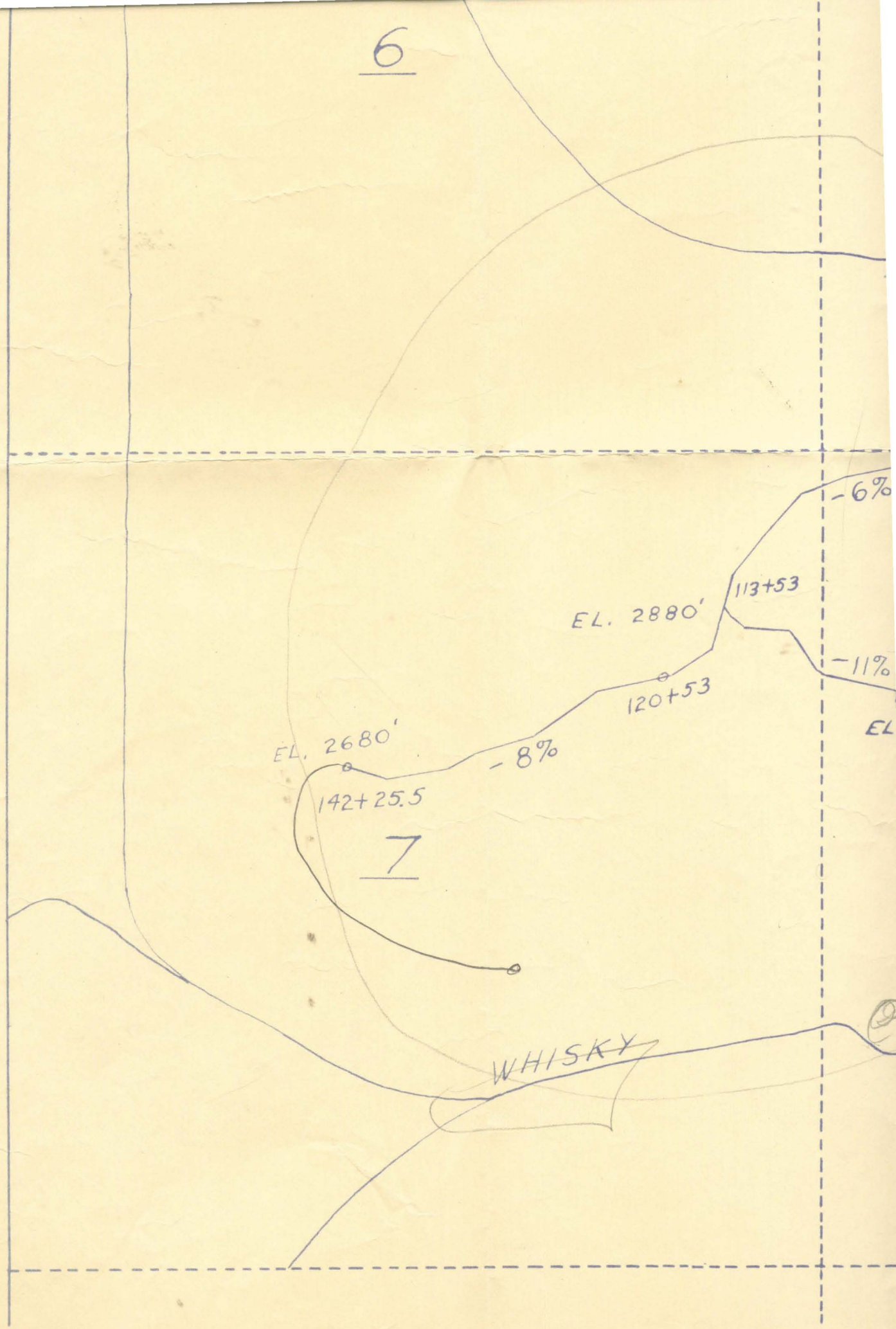

EL. 2680'

142+25.5

-8%

120+53

EL. 2880'

113+53

-11%

-6%

EL

7

WHISKY

9

5

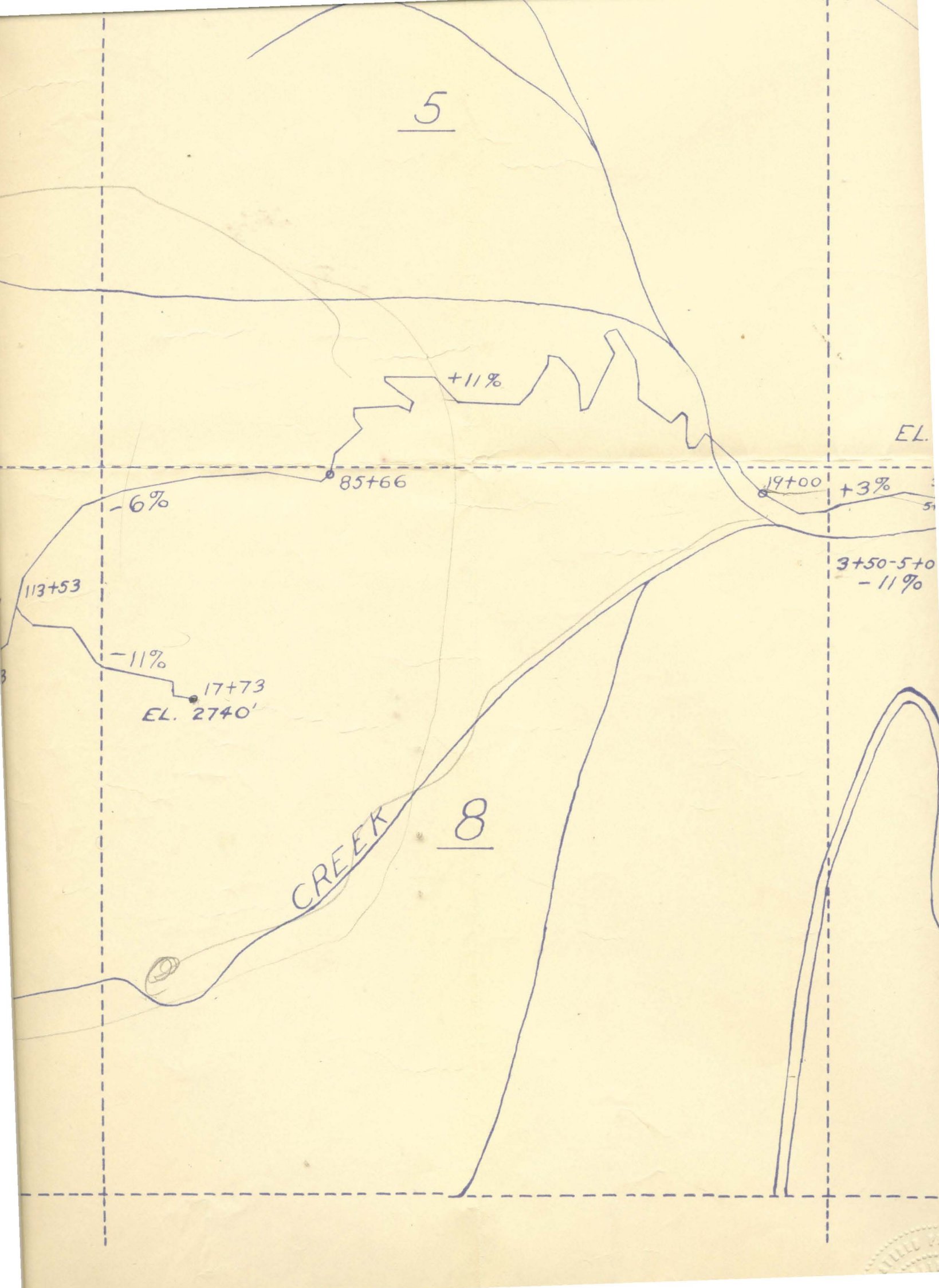

+11%

EL.

-6%

85+66

19+00

+3%

113+53

3+50-5+0
-11%

-11%

17+73

EL. 2740'

CREEK

8