

Brunton-Pace Survey
1" = 100'

Digmore Mercury
Lake Co.

June 9, 1958

MS

35 shows a attitude of bedding in tufts and "banding" in altered rock.

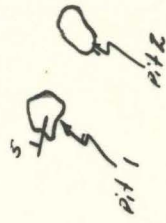
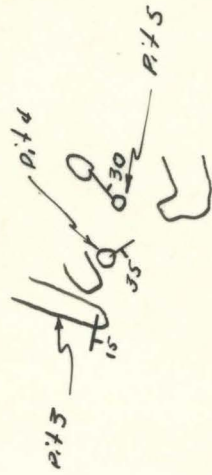

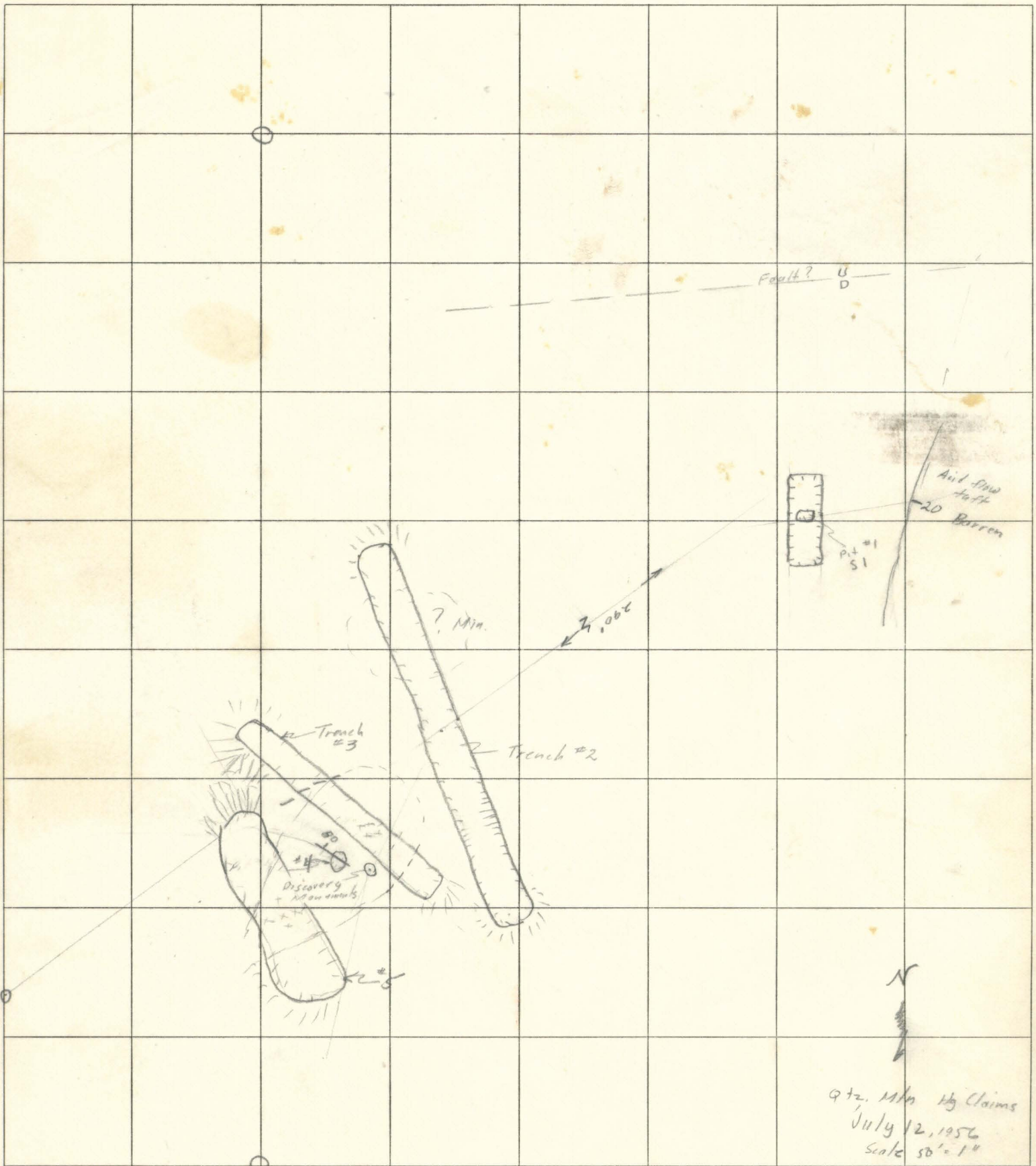

qtz. Mtn. Hy Claims
July 12, 1956
Scale 50' = 1"
Branton & Bee
MS
Sheet 1

Trench
#7
150'

Trench 100'
W of #7



Q-60

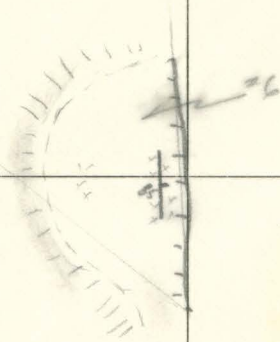

Sheet 2
Q+2 Mtn, Hg