

Lower outline of cut
15'-20' (ave. cut)

25' face

Massive clayey tuff

Silicified Tuff

Dip
WK Tuff

Outline of Lower Cut
White King

Oct. 31 - 53
1" = 10'

Brunton & Tape



2' shear etc buff tuff
Acid water
65 Buff tuff & soil

Line of section (subm. for Ore-Bin Article)

Partially altered, opalized white, clayey tuff

DDM #2 70' (cont'd to 49')

Altered clayey tuff
Apple-green U min. in trenches

Clayey tuff
24" Pine

Yellow U min. in main pit

fracture of zone

banded opalized tuff
AgS in corner
MS

Opalized tuff

White King #4

Scale 20' = 1"

5/2/218
8/22/55



AgS
Apple-green U mineral

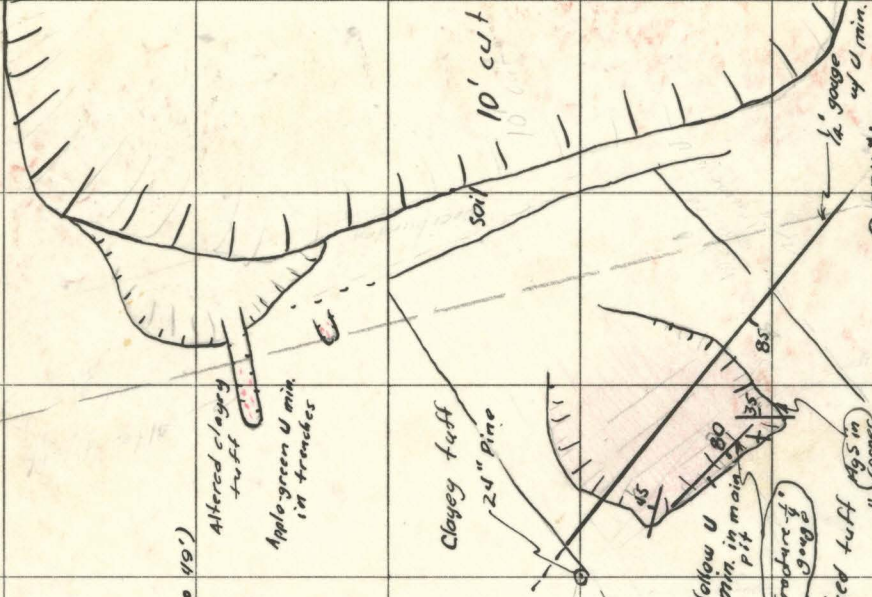
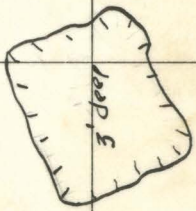
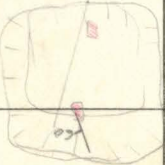

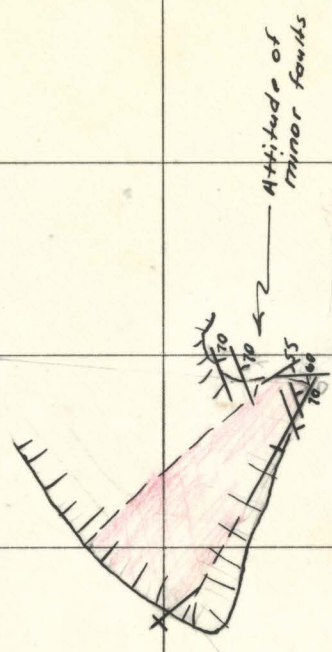
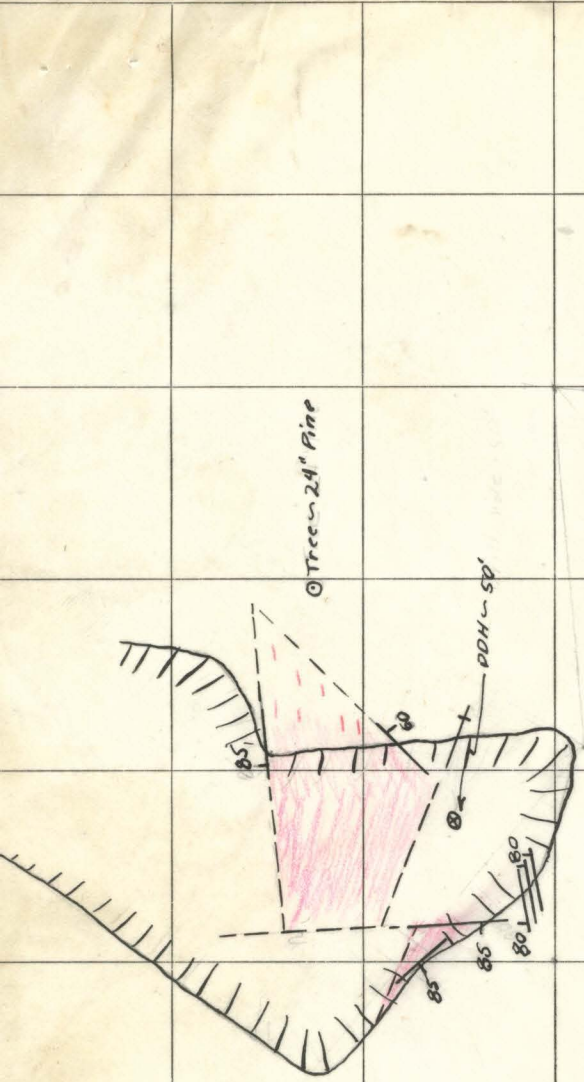

N

Lucky Lass Mine

Scale ~ 1" = 20'
8/23/55 - JMB

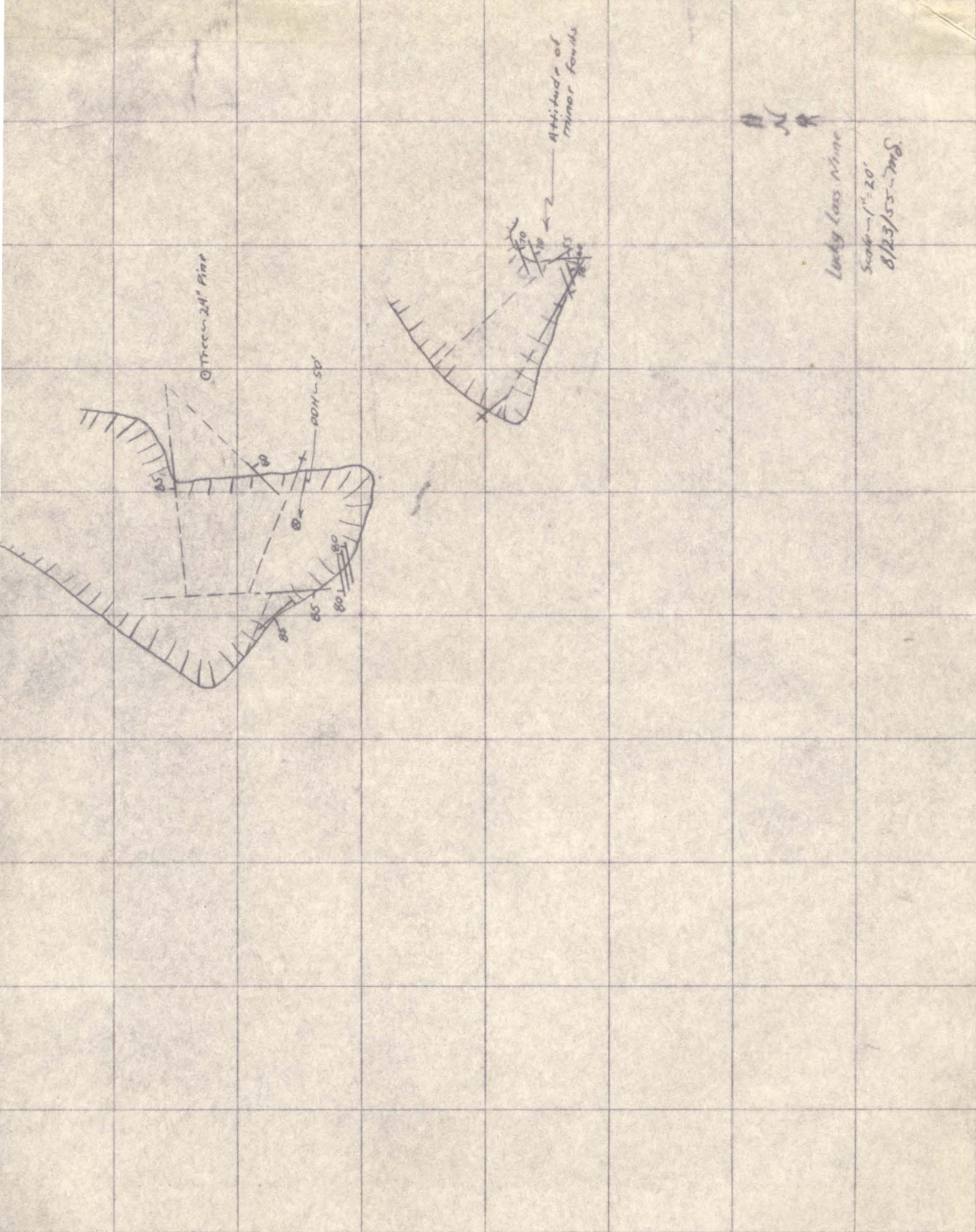

Green-24' Flint

145-1400'

Attitude of minor faults



Ledyard Mine

Dec-25/1878
S. J. 1-1-1905

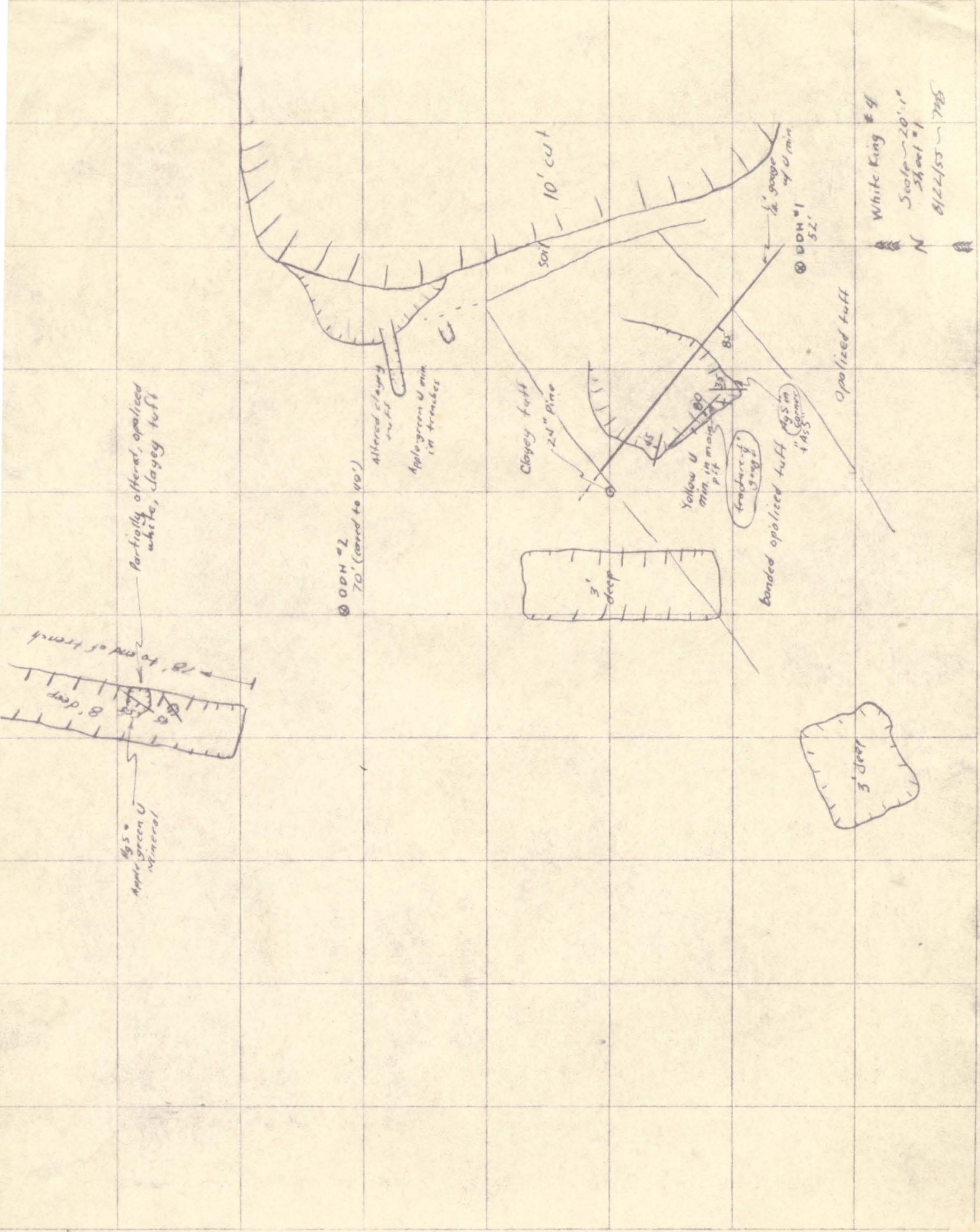

Partially altered, opalized white, clayey tuft

BDN #2 70' (card to 40')

Altered clayey tuft
Apple green U min in trenches

Clayey tuft
24" Pine

Yellow U min in main pit

fracture of ground

bonded opalized tuft
45 in
145 in

Opalized tuft

White King #4
Scale ~ 20' r
Sheet #1
8/22/55 ~ 7065



Apple green U mineral

Cross-section along
Warner Valley Road
Hwy 395 to Adel
2.5 miles
(approx)

Horiz scale - 5000' = 1"
Vert. " - 500' = 1"
Section - N75W-S25E
Elev. - Aneroid
Barometer

- Alluv.
- Gray fg x'l tuft
- Unconsol tuft + soil
- Consol litk tuft
- Platy pinkish lithic tuft
- Varicolored tufts + sands
- Sands

5.5 miles ←

2.5 miles ←

6.7 miles ←

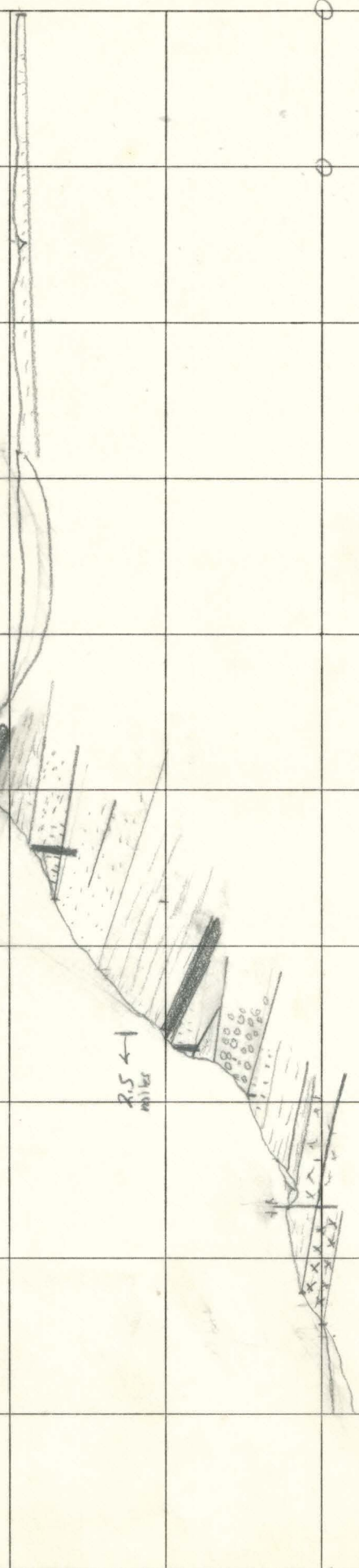

2

Main Argonne Rd road.

Scale 3" = 1 mile

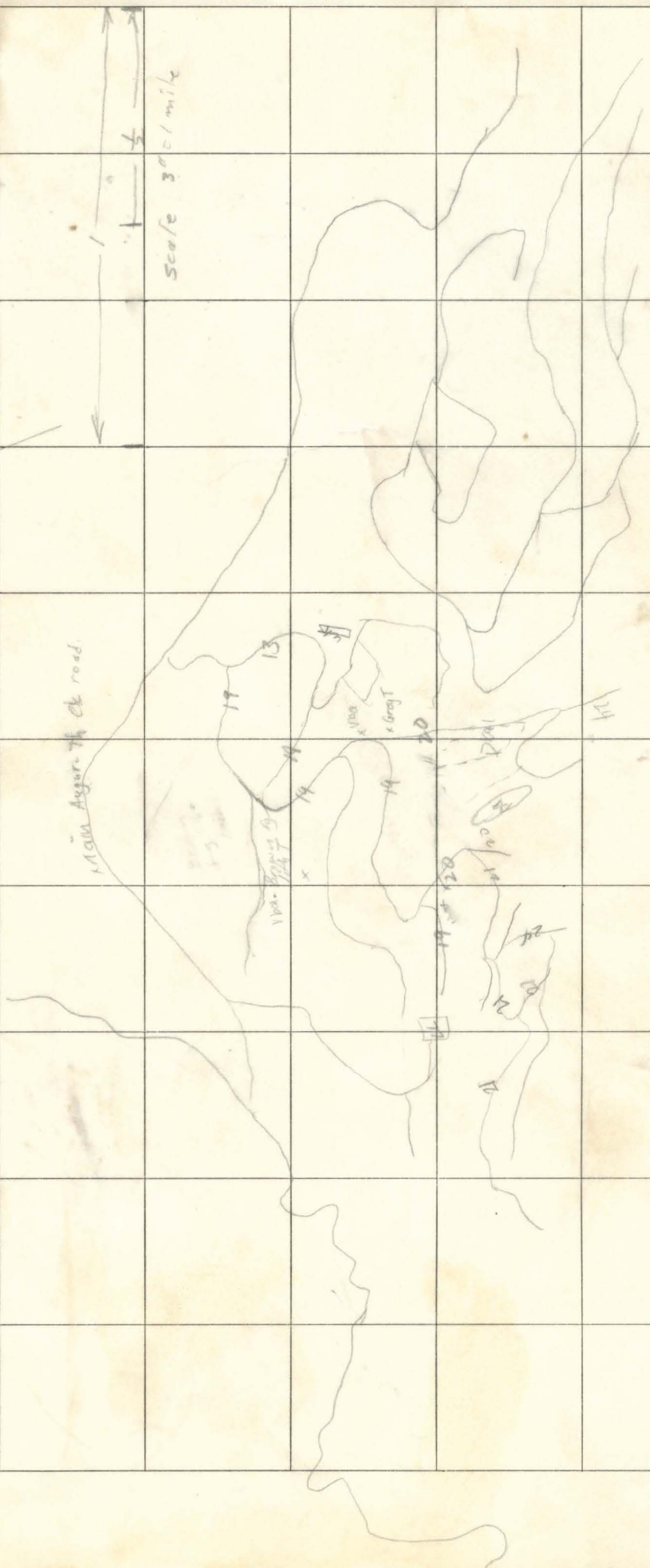

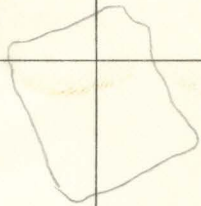
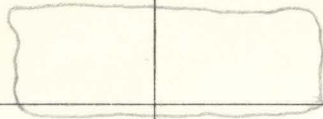
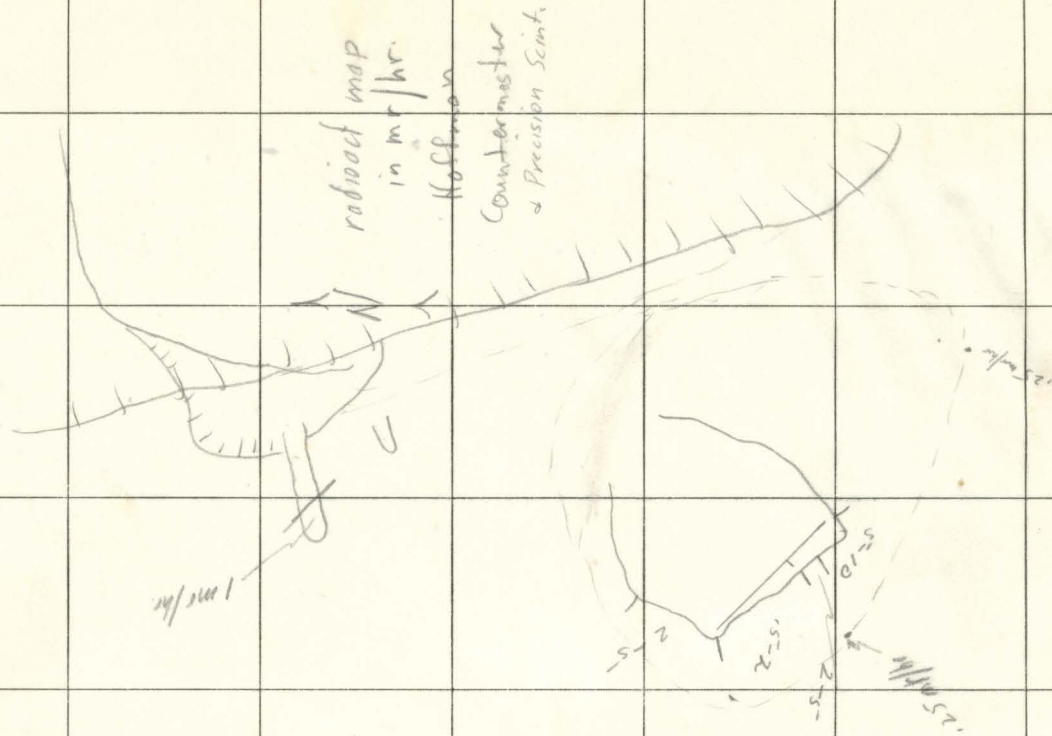

Sheet 2 white king

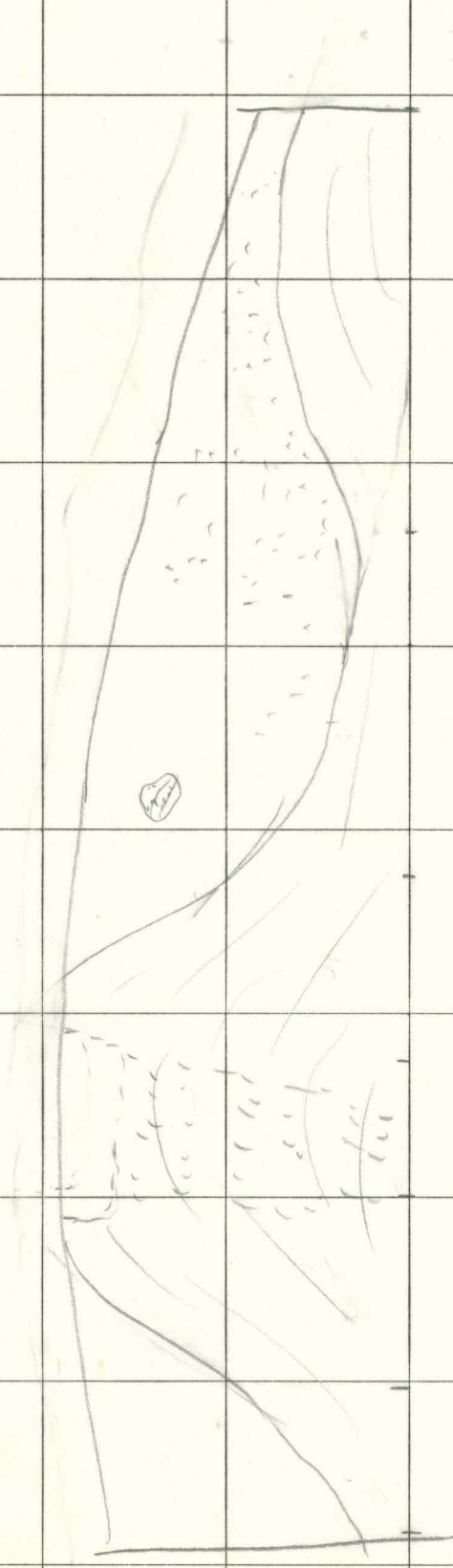

Sketch of Section at Working Face - White King Mine, Lake Co. Oregon

1" = 10'

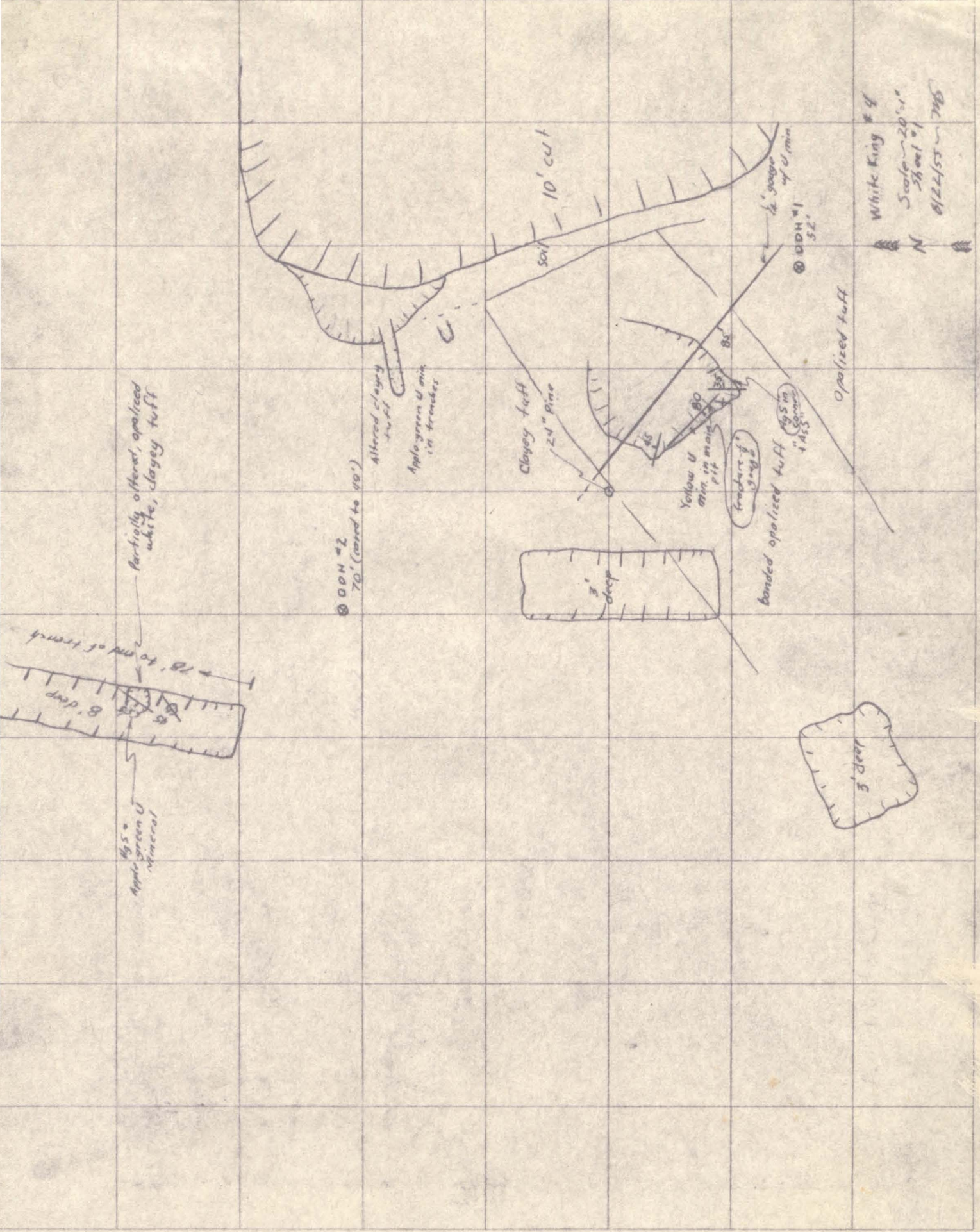

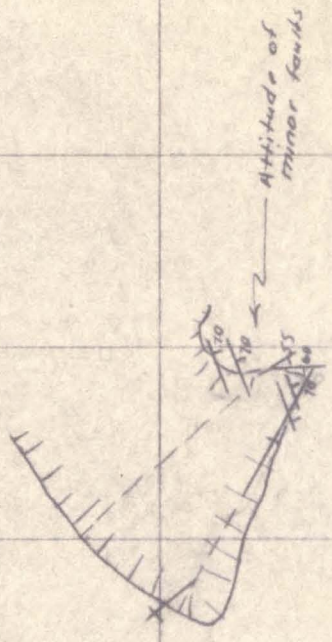

111

July 1955

Scale 1" = 20'
8/23/55 - ms