



Defiance

Outcrop Defiance Vein
223
o 7477' EL.

Air Raise

020765

Winze

5/5/65 #

SCALE: 1" = 100'

SKETCH MAP
PALMBAH RESEARCH CORPORATION
TRICK 1000 DRIFT
3/17/65 by H. Barton
Rev. 5/5/65

(1000, 600, and OME 1000
levels and outcrops from
traverse survey by Leslie
C. Richards; 600 winze-
drift approximated from
I.C. 7417, D.I.B.L.; FRC
1-1000 drift from Brunton
traverse.)

Butte

Cor. No. 1
JUNE

600 Drift

California vein

(Sheet 2)

FRC Drift
M-1000 (Sheet 1)

TS Portal Outcrop

200 Drift 650' EL.

YuKon Vein

450' EL.

76°

76°

69°

62°

OME Tunnel
18' EL.

76°

FEDERAL RESOURCES CORPORATION
MUSICK 1000 Drift - I

(From Brunton Sketch Map)
June, 1965: H. Barton

(au-ag-Pb, Zn, Cu)

1" = 40 feet

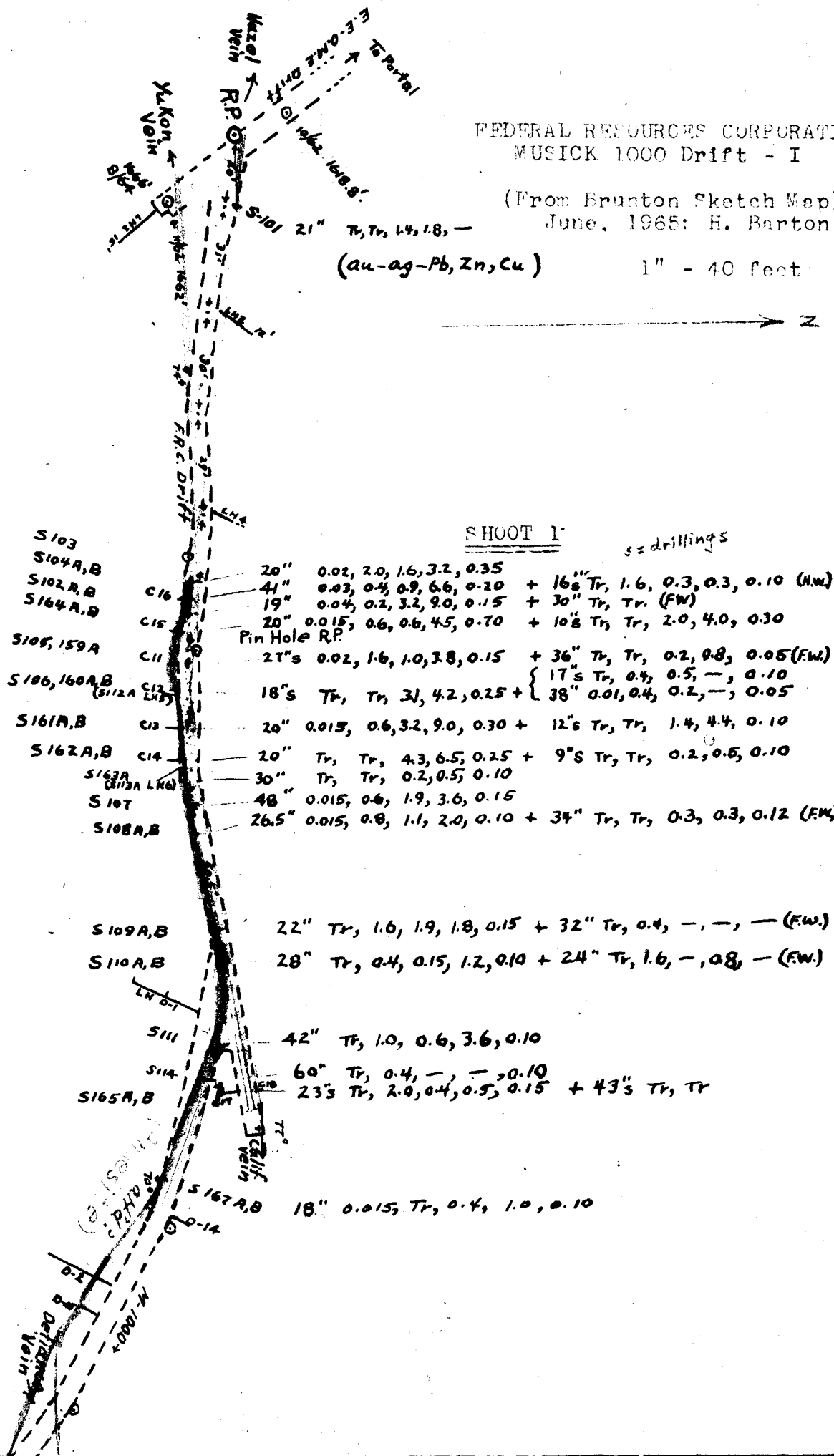

FEDERAL RESOURCES CORPORATION
 MUSICK 1000 Drift - II

(From Brunton Sketch)
 June, 1965: H. Barton

1" - 40 feet

(Au-Ag-Pb,Zn,Cu)

16" 0.03, 0.4, 1.6, 3.8, 0.20
 12" Tr, Tr, —, 0.8, —
 30" Tr, Tr

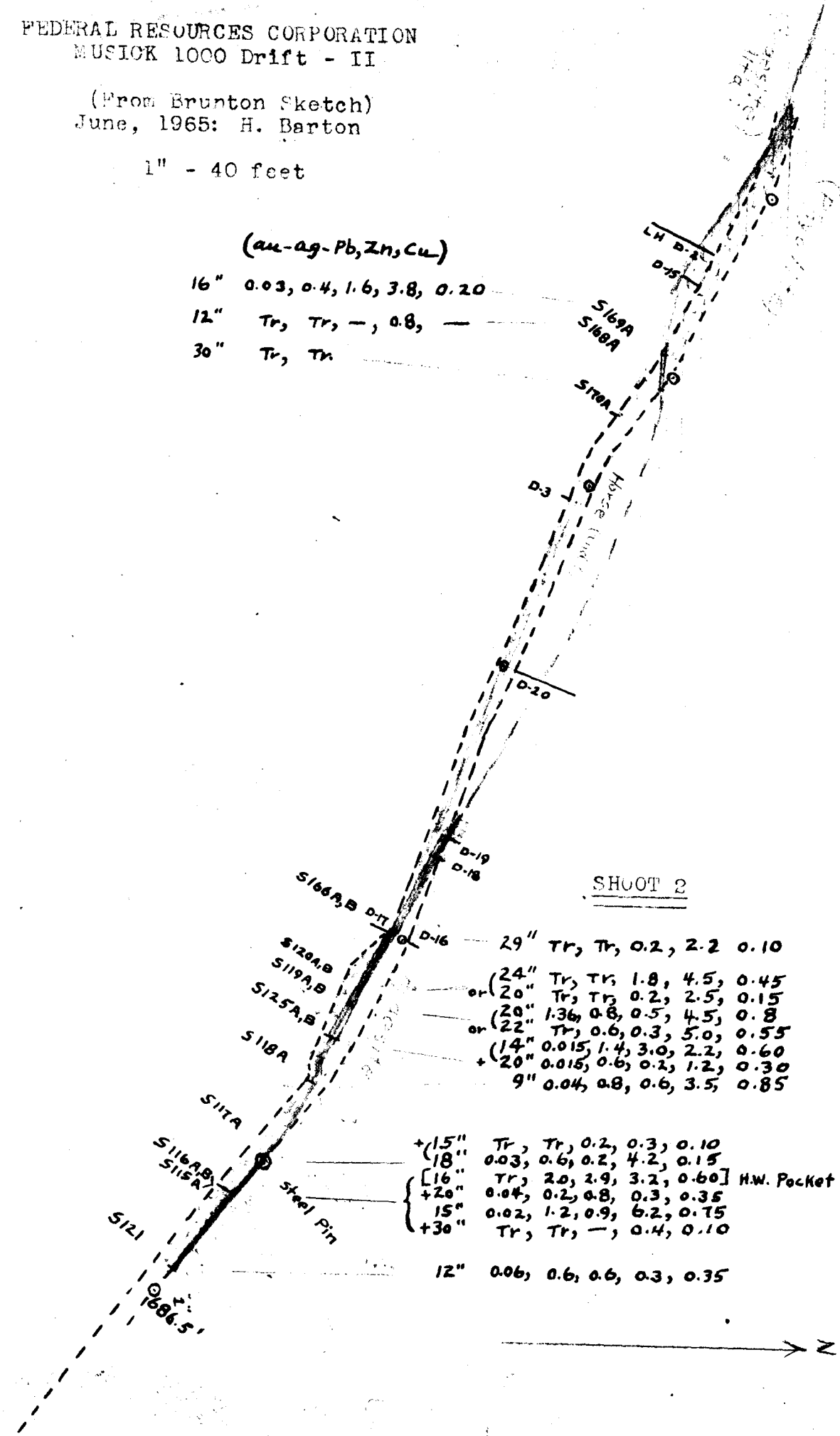

SHOOT 2

29" Tr, Tr, 0.2, 2.2 0.10
 or 24" Tr, Tr, 1.8, 4.5, 0.45
 or 20" Tr, Tr, 0.2, 2.5, 0.15
 or 22" 1.36, 0.8, 0.5, 4.5, 0.8
 or 22" Tr, 0.6, 0.3, 5.0, 0.55
 + 14" 0.015, 1.4, 3.0, 2.2, 0.60
 + 20" 0.015, 0.6, 0.2, 1.2, 0.30
 9" 0.04, 0.8, 0.6, 3.5, 0.85

+ 15" Tr, Tr, 0.2, 0.3, 0.10
 18" 0.03, 0.6, 0.2, 4.2, 0.15
 [16" Tr, 2.0, 2.9, 3.2, 0.60] H.W. Pocket
 + 20" 0.04, 0.2, 0.8, 0.3, 0.35
 15" 0.02, 1.2, 0.9, 6.2, 0.75
 + 30" Tr, Tr, —, 0.4, 0.10

12" 0.06, 0.6, 0.6, 0.3, 0.35

1686.5

Au-Ag-Pb-Zn-Cu

123	27"	Tr, 0.4, 1.1, 2.0, 0.20
150	27"	0.03, Tr, 2.2, 3.2, 0.33
122	+12"	Tr, 0.4, 1.0, 4.2, 0.50
	+12"	Tr, 0.4, 0.3, —, 0.10
146	15"	0.01, 0.8, 0.5, 2.5, 0.30
145	30"	0.02, 6.2, 3.5, 5.0, 0.40
147	13"	Tr, 4.0, 7.1, 14.2, 1.0
148	18"	0.015, 2.0, 2.1, 9.0, 0.38
149	21"	0.015, 2.6, 3.6, 9.8, 0.50
128	36"	0.03, 2.0, 2.2, 5.5, 0.70
142	30"	0.01, 2.4, 1.5, 10.8, 0.45
130	15"	Tr, 0.4, 0.3, 4.8, 0.45
	+24"	Tr, Tr, 0.2, 0.2, —
155	40"	Tr, 0.6, 0.3, 2.0, 0.25
156	25"	Tr, Tr, 1.3, 3.0, 0.30
	+23"	Tr, Tr
157	25"	0.01, 1.0, 0.5, —, 0.10
	+23"	0.01, 1.6
126	+20"	0.015, 0.6, 0.2, 4.2, 0.55
	20"	0.06, 1.0, 1.2, 6.0, 0.70
129	24"	Tr, 0.6, 0.3, 9.0, 0.80
	+36"	Tr, 0.4, 0.2, 2.0, 0.25

SHOOT #3

134	28"	Tr, 0.4, 0.3, 2.7, 0.10
	+26"	Tr, Tr, —, 3.2, 0.35
141	26"	0.015, 2.0, 0.2, 6.0, 0.75
	+30"	Tr, 2.0, 0.2, 4.8, 0.25
135	15"	Tr, 1.6, 2.0, 8.2, 0.60
	+30"	0.2, 2.0, 1.4, 6.2, 0.75
[136	24"	Tr, Tr, 0.3, 0.5, 0.2] F.W.
152	[21"	Tr, 0.6] F.W.
	+24"	Tr, 0.4, 1.5, 3.6, 0.30
	+24"	0.04, 1.6, 1.6, 5.7, 0.50
153	11"	Tr, 2.0, 0.5, —, 0.10 F.W.
	+22"	0.04, 1.2, 0.7, 9.0, 0.55
	+22"	Tr, Tr, 0.2, 1.0, 0.10
137	12"	0.02, 6.0, 14.4, 7.2, 1.2
	+24"	Tr, Tr
	+24"	Tr, Tr, —, 0.3, 0.40
154	37"	0.02, 0.6, 2.5, 4.2, 0.40
140	40"	0.80, 1.6, 1.4, 3.7, 0.35
	20"	0.04, 2.0, 1.7, 4.0, 0.35
138	13"	Tr, 2.4, 1.1, 3.0, 0.30
151	9"	0.04, 2.4, 1.1, 3.0, 0.30

SHOOT #4

FEDERAL RESOURCES CORPORATION
MUSICK 1000 Drift - III

(From Brunton Sketch)
June, 1965: H. Barton

1" - 40 feet

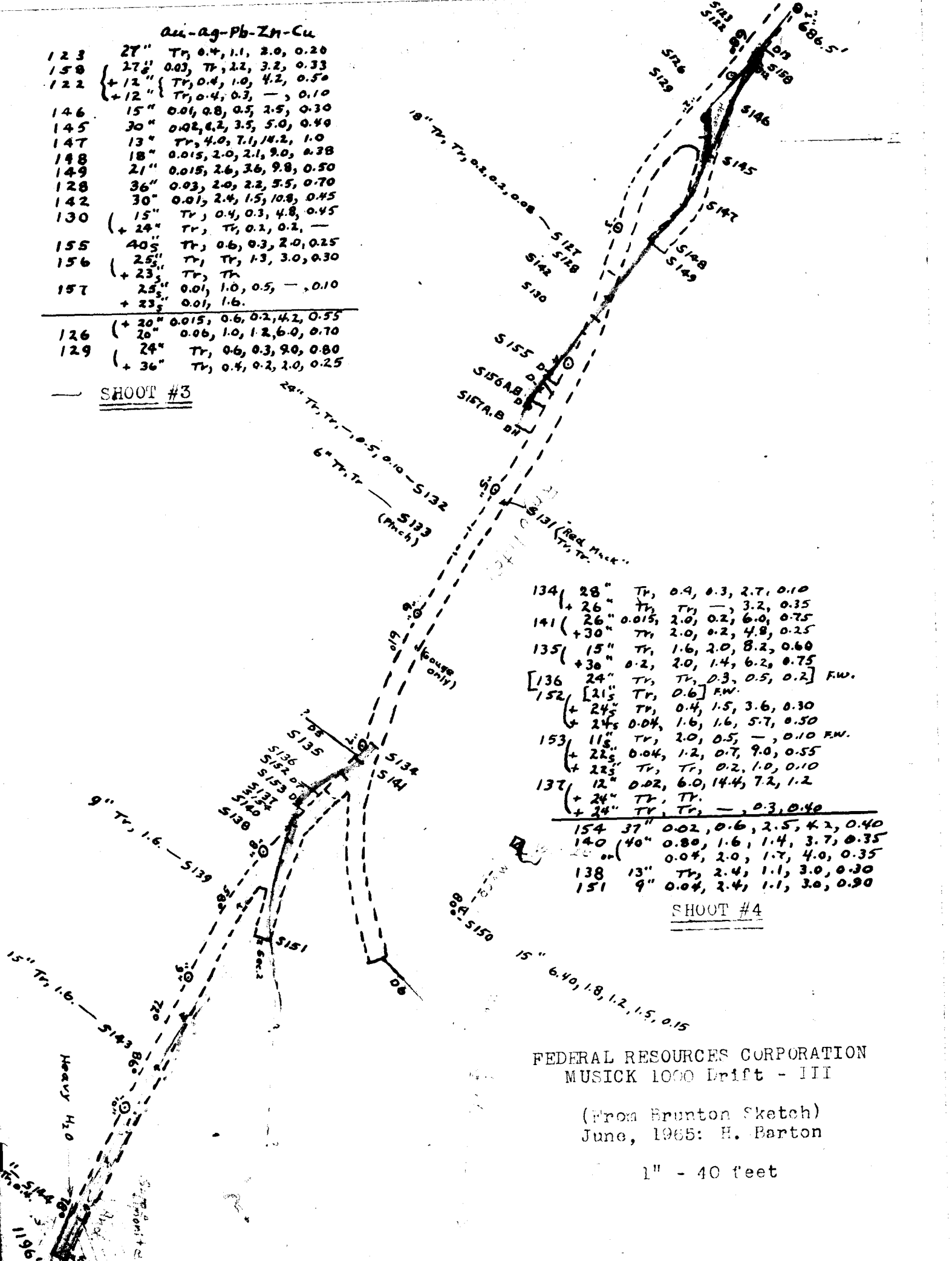

MUSICK 600 WINZE EAST

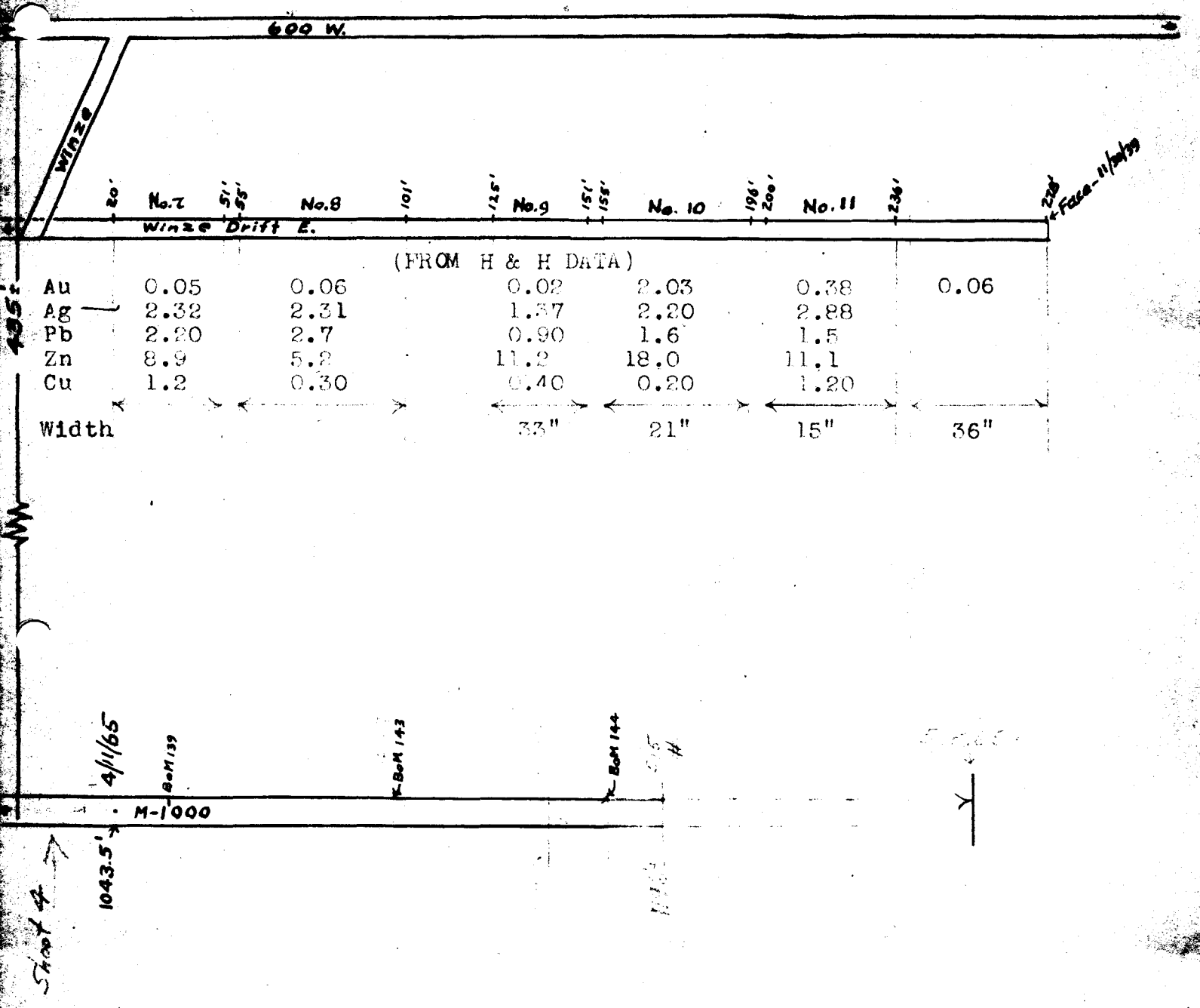

SKETCH
 for
 FEDERAL RESOURCES CORP.
 4/13/65 by H. Barton
 SCALE: 1" = 40'
 Revid 5/5

Stopped

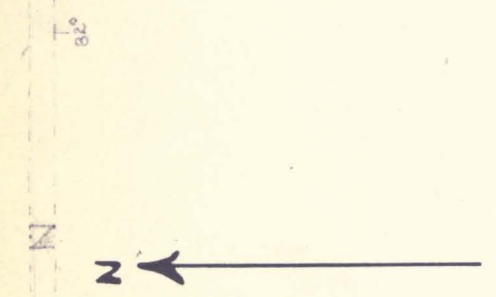

M 200
 E1 6493
 9/20/64
 1" = 40 ft. 8/64:hb

MUSICK 1000-level Drift
 BOHEMIA DISTRICT

M 600
 Elev 450'
 1°
 1450' (End O.N.B. Drift)
 Elev 174'
 14746'

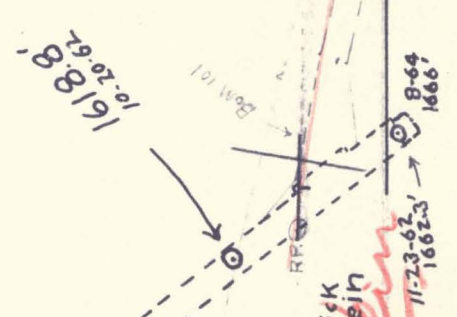
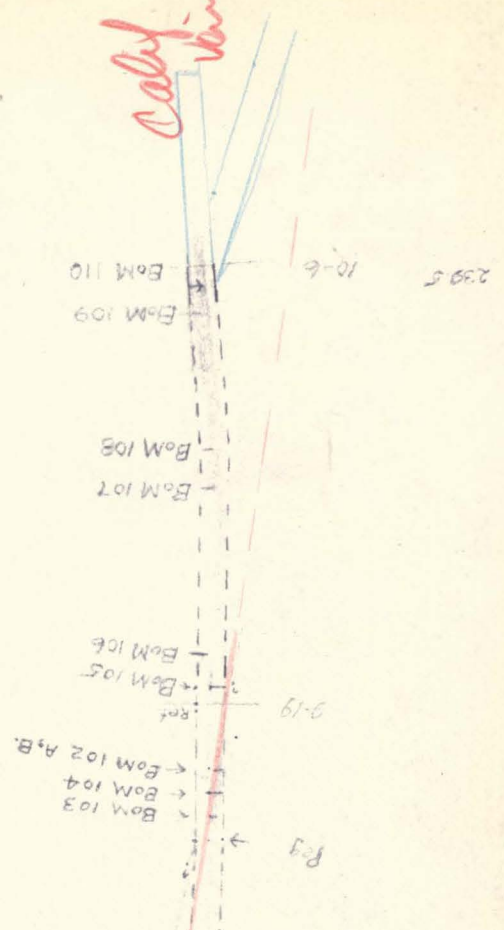

Yukon Vein
 Musick Vein
 11-23-62
 1662.5'

Calif. vein

