

# GOLD EAGLER GROUP

(Jumbo, Highland)

NW 1/4 Sec. 13  
 T. 19 S. - R. 3 E.  
 Lane County, Ore.  
 Waldo Lake Quadrangle

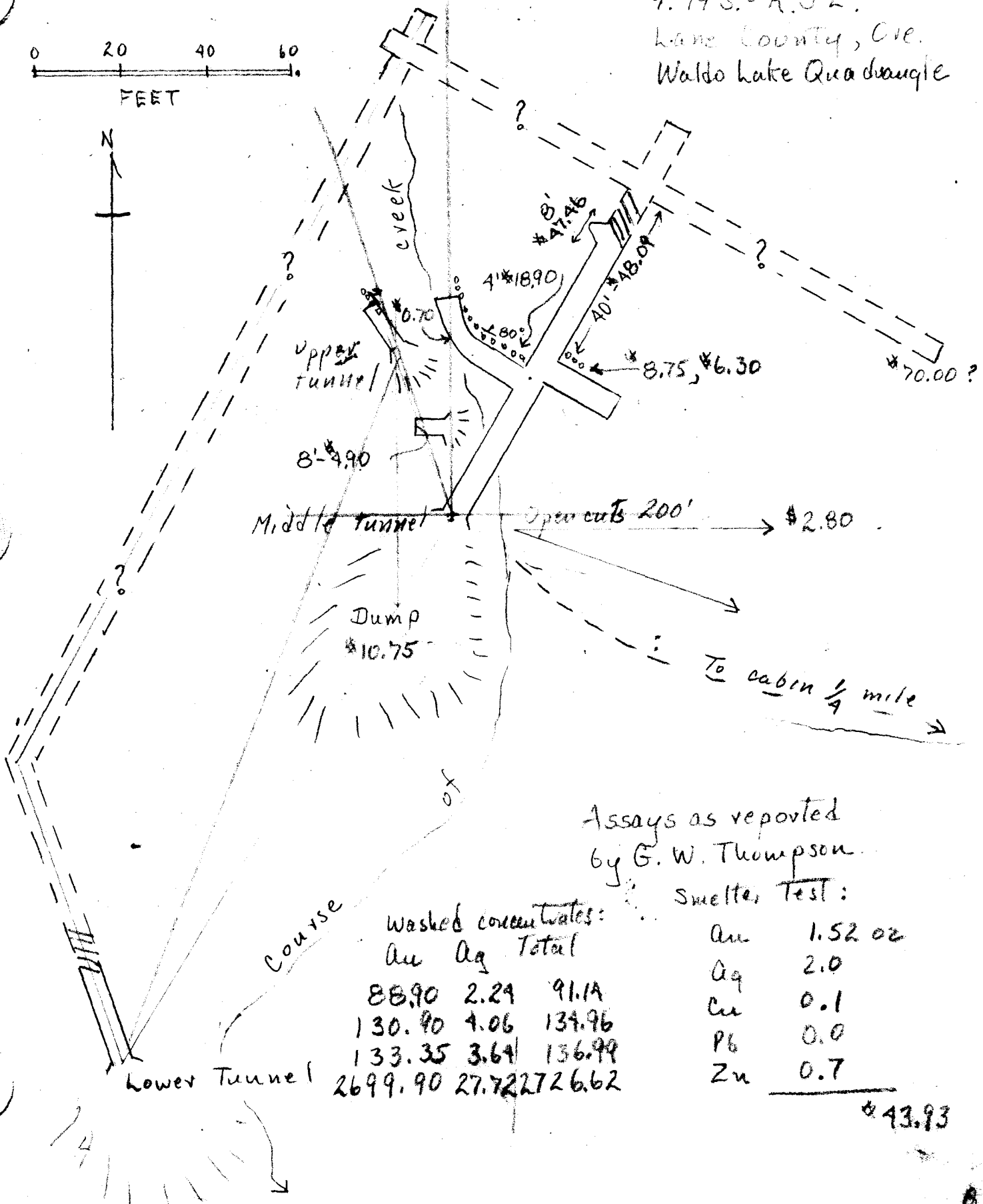

Assays as reported  
 by G. W. Thompson

Smelter Test:

Washed concentrates:

	Au	Ag	Total
88.90	2.24	91.14	
130.90	4.06	134.96	
133.35	3.64	136.99	
2699.90	27.72	2726.62	

Au	1.52 02
Ag	2.0
Cu	0.1
Pb	0.0
Zn	0.7

\$43.93

NORTH

GOLD EAG

No 2 and 5

HEAVY  
PIPE  
CONCENTRATE  
ASSAY  
156

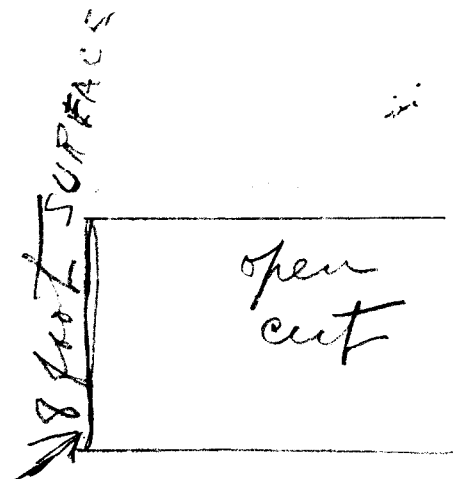
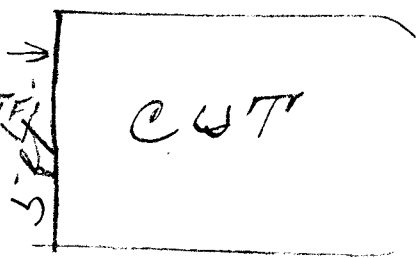

GENERAL SAMPLE  
40% SILICEOUS MATERIAL  
ASSAY # 48.09

ASSAY OF WASHED  
CONCENTRATE

GOLD-SILVER			
\$88.90	\$2.24	-	91
130.90	4.06		134
133.35	3.64		136

SMELTER TEST  
ORE VALUE \$43.

Gold	Silver	Copper	Lead
1.52	2.00	.1	none
			13% cent

IRON AND  
MONITE  
ASSAY \$4.90

GRAY QUARTZ  
ASSAY #47.46

70 ft

SILICEOUS  
ASSAY #

RIGHTSILICEOUS MATERIAL  
ASSAY #6.30

FASTERLY  
TUNNEL

10.46

SILICEOUS MATERIAL  
ASSAY #18.90

LIGHT SILICEOUS MATERIAL  
ASSAY #6.30

200 FT FASTERLY  
FROM TUNNEL  
SURFACE ASSAY

OPEN  
CUT

35 foot  
cross cut  
Country Rock  
ASSAY #7.0

30 ft.  
CROSS CUT

Rock  
WHITE QUARTZ AND KADOLIN  
ASSAY #8.75

TUNNEL

DUMP  
ALTERED VEIN  
MATERIAL  
ASSAY #10.78

SOUTH

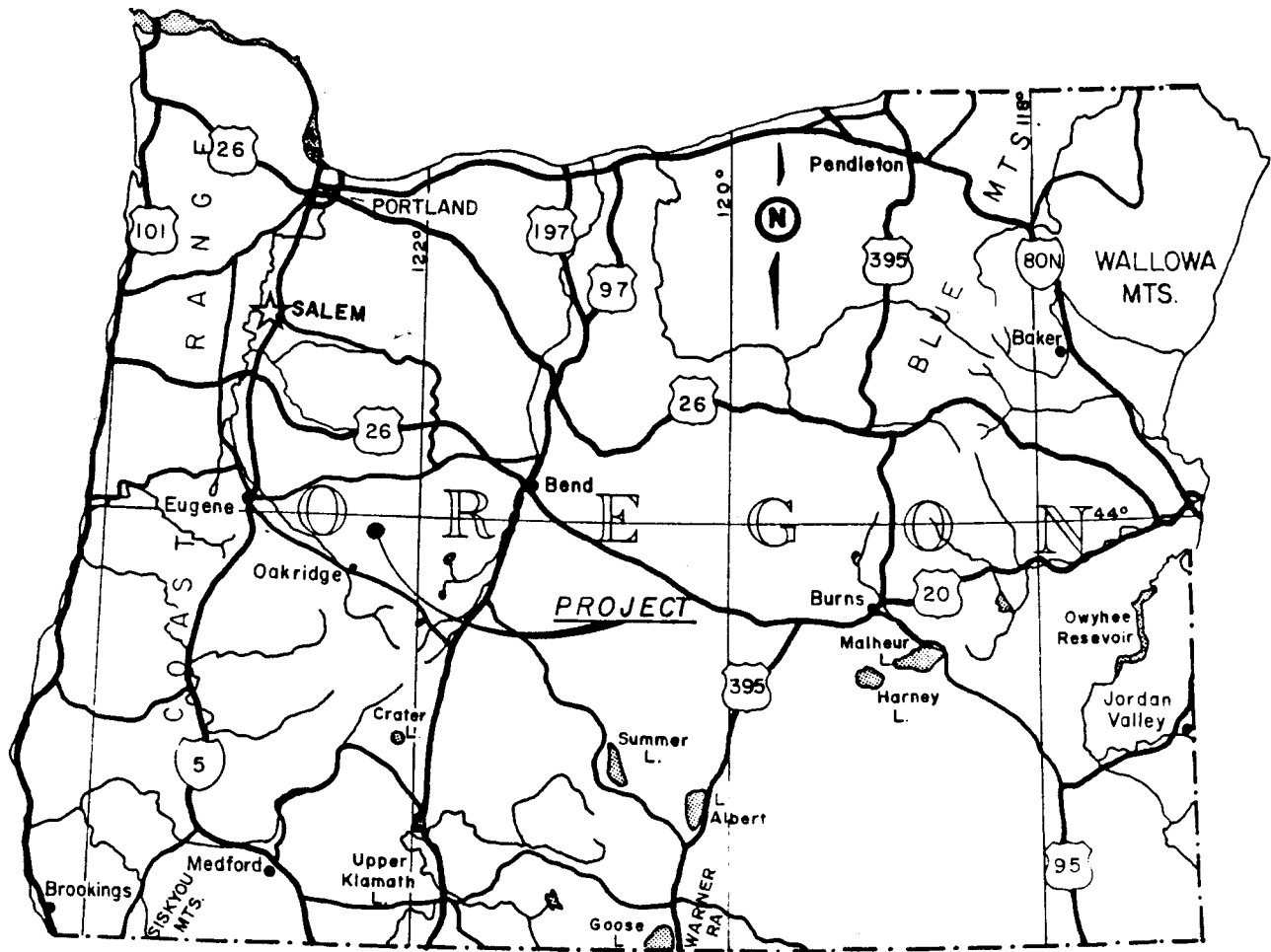

<b>RANGER OIL LIMITED</b> <b>INVADER RESOURCES LTD.</b>		
<b>FALL CREEK PROJECT</b> Fall Creek Mining District, Lane Co., Oregon <b>LOCATION MAP</b>		
T. 19 S., R. 3 & 4 E., W. M.	SCALE: 1:150,000	FIG.
DATE: NOV., 1984	DRAWN: D.W.	1

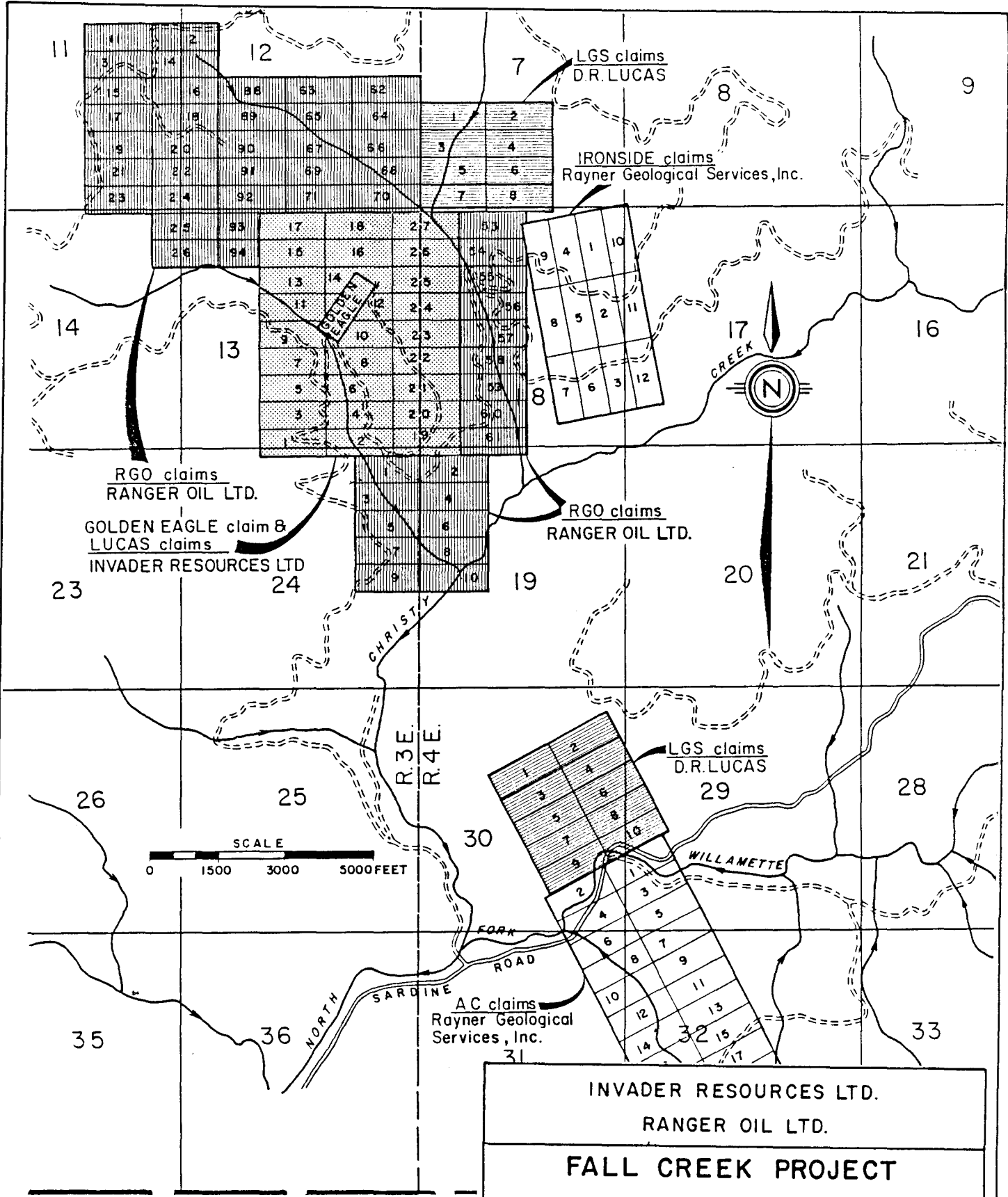

NOTE: CLAIM LOCATIONS AFTER STAKING  
 SKETCHES SUPPLIED TO THE  
 BUREAU OF LAND MANAGEMENT  
 OREGON STATE OFFICE

INVADER RESOURCES LTD. RANGER OIL LTD.	
<b>FALL CREEK PROJECT</b>	
Fall Creek Mining District, Lane Co., Oregon	
<b>CLAIM MAP</b>	
T. 19 S., R. 3&4 E., W.M.	SCALE 1:36000
DATE: AUG. 1984	DRAWN: D.W.
FIG. 2	

# CORRELATION CHART FOR THE WESTERN CASCADES OREGON

( Modified from Brooks and Ramps, 1968 )

From Cochrane, 1984

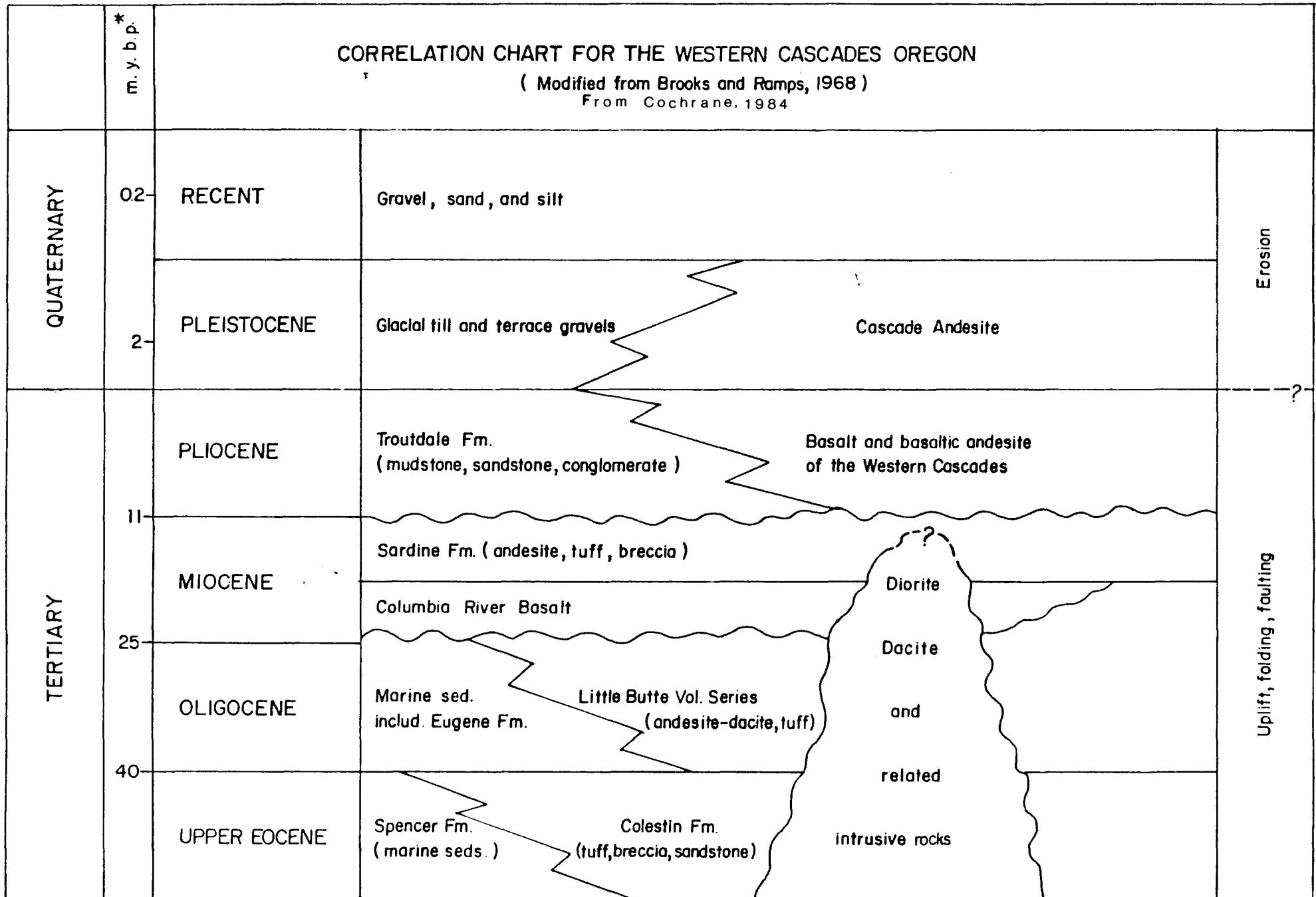

\* million years before present