

Boise Assayers And Metallurgy, Inc.

Consulting Mining and Metallurgical Engineers

208/375-8778

601 E. 46th, #24

Boise, Idaho 83714

Sunshine Mining Co.
Attn: Allen Young
815 Park Blvd.
Boise, ID

November 20, 1992

LAB #	DESCRIPTION	Au ppb
58552	6621	TR
58553	6622	TR
58554	6623	TR
58555	6624	27
58556	6625	24
58557	6626	TR
58558	6627	TR

Jim Mashburn, Lab Manager

Boise Assayers And Metallurgy, Inc.

Consulting Mining and Metallurgical Engineers

208/375-8778

601 E. 46th, #24

Boise, Idaho 83714

Sunshine Mining Co.
Attn: Allen Young
815 Park Blvd.
Boise, ID

November 20, 1992

LAB #	DESCRIPTION	Au ppb
58552	6621	TR
58553	6622	TR
58554	6623	TR
58555	6624	27
58556	6625	24
58557	6626	TR
58558	6627	TR

Jim Mashburn, Lab Manager

Dewey L. Jones Jr.
40990 Lacombe Dr.
Lebanon, Oregon. 97355
(503)451-2810

TO:
SUNSHINE MINING COMPANY,
Suite 100
Boise, Idaho. 83712

Dear Mr. Young,

I hope that this letter finds you well and in the best of health.

I have just recieved your most welcome letter showing your interest in my hard rock mining claims and have enclosed a total of 7 samples off the southeast side along with a sample map showing approximately where each sample was taken.

Concerning the location of the claims, I must apologize for my scepticizism first off as I've heard alot of gossip about how big mining companies will surround an individual's claim so there is no access or that they will some how work it out from under the claimant.

I hope that you can understand my being alittle bit afraid here as mining is of great pleasure to me and I throughly enjoy it and I hope that you will be above board with me as I would like to do business with you and your company.

I will go ahead and give you all the information that you require as I know that if you need to do any geophysical, geachemical, or geomagnetic anomoly testing that you will need all the information in order to obtain the proper location to conduct any of these tests.

The location of my 2 claims is; township-11s, range-4e and are located in the Northwest section of section 20 of Linn county. The closest mining district is the Quartzville mining district. The claim names are: Discovery #1 ORMC.# 141901, and Discovery #2 ORMC.#141902.

Access to them is all on paved road and at a low elevation.

After reaching Yellowbottem road via Quartzville road out of the Sweethome/Foster area, you would turn to your left and proceed exactly 2 miles as this will put you at the southeast head of the claim.

I hope that you find this material of interest and that the content of minerals prove to be profitable for you as I do feel that I have a good offer for you and I know alot of the old mining history for the Cascades as well as know about other locations that were just hy-graded during the 1850's gold rush and a rough history about a mountain close to the claim area that had at one time, about 5000 men on it until gold was discovered in the 1860's in Quartzville (that was easy to dig.)

Anyhow, I hope that this will help, and I hope to hear from you soon.

Sincerely,

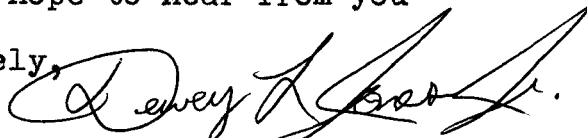
OWNER.

Sample map of claim areas for location of samples.

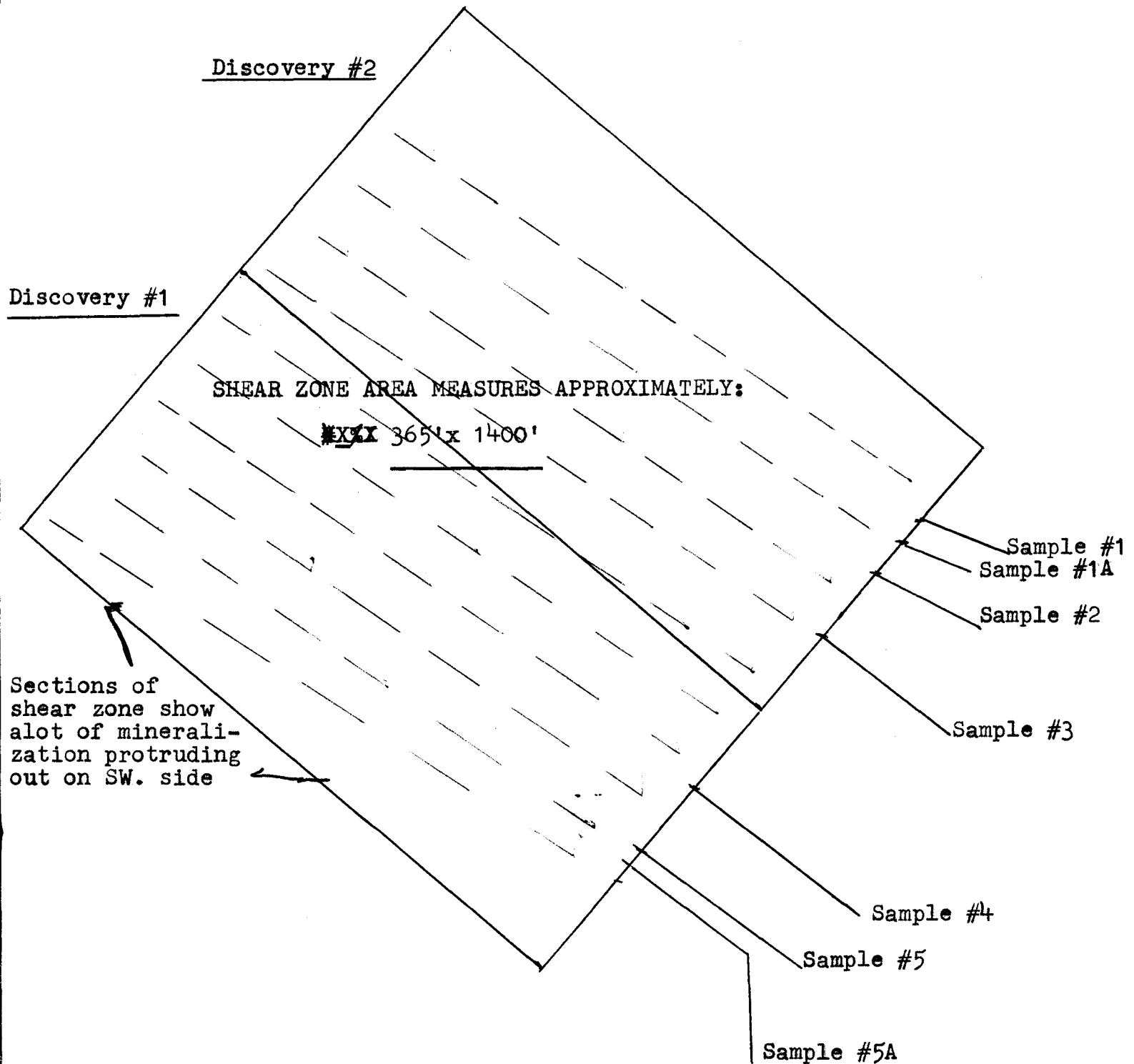

All samples were taken of the South East side of the claim area as this side has the easiest access and the mineralization area is readily exposed to sampling.

Visually, the shear zone shows good mineralization through out the full strike and the further in you dig the more metamorphic the rock becomes and concentration of minerals tend to improve.

Signature of Claimant Lewy A. Jones Jr. date June 21, 1992

MAP of Mining Claim(s)

Township 11 S Range 4 E Section 20 State of OREGON

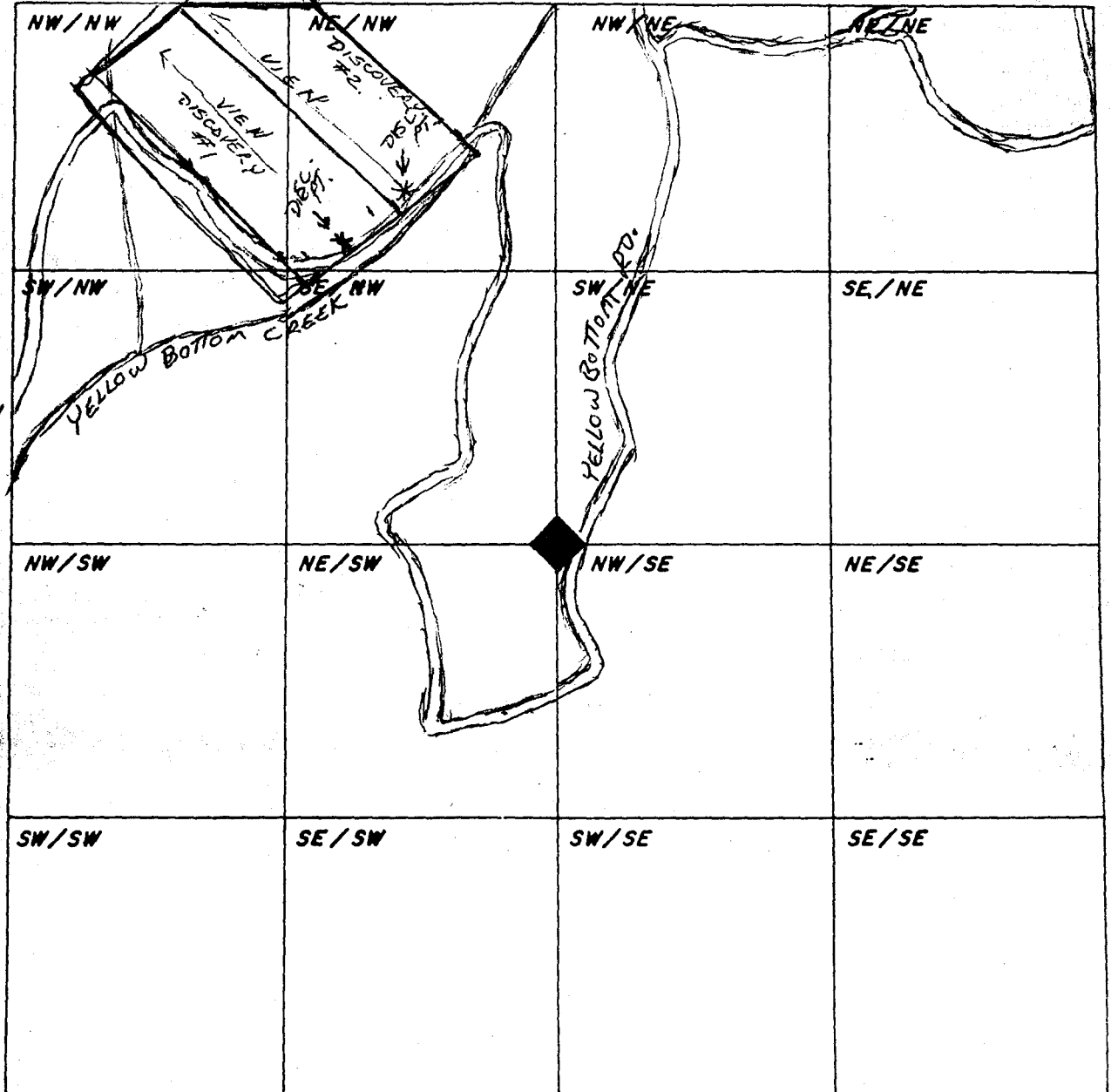

QUADSVILLE
PARK / WORK CTR.

When drawing your claim(s) use an ordinary ruler. 1/8th of an inch would be 100 feet so a full size lode (600' x 1500') would be 3/4" by 1 7/8". A full size placer (1320' x 660') would be 1 5/8" by 13/16".

No. BX- 6624 Date 10-3-92

Property Dewey Jones

Sample Location Sample #1A - Area #2

Description/Remarks Oxidized Tuff(?)
w/ FeOx

Attitude _____

Sample Type: Cut _____ Grab

Soil _____ Trench _____ Drill Core, Cuttings _____

Other _____

Sampler _____

Geochem Au Ag Cu Pb Zn As

Assay Other _____

No. BX- 6625 Date 10-3-92

Property Dewey Jones

Sample Location Sample #5 - Area #1

Description/Remarks Silicified Tuff(?)
w/ pyrite. Bleached.
some talc-like material.

Attitude _____

Sample Type: Cut _____ Grab

Soil _____ Trench _____ Drill Core, Cuttings _____

Other _____

Sampler _____

Geochem Au Ag Cu Pb Zn As

Assay Other _____

WILSON JONES METALLURGY, INC.
3750 10th St
Bldg 103714
606170

Customer's Order No. _____		Date <u>Nov 7</u> 19 <u>92</u>				
Name <u>Smith Mining Co.</u>						
Address _____						
SOLD BY	CASH	C.O.D.	CHARGE	ON ACCT.	MOSE RETD.	PAID OUT
			<input checked="" type="checkbox"/>			
QUAN.	DESCRIPTION	PRICE	AMOUNT			
	<u>FA: Au, Ag</u>		<u>16</u>			
	<u>AA: Au, Ag</u>					
All claims and returned goods MUST be accompanied by this bill.			TAX			
502370			TOTAL <u>16.00</u>			
Received by _____						

Wilson Jones® BUSINESS FORM 55-43AD MADE IN U.S.A.

No. BX- 6626 Date 10-3-92

Property Dewey Jones

Sample Location Sample #4 - Area #1

Description/Remarks Andesite(?) w/
some pyrite.

Attitude _____

Sample Type: Cut _____ Grab

Soil _____ Trench _____ Drill Core, Cuttings _____

Other _____

Sampler _____

Geochem Au Ag Cu Pb Zn As

Assay Other _____

No. BX- 6621 Date 10-3-92

Property Dewey Jones

Sample Location Sample #1 - Area #2

Description/Remarks Silicified Tuff(?) w/ pyrite - some FeO

Attitude _____

Sample Type: Cut _____ Grab Drill Core, Cuttings _____

Soil _____ Trench _____

Other _____

Sampler _____

Geochem Au Ag Cu Pb Zn

Assay Other _____

No. BX- 6623 Date 10-3-92

Property Dewey Jones

Sample Location Sample #3 - Area #2

Description/Remarks Silicified Tuff(?) w/ pyrite. Bleached.

Attitude _____

Sample Type: Cut _____ Grab Drill Core, Cuttings _____

Soil _____ Trench _____

Other _____

Sampler _____

Geochem Au Ag Cu Pb Zn As

Assay Other _____

No. BX- 6622 Date 10-3-92

Property Dewey Jones

Sample Location Sample #2 - Area #2

Description/Remarks Silicified Tuff(?) w/ pyrite. Bleached.

Attitude _____

Sample Type: Cut _____ Grab Drill Core, Cuttings _____

Soil _____ Trench _____

Other _____

Sampler _____

Geochem Au Ag Cu Pb Zn As

Assay Other _____