

SEC. 33

SEC. 34

NE - NE

NW - NW



1319.67

SPUR ROAD

N 81° E

LITTLE NORTH RIVER
SANTIAM RIVER

N 52° E

N 61° W

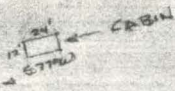

1051.1

CROWN POINT PLACER CLAIM
NE 1/4 SEC. 33, T. 8 S., R. 4 E., W. M.
SCALE: 1 inch = 100 feet

SW - NE

*2

*3

*4

*5

*6

*7

*8

*10

*11

*12

*13

*14

*15

*16

*17

*18

*19

Pearl Creek
Guard 51A

1 mile

MAP '81 3

R. 4 E.

1/4 Cor.

Forest Road S80

Sec. Cor.

Little North Santiam River

*Loc. Notice

Cabin

Sluice Boxes
Sample Taken

T. 8 S.

SEC.
33

Crown Point Mining Company
160-Acre Crown Point Placer Claim
Willamette National Forest
Marion County, Oregon

Scale 500 ft. = 1 inch