

APR 23 1980

DEPT OF GEOLOGY  
& MINERAL INDUST

**REPORT  
of  
SUB-SURFACE  
SURVEY**

**REICHHOLD ENERGY CORP.**

**COLOMBIA COUNTY NO.12**

*KST*

**JOB NO. B 2618**

**DATE 3-17-80**

**DIRECTIONAL DRILLING, INC.**

**BAKERSFIELD**

Phone: 324-3574

# DIRECTIONAL DRILLING, INC.

SHEET NO. 1

JOB NO. B2618

COMPANY REICHOLD ENERGY CORPORATION

ADDRESS KB = +908'

WELL COLOMBIA COUNTY #12

FIELD MIST

COUNTY COLOMBIA

STATE OREGON

MEASURED DEPTH	TERMINAL DRIFT ANGLE	TERMINAL DIRECTION OF DEVIATION	VERTICAL DEPTH	TOTAL COORDINATES				SL. DEPTH <del>VERTICAL</del>
				NORTH	SOUTH	EAST	WEST	
406	ASSUMED	VERTICAL TO THIS DEPTH						
448	2°	S 57 E	447.99		.40	.61		
511	3° 45'	S 42 E	510.91		2.45	3.02		
604	5° 45'	S 26 E	603.59		8.04	7.32		
700	7° 15'	S 24 E	698.93		18.69	11.92		
794	8°	S 25 E	792.15		30.03	17.09		
883	10°	S 24 E	804.99		43.42	23.19		
951	12°	S 24 E	946.83		54.40	28.08		
1043	15°	S 26 E	1036.29		73.86	37.15		
1139	18°	S 25 E	1128.34		98.47	48.89		
1233	20°	S 29 E	1217.22		125.74	62.78		
1359	23°	S 27 E	1334.45		166.51	84.46		
1422	23° 15'	S 25 E	1392.39		103.75	95.31		
1484	24° 45'	S 22 E	1449.03		211.88	105.37		
1545	25° 30'	S 21 E	1504.25		235.98	114.06		
1639	27°	S 21 E	1503.56		274.79	129.76		
1732	28° 30'	S 20 E	1670.06		315.35	144.92		
1766	28° 45'	S 18 E	1700.71		330.75	150.23		
1830	27° 45'	S 17 E	1757.09		359.64	159.34		
1861	26° 45'	S 17 E	1704.64		373.22	163.49		
1920	26°	S 18 E	1837.50		398.21	171.37		-1029'
2015	27°	S 18 E	1922.52		438.53	184.47		-1115'
2108	27° 45'	S 18 E	2005.11		479.20	197.68		-1177'
2201	29°	S 17 E	2006.93		521.35	210.97		-1279'
2323	30°	S 16 E	2193.12		578.95	228.03		-1385'
2450	30° 30'	S 16 E	2302.02		640.45	245.67		-1495'
2575	31°	S 16 E	2410.25		701.89	263.28		-1602'
2650	31° 30'	S 15 E	2474.37		739.38	273.68		-1666'
2929	34° 45'	S 11 E	2708.03		887.94	307.98		-1900'
3364	37° 30'	S 07 E	3059.39		1141.23	348.10		
CLOSURE: 1193.14'				S 16°	57' E			
ALL METHODS OF CALCULATIONS ARE AVERAGE ANGLE								

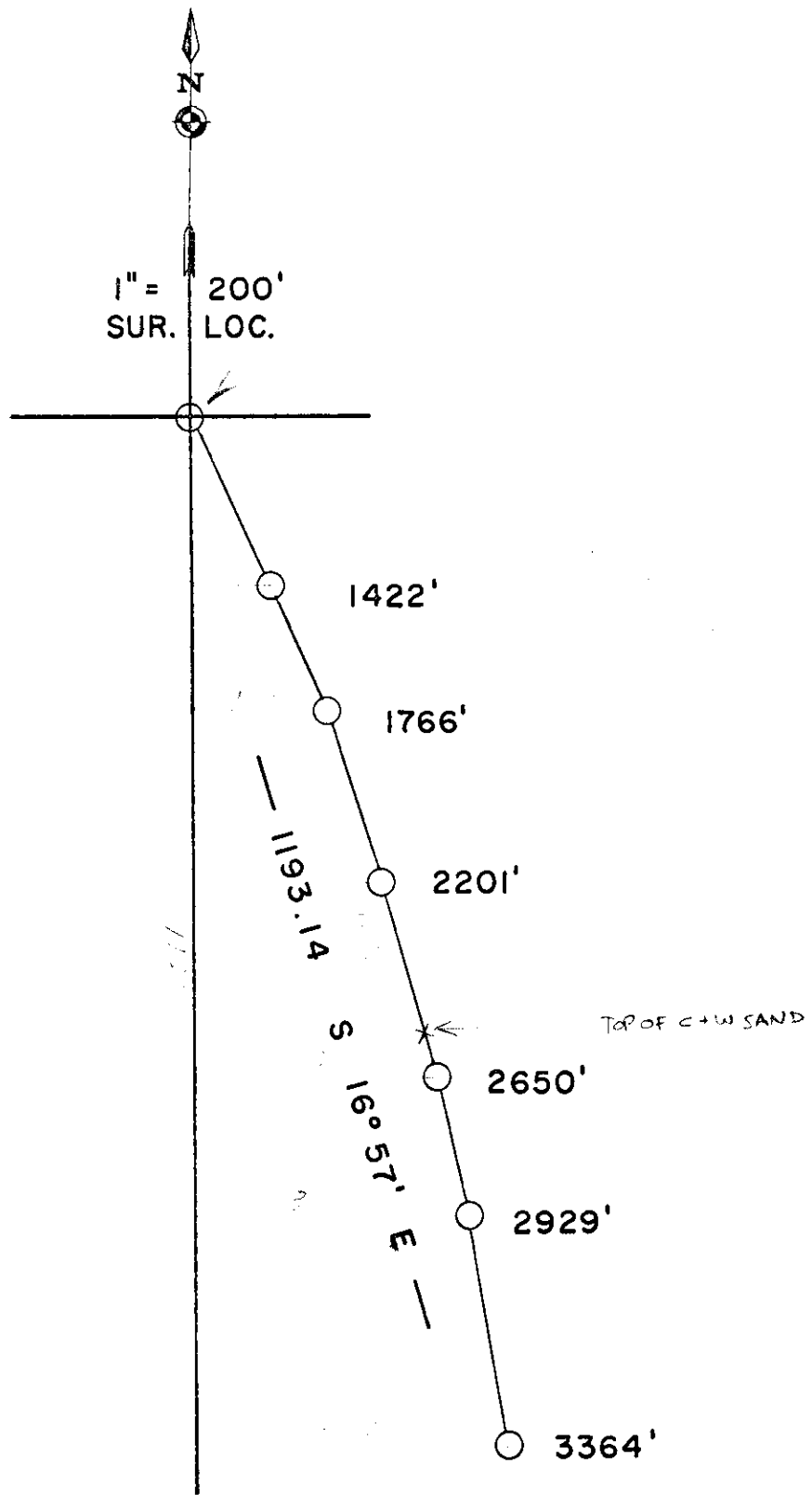

M.D.	3364'
V.D.	3059.39'
SOUTH	1141.23'
EAST	348.10'