



DRIFT LOG

COMPANY AMERICAN QUASAR PETROLEUM CO.
 WELL HICKEY NO. 9-12
 FIELD LEBANON
 COUNTY LINN STATE OREGON

COMPANY AMERICAN QUASAR PETROLEUM COMPANY
 WELL HICKEY NO. 9-12
 FIELD LEBANON (API NO. 36 043 00013)
 COUNTY LINN STATE OREGON

Location 1980' SOUTH AND 990' EAST FROM THE NORTHWEST CORNER OF:
 Sec. 9 Twp. 12S Rge. 2W

Other Services:
 DIG
 CDL/N
 C/AVL

Permanent Datum G.L. Elev. 329.0
 Log Measured From K.B. 0R 10.5 Ft. Above Perm. Datum Elev. K.B. 340.5
 Drilling Measured From K.B. D.F. 329.0 G.L. 329.0

Date	1-27-81	2-5-81		
Run No.	ONE	TWO		
Depth - Driller	2162	4030		
Depth - Welex	2162	4026		
Btm. Log Inter.	2160	4024		
Top Log Inter.	522	2116		
Casing - Driller	9 5/8 @ 521	7 @ 2116		
Casing - Welex	522	2116		
Bit Size	8 3/4	6 1/4		
Type Fluid in Hole	LIGNOSULF	LIGNOSULF		
Dens. 1	90	94	1.70	1.65
Visc.	1	1	1.70	1.65
pH	9.5	9.5	15.8 ml	14.0 ml
Fluid Loss	9.5	9.5	15.8 ml	14.0 ml
Source of Sample	CIRCULATED	CIRCULATED		
R _m @ Meas. Temp.	3.46 @ 46 °F	1.9 @ 48 °F		
R _{mf} @ Meas. Temp.	4.58 @ 58 °F	1.0 @ 53 °F		
R _{mc} @ Meas. Temp.	3.22 @ 54 °F	3.0 @ 50 °F		
Source R _{mf} R _{mc}	MEASURED	MEASURED		
R _m @ BHT	1.44 @ 110 °F	0.6 @ 140 °F		
Time Since Circ.	N/A	N/A		
Max. Rec. Temp.	110 °F @ BHT	110 °F @ BHT		
Equip. 1 Location	8586 MDLND	2876 MDLND		
Recorded By	ANDERSON	ANDERSON		
Witnessed By	MANN	MANN		

Fold Here

Service Ticket No. 055110 Remarks: RUN TWO; 055114

Change in Mud Type or Additional Samples		Run No.			
Date	Sample No.	1	2	3	4
Depth - Driller		TOOL TYPE	DIP	DIP	
Type Fluid in Hole		TOOL NUMBER	N/A	N/A	
		PAD TYPE	FORX0	FORX0	
Dens. 1	Visc.	CORRELATED BY			
pH	Fluid Loss	COMPUTED BY			
Source of Sample					
R _m @ Meas. Temp.	@ °F	REMARKS:			
R _{mf} @ Meas. Temp.	@ °F				
R _{mc} @ Meas. Temp.	@ °F				
Source: R _{mf} R _{mc}	ONE I	TWO I			
R _m @ BHT	1.44 @ 110 °F	0.65 @ 140 °F			
R _{mf} @ BHT	2.41 @ 110 °F	0.39 @ 140 °F			
R _{mc} @ BHT	1.68 @ 110 °F	1.07 @ 140 °F			

Welex does not guarantee the accuracy of any interpretation of log data, conversion of log data to physical rock parameters, or recommendations which may be given by Welex personnel or which may appear on the log or in any other form. Any user of such data, interpretations, conversions, or recommendations agrees that Welex is not responsible, except where due to gross negligence or wilful misconduct, for any loss, damages, or expenses from the use thereof.

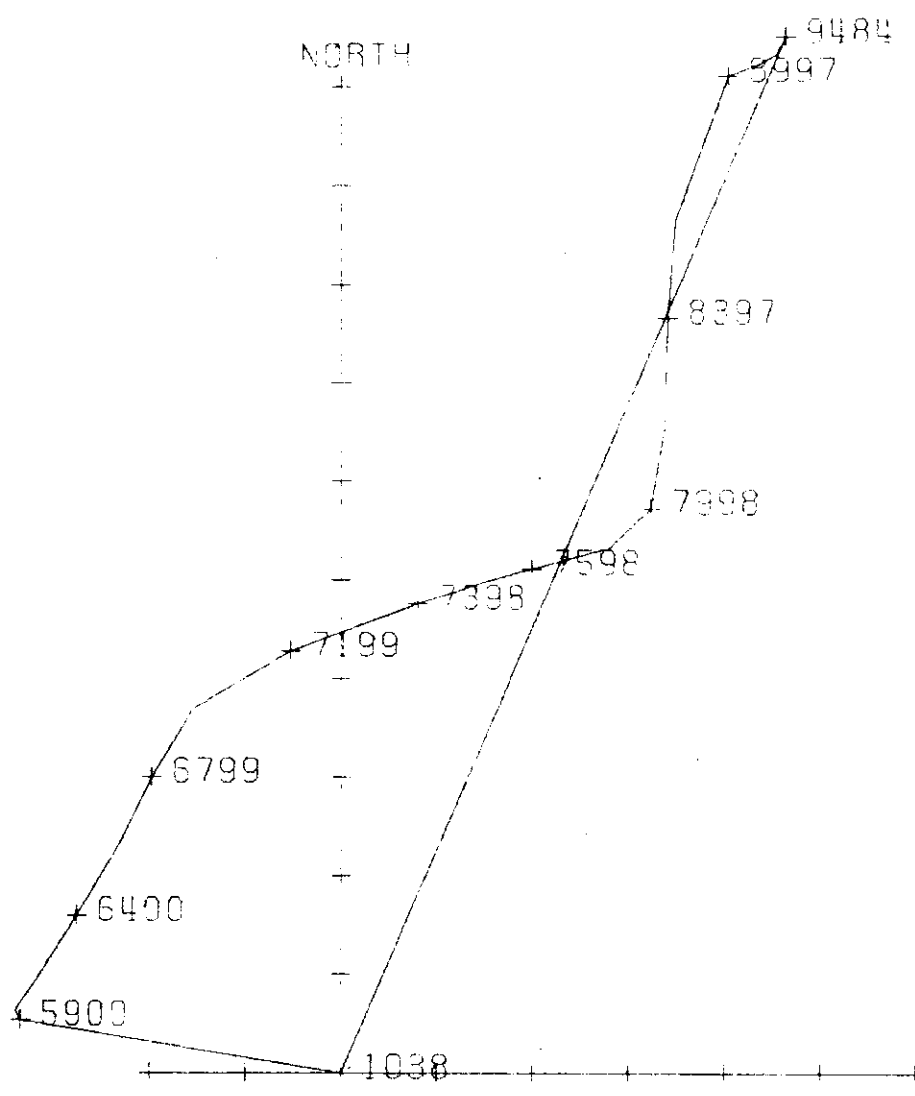

SCALE OF PLOT 1 INCH = 20 FEET
 CLOSURE ANGLE N 23° 49' E
 CLOSURE DIST 114.84

MEAS. DEPTH	DRIFT ANGLE	HOLE T.U.D.	BEARING	COURSE COORDINATES				TOTAL COORDINATES			
				NORTH	SOUTH	EAST	WEST	NORTH	SOUTH	EAST	WEST
1038	.00	1038.00	N 81 W	.0	.0	.0	.0	.0	.0	.0	.0
5900	.80	5899.84	N 81 W	5.3		33.5	5.3	33.5			
6000	.70	5999.82	N 30 E	1.0		.5	6.3	34.0			
6200	1.60	6199.78	N 40 E	3.3		2.3	9.6	31.7			
6400	2.70	6399.64	N 26 E	6.3		4.1	15.9	27.6			
6600	2.40	6599.44	N 37 E	7.6		4.6	23.5	23.0			
6800	1.80	6799.30	N 15 E	6.5		3.2	30.0	19.8			
7000	3.00	6999.12	N 50 E	7.0		4.4	37.0	15.4			
7200	3.70	7198.78	N 70 E	5.8		10.1	42.8	5.3			
7400	4.40	7398.27	N 70 E	4.8		13.3	47.6	8.0			
7500	3.60	7498.03	N 75 E	2.1		6.7	49.7	14.6			
7600	2.70	7597.88	N 76 E	1.4		5.3	51.1	19.9			
7800	2.10	7797.70	N 74 E	2.2		8.1	53.2	28.0			
8000	1.40	7997.60	N 20 E	4.0		4.3	57.2	32.3			
8200	3.40	8197.41	N 0 E	8.2		1.4	65.5	33.8			
8400	3.00	8397.09	N 3 E	11.2		.3	76.6	34.1			
8600	2.70	8596.84	N 7 E	9.9		.9	86.5	34.9			
9000	1.80	8996.53	N 34 E	14.6		5.4	101.1	40.4			
9200	.30	9196.48	S 76 E	1.2		3.2	102.3	43.6			
9400	1.00	9396.47	N 17 E	1.0		1.8	103.3	45.4			
9488	1.60	9484.45	N 42 E	1.7		1.0	105.1	46.4			

HORIZONTAL DEPARTURE = 114.84 FEET AT NORTH 23 DEG. 49. MIN. EAST (GRID)