

STATE OF OREGON
DEPARTMENT OF GEOLOGY AND MINERAL INDUSTRIES
910 State Office Building Portland, OR 97201

MISCELLANEOUS APPLICATION

(In compliance with rules and regulations pursuant to ORS 520)

Amoco (Company or operator) Weyerhaeuser (Lease) "B" No. 1 (Well No.)
Sec. _____, T. _____, R. _____ M.B.&M. Surveyed Coordinates: _____
Wildcat: (or) Field Name: _____ County: Douglas
Date: 1/29/85 Person: Jackie Meyer Position: Tool pusher

This application becomes a permit when signed and dated by DOGAMI in the box below.

The present condition of the well, including complete casing record, is as follows:

1. Perforated 446-4440
2. Test on SW
3. Pumped plug 4520-4337 w/130 SX (Tag at 4337 w/wire line)

Following is a detailed account of proposed work:

1. Perforate 3025'-3023'
2. Set retainer at 3000'
3. Perforate 2784'-2780'
4. Perform circuit to squeeze job (no cement in annulus) string held retainer - squeeze on production joints, up annulus, on sand above pipe
5. Dress down to retainer
6. Perforate between 3000' & 2784'
7. Test.

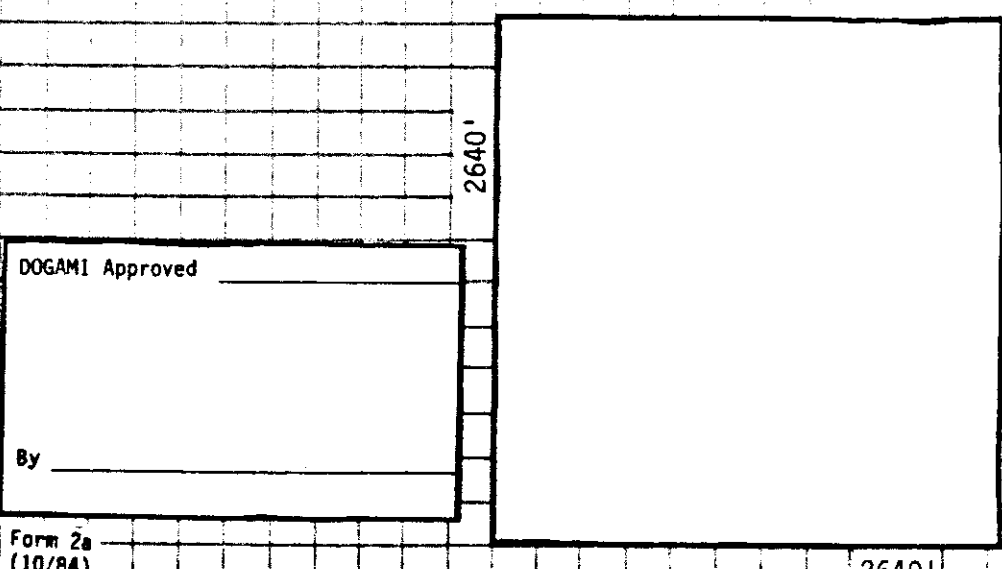
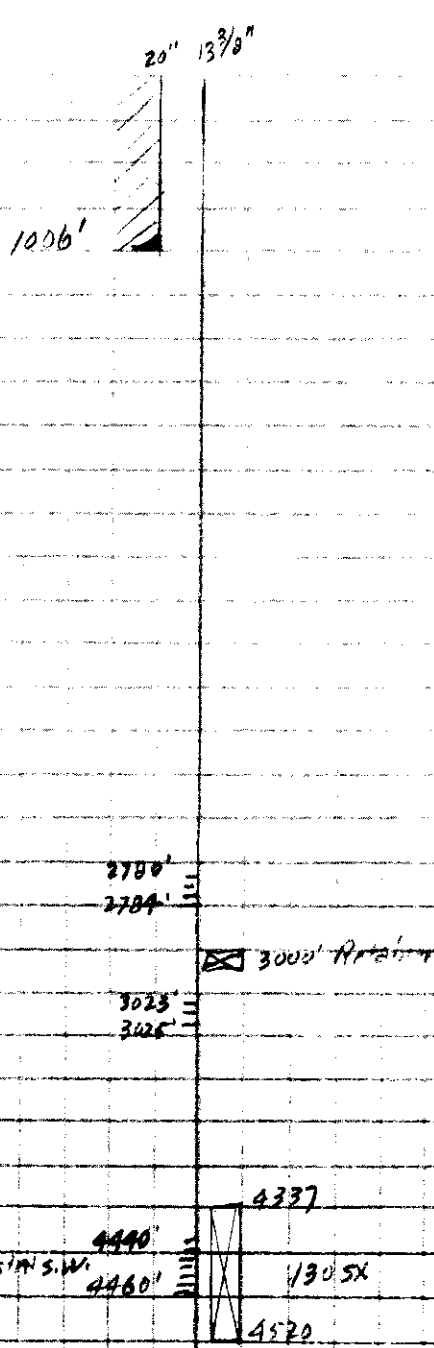

STATE OF OREGON
DEPARTMENT OF GEOLOGY AND MINERAL INDUSTRIES
910 State Office Building Portland, OR 97201

MISCELLANEOUS APPLICATION

(In compliance with rules and regulations pursuant to ORS 520)

Amoco (Company or operator) Weyerhaeuser (Lease) B-1 (Well No.)
Sec. _____, T. _____, R. _____ M.B.&M. Surveyed Coordinates: _____
Wildcat: (or) Field Name: _____ County: Douglas
Date: 1/22/85 Person: Jackie Meyer Position: Tool pusher

This application becomes a permit when signed and dated by DOGAMI in the box below.

The present condition of the well, including complete casing record, is as follows:

- 20" csm 1000'
- 13 3/8" csm 5700'
- TD 11,330'
- Plugged 5745' - DST run below shoe, no good.

Following is a detailed account of proposed work:

1. Plug from 5745' to 5660' (100' inside csg.) Tag plug w/wireline or DP.
2. Perf. and test at 4400'. If no good, plug reperf.
3. Maybe further zones perforated later.
4. Meyer to call DOGAMI when next DST is done to discuss plug for those reperf.

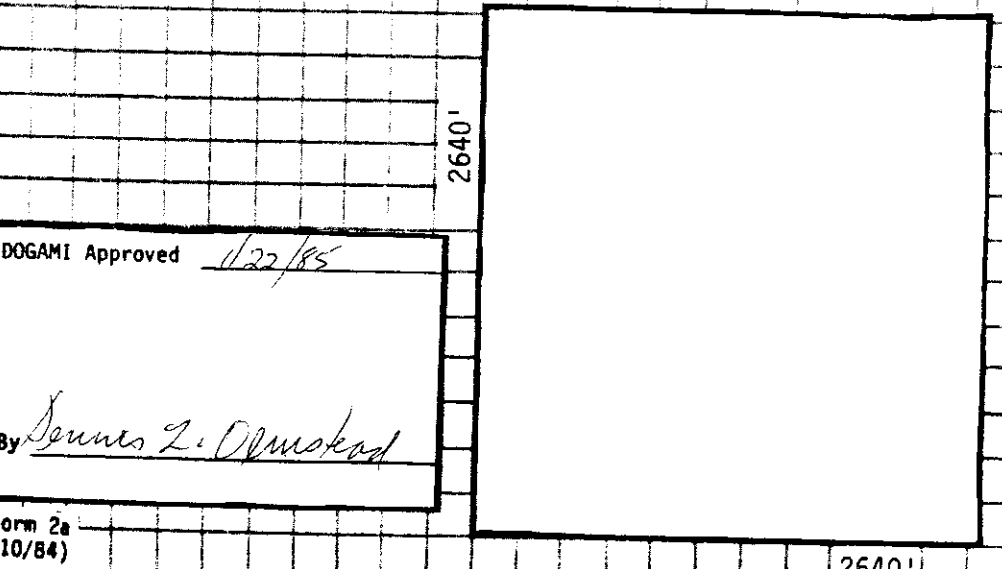
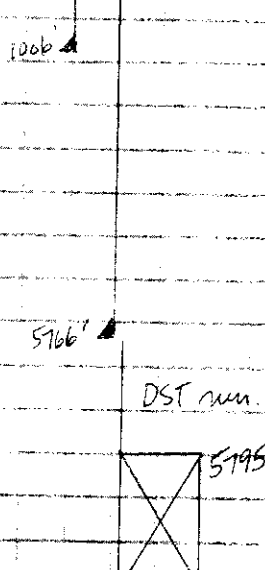

TD 11,330'