

# Branch - Lebanon Center

Linn\_coc14A

Linn-Benton CC

Building Type		County	
Community_College		Linn	
Street			
44 Industrial Way			
City		State	Zip
Lebanon		OR	97335
Latitude		Longitude	
44.54835		122.90665	
Tracking Code		Inspection Date	
New Building		3/1/2007	

Seismicity Zone: Moderate

## FEMA 154 Rapid Visual Screening Score Card

	Type	Basic Score	Vert Irreg	Plan Irreg	Pre-Code	Post-Bench	Soil C	Soil D	Soil E	RVS Score
Primary		0	0	0	0	0	0	0	0	0
Secondary		0	0	0	0	0	0	0	0	0
Tertiary		0	0	0	0	0	0	0	0	0

Branch - Lebanon Center

## Final RVS Score

Final Type

Final Score

FEMA-154 Collapse Potential

Low (<1%)

## East Linn Workforce Development Center

### First Floor

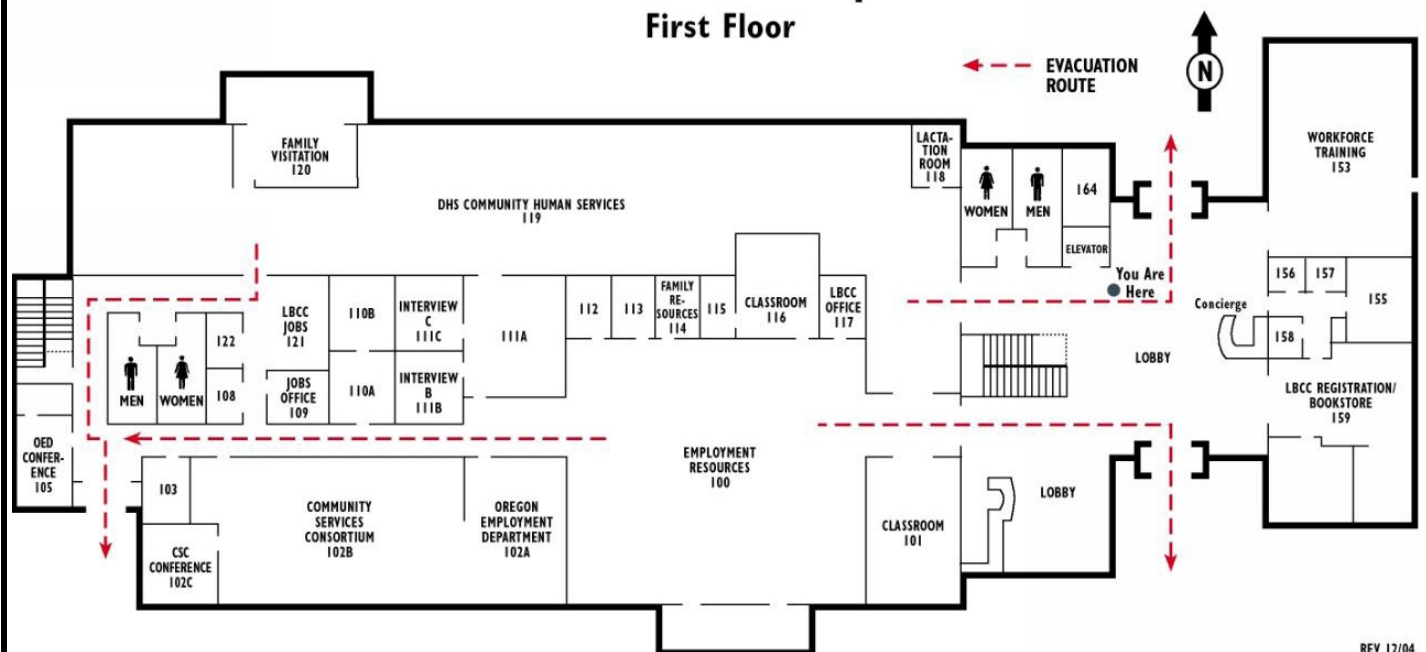

REV 12/04



OregonGeology

Rapid Visual Screening - Senate Bill #2 - Seismic Needs Assessment  
Oregon Department of Geology and Mineral Industries

Enrollment	Year Built (Field Verified)	Year Built (Alt. Source)	Est. Decade Built
	2002	2002	
Total Area (square ft)	Number of Stories	Basement	Pounding Potential
	2	No	No

Plan Irregularities	Vertical Irregularities

Falling Hazards	Poor Conditions