

Building Type		County	
Police - City		Tillamook	
Street			
202 N Hwy 101			
City	State	Zip	
Rockaway Beach	OR	97136	
Latitude		Longitude	
45.61465		123.94337	
Tracking Code		Inspection Date	
RVS in 2006		9/6/2006	



Seismicity Zone: Very High

FEMA 154 Rapid Visual Screening Score Card

	Type	Basic Score	Vert Irreg	Plan Irreg	Pre-Code	Post-Bench	Soil C	Soil D	Soil E	RVS Score
Primary	C2	2.8	0	-0.5	-1	0	0	0	-0.8	0.5
Secondary		0	0	0	0	0	0	0	0	0
Tertiary		0	0	0	0	0	0	0	0	0

Rockaway Police Dept

Final RVS Score

Final Type

Final Score

C2

0.5

FEMA-154 Collapse Potential

High (>10%)

Till-pol03

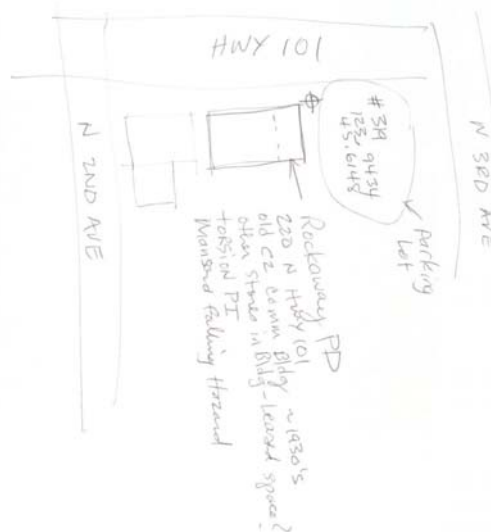

Enrollment	Year Built (Field Verified)	Year Built (Alt. Source)	Est. Decade Built
			1930
Total Area (square ft)	Number of Stories	Basement	Pounding Potential
	1	No	No

Plan Irregularities	Vertical Irregularities
Torsion: Eccentric Stiffness	None
None	None
None	None

Falling Hazards	Poor Conditions
Other: Ornamental Hazard Over Exit	None
None	None
None	None



N Elevation View



NW Plan Irregularity Primary



W Building Name

N Primary Structural Type
FORM MARKSSW Elevation View
NO POUNDING