

## Pre-Operations Report

**Operation Name:** Off the Edge

**County (%):** Klamath (100%)

**Elevation:** 4,397 - 4,923 ft

**Legal Description:** T24S R9E, Section(s) 33, 34; T25S R9E, Section(s) 3, 4

**Tax Code(s):**

**BOF%:** 100% **CSL%:** 0%

**Sale Quarter:** 3

### I. VOLUME AND VALUE SUMMARY

**Table 1. Types, Acres, and Value**

Unit	Harvest Type	Anticipated Product <sup>c</sup>	Gross Acres	Net Acres	MBF/ Acre <sup>a</sup>	MBF/ Unit <sup>a</sup>	\$/MBF <sup>b</sup>	\$ / Unit
1	PC-M	PP-S, LP-S	1035	904	0.8	723	\$3	\$1,808
Total		Regeneration	0	0		0		
		Partial Cut	1035	904		723		
						Gross Value		\$1,808
a. Estimated harvest volume per acre for Unit.						Project Costs		\$1,000
b. Estimated ‘price’ (excluding Project Costs)						Net Value		\$808
c. Anticipated Product (AA-B-C) – AA) SLI species code of the bid species, B) Size Class (S – small [average DBH < 15], M – medium [average DBH 15 to 23], L – large (average DBH > 23)), C) Special Product (P – Premium, H – Hardwood)								

### II. CURRENT STAND CONDITION:

**Table 2. Stand Inventory Information**

Unit	Stand ID	Measured/Imputed <sup>a</sup>	Species	Age	TPA	DBH	BA	SDI	Net Acres <sup>a</sup>
1	41003	M	PP,LP	60	67	12	50	14%	1
1	41008	I = 41007	PP,LP	60	127	10	75	23%	1
1	41083	M	PP,LP	60	45	14	47	13%	1
1	41084	M	LP,PP	60	96	11	59	18%	513
1	41085	M	PP,LP	60	92	13	79	22%	318
1	41086	I = 41085	PP,LP	60	92	13	79	22%	4
1	41152	I = 41168	LP,PP	60	99	12	72	21%	65

- a. Identify the source of stand inventory information. Use the following codes: M = Measure SLI data, I = Imputed SLI data, P = Pre-Cruise Plots, O = other (if other, describe below).
- b. Net Acres have been rounded to the nearest whole acre in this table. Stand that comprise less than one acre of a harvest unit are not reported in this table, so the total "Net Acres" per unit in this table may not equal the total "Net Acres" per unit in table 1.

**Table 3. Additional Stand Information**

Unit	Stand ID	Snags/Acre <sup>a</sup>	Down Wood/Acre <sup>b</sup>	Forest Health		
				SNC	Phellinus	Other <sup>c</sup>
1	41003	--	--	--	--	--
1	41008	--	--	--	--	--
1	41083	--	--	--	--	--
1	41084	--	--	--	--	--
1	41085	--	--	--	--	--
1	41086	--	--	--	--	--
1	41152	--	--	--	--	--

- a. Identify the number of hard snags per acre (decay classes 1 and 2)

- b. Identify the cubic feet per acre of hard down wood (decay classes 1 and 2)
- c. Describe “Other” forest health issue.

- There is currently no snag or down wood inventory data available for these stands.
- Where feasible, opportunities for snag creation of smaller diameter trees will be assessed during sale layout.

### III. WILDLIFE AND T&E SPECIES CONSIDERATIONS:

Foresters need to request the Biological Survey Tracking Form (BSTF) from the ODF Wildlife Biologist prior to sale layout in order to ensure all T&E related information is complete and understood.

1. A portion of the operation is within a NSO Circle or Home:  
☒ No    ☐ Yes, BA required
2. Are Surveys for NSO being conducted for any portion of this operation?  
☐ Yes    ☒ No    ☐ Density surveys
3. Are there any additional considerations (FPA Resource Sites, Species of Concern sites/Plants [from ORBIC<sup>1</sup>])?  
☐ No    ☒ Yes, please describe: Unthinned patches of timber will be retained within the sale as thermal and visual cover for wildlife. District will work with Area Biologist to identify these areas.

### IV. PROPOSED MANAGEMENT PRESCRIPTION AND PROPOSED OUTCOME:

**Table 4. Partial Cut Prescription (Complete only for Partial Cut Harvests)**

Unit	Harvest Type	Harvest Species	Residual			
			Species	TPA	BA	% SDI
1	PC-M	LP, PP	LP, PP, SP	121	80	

- **Prescription Considerations:**
  - This harvest will increase viability of the stand by reducing stocking levels to maintain proper stand density. The stand is currently overstocked and vulnerable to attack by a range of forest pathogens. Research has shown that fast-growing trees can resist bark beetle attack, some diseases, and mistletoe infection. Therefore, maintaining forest health means keeping individual trees growing well. This will maximize opportunity for future harvests and create a resilient stand suitable to the climate and ecology of eastern Oregon ponderosa and mixed pine stand types.
  - Thinning will be primarily from below, removing suppressed understory and co-dominant individuals. Overstory trees will be cut as needed to ensure continued stand growth. The stand will result with a multi aged and vigorously growing 80 sqft/acre basal area where forest health constraints allow.
  - The remaining stand will be grown forward with another entry anticipated in approximately 20 years.

## V. HARVESTING AND ACCESS CONSIDERATIONS:

**Table 5. Harvest System and Access Summary**

Unit	Harvest System		Slope (%)	Area Access	Seasonal Access
	% Cable	% Ground			
1	0	100	<35	Established	All Weather

- Haul Route: CB-8 to 9772 rd. to 9765 rd. to Hwy 97; CB-7 to 9772 rd. to 9765 rd. to Hwy 97; CB-6 to 9772 rd. to 9765 rd. to Hwy 97.
- Haul Route Condition: Haul route consists of all-weather pumice roads that are otherwise unsurfaced and are typically frozen during the winter.
- Are easements required for the haul route? ☐ Yes ☒ No

**Table 6. Transportation Management Summary (Miles)**

Activity	Mainline	Collector	Rocked Spur	Dirt Spur
Construct	0	0	0	0
Improve, Rock, and/or Maintain	12	0	0	4
Vacate	0	0	0	0
Stream Crossings to install existing (IE)/replace (R)/new construction (NC)				
Type F - SSBT <sup>a</sup>	0	0	0	0
Type F – Non-SSBT	0	0	0	0
Type N	0	0	0	0

- Rock Sources for this operation: Rock will be purchased from a local weed-free vendor.
- Are property line surveys required for this operation? ☐ Yes ☒ No

## VI. AQUATIC RESOURCES:

- Do any streams require additional review for the following?
  - Fish presence: ☒ No ☐ Yes
  - Perennial/Seasonal: ☒ No ☐ Yes
- Are any domestic points of diversion identified in the Oregon Water Resource Department's water rights information search GIS database located downstream within 3,000 feet of the harvest operation?
   
☒ No ☐ Yes, describe protection measures:
- Are there any unregistered or unknown status domestic points of diversion that have been identified within the harvest operation? ☒ No ☐ Yes, please describe:
- Is there a Stream Enhancement Project planned? ☒ No ☐ Yes, please describe:

## VII. SLOPE STABILITY ISSUES

Table 7. Summary of Slope Stability Assessment

Unit	Harvest Review Completed?	Public Safety Review Complete?	Additional Comment
1	Yes	Yes	

- Geotechnical reviews have been completed. Additional consultation with Geotechnical Specialists will be done during sale layout as needed.

## VIII. RECREATION RESOURCES:

Recreation issues/coordination: ☒ No ☐ Yes, please describe:

## IX. HISTORIC AND CULTURAL RESOURCES:

1. Has the sale been reviewed by a qualified archaeologist for potential historic or cultural resource presence?  
☒ Yes ☐ No

## X. SCENIC RESOURCES:

Are there scenic resources in the vicinity of this operation that need additional consideration? ☒ No ☐ Yes, please describe:

## XI. OTHER RESOURCE CONSIDERATIONS:

1. Has a review of the FLMCS layer determined that any resources not mentioned in the report above need additional planning? ☒ No ☐ Yes, describe below
2. Are there any other resources present that need additional consideration? ☒ No ☐ Yes, please describe:

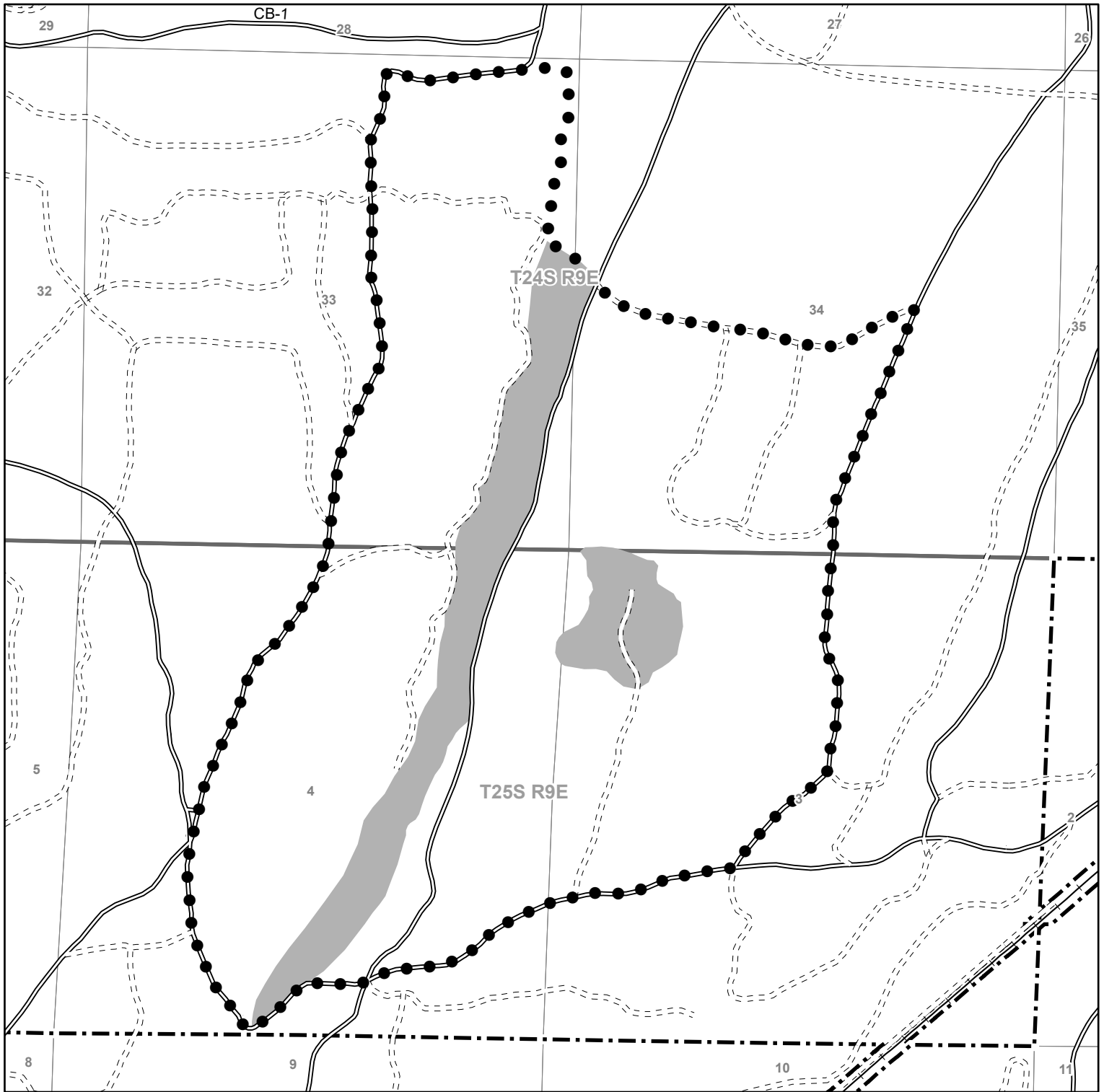

## FY 2026 - Klamath-Lake District

### Off the Edge

Portions of Section(s) 33, 34, T24S, R9E & 3, 4, T25S, R9E, W.M.  
Klamath County

State Forest Division  
11/15/2024

This product is for informational use and may not have been prepared for or be suitable for legal, engineering or survey purposes. Variations may exist between and among data sets in use by the Department of Forestry.

This map was developed using the Statewide Flow Line layer.

Unit 1 904 Acres (PC)

Total 904 Acres

### Legend

- ● Sale Boundary
- Railroads
- Ownership Boundary
- Surfaced
- Unsurfaced
- No Harvest Area

1:18,000

1,000 500 0 1,000 Feet

