

Pre-Operations Report

Operation Name: West Homestead
County (%): Marion (100%)
Elevation: 1,522 – 2,256 ft
Legal Description: T7S R2E, Section(s) 33, 34

Tax Code(s):
BOF%: 0 **CSL%:** 100
Sale Quarter: ALT

I. VOLUME AND VALUE SUMMARY

Table 1. Types, Acres, and Value

Unit	Harvest Type	Anticipated Product ^c	Gross Acres	Net Acres	MBF/Acre ^a	MBF/Unit ^a	\$/MBF ^b	\$/Unit
1	CC	DF-M, BM-S	52	51	30.0	1,530	\$300	\$459,000
Total		Regeneration	52	51		1,530		
		Partial Cut	0	0				
							Gross Value	\$459,000
a. Estimated harvest volume per acre for Unit.							Project Costs	\$94,661
b. Estimated 'price' (excluding Project Costs)							Net Value	\$364,339
c. Anticipated Product (AA-B-C) – AA) SLI species code of the bid species, B) Size Class (S – small [average DBH < 15], M – medium [average DBH 15 to 23], L – large (average DBH > 23]), C) Special Product (P – Premium, H – Hardwood)								

II. CURRENT STAND CONDITION:

Table 2. Stand Inventory Information

Unit	Stand ID	Measured/Imputed ^a	Species	Age	TPA	DBH	BA	SDI	Net Acres ^b
1	12009	M	DF,RA	51	140	16	196	50%	45
1	12236	M	DF,BM	171*	60	29	282	56%	6

- a. Identify the source of stand inventory information. Use the following codes: M = Measured SLI data, I = Imputed SLI data, P = Pre-Cruise Plots, O = other (if other, describe below).
- b. Net Acres have been rounded to the nearest whole acre in this table. Stand that comprise less than one acre of a harvest unit are not reported in this table, so the total "Net Acres" per unit in this table may not equal the total "Net Acres" per unit in table 1.

* Trees within this age class will be reserved as leave trees

The target stand 12009 was planted but has no record of pre-commercial or commercial thinning. Stand 12236 has no prior management history and will be reserved as leave trees.

Table 3. Additional Stand Information

Unit	Stand ID	Snags/Acre ^a	Down Wood/Acre ^b	Forest Health		
				SNC	Phellinus	Other ^c
1	12009	1	1381			
1	12236	7	1352			

- a. Identify the number of hard snags per acre (decay classes 1 and 2)
- b. Identify the cubic feet per acre of hard down wood (decay classes 1 and 2)
- c. Describe "Other" forest health issue.

III. WILDLIFE AND T&E SPECIES CONSIDERATIONS:

Foresters need to request the Biological Survey Tracking Form (BSTF) from the ODF Wildlife Biologist prior to sale layout in order to ensure all T&E related information is complete and understood.

1. A portion of the operation is within (Check all that apply):
☐ TAS ☐ NSO Circle or Home Range, or Baseline or Elevated Baseline Thiessen (BA required)
☐ MMMA (BA required) ☒ None
2. Are Surveys for NSO being conducted for any portion of this operation?
☐ No ☒ Density Surveys ☐ Operational Surveys ☐ Combination (Density/Operational)

Notes:

3. Are Surveys for MM being conducted for any portion of this operation?
☐ Yes (in progress/completed) ☐ No (Not habitat) ☒ N/A (outside of MM survey zone)

Notes:

4. Are there any additional considerations (FPA Resource Sites, Species of Concern sites/Plant [from ORBIC¹])?
☒ No ☐ Yes, please describe:

IV. DESIRED FUTURE CONDITION AND PRESCRIPTION:

Table 4. Stand Structure Information

Unit	Stand ID	Current	Desired Future ^b	Inside of HCA	Net Acres ^a
1	12009	UDS	GEN	No	45
1	12236	OFS	GEN	No	6

- a. Net Acres have been rounded to the nearest whole acre in this table. Stand that comprise less than one acre of a harvest unit are not reported in this table, so the total "Net Acres" per unit in this table may not equal the total "Net Acres" per unit in table 1.
- b. While desired future condition complex (Layered -LYR and Older Forest Structure – OFS) is mapped, targets for Regeneration, Closed Single Canopy and Understory stands are not. These stand types are typically referred to as General (GEN) when discussing desired future condition.

Table 5. Partial Cut & HCA Prescriptions (Complete only for Partial Cut and HCA Harvests)

Unit	Harvest Type	Harvest Species	Residual			
			Species	TPA	BA	% SDI
1	CC					

- **Leave Tree Considerations:** Foresters will work with wildlife biologist during sale layout. The following should be considered when determining final leave tree arrangements.
 - **Stand Characteristics:** The East sale boundary is the draft Habitat Conservation Area (HCA). Some older trees in stand 12236 are outside of the HCA and included within the sale area. Those oldest trees along the HCA boundary will be reserved as leave trees.
- **Reforestation Considerations:** Following the completion of harvest, the unit will be planted with a mixture of species native to the geographic area.

V. HARVESTING AND ACCESS CONSIDERATIONS:

Table 6. Harvest System and Access Summary

Unit	Harvest System		Slope (%)	Unit Access	Seasonal Access
	% Cable	% Ground			
1	100	0	>65	Simple	TBD

- Haul Route: The haul route for this operation will be the Abiqua 133 Road and associated spurs off that collector road. The Abiqua 133 Road goes out to the Abiqua 100 road and eventually out Grade Road.
 - The sale is behind a locked gate
- Haul Route Condition: The Grade Road and Abiqua 100 Road are in good condition currently. The collector and spur roads associated with accessing this Unit will need considerable improvement and reconstruction to facilitate log haul.
- Are easements required for the haul route? ☐ No ☒ Yes

Easements are in place to go out the Abiqua 100 Road. ODF will coordinate with the adjacent landowner to ensure the entirety of the haul route is covered by this easement or if another one will need to be filed. The existing easement requires insurance and road maintenance. The easement on file is 311.2412 with Weyerhaeuser.

Table 7. Transportation Management Summary (Miles)

Activity	Mainline	Collector	Rocked Spur	Dirt Spur
Construct	0	0	0.98	0
Improve, Rock, and/or Maintain	0	0.41	0	0
Vacate	0	0	0	0
Stream Crossings: install on existing road (IE)/replace on existing road (R)/install on new construction road (NC)				
Type F - SSBT ^a	0	0	0	0
Type F – Non-SSBT	0	0	0	0
Type N	0	0	0	0

a. Salmon Steelhead and Bull Trout (SSBT)

- Rock Sources for this operation: The primary rock source for this operation will be the Bridge Creek Pit.
- Are property line surveys required for this operation? ☐ No ☒ Yes

The northern, western and southern lines of this Unit are shared with an adjacent landowner and will need to be reconned for survey needs prior to layout and harvest.

- Is there planned new road construction planned within RCAs/HCA's? ☒ No ☐ Yes

VI. AQUATIC RESOURCES:

1. Do any streams require additional review for the following?
 - Fish presence: ☒ No ☐ Yes
 - Perennial/Seasonal: ☐ No ☒ Yes
 - H.E.R.: ☐ No ☒ Yes
 - There are streams within the sale that require additional review. Buffers shown on the map indicate where it is believed streams are located. These streams will be located, verified for permanence, and/or type of seasonal stream during sale layout and Geotech review and buffered as required.
2. Is a portion of the operation within an Aquatic Anchor? ☒ No ☐ Yes, name:
3. Are any domestic points of diversion identified in the Oregon Water Resource Department's water rights information search GIS database located downstream within 3,000 feet of the harvest operation?
☒ No ☐ Yes, describe protection measures:
4. Are there any unregistered or unknown status domestic points of diversion that have been identified within the harvest operation? ☒ No ☐ Yes, please describe:
5. Is there a Stream Enhancement Project planned? ☒ No ☐ Yes, please describe:

VII. SLOPE STABILITY ISSUES:

Table 8. Summary of Slope Stability Assessment

Unit	Harvest Review Complete	Public Safety Review Complete	Additional Comment
1	Yes	Yes	See Recommendations

- **Geotech Review:** Geotechnical reviews have been completed and slope protections have been incorporated into No Harvest buffers shown on the map. Additional consultation with Geotechnical Specialists will be done during sale layout as needed.

VIII. RECREATION RESOURCES:

1. Recreation issues/coordination: ☒ No ☐ Yes, please describe:

IX. HISTORIC AND CULTURAL RESOURCES:

1. Has the sale been reviewed by a qualified archaeologist for potential historic or cultural resource presence? ☐ No ☒ Yes

X. SCENIC RESOURCES:

1. Are there scenic resources in the vicinity of this operation that need additional consideration?
☒ No ☐ Yes, please describe:

XI. OTHER RESOURCE CONSIDERATIONS:

1. Has a review of the FLMCS layer determined that any resources not mentioned in the report above need additional planning? ☒ No ☐ Yes, please describe:
2. Are there any other resources present that need additional consideration? ☐ No ☒ Yes, please describe:
 - **Adjacent Landowners (shared property lines):**
 - Private-Industrial Landowner
 - District staff will work with adjacent private landowners to determine what additional outreach is needed during the sale process and if any additional restrictions are needed.

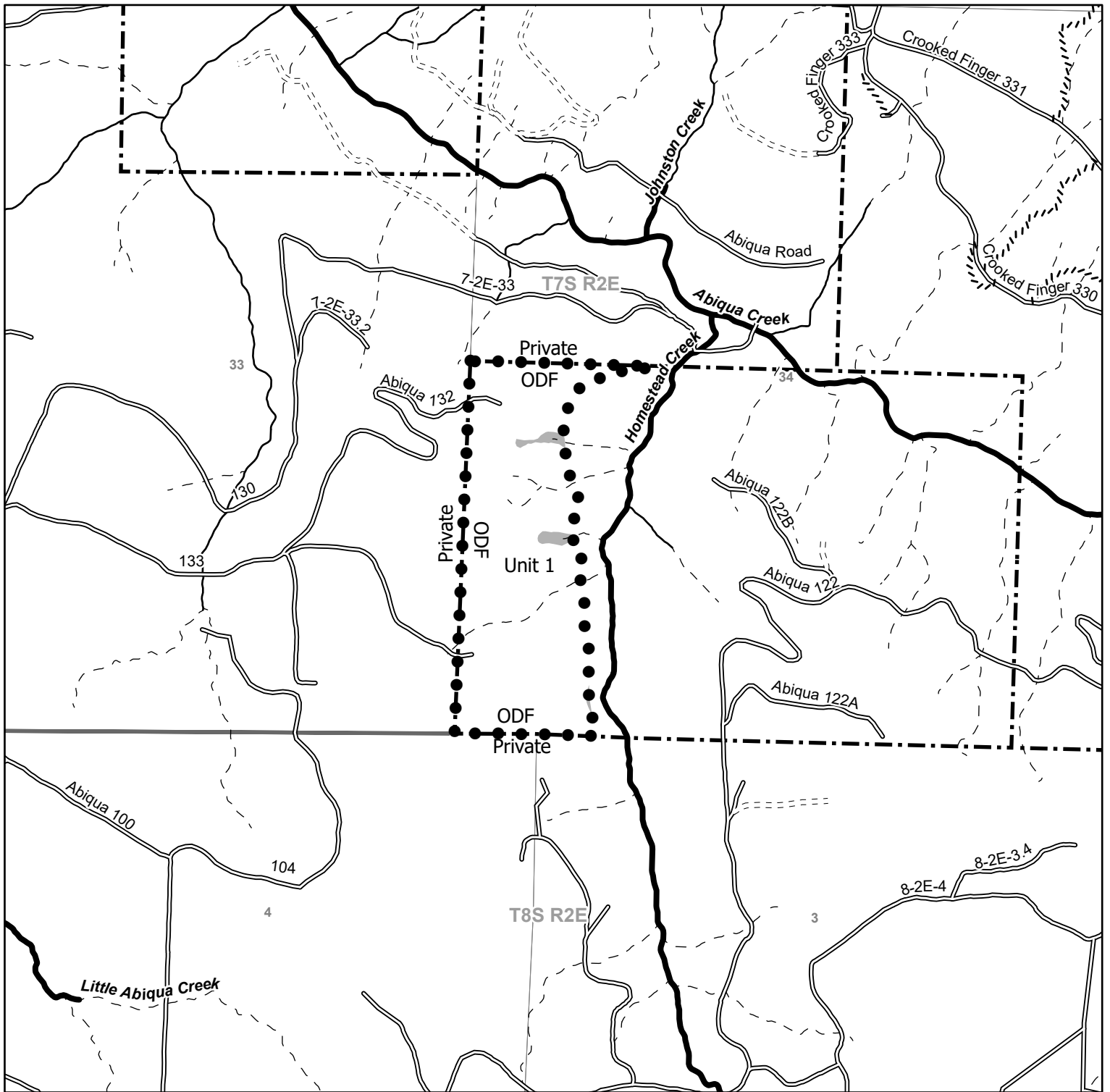

Legend

- ● Sale Boundary
- No Harvest Area
- //// Recreation Trails
- Surfaced
- Unsurfaced
- Perennial Fish Streams
- Perennial Non-Fish Streams
- - - Seasonal Streams
- Ownership Boundary

FY 2026 - North Cascade District West Homestead Portions of Section(s) 33, 34, T7S R2E, WM. Marion County

State Forest Division
01/03/2025

This product is for informational use and may not be suitable for legal, engineering, or surveying purposes. Variations may exist between and among data sets in use by the Department of Forestry. This map was developed using the Statewide Stream Layer.

Unit 1 51 Acres (CC)

Total 51 Acres



Map 2 of 2

1:12,000

1,000 500 0 1,000 Feet

