

Pre-Operations Report

Operation Name: Three Divides
County (%): Washington (100%)
Elevation: 622 - 934 ft
Legal Description: T3N R5W, Section 36

Tax Code(s): n/a
BOF%: 100 **CSL%:** 0
Sale Quarter: Alternate

I. VOLUME AND VALUE SUMMARY

Table 1. Types, Acres, and Value

Unit	Harvest Type	Anticipated Product ^c	Gross Acres	Net Acres	MBF/ Acre ^a	MBF/ Unit ^a	\$/MBF ^b	\$/Unit
1	CC	DF-L, BM-S	142	77	45.0	3,465	\$500	\$1,732,500
Total		Regeneration	142	77		3,465		
		Partial Cut						
							Gross Value	\$1,732,500
a. Estimated harvest volume per acre for Unit.							Project Costs	\$65,685
b. Estimated ‘price’ (excluding Project Costs)							Net Value	\$1,666,815
c. Anticipated Product (AA-B-C) – AA) SLI species code of the bid species, B) Size Class (S – small [average DBH < 15], M – medium [average DBH 15 to 23], L – large (average DBH > 23]), C) Special Product (P – Premium, H – Hardwood)								

II. CURRENT STAND CONDITION:

Table 2. Stand Inventory Information

Unit	Stand ID	Measured/Imputed ^a	Species	Age	TPA	DBH	BA	SDI	Net Acres ^b
1	8342	M	DF, RC	90	135	18	234	57%	25
1	8344	M	DF, BM	90	110	22	280	63%	9
1	8345	I = 7463	DF, RC	90	92	21	218	50%	43

- a. Identify the source of stand inventory information. Use the following codes: M = Measured SLI data, I = Imputed SLI data, P = Pre-Cruise Plots, O = other (if other, describe below).
- b. Net Acres have been rounded to the nearest whole acre in this table. Stand that comprise less than one acre of a harvest unit are not reported in this table, so the total "Net Acres" per unit in this table may not equal the total "Net Acres" per unit in table 1.

- These stands were planted and the southern portion was commercially thinned in 2014.

Table 3. Additional Stand Information

Unit	Stand ID	Snags/Acre ^a	Down Wood/Acre ^b	Forest Health		
				SNC	Phellinus	Other ^c
1	8342	9	167		Yes	
1	8344	5	1297		Yes	
1	8345	4	113		Yes	

- a. Identify the number of hard snags per acre (decay classes 1 and 2)
- b. Identify the cubic feet per acre of hard down wood (decay classes 1 and 2)
- c. Describe "Other" forest health issue.

III. WILDLIFE AND T&E SPECIES CONSIDERATIONS:

Foresters need to request the Biological Survey Tracking Form (BSTF) from the ODF Wildlife Biologist prior to sale layout in order to ensure all T&E related information is complete and understood.

- 1. A portion of the operation is within (Check all that apply):
☐ TAS ☐ NSO Circle or Home Range, or Baseline or Elevated Baseline Thiessen (BA required)
☐ MMMA (BA required) ☒ None
- 2. Are Surveys for NSO being conducted for any portion of this operation?
☐ No ☒ Density Surveys ☐ Operational Surveys ☐ Combination (Density/Operational)

Notes:

- 3. Are Surveys for MM being conducted for any portion of this operation?
☒ Yes (in progress/completed) ☐ No (Not habitat) ☐ N/A (outside of MM survey zone)

Notes: Surveys being conducted in 2024 and 2025.

- 4. Are there any additional considerations (FPA Resource Sites, Species of Concern sites/Plant [from ORBIC¹])?
☒ No ☐ Yes, please describe:

IV. DESIRED FUTURE CONDITION AND PRESCRIPTION:

Table 4. Stand Structure Information

Unit	Stand ID	Current	Desired Future ^b	Inside of HCA	Net Acres ^a
1	8342	LYR	GEN	No	25
1	8344	UDS	GEN	No	9
1	8345	UDS	GEN	No	43

- a. Net Acres have been rounded to the nearest whole acre in this table. Stand that comprise less than one acre of a harvest unit are not reported in this table, so the total “Net Acres” per unit in this table may not equal the total “Net Acres” per unit in table 1.
- b. While desired future condition complex (Layered -LYR and Older Forest Structure – OFS) is mapped, targets for Regeneration, Closed Single Canopy and Understory stands are not. These stand types are typically referred to as General (GEN) when discussing desired future condition.

Table 5. Partial Cut & HCA Prescriptions (Complete only for Partial Cut and HCA Harvests)

Unit	Harvest Type	Harvest Species	Residual			
			Species	TPA	BA	% SDI
1	CC					

- **Leave Tree Considerations:** Foresters will work with Wildlife Biologist during sale layout. The following should be considered when determining final leave tree arrangements.
 - Stand Characteristics: Prioritize larger diameter trees as part of the retention strategy.
- **Reforestation Considerations:** Following the completion of harvest, the unit will be planted with a mixture of species native to the geographic area.

¹ Oregon Biodiversity Information Center
Forest Grove District
Draft - April 2025

V. HARVESTING AND ACCESS CONSIDERATIONS:

Table 6. Harvest System and Access Summary

Unit	Harvest System		Slope (%)	Unit Access	Seasonal Access
	% Cable	% Ground			
1	0	100	<35	Simple	Dry Weather Only

- Haul Route:
 - Strassel Road to Timber Road to Highway 26
 - This sale is behind a locked gate.
- Haul Route Condition:
 - The haul route is in good condition and road maintenance or improvement needs will be assessed during sale layout.
- Are easements required for the haul route? ☐ No ☒ Yes
 - An easement will be required to haul rock and haul logs on Stimson property.

Table 7. Transportation Management Summary (Miles)

Activity	Mainline	Collector	Rocked Spur	Dirt Spur
Construct	0	0	0	0.83
Improve, Rock, and/or Maintain	0	0	3.1	0
Vacate	0	0	1.9	0
Stream Crossings: install on existing road (IE)/replace on existing road (R)/install on new construction road (NC)				
Type F - SSBT ^a	0	0	0	0
Type F – Non-SSBT	0	0	0	0
Type N	0	0	1	0

- Salmon Steelhead and Bull Trout (SSBT)
 - Opportunities to vacate or block new or existing roads and/or spurs will be considered during sale layout.
- Rock Sources for this operation:
 - Wildcat Stockpile
 - Are property line surveys required for this operation? ☒ No ☐ Yes
 - Is there planned new road construction planned within RCAs/HCA's? ☐ No ☒ Yes

VI. AQUATIC RESOURCES:

- Do any streams require additional review for the following?
 - Fish presence: ☒ No ☐ Yes
 - Perennial/Seasonal: ☐ No ☒ Yes
 - H.E.R.: ☐ No ☒ Yes

- There are streams within the sale that require additional review. Buffers shown on the map indicate where it is believed streams are located. These streams will be located, verified for permanence, and/or type of seasonal stream during sale layout and Geotech review and buffered as required.
2. Is a portion of the operation within an Aquatic Anchor? ☒ No ☐ Yes, name:
 3. Are any domestic points of diversion identified in the Oregon Water Resource Department's water rights information search GIS database located downstream within 3,000 feet of the harvest operation?
☒ No ☐ Yes, describe protection measures:
 4. Are there any unregistered or unknown status domestic points of diversion that have been identified within the harvest operation? ☒ No ☐ Yes, please describe:
 5. Is there a Stream Enhancement Project planned? ☒ No ☐ Yes, please describe:

VII. SLOPE STABILITY ISSUES:

Table 8. Summary of Slope Stability Assessment

Unit	Harvest Review Complete	Public Safety Review Complete	Additional Comment
1	Yes	No	-

Geotech Review: Initial geotechnical reviews will be completed prior to AOP approval. Some slope protections are dependent on further field review or on stream surveys that will be completed during sale layout. Consultation with the Geotechnical Specialist is required during sale layout and as streams surveys are completed in order to determine if additional protections are required.

VIII. RECREATION RESOURCES:

1. Recreation issues/coordination: ☒ No ☐ Yes, please describe:

IX. HISTORIC AND CULTURAL RESOURCES:

1. Has the sale been reviewed by a qualified archaeologist for potential historic or cultural resource presence? ☐ No ☒ Yes

X. SCENIC RESOURCES:

1. Are there scenic resources in the vicinity of this operation that need additional consideration?
☒ No ☐ Yes, please describe:

XI. OTHER RESOURCE CONSIDERATIONS:

1. Has a review of the FLMCS layer determined that any resources not mentioned in the report above need additional planning? ☒ No ☐ Yes, please describe:
2. Are there any other resources present that need additional consideration? ☐ No ☒ Yes, please describe:
 - **Adjacent Landowners (shared property lines):**
 - Private Landowner, Private Industrial:
 - District staff will work with adjacent private landowners to determine what additional outreach is needed during the sale process and if any additional restrictions are needed.

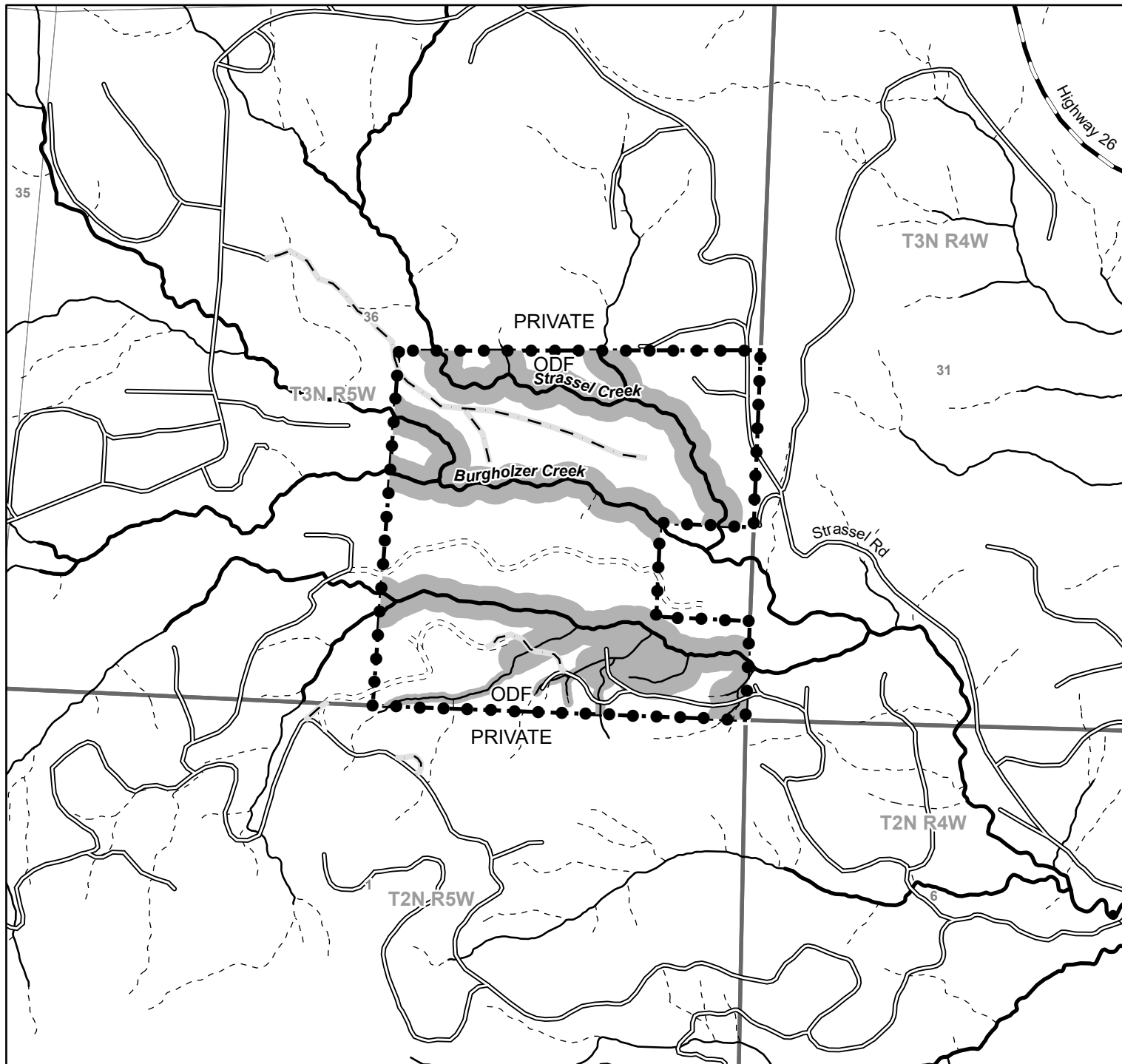

Legend

- ● Sale Boundary
- No Harvest Area
- Gates
- New Road Construction
- Paved Roads
- Surfaced Roads
- - - - Unsurfaced Roads
- Perennial Fish Streams
- Perennial Non-Fish Streams
- - - - Seasonal Streams
- Ownership Boundary

FY 2026 - Forest Grove District Three Divides Portions of Section 36, T3N, R5W, W.M. Washington County

Unit 1 77 acres (CC)

State Forest Division
02/07/2025

This product is for informational use and may not be suitable for legal, engineering, or surveying purposes. Variations may exist between and among data sets in use by the Department of Forestry. This map was developed using the Statewide Stream Layer.

1:12,000
1,000 500 0 1,000 Feet

