

## Pre-Operations Report

**Operation Name:** Lone Corndog

**County (%):** Klamath (100%)

**Elevation:** 4,449 - 4,757 ft

**Legal Description:** T32S R7.5E, Section(s) 17, 18, 19, 20

**Tax Code(s):**

**BOF%:** 100% **CSL%:** 0%

**Sale Quarter:** 4

### I. VOLUME AND VALUE SUMMARY

**Table 1. Types, Acres, and Value**

Unit	Harvest Type	Anticipated Product <sup>c</sup>	Gross Acres	Net Acres	MBF/ Acre <sup>a</sup>	MBF/ Unit <sup>a</sup>	\$/MBF <sup>b</sup>	\$ / Unit
1	PC-R	PP-S, WF-S	752	752	3.7	2,782	\$125	\$347,750
Total		Regeneration	0	0				
		Partial Cut	752	752		2,782		
						Gross Value		\$347,750
a. Estimated harvest volume per acre for Unit.						Project Costs		\$28,000
b. Estimated 'price' (excluding Project Costs)						Net Value		\$319,750
c. Anticipated Product (AA-B-C) – AA) SLI species code of the bid species, B) Size Class (S – small [average DBH < 15], M – medium [average DBH 15 to 23], L – large (average DBH > 23]), C) Special Product (P – Premium, H – Hardwood)								

### II. CURRENT STAND CONDITION:

**Table 2. Stand Inventory Information**

Unit	Stand ID	Measured/Imputed <sup>a</sup>	Species	Age	TPA	DBH	BA	SDI	Net Acres <sup>a</sup>
1	40100	M	WF,PP	95	84	15	99	26%	112
1	40101	M	PP,WF	95	120	14	122	33%	379
1	40103	M	PP,WF	95	121	15	145	38%	251
1	40104	I = 99999	PP,WF	95	--	--	--	0%	8

- a. Identify the source of stand inventory information. Use the following codes: M = Measure SLI data, I = Imputed SLI data, P = Pre-Cruise Plots, O = other (if other, describe below).
- b. Net Acres have been rounded to the nearest whole acre in this table. Stand that comprise less than one acre of a harvest unit are not reported in this table, so the total "Net Acres" per unit in this table may not equal the total "Net Acres" per unit in table 1.

**Table 3. Additional Stand Information**

Unit	Stand ID	Snags/Acre <sup>a</sup>	Down Wood/Acre <sup>b</sup>	Forest Health		
				SNC	Phellinus	Other <sup>c</sup>
1	40100	0	14	--	--	--
1	40101	1	274	--	--	--
1	40103	2	277	--	--	--
1	40104	0	0	--	--	--

- a. Identify the number of hard snags per acre (decay classes 1 and 2)
- b. Identify the cubic feet per acre of hard down wood (decay classes 1 and 2)
- c. Describe "Other" forest health issue.

- Where feasible, opportunities for snag creation of small to medium diameter trees will be assessed during sale layout.

III. WILDLIFE AND T&E SPECIES CONSIDERATIONS:

Foresters need to request the Biological Survey Tracking Form (BSTF) from the ODF Wildlife Biologist prior to sale layout in order to ensure all T&E related information is complete and understood.

- 1. A portion of the operation is within a NSO Circle or Home:  
☒ No    ☐ Yes, BA required
- 2. Are Surveys for NSO being conducted for any portion of this operation?  
☒ Yes    ☐ No    ☐ Density surveys
  - Note: Two year NSO monitoring surveys done every 5 years with surveys scheduled for 2024 and 2025. No operational surveys required with long range plan.
- 3. Are there any additional considerations (FPA Resource Sites, Species of Concern sites/Plants [from ORBIC<sup>1</sup>])?  
☐ No    ☒ Yes, please describe:
  - Sun Creek, which contains Bull Trout, is immediately adjacent to the sale area but is outside the harvest boundary. There may be potential for stream enhancement by adding large wood to Sun Creek along the eastern border of the sale. The “SOC Plants” layer indicates the possible presence of “Crater Lake rock-cress” along the northern and southern boundaries of sale area. This is currently listed as species of concern and has no legal protection requirements at this time.

IV. PROPOSED MANAGEMENT PRESCRIPTION AND PROPOSED OUTCOME:

Table 4. Partial Cut Prescription (Complete only for Partial Cut Harvests)

Unit	Harvest Type	Harvest Species	Residual			
			Species	TPA	BA	% SDI
1	PC-R	PP WF	PP WF	40	70	--

- **Prescription Considerations:**
  - Harvest in this area is intended to reduce stocking levels while retaining the uneven aged characteristics of the stand. Trees will be individually selected for removal across all age classes. Group selection cuts may be incorporated into the marking prescription if neccessary. Groups will be limited to 2-5 acre patches not to exceed 10% of the total sale area. Highly defective trees will be marked reserved in order to provide snags and down wood for wildlife habitat.
- **Reforestation Considerations:** Post-harvest the group selects will be planted with ponderosa pine. Interplanting of understocked areas will occur as well if needed. The remaining stand will be grown forward with another entry anticipated in approximately 20 years.

<sup>1</sup> Oregon Biodiversity Information Center  
Klamath Lake District  
Draft - April 2025

## V. HARVESTING AND ACCESS CONSIDERATIONS:

**Table 5. Harvest System and Access Summary**

Unit	Harvest System		Slope (%)	Area Access	Seasonal Access
	% Cable	% Ground			
1	0	100	<35	Established	All Weather

1. Haul Route: Hauling will be on the 2 and 3 roads.
  - This sale area is behind locked gates. The closure is from November 6<sup>th</sup> through July 1<sup>st</sup>. Keys area available from the district office.
2. Haul Route Condition: Hauling will occur on the 2 and 3 roads. The 2 road and portions of the 3 road are unsurfaced with the remainder of the 3 road being rocked. All are suitable for all weather hauling.
3. Are easements required for the haul route? ☐ Yes ☒ No

**Table 6. Transportation Management Summary (Miles)**

Activity	Mainline	Collector	Rocked Spur	Dirt Spur
Construct	0	0	0	0
Improve, Rock, and/or Maintain	3	0	0	3
Vacate	0	0	0	0
Stream Crossings to install existing (IE)/replace (R)/new construction (NC)				
Type F - SSBT <sup>a</sup>	0	0	0	0
Type F – Non-SSBT	0	0	0	0
Type N	0	0	0	0

4. Rock Sources for this operation: Rock will be purchased from a local weed-free vendor.
5. Are property line surveys required for this operation? ☐ Yes ☒ No

## VI. AQUATIC RESOURCES:

1. Do any streams additional review for the following?
  - Fish presence: ☒ No ☐ Yes
  - Perennial/Seasonal: ☒ No ☐ Yes
2. Are any domestic points of diversion identified in the Oregon Water Resource Department's water rights information search GIS database located downstream within 3,000 feet of the harvest operation?  
☒ No ☐ Yes, describe protection measures:
3. Are there any unregistered or unknown status domestic points of diversion that have been identified within the harvest operation? ☒ No ☐ Yes, please describe:
4. Is there a Stream Enhancement Project planned? ☐ No ☒ Yes, please describe:

Opportunities for stream enhancement including adding large wood into Sun Creek will be investigated with the Aquatic and Riparian Specialist and district staff during sale layout.

## VII. SLOPE STABILITY ISSUES

Table 7. Summary of Slope Stability Assessment

Unit	Harvest Review Completed?	Public Safety Review Complete?	Additional Comment
1	Yes	Yes	

- Geotechnical reviews have been completed. Additional consultation with Geotechnical Specialists will be done during sale layout as needed.

## VIII. RECREATION RESOURCES:

1. Recreation issues/coordination: ☒ No ☐ Yes, please describe:

## IX. HISTORIC AND CULTURAL RESOURCES:

1. Has the sale been reviewed by a qualified archaeologist for potential historic or cultural resource presence?  
☐ Yes ☒ No
- Cultural Resource Review will be conducted prior to sale layout

## X. SCENIC RESOURCES:

1. Are there scenic resources in the vicinity of this operation that need additional consideration? ☒ No ☐ Yes, please describe:

## XI. OTHER RESOURCE CONSIDERATIONS:

1. Has a review of the FLMCS layer determined that any resources not mentioned in the report above need additional planning? ☐ No ☒ Yes, describe below
  - The FLMCS layer indicates that this sale area is within the “Sun Creek Cooperative Road Closure” area. Roads will be closed from November 1st through June 30th of each year to reduce harassment to calving elk.
2. Are there any other resources present that need additional consideration? ☒ No ☐ Yes, please describe:

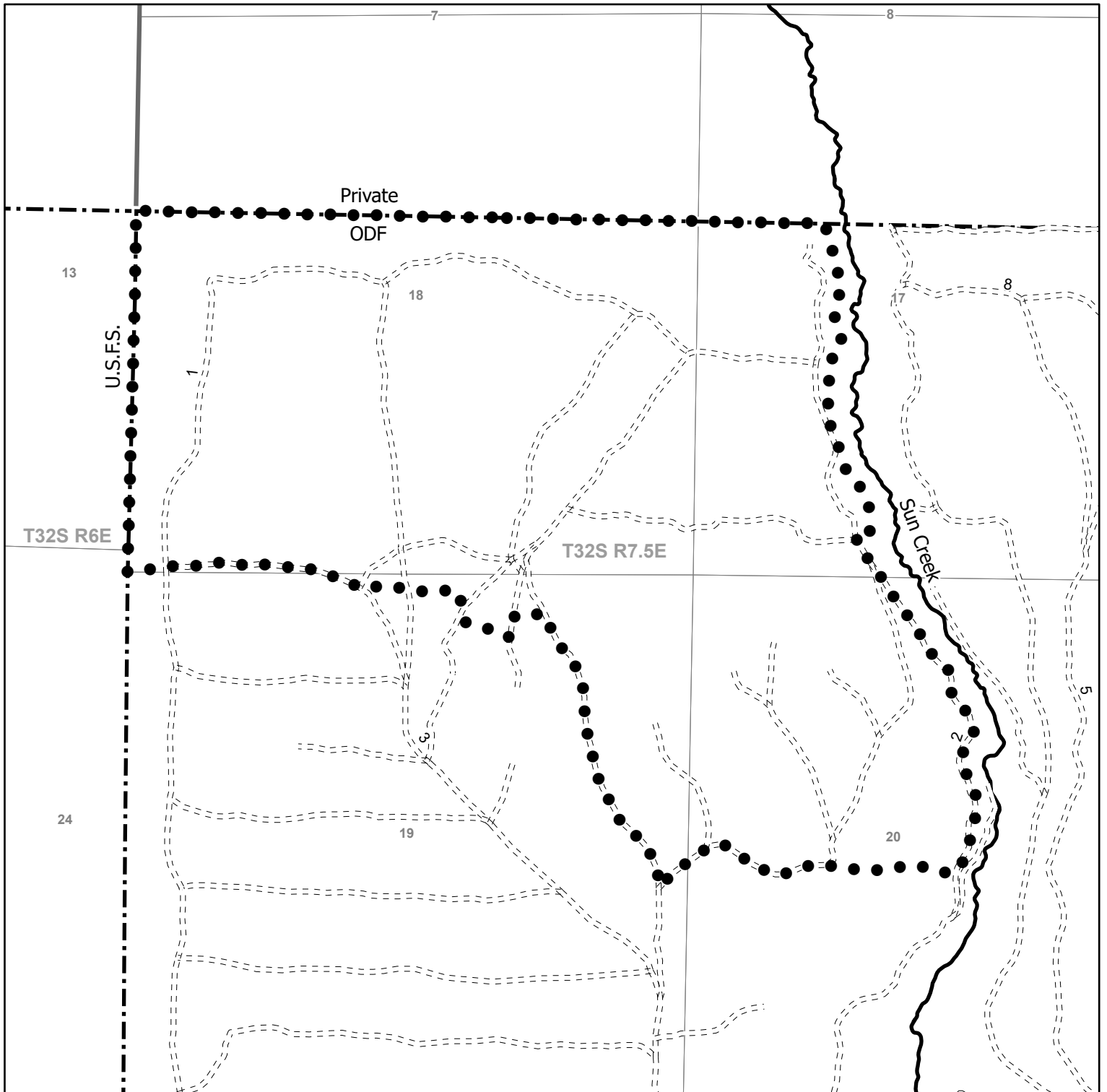

**FY 2026 - Klamath-Lake District  
Lone Corndog  
Portions of Section(s) 24, T32S, R6E & 17, 18, 19, 20, T32S, R7.5E, W.M.  
Klamath County**

**Legend**

- ● Sale Boundary
- Ownership Boundary
- Unsurfaced
- Perennial Fish

State Forest Division  
11/15/2024

This product is for informational use and may not have been prepared for or be suitable for legal, engineering or survey purposes. Variations may exist between and among data sets in use by the Department of Forestry. This map was developed using the Statewide Flow Line layer layer.

Unit 1    752    Acres (PC)

Total    752    Acres

1:15,800

1,000   500   0   1,000 Feet

