

NW Corner: J-box may be impacted by ramp improvements and mast arm pole and driveway limit longitudinal placement. Creates potential for rewire of north side of intersection.

SIGNAL PLAN
HANCOCK AT N. HOWARD ST.
HWY. 1W MP. 23.56

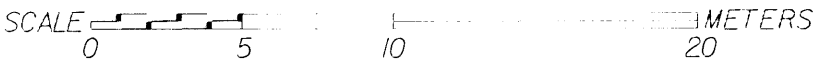

LEGEND

- (C) 332 Install model 170 controller in model 332 cabinet with riser frame, orient front(louvered) door as shown
- (MP) X Install special (non-standard) traffic signal mast arm pole
- (MPL) T Install type (T) standard traffic signal mast arm pole with luminaire pole extension (12.2 meter mounting ht.)
- (MPL) X Install special (Non-standard) traffic signal mast arm pole with luminaire pole extension (12.2 meter mounting ht.)
- (MA) L Install (L) meter traffic signal mast arm
- (LA) L Install (L) meter luminaire arm
- (PP) Install pedestrian signal pedestal with frangible base
- (RPS) Install remote power service post
- (V) Ph Install phase (Ph) vehicle signal with LED's
- (P/B) Ph Install phase (Ph) pedestrian signal with LED's, pushbutton and instruction decal
- (AL) 1L Install aluminum (762 mm x 914 mm, type "W7") "ONE WAY" left arrow sign (Type A, Diamond grade sheeting)
- (AL) 1R Install aluminum (762 mm x 914 mm, type "W7") "ONE WAY" right arrow sign (Type A, Diamond grade sheeting)
- (TC) Install terminal cabinet
- (SCL) T Install service cabinet, 120 volt, for both signal and illumination circuits
- (MS) T Install 120 volt meter base
- (JB) 2 Install 560 mm x 305 mm x 305 mm (min. dimension) precast concrete junction box
- (JB) 3 Install 760 mm x 430 mm x 305 mm (min. dimension) precast concrete junction box
- (N-C) Install (N) No. 8 type THWN (Signal system common)
- (N-G) Install (N) No. (G) type THWN wires
- (N-G) Install (N) No. (G) type XHHW wires
- (PL) Install poly pull line (1 kn min-strength)
- (3) Ph Includes 3 spare wires for phase (Ph) as per table
- (S) Install (S) mm electrical conduit
- (DC) Detector conduit (See Detector Plan)
- (IC) Interconnect conduit (See Interconnect Plan)

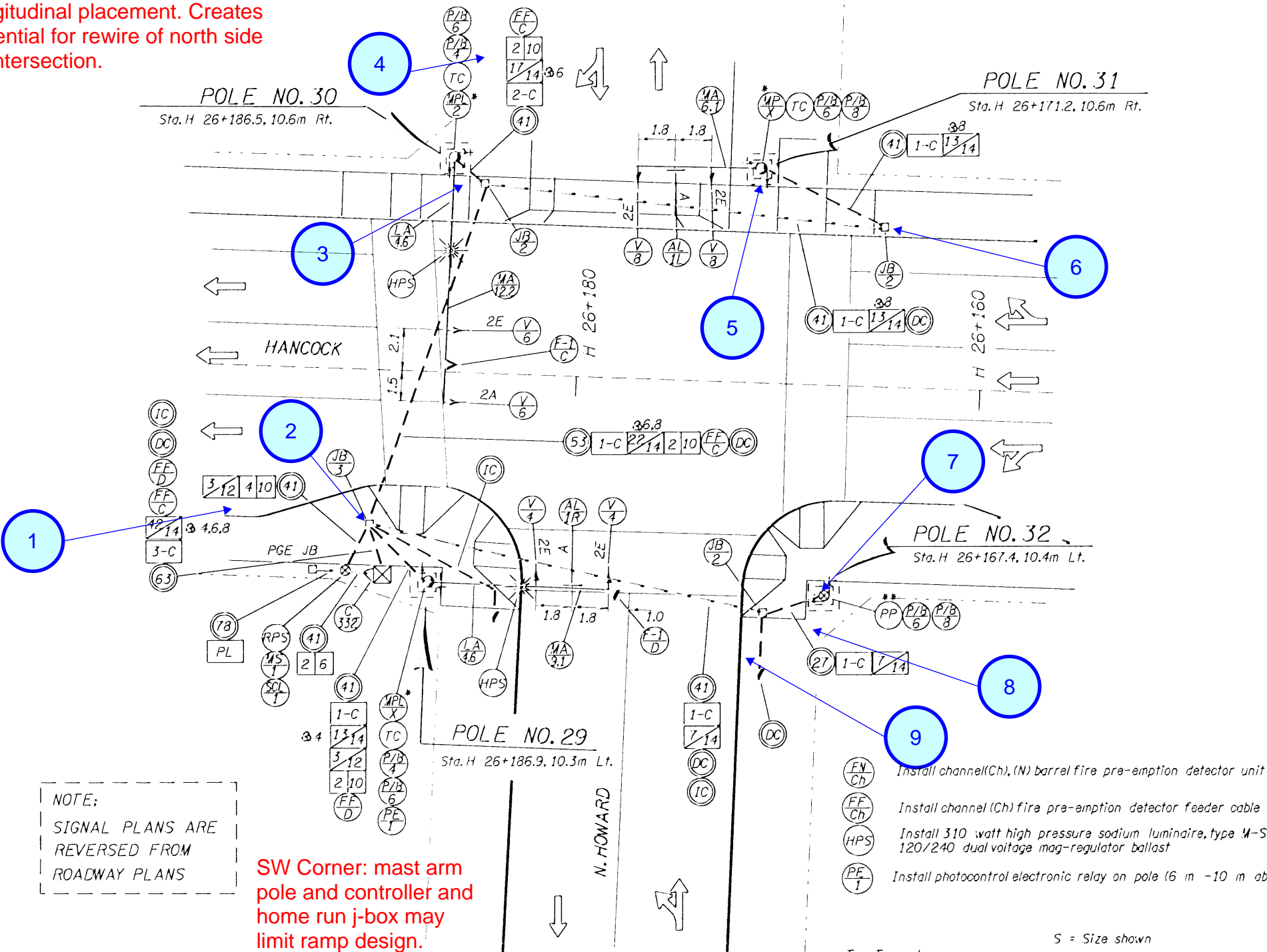

NOTE:
SIGNAL PLANS ARE
REVERSED FROM
ROADWAY PLANS

SW Corner: mast arm
pole and controller and
home run j-box may
limit ramp design.

POLE ENTRANCE CHART

Pole No.	29	30	31	32
Luminaire Arm	5	7	1	-
Mast Arm	5	7	1	-
Terminal Cabinet	1	3	5	-
Pedestrian Signal Clam Shell	1/7	1/3	3/5	5/7

T = Type shown
L = Length shown
Ph = Phase shown
N = Number shown
G = AWG size shown
S = Size shown
Ch = Channel shown
A = Standard plumbizer
E = Elevator plumbizer
2 = 305 mm R, 305 mm Y, 305 mm G

Note:
Field verify pole locations.
(Stations and offsets are approximate.)
* Flat Black pole with ornamental base shoe.
** Flat black pole and appurtenances.

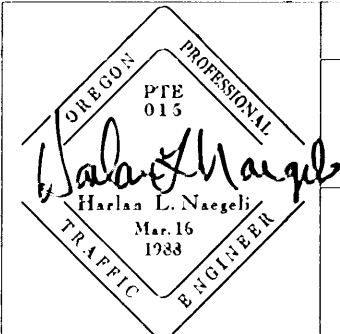

OREGON DEPARTMENT OF TRANSPORTATION
TRAFFIC MANAGEMENT SECTION
TRAFFIC SIGNAL INSTALLATION
BRUTCHER ST. - EVEREST ST. &
EVEREST ST. - MAIN ST. (NEWBERG) SECS.
PACIFIC HIGHWAY WEST
YAMHILL COUNTY

DATE November 2000
DESIGNED BY: H. Naegeli
CHECKED BY: T. Jenkins
DRAWN BY: H. Naegeli

Exp. 12/31/2002

A5

05602tr3.sg2

T.J.S. C.W.G. NO. 12274



DETECTOR PLAN
HANCOCK AT N. HOWARD ST.
HWY. 1W MP. 23.56

SCALE 0 10 20 40 METERS

LEGEND

- (C) Controller (See Signal Plan)
- (JB/SP) Junction box (See Signal Plan)
- (JB/1) Install 440 mm x 265 mm x 305 mm (min. dimension) precast concrete junction box
- (SP/5) Install 150 mm max. sand pocket block-out with (S) mm conduit to junction box
- (LD/Ph) Install phase (Ph) 1.2 m diamond vehicle detector loop
- (LB/Ph) Install phase (Ph) 0.7 m diamond bicycle detector loop
- (LF/X-Ph) Install (X) phase (Ph) loop feeder cables
- (N/LW) Install (N) pair of loop wires
- (S) Install (S) mm electrical conduit
- (EC) Electrical conduit (See Signal Plan)
- (IC) Interconnect conduit (See Interconnect Plan)

Ph = Phase shown
X = Number of cables shown
N = Number shown
S = Size shown

NOTE:
SIGNAL PLANS ARE
REVERSED FROM
ROADWAY PLANS

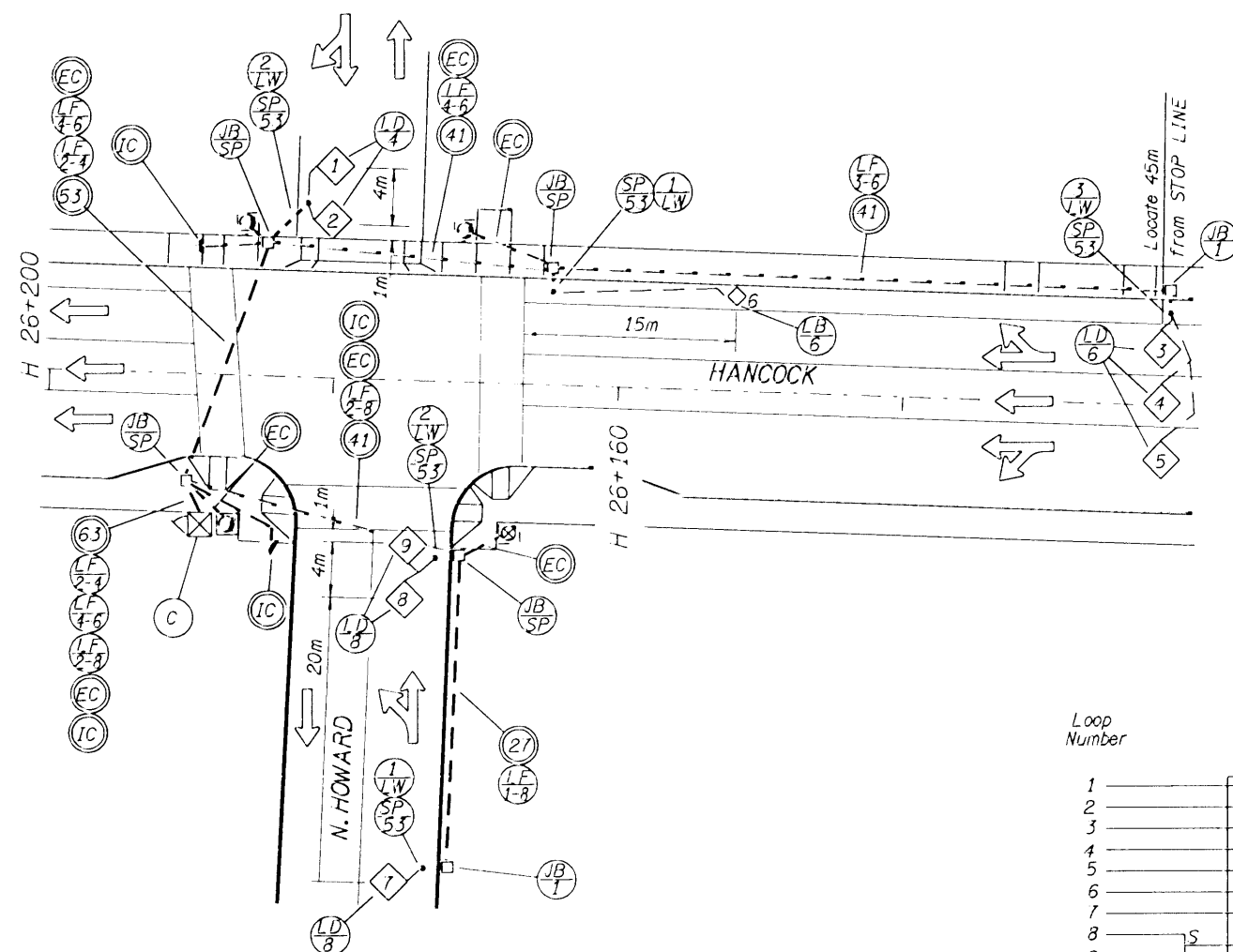

Loop Number	Phase	Function	Slot
1	4	E.C.	I6U
2	4	E.C.	I6L
3	6	E.C.	J2U
4	6	E.C.	J2L
5	5(6)	E.C.	J5U
6	6	E.C.	J3L
7	8	E.C.CO	J6U
8	8	E.C.	J6L
9	S		

Transfer to J3U
Controller Cabinet

LOOP DETECTOR WIRING DIAGRAM

S = Series, E=Extension, C=Call, CO=Carry-over.
See T.M.S. Drwg. No. TM408 for loop detector details
Center all loops in travel lanes or as shown on plan

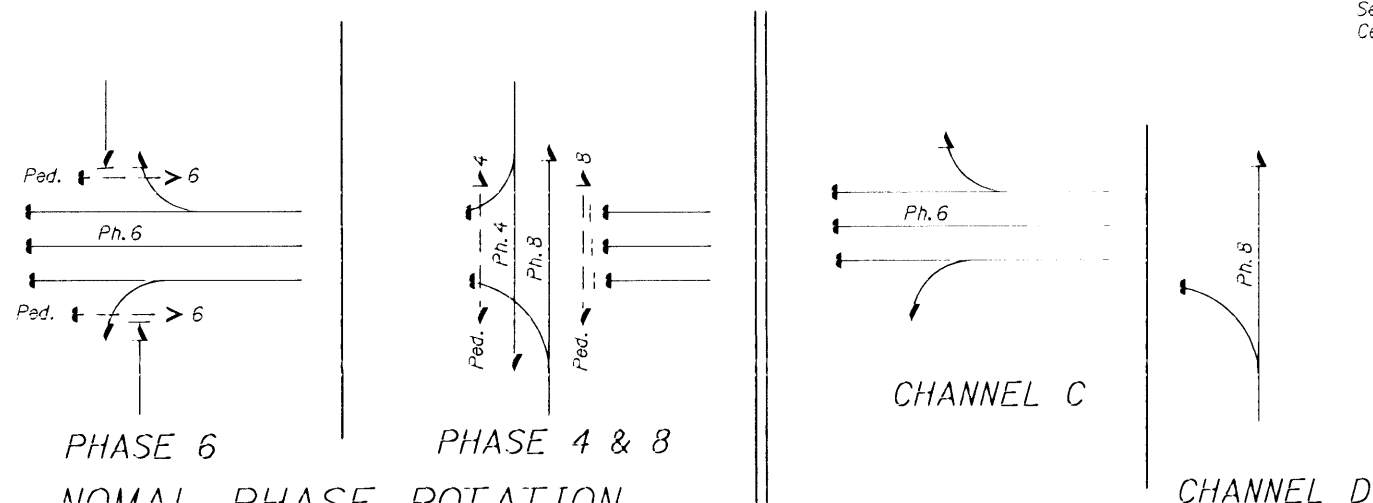

(State furnished program)

FIRE PRE-EMPTION OPERATION

	OREGON DEPARTMENT OF TRANSPORTATION TRAFFIC MANAGEMENT SECTION	
	TRAFFIC SIGNAL INSTALLATION BRUTCHER ST. - EVEREST ST. & EVEREST ST. - MAIN ST. (NEWBERG) SECS. PACIFIC HIGHWAY WEST YAMHILL COUNTY	
	DATE: November 2000	
	DESIGNED BY: H. Naegeli	
	CHECKED BY: T. Jenkins	
	DRAWN BY: H. Naegeli	
Exp. 12/31/2002	B5	05602tr3.sg2

T.M.S. DRG. NO. 12275