

NW Corner: Grades are an issue on this corner.

Water meter is within sidewalk. See photo 7.

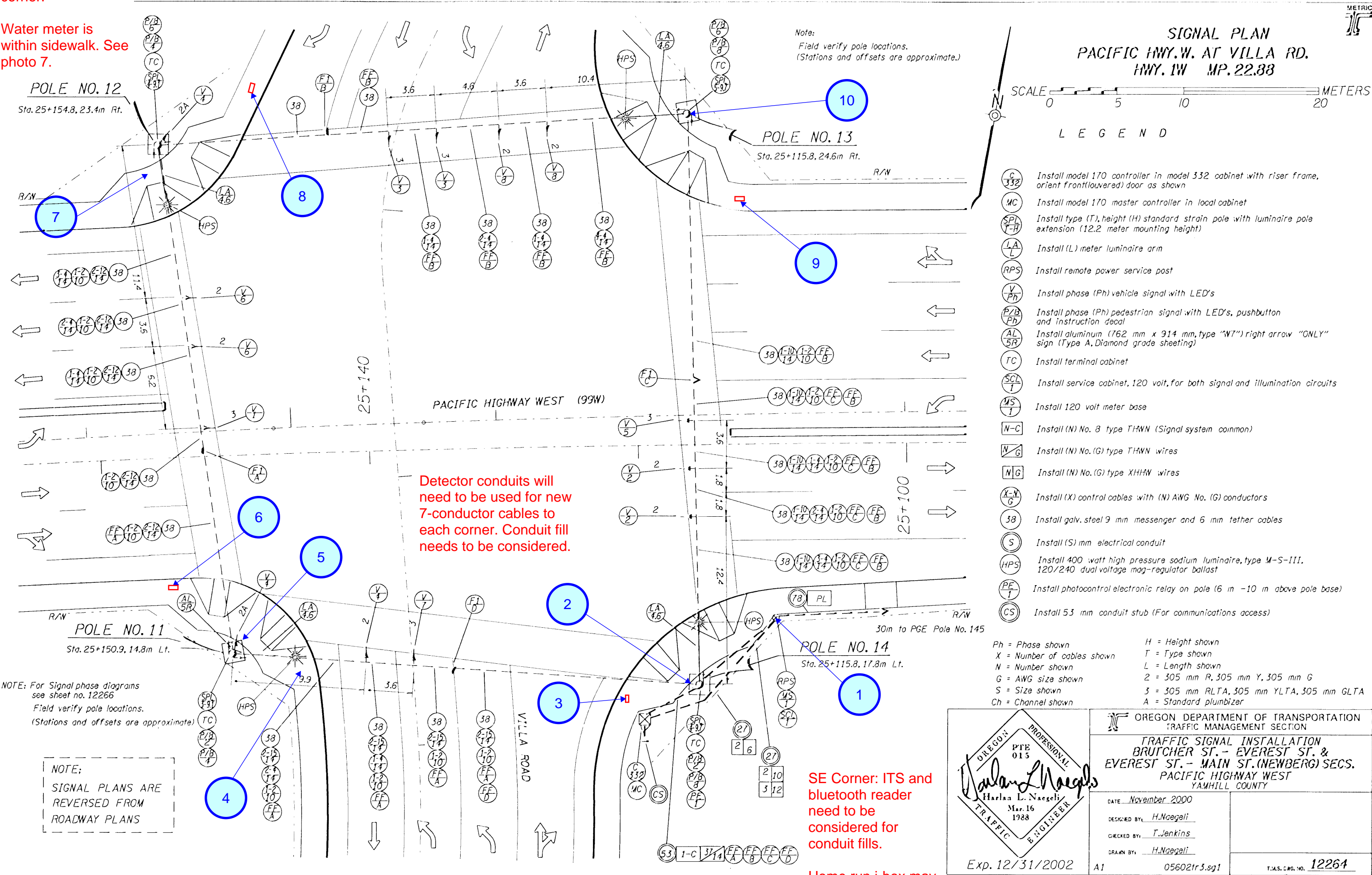



DETECTOR PLAN
PACIFIC HWY.W. AT VILLA RD.
HWY. 1W MP.22.88

SCALE 0 10 20 40 METERS

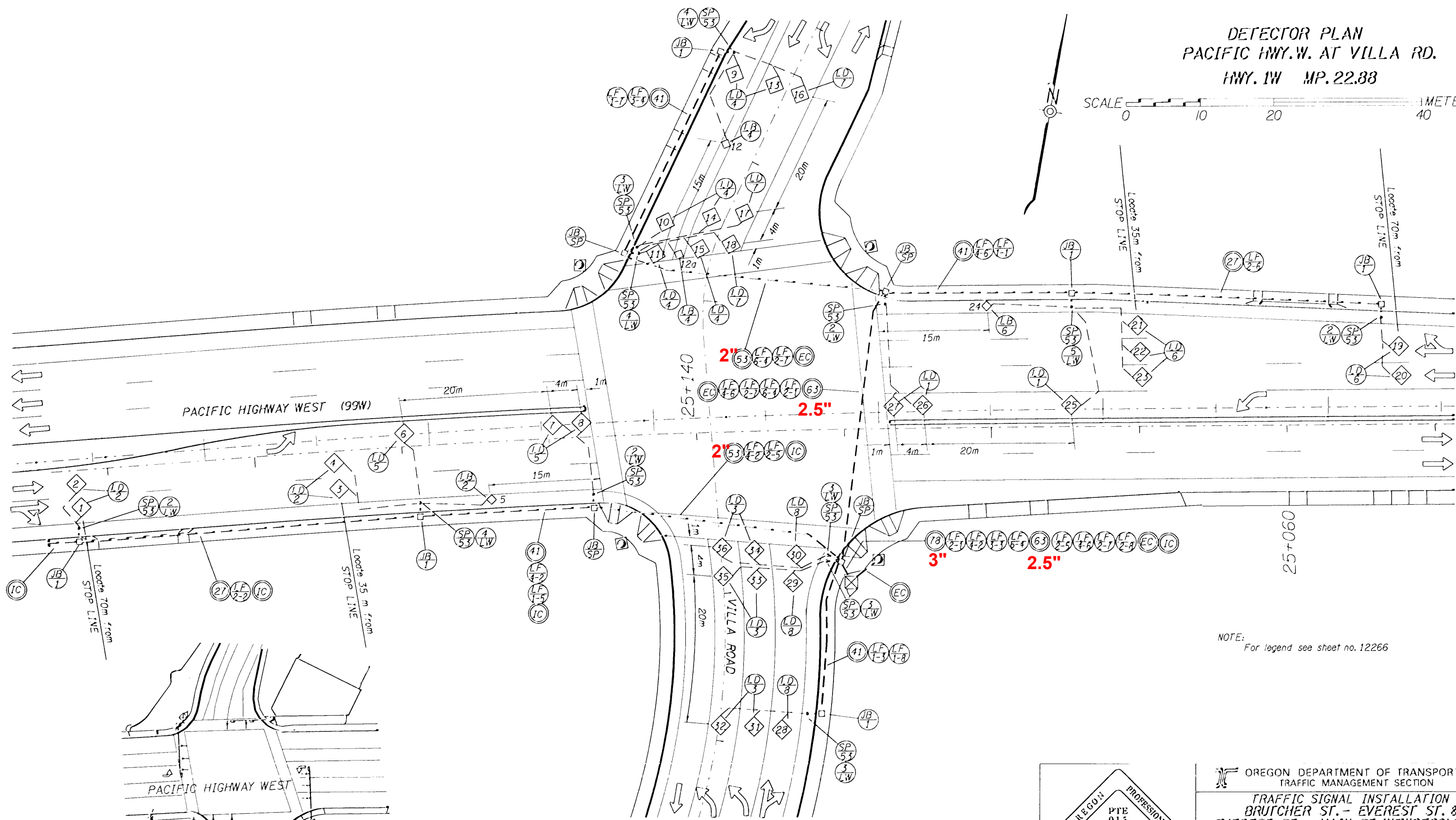

NOTE:
For legend see sheet no.12266

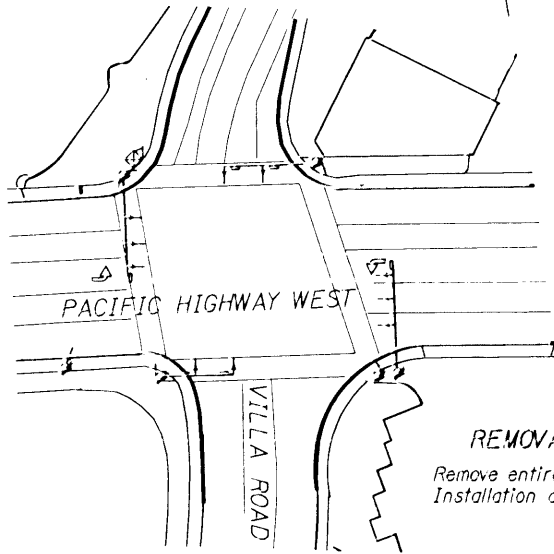

REMOVAL PLAN
Remove entire existing Traffic Signal
Installation and all appurtenances.

NOTE:
SIGNAL PLANS ARE
REVERSED FROM
ROADWAY PLANS

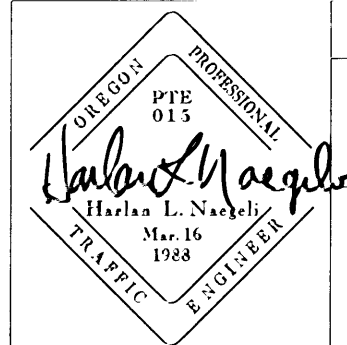

OREGON DEPARTMENT OF TRANSPORTATION
TRAFFIC MANAGEMENT SECTION
TRAFFIC SIGNAL INSTALLATION
BRUTCHER ST. - EVEREST ST. &
EVEREST ST. - MAIN ST. (NEWBERG) SECS.
PACIFIC HIGHWAY WEST
YAMHILL COUNTY

DATE November 2000
DESIGNED BY H.Naegeli
CHECKED BY T.Jenkins
DRAWN BY H.Naegeli

B1 056021r3.sg1 T.A.S. C.W.G. NO. 12265