

Unit 3 Lesson 1: Corner and Curb Ramp Position Numbering



Course Navigation Tips:

- To complete each lesson, you must interact with the audio narration at the top of each section.
- You may drag the toggle on the playback bar to the last 5 seconds and let it play. This will allow the system to note it as complete.
- You are encouraged to complete the entire unit before closing in case your progress is not saved.



You must click on all images before moving on to next Lesson.



01:35

Start Audio Narration

To keep track of inventoried curb ramps along the State Highway System, a curb ramp numbering methodology was developed to give a unique identifier to each ODOT Curb Ramp. Each Curb Ramp has a corner number and a curb ramp number that is attached to a Highway Number and Highway Mile Point. The methodology for describing corner and curb ramp positions is specific to ODOT for inventory and inspection purposes.

To understand how the corner and curb ramp positions are assigned, see Exhibit A in link below. Exhibit A can also be found on the Roadway Assets & Inspection website.

Roadway Assets & Inspection Website

WEBSITE

Exhibit A

Refer to Exhibit A when numbering a new intersection.

EXHIBIT A

If the intersection is complex or if there is a question on determining the correct numbering, contact the ADA Inventory Team through the ODOT Standards email.

EMAIL

Scroll through both pages of Exhibit A below.

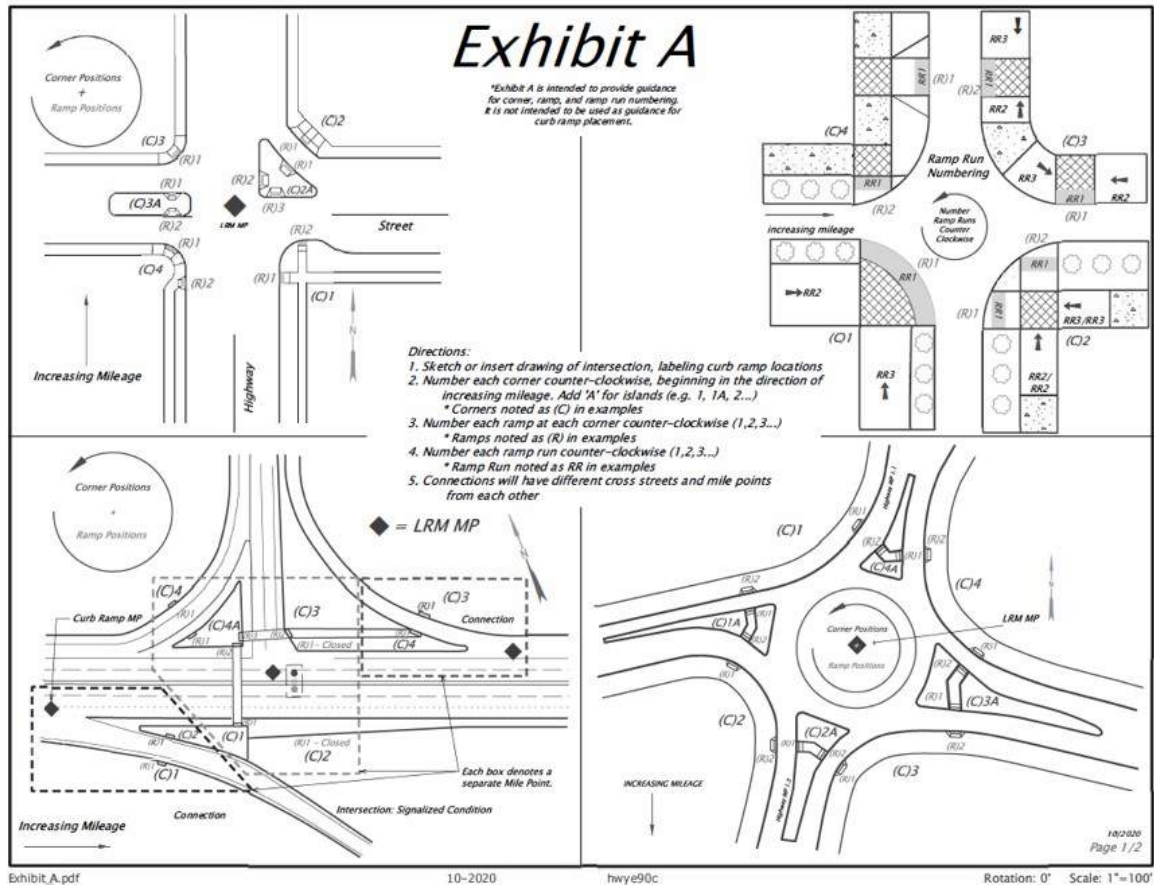
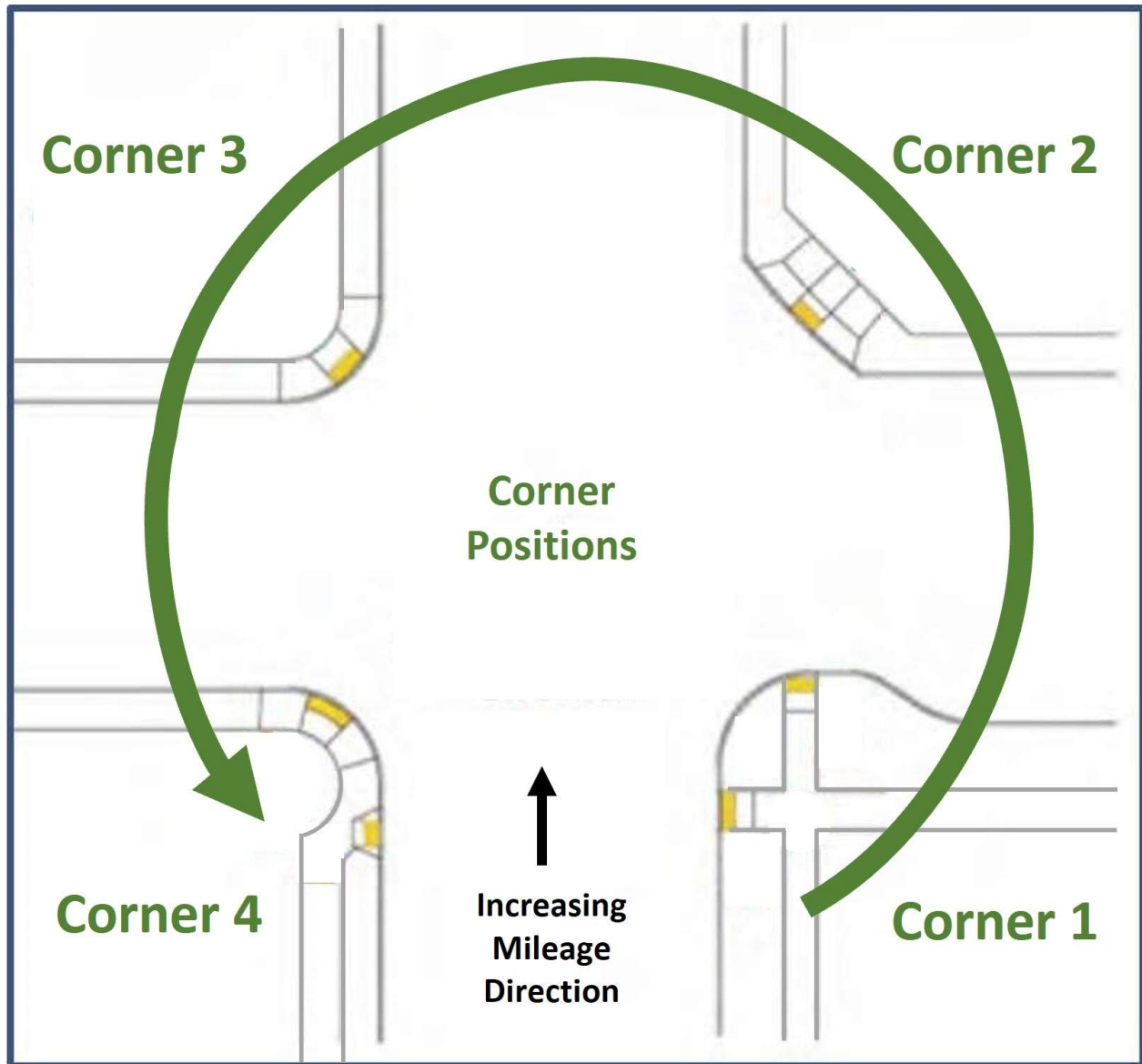

Exhibit A: Curb Ramp Location and Numbering, Page 1

north or from left to right. For example, I-5 increases south to north but US101 increases north to south.



Counter-Clockwise Corner Numbering Scheme

Corner Position Numbering

Corner position values are assigned at intersections with other roads on or along the State Highway.

Corner numbering is based on the increasing mile point direction. Corner position 1 is always located at the

first corner on the right as you move in the direction of increasing mile points. Subsequent corner positions are numbered sequentially in a counterclockwise manner.

All corners of an intersection are to be tied to the same mile point.

In the example on the right, corners 1 through 4 are tied to mile point 8.41 in the middle of the intersection. Do not use other mile point numbers that are closest to the curb ramps, such as 8.4 for corners 1 and 4 or 8.42 for corners 2 and 3.

Note: Increasing mile points in the image are from top to bottom.

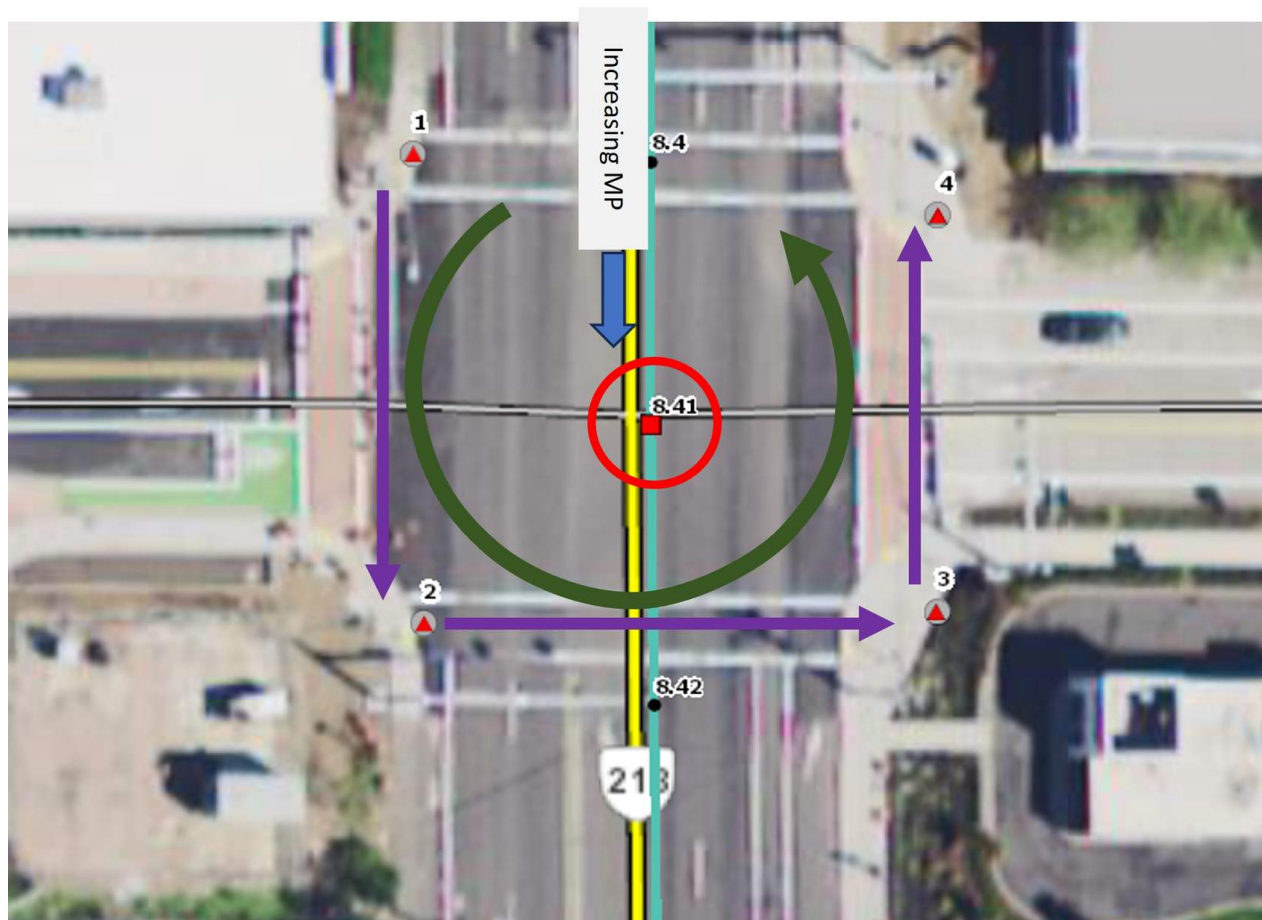
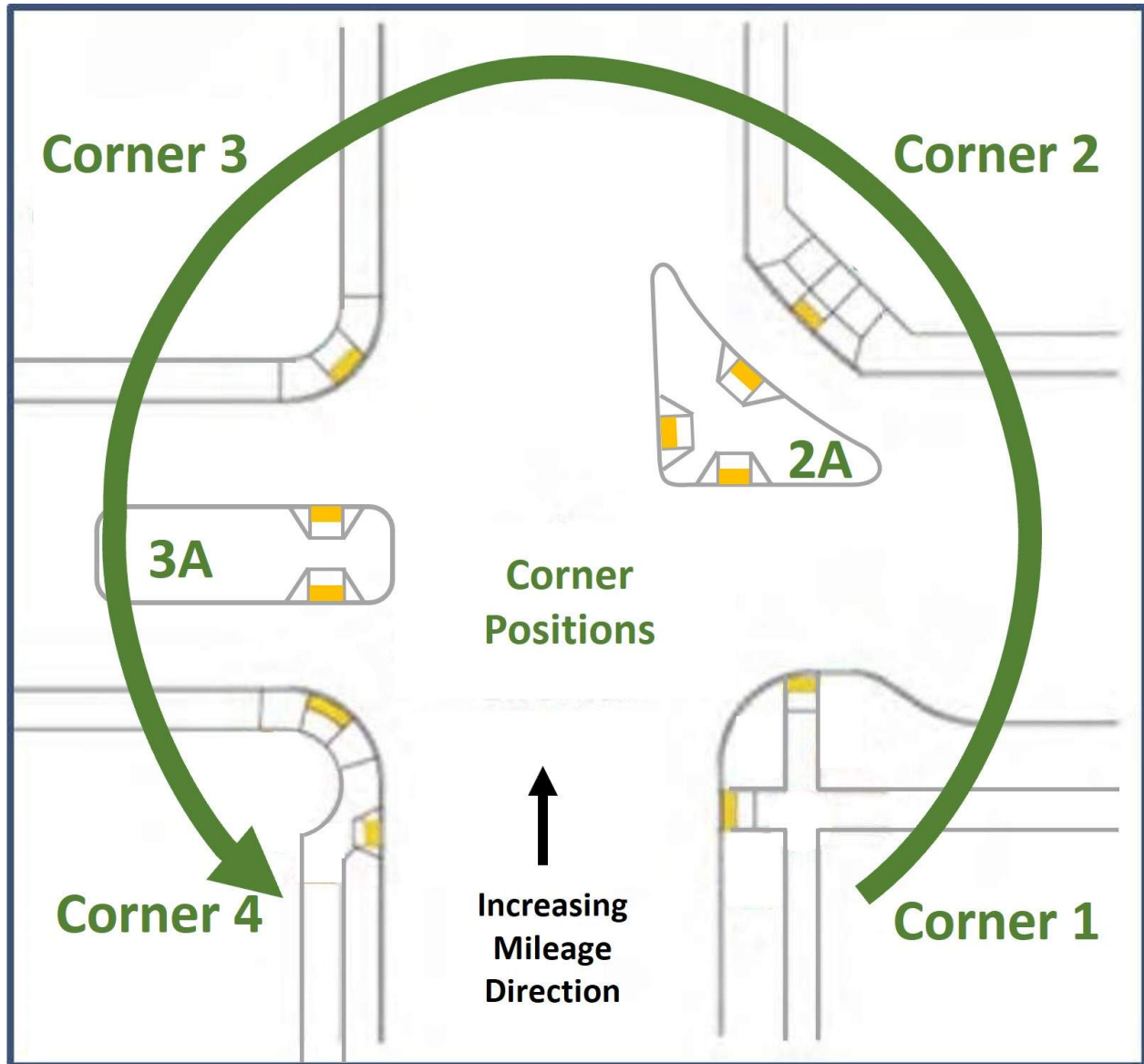

Illustration Showing Intersection Mile Point 8.41 and Associated Corners



00:29

Start Audio Narration



Corner and Island Numbering

Islands

Islands are tied to the corner they are associated with. If it is a median island, it will take the number plus A of the corner just passed counterclockwise. If it is a right turn slip lane island, it will be associated with the corner it crosses the slip lane with. Refer to image on the left.



There can be up to 8 (1-8) corners and 8 (1A-8A) islands per intersection.



01:00

Continue Audio Narration

Midblock Crosswalks

If there is an island located midblock, and not at an intersection, use the closest mile point to the crosswalk. Review Page 2 of the Exhibit A showing corner numbering conventions. Midblock crossing corner numbering is always Corner 1 or Corner 4 based on increasing mileage on the highway.

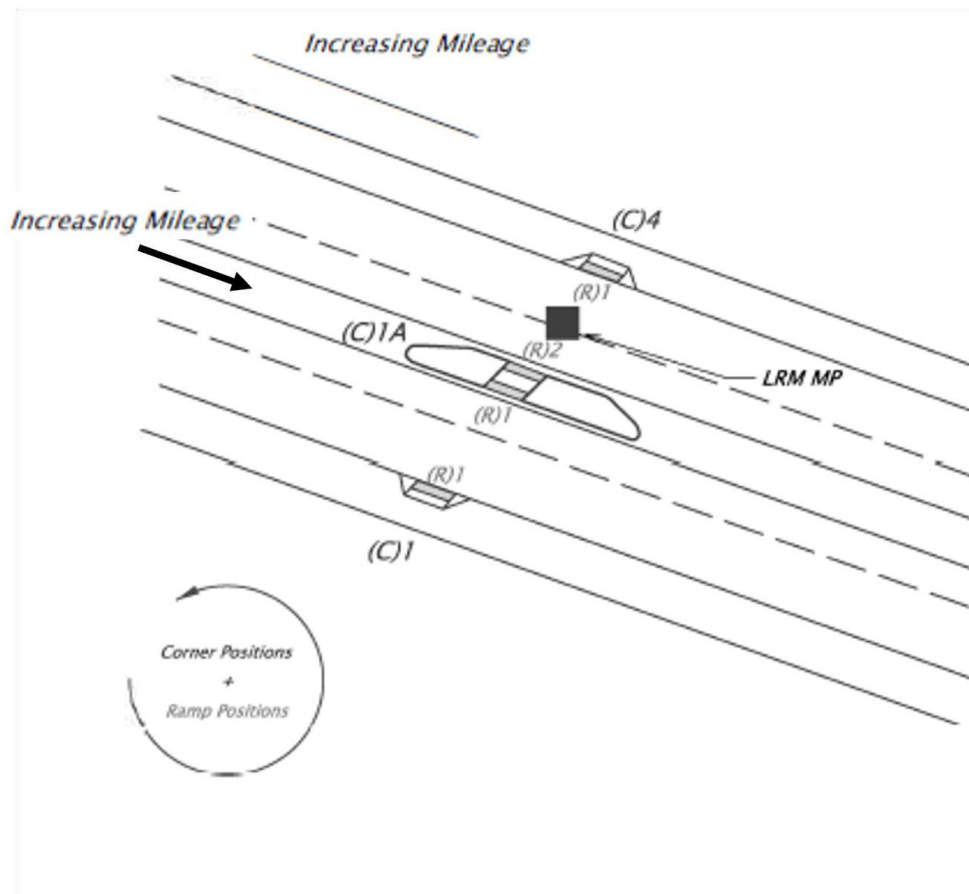

Midblock Crossing "Corner" Numbering from Exhibit A

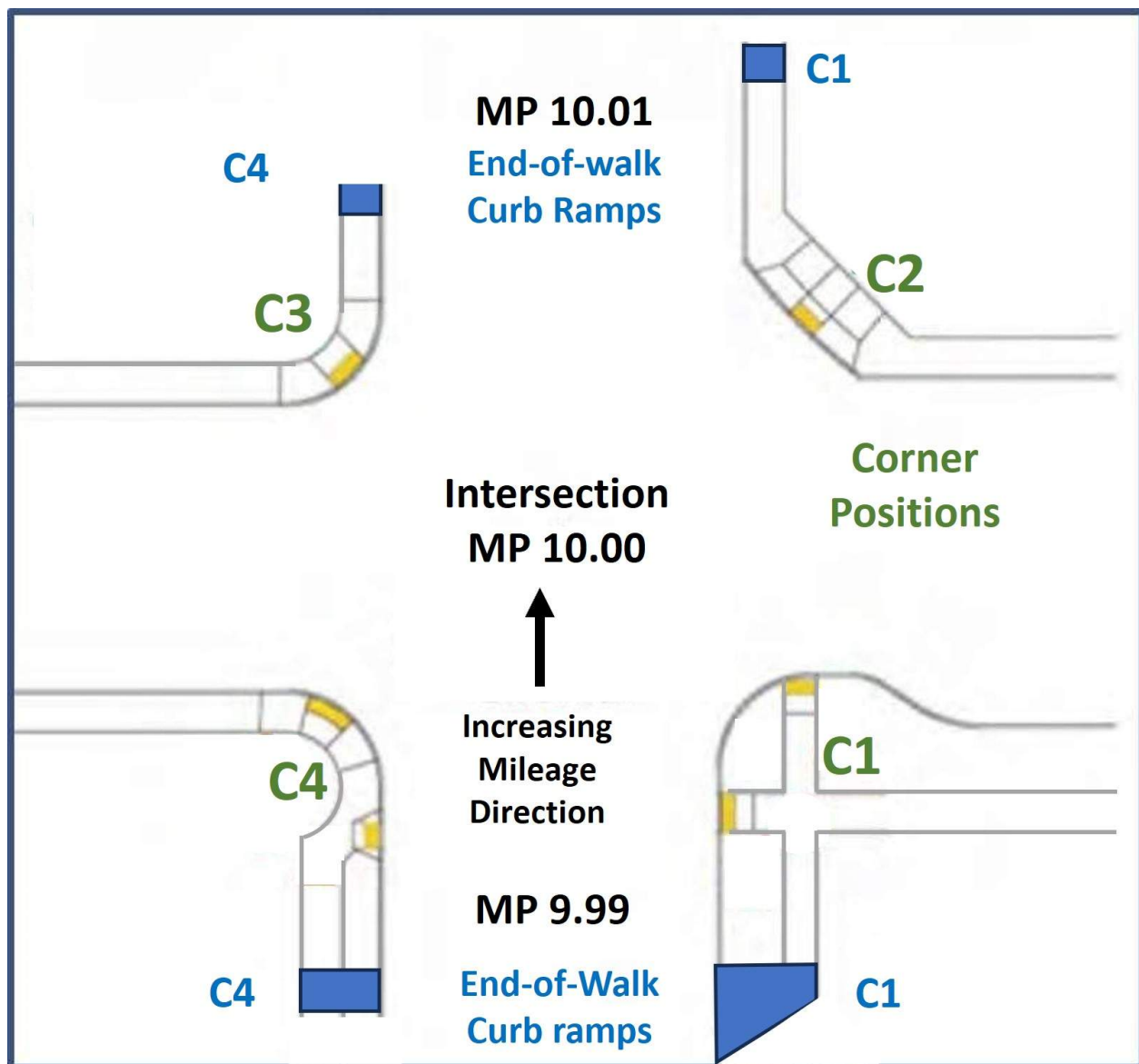

End-of-Walk "Corner" Numbering Example

End-of-Walks

Like midblock crosswalks, end-of-walks are located midblock and can only be corner 1 or 4 depending if they are on the increasing or decreasing side. Do not designate curb ramps at driveway entrances or intersections as end-of-walks.

In the illustration on the left, notice the end-of-walk ramps on either side of the intersection are either Corner 1(C1) or Corner 4 (C4). The mile points used for the end-of-walk are the ones that are closest to the ramps, MP 9.99 and MP 10.01.



When Two Highways Intersect

When an intersection is located where two different highways intersect, the highway with the lower number takes precedence. The exception to the rule is highways 081 and 091 which take precedence over other highways.

Gore Points

For curb ramps on off and on ramps at interchanges, the gore point is used as the mile point, as shown in the image below. Review Page 2 of the Exhibit A showing corner numbering conventions.

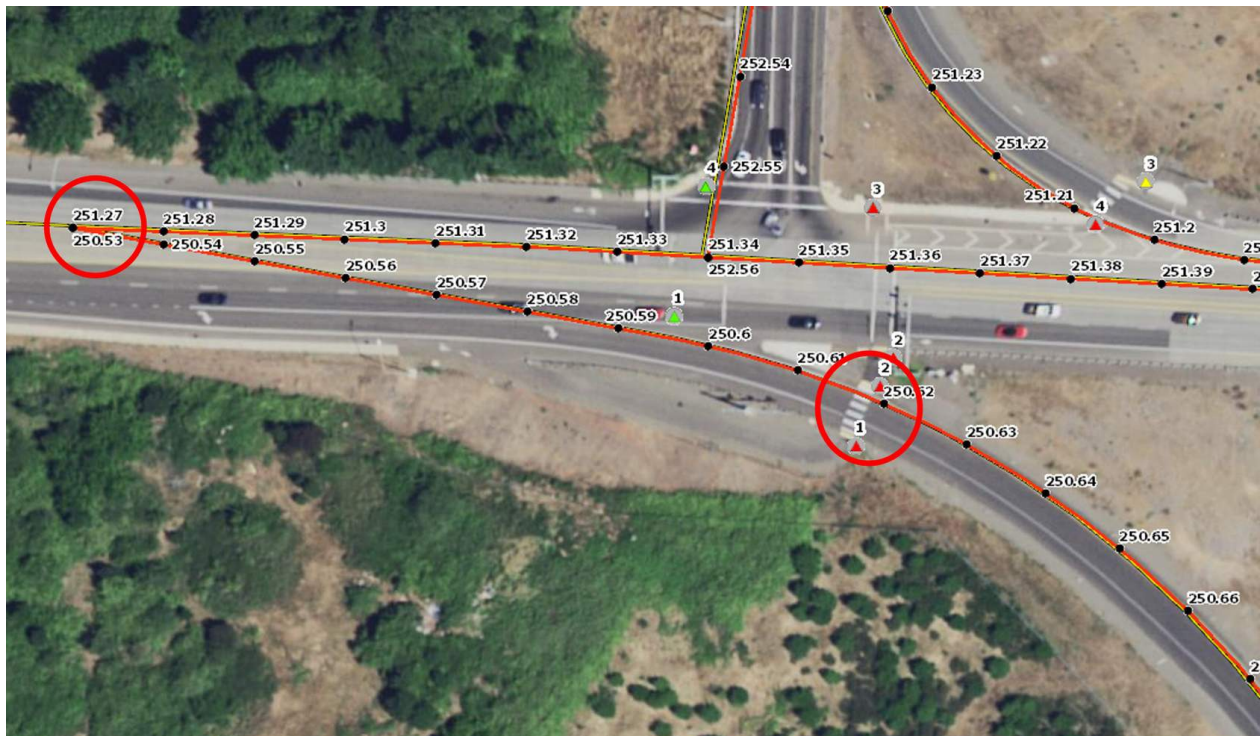

*Example of a Gore Mile Point designation for On-Ramp Curb Ramps. Use
MP 251.27 from Mainline Highway on Overpass*

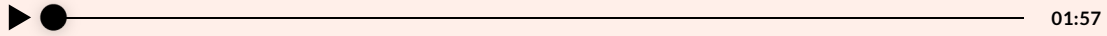

Continue Audio Narration

Curb Ramp Position Numbering

Curb ramp position values are also assigned in a counterclockwise fashion like corner positions.

Two curb ramp positions are allowed on each corner. On islands, up to 3 curb ramp positions are allowed.

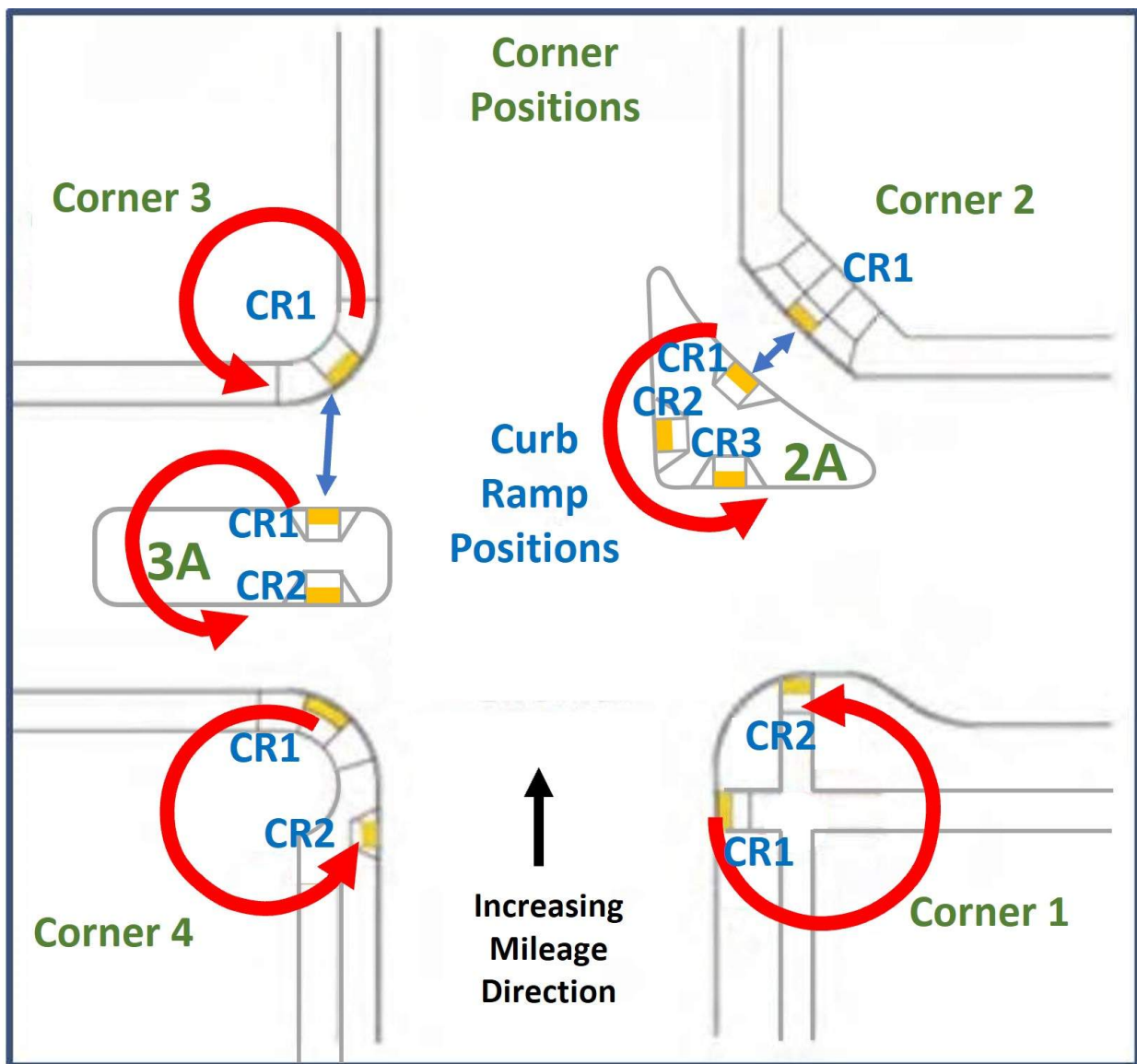

Counterclockwise Curb Ramp Corner Numbering

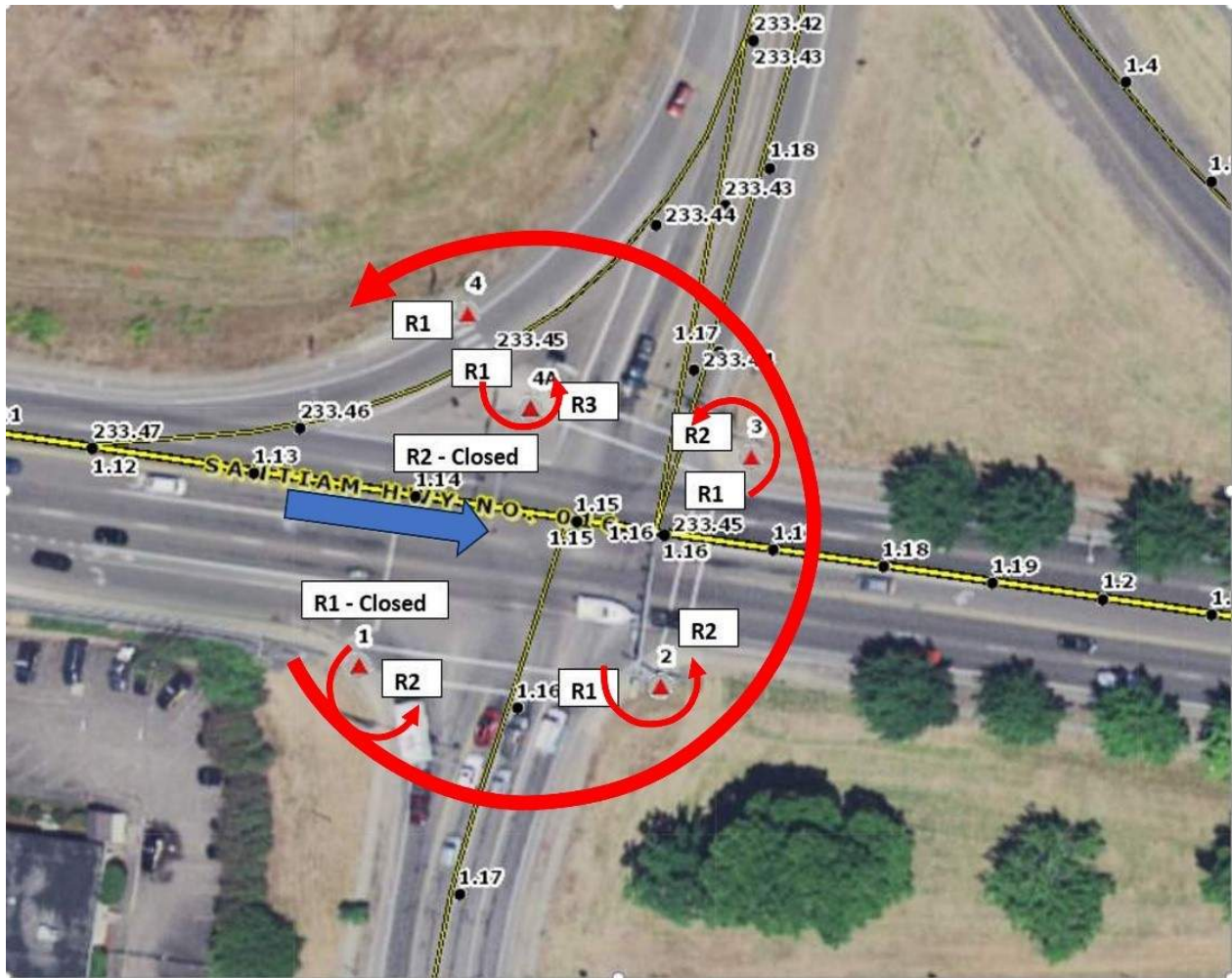

Illustration Showing a Closed Crossing and How to Number Closed Crossings

Closed Crossings

Positions that are closed due to an approved crosswalk closure will still be assigned a curb ramp position. Refer to image on the left of an intersection with a closed crossing.

In most cases, you will be able to verify curb ramp numbering in FACS-STIP, which is covered in the following unit. Understanding curb ramp numbering will help keep curb ramp inspection form submittal errors to a minimum.

For assistance on curb ramp numbering at complex intersections or any other curb ramp numbering concerns, please contact the ADA Inventory Team through the ODOT Standards email:

EMAIL



The methodology for describing corner and curb ramp positions is specific to ODOT for inventory and inspection purposes.

Knowledge Check

Is the increasing mileage always increasing with the north arrow?

☐

Yes

☐

No

SUBMIT

Exhibit A- Activity

The activity below is two parts. The first is corner position labeling and the second is ramp position labeling. In each part, you must drag and drop the correct number of corner or curb ramp positions to the corresponding location. The label will turn green if you are correct, and red if you are incorrect. Continue until all the boxes are green. Once you have completed both activities, you will be able to move on.

 Thumbnail



Complete any questions, expand all tabs, review all figures, complete quizzes and advance audio to the end before moving on. Unit Quiz 3 is on the next screen.



After you have completed the quiz, close your window and the next Unit will become available in Workday Learning.

CONTINUE