

STATE OF OREGON
DEPARTMENT OF TRANSPORTATION

PLANS FOR PROPOSED PROJECT

GRADING, STRUCTURES, PAVING, & SIGNING
**N. JEFFERSON INTCHGE. -
N. ALBANY INTCHGE. (SB) SEC.**

**PACIFIC HIGHWAY
MARION & LINN COUNTIES
DECEMBER 2003**

INDEX OF SHEETS	
SHEET NO.	DESCRIPTION
1	Title Sheet
1A	Index Of Sheets Cont'd.
1B	Standard Drg. Nos.
2, 2A Thru 2A-13 Incl.	Typical Sections
2B Thru 2B-8 Incl.	Details
2B-9 Thru 2B-14 Incl.	Superelevation Chart
2C Thru 2C-67 Incl.	Traffic Control Plan
2D, 2D-2, 2D-3	Pipe Data Sheet

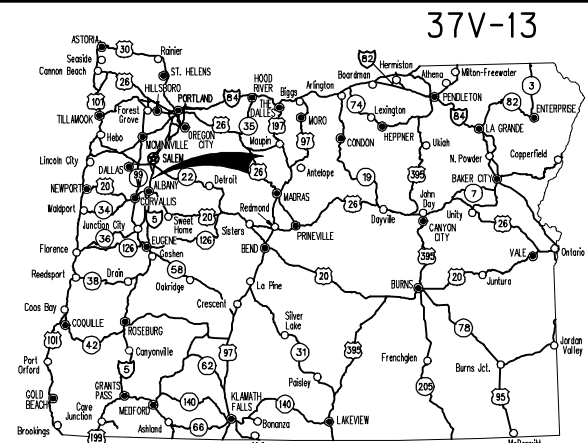

Overall Length Of Project - 15.97 km (9.93 Miles)

ATTENTION:
Oregon Law Requires You To Follow Rules Adopted By The Oregon Utility Notification Center. Those Rules Are Set Forth In OAR 952-001-0010 Through OAR 952-001-0090. You May Obtain Copies Of The Rules By Calling The Center. (Note: The Telephone Number For The Oregon Utility Center Is (503) 232-1987.)

LET'S ALL
WORK TOGETHER
TO MAKE THIS
JOB SAFE

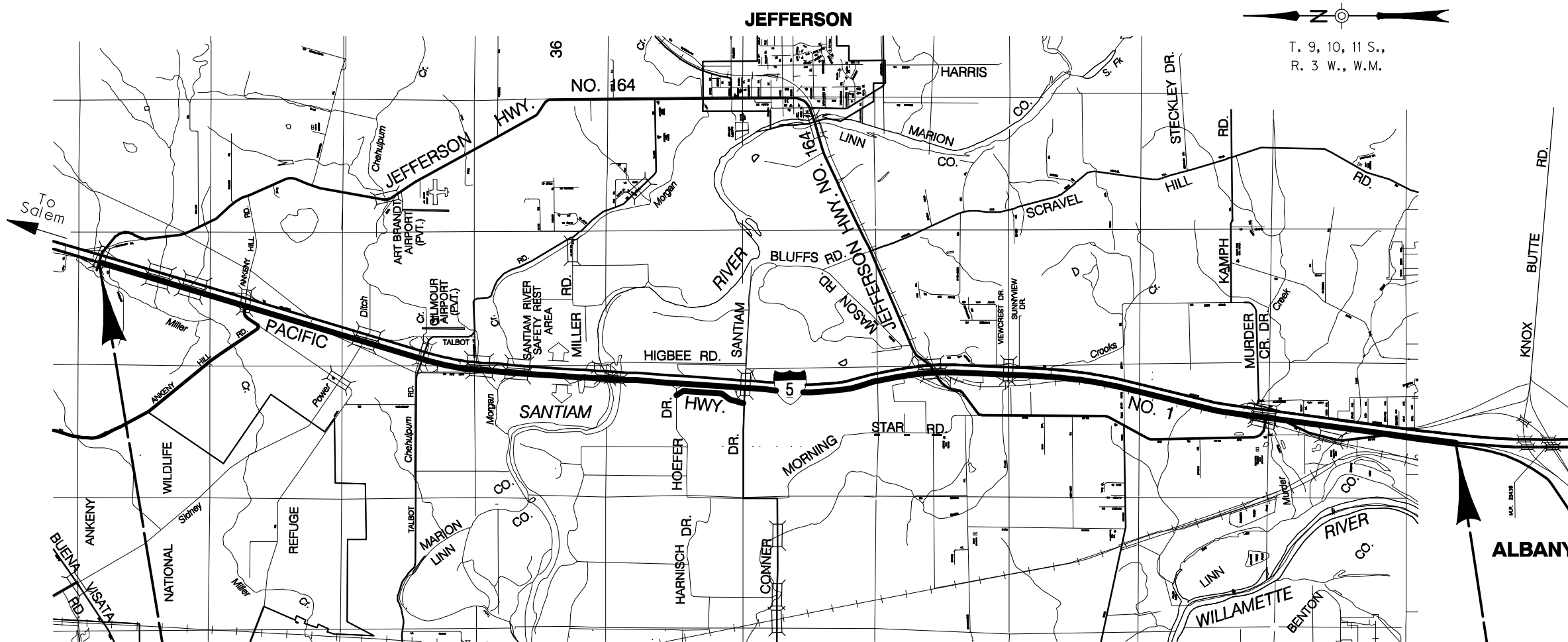

T. 9, 10, 11 S.,
R. 3 W., W.M.

**BEGINNING OF PROJECT IM-S001(171)
STA. 15+350 (M.P. 244.67)**

**END OF PROJECT IM-S001(171)
STA. 31+474 (M.P. 234.64)**



OREGON TRANSPORTATION COMMISSION

- Stuart Foster CHAIRMAN
- Gail L. Achterman COMMISSIONER
- Mike Nelson COMMISSIONER
- Randall Pope COMMISSIONER
- John Russell COMMISSIONER
- Bruce A. Warner DIRECTOR OF TRANSPORTATION

REGISTERED PROFESSIONAL
ENGINEER
15368PE

OREGON
MAR. 26, 1991
THOMAS J. LAUER
Expires Dec. 31, 2004

Thomas J. Lauer
ACTING TECHNICAL SERVICES MANAGING ENGINEER

**N. JEFFERSON INTCHGE. -
N. ALBANY INTCHGE. (SB) SEC.
PACIFIC HIGHWAY
MARION & LINN COUNTIES**

FEDERAL HIGHWAY ADMINISTRATION	PROJECT NUMBER	SHEET NO.
OREGON DIVISION	IM-S001(171)	1

INDEX OF SHEETS, CONT'D.	
SHEET NO.	DESCRIPTION
3	General Construction (Plan & Profile)
3A	Profile
4, 5	General Construction (Plan & Profile)
5A	Construction Notes
6	Alignment
6A	General Construction (Plan & Profile)
6B	Construction Notes
6C	Profile
7, 8	General Construction (Plan & Profile)
8A	Construction Notes
9, 10	General Construction (Plan & Profile)
10A	Construction Notes
11	General Construction (Plan & Profile)
11A	Construction Notes
11B	Profile
12, 13, 14	General Construction (Plan & Profile)
14A	Profile
15	General Construction
15A	Construction Notes
15B	Profile
16	General Construction
16A	Construction Notes
16B	Profile
17	General Construction (Plan & Profile)
17A	Construction Notes
18, 19	General Construction (Plan & Profile)
19A	Construction Notes
20	Alignment
20A	General Construction
20B	Construction Notes
20C	General Construction
20D Thru 20G Incl.	Profile
21, 22	General Construction (Plan & Profile)
23 Thru 27 Incl.	General Construction
28	General Construction (Plan & Profile)
29, 30	General Construction
PERMANENT PAVEMENT MARKINGS	
ST-1 Thru ST-23 Incl.	Striping Plan

INDEX OF SHEETS, CONT'D.	
SHEET NO.	DESCRIPTION
GEO/HYDRO	
GHA-1 Thru GHA-3 Incl.	Erosion Control Details
GHA-4 Thru GHA-22 Incl.	Erosion Control Plan
GHB-1 Thru GHB-8, Incl.	Geotechnical Data
57052	NB Santiam O'flow #7 (Information Only)
GHB-9, GHB-10	Geotechnical Data
57061	NB O'Xing UPRR & Jefferson (Info Only)
DRAWING NO. DESCRIPTION	
63700	Bridge Project Map
EQUIPMENT PASS	
63701	Plan & Elevation
63702	Miscellaneous Details
SB SIDNEY POWER CANAL	
63703	Plan & Elevation
63704	Footing Plan
63705	Typical Deck Section
63706	Slab Details
63707	Bent 1 & 2 Details
SB CHEHULPUM CREEK (DOTY CREEK)	
63711	Plan & Elevation
63712	Footing Plan
63713	Typical Deck Section
63714	Slab Details
63715	Bent 1 & 2 Details
SB SANTIAM O'FLOW NO. 1	
63716	Plan & Elevation
63717	Footing Plan
63718	Longitudinal & Transverse Deck Sections
63719	Deck Reinforcement Layout
63720	Bents 1 & 4 Details
63721	Bents 2 & 3 Details
SB SANTIAM O'FLOW NO. 5	
63722	Plan & Elevation
63723	Footing Plan
63724	Longitudinal & Transverse Deck Sections
63725	Deck Reinforcement Layout
63726	Bents 1 & 4 Details
63727	Bents 2 & 3 Details
SB SANTIAM O'FLOW NO. 5F (FRONTAGE RD.)	
63748	Plan & Elevation
63749	Footing Plan
63750	Longitudinal & Transverse Deck Sections
63751	Deck Reinforcement Layout
63752	Bents 1 & 4 Details
63753	Bents 2 & 3 Details

INDEX OF SHEETS, CONT'D.	
DRAWING NO.	DESCRIPTION
SB SANTIAM O'FLOW NO. 10	
63754	Plan & Elevation
63755	Footing Plan
63756	Longitudinal & Transverse Deck Sections
63757	Deck Reinforcement Layout
63758	Bents 1 & 4 Details
63759	Bents 2 & 3 Details
SB SANTIAM O'FLOW NO. 10F (FRONTAGE RD.)	
63760	Plan & Elevation
63761	Footing Plan
63762	Precast Slab Details
63763	Bents 1 & 3 Details
63764	Bent 2 Details
SB SANTIAM O'FLOW NO. 6	
63765	Plan & Elevation
63766	Footing Plan
63767	Deck Plan
63768	Longitudinal & Transverse Deck Sections
63769	End Bent Details
63770	Interior Bent Details
SB SANTIAM O'FLOW NO. 6F (FRONTAGE RD.)	
63771	Plan & Elevation
63772	Footing Plan
63773	Deck Plan
63774	Typical Deck Section & Misc. Rail Details
63775	Precast Prestressed Slab Schedule
63776	End Bent Details
63777	Bents 2 Thru 6 Details
SB SANTIAM O'FLOW NO. 7	
63778	Plan & Elevation
63779	Footing Plan
63780	Deck Reinforcement Layout
63781	Typical Deck Sections
63782	Longitudinal Deck Sections
63783	Bents 1 & 6 Details
63784	Interior Bent Details
SB SANTIAM O'FLOW (Conn. Lt.)	
63785	Plan & Elevation
SB O'XING & JEFFERSON SEC. HWY. 164	
63789	Plan & Elevation
63790	General & Misc. Details
63791	Footing Plan
63792	Construction Sequence Details
63793	Deck Plan: Span 1
63794	Deck Plan: Span 2



N. JEFFERSON INTCHGE. - N. ALBANY INTCHGE. (SB) SEC.		
PACIFIC HIGHWAY MARION & LINN COUNTIES		
FEDERAL HIGHWAY ADMINISTRATION	PROJECT NUMBER	SHEET NO.
OREGON DIVISION	IM-S001(171)	1A

INDEX OF SHEETS, CONT'D.	
DRAWING NO.	DESCRIPTION
SB O'XING & JEFFERSON SEC. HWY. 164 (Cont'd.)	
63795	Deck Plan: Span 3
63796	Typical Deck Section
63797	Typical Deck Section At Box Girder
63798	R.C. Box Girder Details
63799	Beam "C" Details
63800	Post-Tensioning And Beam-E Details
63801	Post-Tensioning Bulb-I Beam Details
63802	Bulb-I Beam Schedule, Post-Tensioned End Block & Misc. Details
63803	Prestressed Beam Details
63804	General Details Post-Tensioning For Bulb-I Beams
63805	Post-Tensioning Details
63806	Bearing Details
63807	Bent 1 Details
63808	Bent 1 Details Cont.
63809	Bent 2 & 3 Details
63810	Bent 2 & 3 Details Cont.
63811	Bent 2 & 3 Misc. Details
63812	Bent 4 Details
63813	Bent 4 Details Cont.
63814	Wingwall Details
63815	Protective Fencing Details
STANDARD CONC. BRIDGE RAIL MOD. TYPE F	
63708	General Details
STD. TRANS. CONC. BR. RAIL TO GUARD RAIL	
63709	General Details
STANDARD BRIDGE END PANEL	
63710	Standard Bridge End Panel Details
RETAINING WALL	
63786	Plan & Elevation
SIGN SUPPORTS	
63787, 63788	Monotube Cantilever Type Sign Support
SHEET NO.	DESCRIPTION
PERMANENT SIGNING	
S-6507 Thru S-6526 Incl.	Signing Plan
S-6527 Thru S-6531 Incl.	Sign Details
S-6532 Thru S-6539 Incl.	Sign & Post Data Table

Standard Drg. Nos.

RD200	- Rdwy. Cross Slopes Superelevated Sections
RD205, RD210	- Ramp Details
RD215	- Channelization & Intersection Details
RD258	- Valve Box & Operator Ext. Assembly
RD300	- Trench Backfill, Bedding, Pipe Zone
RD302	- Street Cut
RD314	- Open Grade HMA Drainage Details
RD316, RD318	- Sloped Ends For Pipe
RD326	- Coupling Bands
RD330	- Metal Pipe Slope Anchors
RD336, RD344, RD35?, RD356	- Manholes
RD364	- Misc. Drainage Structures
RD376	- Concrete Inlets
RD380, RD386	- Pipe Fill Height Tables
RD400, RD405, RD410, RD415, RD440, RD450	- Guardrail
RD500	- Precast Conc. Barrier Pin & Loop Assembly
RD510	- Concrete Barrier Terminal
RD515	- Median Barrier Anchoring Details
RD520	- Cast In Conc. Barrier Transition To Bridge Rail
RD530	- Guardrail Conn. To Concrete Barrier
RD545	- Precast Tall Concrete Barrier
RD550	- Cast in Place Tall Conc. Barrier Transition To Br. Rail
RD570	- Guardrail Connection To Tall Concrete Barrier
RD610	- Asphalt Pavement Details
RD700	- Curbs
RD800, RD805	- Traffic Delineators
RD810	- Barbed & Woven Wire Fences
RD900, RD905, RD910, RD920, RD925, RD935, RD945	- Traffic Control Plans
RD950	
RD955, RD960	
RD1000	- Construction Entrances
RD1005	- Check Dams
RD1010	- Inlet Protection
RD1025, RD1035	- Sediment Barrier
RD1040	- Sediment Fence

Standard Drg. Nos. Contd.

BR115	- Slope Paving
BR120	- Standard Deck Drains
BR135, BR136	- Access & Ventilation Details For Conc. Box Girders
BR145	- Single Strip Seal Expansion Joint
BR160, BR165	- Bridge End Panel
BR200	- Conc. Bridge Rail Type "F"
BR203	- Transition Conc. Br. Rail To Guardrail
BR226	- 2-Tube Side Mount Rail
BR230, BR236	- Trailing End Br. Conn. Conc. Br. Rail To Guardrail
BR240, BR241	- Protective Screening
BR266	- Std. Modified Type 2A Rail
BR350	- Temp. Diaphragm Beam For Prestressed Conc. Beams
BR420	- 660 mm Std. Precast Prestressed Slab
BR705	- Retaining Walls Front Face Battered 12:1
BR800, BR805	- Box Culvert
BR840	- Double Box Culvert
BR900	- Multi-Post Breakaway Sign Supports
BR906	- Triangular Base Breakaway
BR943-BR948	- Std. Monotube Cantilever Sign Support
BR983	- Breakaway Sign & Luminaire Supports
TM100	- Temp. Wood Post Sizing Charts
TM105	- Orange Flag Board Mounting Details
TM200, TM201, TM202	- Sign Installation Details
TM205	- Aluminum Panel Installation
TM206, TM207	- Sign Mounting Details
TM211, TM212	- Signing Details
TM214, TM215	- Perm. Wood Post Sizing Charts
TM216	- Sign Installation Br. Mount Details
TM217	- Route Markers & Secondary Assemblies
TM218	- Secondary Signing Mounting Details
TM219	- Steel Pole Mounted Sign Details
TM220	- Multi-Post Installations
TM221, TM222	- Milepost Marker Details
TM223, TM224	- Directional Sign Layout
TM225	- Exit No. & Gore Signing Details
TM230, TM231, TM232, TM233	- Mounting Details For Removable Legend
TM500, TM501, TM539, TM547, TM551	- Pavement Markings



N. JEFFERSON INTCHGE. - N. ALBANY INTCHGE. (SB) SEC. PACIFIC HIGHWAY MARION & LINN COUNTIES		
FEDERAL HIGHWAY ADMINISTRATION	PROJECT NUMBER	SHEET NO.
OREGON DIVISION	IM-S001(171)	1B

STATE OF OREGON
DEPARTMENT OF TRANSPORTATION

PLANS FOR PROPOSED PROJECT

GRADING, STRUCTURE, PAVING, & SIGNING
OR11: WESTON BRIDGE SEC.

OREGON - WASHINGTON HIGHWAY

UMATILLA COUNTY
APRIL 2004

INDEX OF SHEETS	
SHEET NO.	DESCRIPTION
1	Title Sheet
1A	Index Of Sheets Cont'd. & Std. Drg. Nos.
2, 2A Thru 2A-3 Incl.	Typicals
2B	Details
3	General Construction
3A	Detour Plan
3B	Profile
3C	Detour Profile
4	General Construction
4A	Construction Notes
4B	Detour Plan
4C	Profile
4D	Detour Profile
4E, 4F, 4G	Ramp Profile
5	General Construction
5A	Detour Plan
5B	Profile
5C	Detour Profile

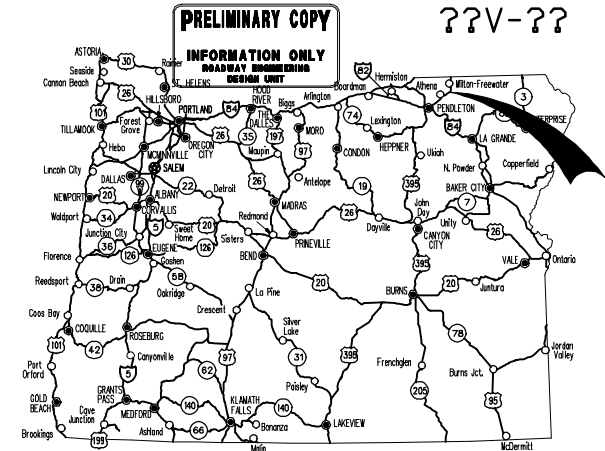

Overall Length Of Project - 0.39 km (0.24 Miles)

ATTENTION:
Oregon Law Requires You To Follow Rules Adopted By The Oregon Utility Notification Center. Those Rules Are Set Forth In OAR 952-001-0010 Through OAR 952-001-0090. You May Obtain Copies Of The Rules By Calling The Center. (Note: The Telephone Number For The Oregon Utility Center Is (503) 232-1987.)



END OF PROJECT
STA. 32+965.301 (M.P. 20.61)

BEGINNING OF PROJECT
STA. 32+265.878 (M.P. 20.17)

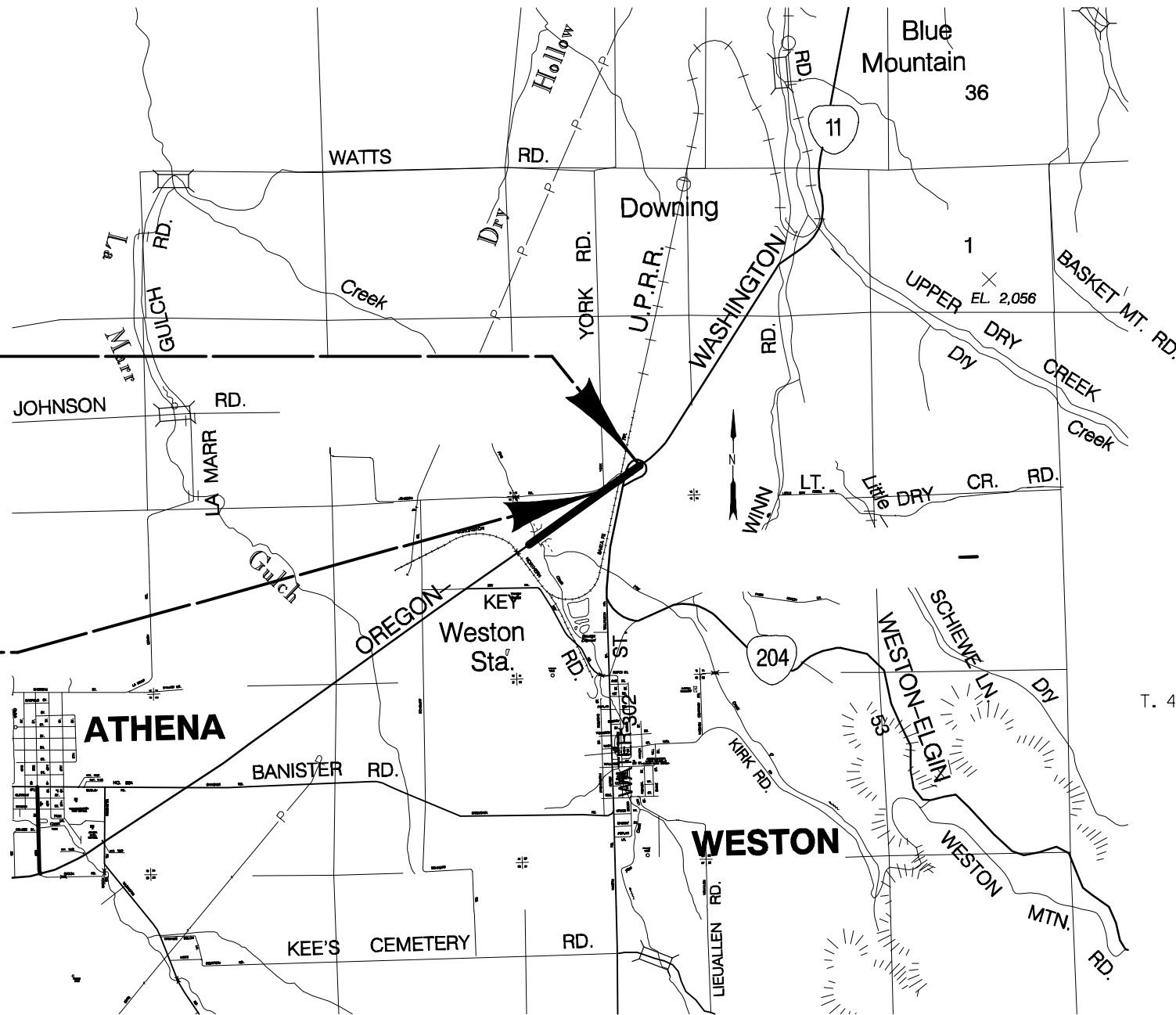

T. 4 N., R. 35 E., W.M.

OREGON TRANSPORTATION COMMISSION
Stuart Foster CHAIRMAN
Gail L. Achterman COMMISSIONER
Mike Nelson COMMISSIONER
Randall Papé COMMISSIONER
John Russell COMMISSIONER
Bruce A. Warner DIRECTOR OF TRANSPORTATION

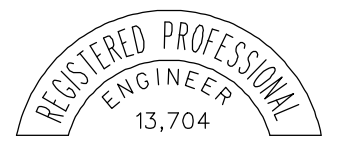

Catherine M. Nelson
TECHNICAL SERVICES MANAGING ENGINEER

OR11: WESTON BRIDGE SEC.
OREGON - WASHINGTON HIGHWAY
UMATILLA COUNTY



FEDERAL HIGHWAY ADMINISTRATION	PROJECT NUMBER	SHEET NO.
OREGON DIVISION	*	1

Standard Drg. Nos.

INDEX OF SHEETS, CONT'D.	
DRAWING NO.	DESCRIPTION
OR11:UPRR O'XING (WESTON) BRIDGE	
1	Plan & Elevation
2	General Notes
3	Staging Details
4	Footing Plan
5	Typical Deck Section
6,7	Bent 1 & Bent 1 Details
8,9	Bent 2 & Bent 2 Details
10	Bent 3
11	Precast Prestressed Box Schedule
12, 13	Ornamental Protection Fencing



OR11: WESTON BRIDGE SEC. OREGON - WASHINGTON HIGHWAY UMATILLA COUNTY		
FEDERAL HIGHWAY ADMINISTRATION	PROJECT NUMBER	SHEET NO.
OREGON DIVISION	#	1A

INDEX OF SHEETS	
SHEET NO.	DESCRIPTION
1	Title Sheet
1A	Index Of Sheets Cont'd. & Std. Drg. Nos.

STATE OF OREGON
DEPARTMENT OF TRANSPORTATION

PLANS FOR PROPOSED PROJECT

PAVING

**OR99W: KIGER ISLAND - OAKLEA &
US20: 53RD - RODEA DR. (CORVALLIS) SECS.
PACIFIC HWY. WEST & CORVALLIS NEWPORT HWY.**

BENTON & LANE COUNTIES
FEBRUARY 2004

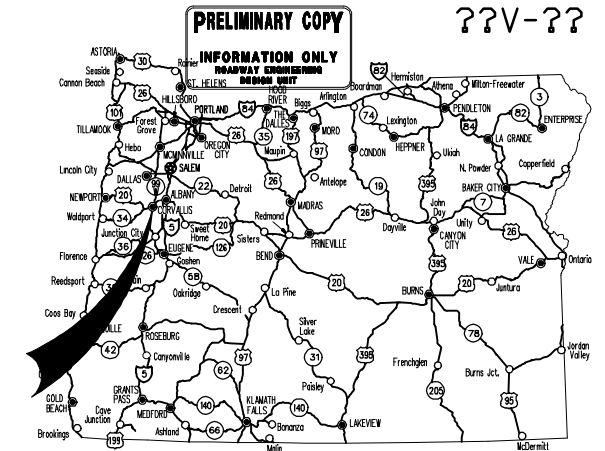

Overall Length Of Project - 34.60 km (21.50 Miles)

ATTENTION:
Oregon Law Requires You To Follow Rules Adopted By The Oregon Utility Notification Center. Those Rules Are Set Forth In OAR 952-001-0010 Through OAR 952-001-0090. You May Obtain Copies Of The Rules By Calling The Center. (Note: The Telephone Number For The Oregon Utility Center Is (503) 232-1987.)

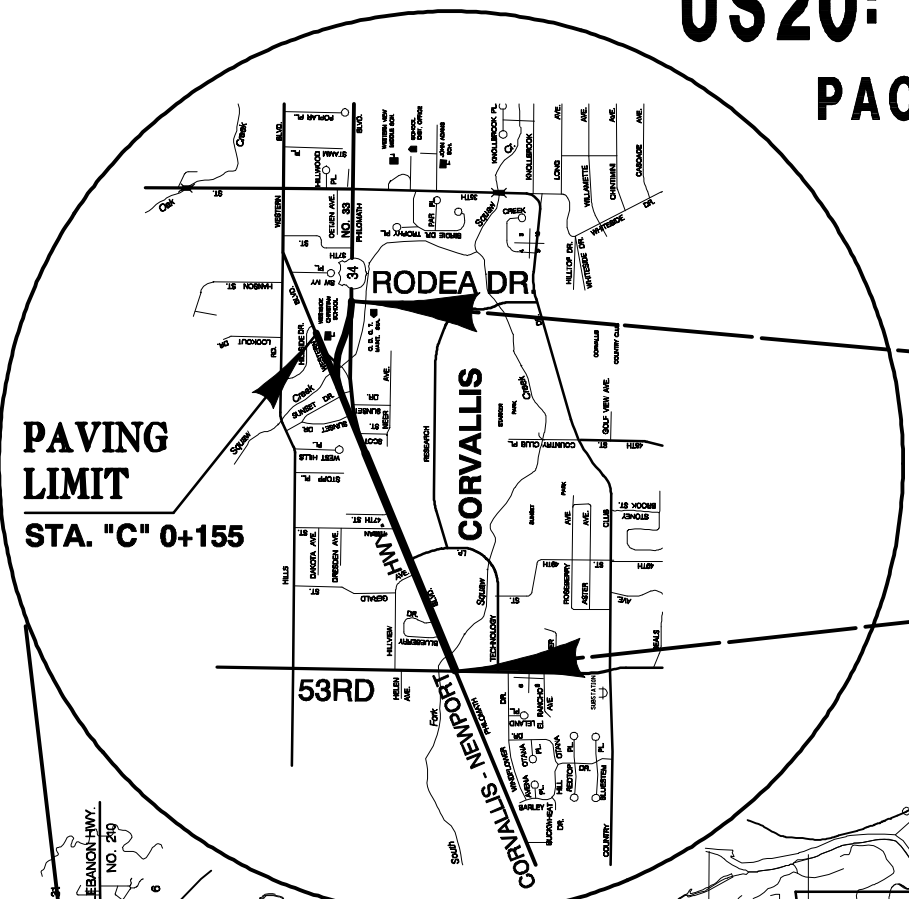

END OF PROJECT
STA. 15+392 (M.P. 54.39)

END OF PROJECT
M.P. 106.9

BEGINNING OF PROJECT
STA. 13+940 (M.P. 53.49)



S.END LONG TOM RVR.BR.
M.P. 106.9

NO WORK AREA
M.P. 88.3

NO WORK AREA

OAK STREET
M.P. 106.9

BEGINNING OF PROJECT
M.P. 86.3

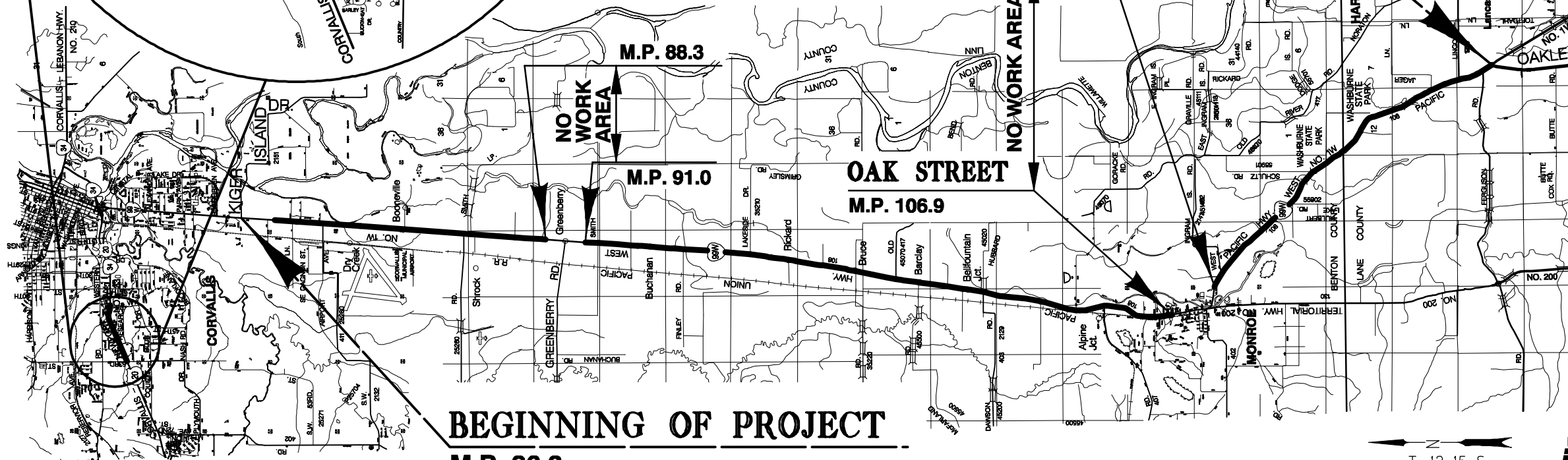

T. 12-15 S.,
R. 4, 5 W., W.M.



OREGON TRANSPORTATION COMMISSION

- | | |
|-------------------|----------------------------|
| Stuart Foster | CHAIRMAN |
| Gail L. Achterman | COMMISSIONER |
| Mike Nelson | COMMISSIONER |
| Randall Papé | COMMISSIONER |
| John Russell | COMMISSIONER |
| Bruce A. Warner | DIRECTOR OF TRANSPORTATION |

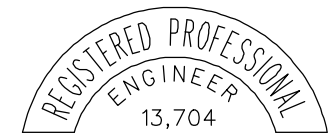

Catherine M. Nelson
TECHNICAL SERVICES MANAGING ENGINEER

**OR99W: KIGER ISLAND - OAKLEA &
US20: 53RD - RODEA DR. (CORVALLIS) SECS.
PACIFIC HWY. WEST & CORVALLIS - NEWPORT HWY.**
BENTON & LANE COUNTIES

FEDERAL HIGHWAY ADMINISTRATION	PROJECT NUMBER	SHEET NO.
OREGON DIVISION	*	1

STATE OF OREGON
DEPARTMENT OF TRANSPORTATION

PLANS FOR PROPOSED PROJECT

PAVING

OR201: JUCT. US20/26 - M.P. 12.51 SEC.

SUCCOR CREEK HIGHWAY

MALHEUR COUNTY

JULY 2004

INDEX OF SHEETS	
SHEET NO.	DESCRIPTION
1	Title Sheet
1A	Index Of Sheets Cont'd. & Std. Drg. Nos.
2, 2A	Typical Sections
2B, 2B-2	Details
2C	Pipe Data Sheet
3 Thru 9 Incl.	General Construction
PERMANENT PAVEMENT MARKINGS	
ST-1	Striping Plan
GEO/HYDRO	
GHA-X	Erosion Control Plans
GHX-X	Water Quality Plans

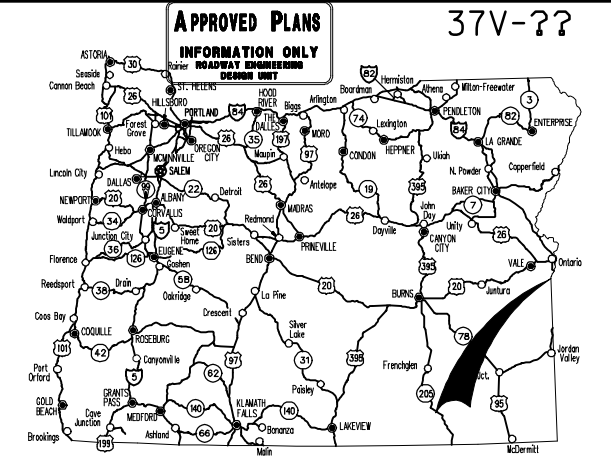

Overall Length Of Project - 20.10 km (12.49 Miles)

ATTENTION:
Oregon Law Requires You To Follow Rules Adopted By The Oregon Utility Notification Center. Those Rules Are Set Forth In OAR 952-001-0010 Through OAR 952-001-0090. You May Obtain Copies Of The Rules By Calling The Center. (Note: The Telephone Number For The Oregon Utility Center Is (503) 232-1987.)

LET'S ALL
WORK TOGETHER
TO MAKE THIS
JOB SAFE

BEGINNING OF PROJECT
STA. 0+000 (M.P. 0.02)

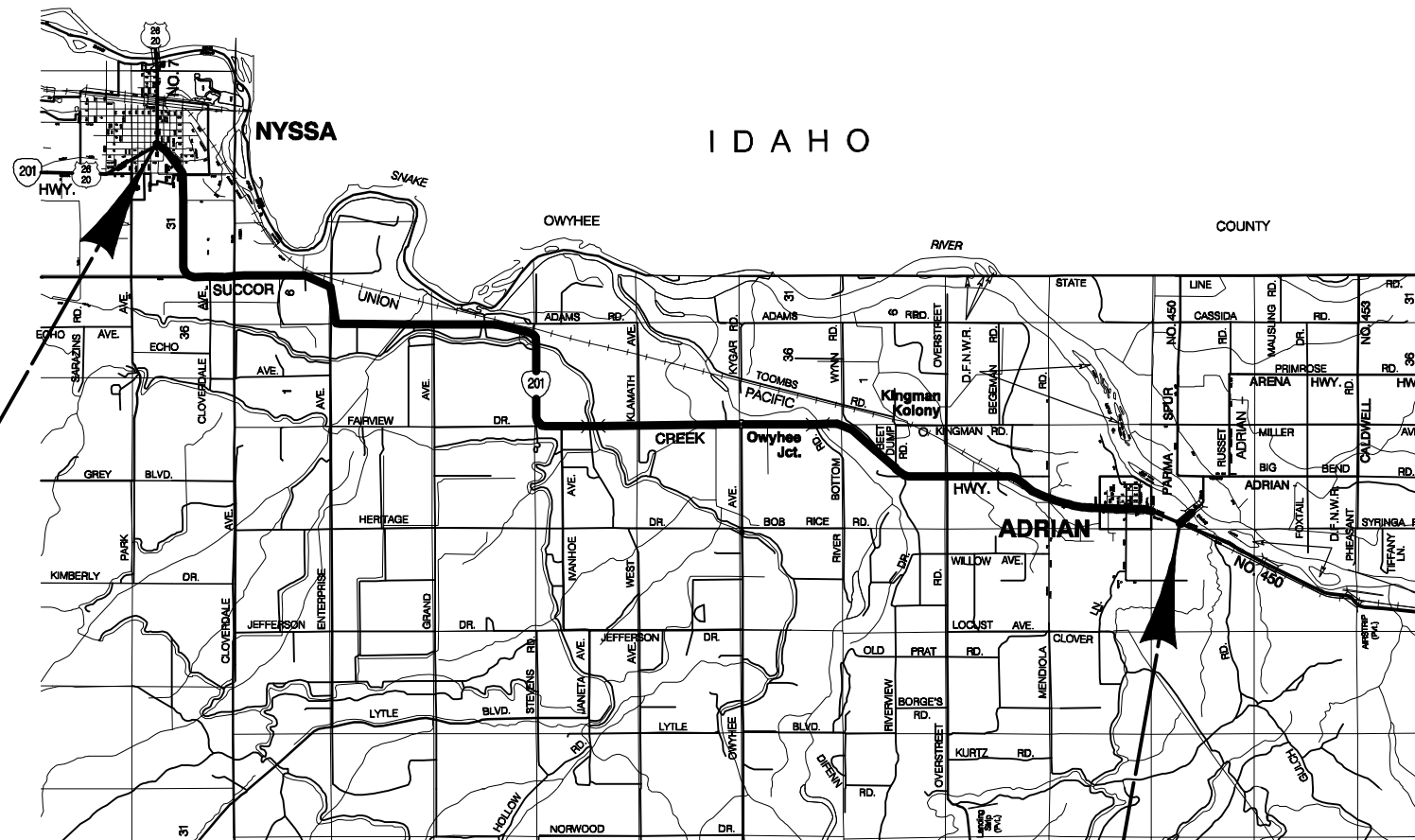

END OF PROJECT
STA. 0+000 (M.P. 12.51)

T. 19-21 S.,
R. 46, 47 E., W.M.



OREGON TRANSPORTATION COMMISSION
Stuart Foster CHAIRMAN
Gail L. Achterman COMMISSIONER
Mike Nelson COMMISSIONER
Randall Papé COMMISSIONER
John Russell COMMISSIONER
Bruce A. Warner DIRECTOR OF TRANSPORTATION

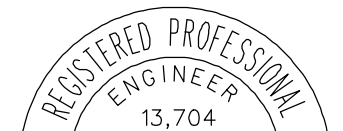

Catherine M. Nelson
TECHNICAL SERVICES MANAGING ENGINEER

OR201: JCT. US20/26 - M.P. 12.51 SEC.		
SUCCOR CREEK HIGHWAY MALHEUR COUNTY		
FEDERAL HIGHWAY ADMINISTRATION	PROJECT NUMBER	SHEET NO.
OREGON DIVISION	*	1

INDEX OF SHEETS, CONT'D.	
DRAWING NO.	DESCRIPTION
BRIDGE NO. #04393A	
#	Description
BRIDGE NO. #04394A	
#	Description
BRIDGE NO. #01747B	
#	Description
PERMANENT SIGNING	
TRAFFIC SIGNALS	

Standard Drg. Nos.

- TM100 - Temp. Wood Post Sizing Charts
- TM105 - Orange Flag Board Mounting Details
- TM111, TM112 - Self-Regulating Diversion
- TM113, TM114, TM115 - Signing Details
- TM150, TM151 - Lane Drop Marking & Signing

- TM200, TM201, TM202, TM205 - Sign Installation Details
- TM206, TM207 - Sign Mounting Details
- TM211, TM212 - Signing Details
- TM214, TM215 - Perm. Wood Post Sizing Charts
- TM216 - Sign Installation Br. Mount Details
- TM217 - Route Markers & Secondary Assemblies
- TM218 - Secondary Signing Mounting Details
- TM219 - Steel Pole Mounted Sign Details
- TM220 - Multi-Post Installations
- TM221, TM222 - Milepost Marker Details
- TM223, TM224 - Directional Sign Layout
- TM225 - Exit No. & Gore Signing Details
- TM230, TM231, TM322, TM233 - Mounting Details For Removable Legend
- TM235, TM237 - Pipe Sign Support Details
- TM239 - Square Tube Sign Support
- TM241 - Triangular Base Breakaway
- TM250, TM251 - Truck Weigh Sta. Signing Details

- TM300, TM301 - Illumination Cabinets
- TM305, TM306 - Illumination Installation
- TM310 - Illumination Details

- TM400, TM401 - Temp. Signal Details
- TM402 - Strain Pole Details
- TM403 - Mast Arm Pole Details
- TM404 - Span Wire Details
- TM405 - Pole Foundations & Grounding
- TM406, TM407, TM408 - Vehicle Signal Details
- TM409, TM410 - Pedestrian Signals
- TM411 - Crosswalk Closure Details
- TM412, TM413 - Interior Illuminated Signs
- TM414 - Mounted Sign Details
- TM415 - Mast Arm Mounted Warning Sign
- TM416 - Overhead Sign Details
- TM417, TM418 - Junction Boxes
- TM419, TM420 - Loop Details
- TM421 - Color Code Charts
- TM422 - Miscellaneous Details
- TM423 - Controller Cabinet & Related Details
- TM424 - Post & Pedestal Cabinets
- TM425 - Flasher Cabinets
- TM426, TM427 - Service Cabinets
- TM428 - Terminal Cabinets
- TM429 - Stabilizer Details
- TM430 - Microloops
- TM431 - Fiber Optic & LED PTR Signs
- TM432, TM433 - Ramp Meter Details
- TM434 - Maintenance Pad Details

- TM500, TM501, TM502 - Pavement Markings
- TM505 - Railroad Pavement Markings
- TM510, TM511 - Bike Lane Pavement Markings
- TM520, TM521, TM522 - Durable Pavement Markings
- TM525 - Pavement Marking Details
- TM526 - Freeway Pavement Markings
- TM527 - Intersection Pavement Markings
- TM530 - Urban Pavement Markings
- TM531 - Urban Pavement Markers
- TM533 - Pavement Markings, Speed Humps
- TM535, TM537 - Crosswalk Markings
- TM539, TM545 - Left Turn Pavement Markings
- TM547 - Fwy. Entrance Pavement Markings
- TM549 - Fwy. Raised Pavement Markers
- TM551 - Fwy. Exit Pavement Markings
- TM555 - No Passing Zone Pvmt. Markings
- TM556 - Bus Pavement Markings
- TM560 - Obstruction Pavement Markings
- TM565 - Rural Raised Pavement Markers



OR201: JCT. US20/26 - M.P. 12.51 SEC.		
SUCCOR CREEK HIGHWAY MALHEUR COUNTY		
FEDERAL HIGHWAY ADMINISTRATION	PROJECT NUMBER	SHEET NO.
OREGON DIVISION	*	1A

INDEX OF SHEETS, CONT'D.	
DRAWING NO.	DESCRIPTION
BRIDGE NO. #04393A	
#	Description
BRIDGE NO. #04394A	
#	Description
BRIDGE NO. #01747B	
#	Description
PERMANENT SIGNING	
TRAFFIC SIGNALS	

Standard Drg. Nos.

- TM100 - Temp. Wood Post Sizing Charts
- TM105 - Orange Flag Board Mounting Details
- TM111, TM112 - Self-Regulating Diversion
- TM113, TM114, TM115 - Signing Details
- TM150, TM151 - Lane Drop Marking & Signing

- TM200, TM201, TM202, TM205 - Sign Installation Details
- TM206, TM207 - Sign Mounting Details
- TM211, TM212 - Signing Details
- TM214, TM215 - Perm. Wood Post Sizing Charts
- TM216 - Sign Installation Br. Mount Details
- TM217 - Route Markers & Secondary Assemblies
- TM218 - Secondary Signing Mounting Details
- TM219 - Steel Pole Mounted Sign Details
- TM220 - Multi-Post Installations
- TM221, TM222 - Milepost Marker Details
- TM223, TM224 - Directional Sign Layout
- TM225 - Exit No. & Gore Signing Details
- TM230, TM231, TM322, TM233 - Mounting Details For Removable Legend
- TM235, TM237 - Pipe Sign Support Details
- TM239 - Square Tube Sign Support
- TM241 - Triangular Base Breakaway
- TM250, TM251 - Truck Weigh Sta. Signing Details

- TM300, TM301 - Illumination Cabinets
- TM305, TM306 - Illumination Installation
- TM310 - Illumination Details

- TM400, TM401 - Temp. Signal Details
- TM402 - Strain Pole Details
- TM403 - Mast Arm Pole Details
- TM404 - Span Wire Details
- TM405 - Pole Foundations & Grounding
- TM406, TM407, TM408 - Vehicle Signal Details
- TM409, TM410 - Pedestrian Signals
- TM411 - Crosswalk Closure Details
- TM412, TM413 - Interior Illuminated Signs
- TM414 - Mounted Sign Details
- TM415 - Mast Arm Mounted Warning Sign
- TM416 - Overhead Sign Details
- TM417, TM418 - Junction Boxes
- TM419, TM420 - Loop Details
- TM421 - Color Code Charts
- TM422 - Miscellaneous Details
- TM423 - Controller Cabinet & Related Details
- TM424 - Post & Pedestal Cabinets
- TM425 - Flasher Cabinets
- TM426, TM427 - Service Cabinets
- TM428 - Terminal Cabinets
- TM429 - Stabilizer Details
- TM430 - Microloops
- TM431 - Fiber Optic & LED PTR Signs
- TM432, TM433 - Ramp Meter Details
- TM434 - Maintenance Pad Details

- TM500, TM501, TM502 - Pavement Markings
- TM505 - Railroad Pavement Markings
- TM510, TM511 - Bike Lane Pavement Markings
- TM520, TM521, TM522 - Durable Pavement Markings
- TM525 - Pavement Marking Details
- TM526 - Freeway Pavement Markings
- TM527 - Intersection Pavement Markings
- TM530 - Urban Pavement Markings
- TM531 - Urban Pavement Markers
- TM533 - Pavement Markings, Speed Humps
- TM535, TM537 - Crosswalk Markings
- TM539, TM545 - Left Turn Pavement Markings
- TM547 - Fwy. Entrance Pavement Markings
- TM549 - Fwy. Raised Pavement Markers
- TM551 - Fwy. Exit Pavement Markings
- TM555 - No Passing Zone Pvm. Markings
- TM556 - Bus Pavement Markings
- TM560 - Obstruction Pavement Markings
- TM565 - Rural Raised Pavement Markers



OR201: JCT. US20/26 - M.P. 12.51 SEC.		
SUCCOR CREEK HIGHWAY MALHEUR COUNTY		
FEDERAL HIGHWAY ADMINISTRATION	PROJECT NUMBER	SHEET NO.
OREGON DIVISION	*	1A

STATE OF OREGON
 DEPARTMENT OF TRANSPORTATION
 PLANS FOR PROPOSED PROJECT

PAVING
OR34: DIGGER CR. - ALSEA MTN. SEC.
ALSEA HIGHWAY
 BENTON COUNTY
 DECEMBER 2003

INDEX OF SHEETS	
SHEET NO.	DESCRIPTION
1	Title Sheet
2, 2A, 2A-2	Typicals
2B Thru 2B-7 Incl.	Details
3 Thru 10 Incl.	General Construction
GEO/HYDRO	
GHA-1	Erosion Control Plan
DRAWING NO. DESCRIPTION	
OR34: MALTBY CREEK BRIDGE	
XXXXX	Bridge Details
OR34: MILL CREEK BRIDGE	
XXXXX	Bridge Details
OR34: ALSEA RIVER BRIDGE	
XXXXX	Bridge Details

- Standard Drg. Nos.
- RD100 - Mailbox Installation
 - RD115 - Monument Box
 - RD258 - Valve Box & Operator Ext. Assembly
 - RD360 - Manhole Frame Adjustment
 - RD376 - Misc. Drainage Structures
 - RD400, RD405, RD410, RD415, RD420, RD425, RD450, RD470 - Guardrail
 - RD610 - Asphalt Pavement Details
 - RD715 - Approaches & Non-Sidewalk Dwys.
 - RD900, RD905, RD910, RD945, RD950 - Traffic Control Plans
 - RD950 - Barricades
 - RD1035 - Sediment Barrier
 - BR203 - Transition Conc. Br. Rail To Guard Rail
 - BR233 - Thrie-Beam Rail
 - BR270 - Rail Transition Details Flex Beam Rail To Curb & Parapet Rail
 - BR273 - Thrie-Beam Rail Retrofit For Curb & Parapet Rail

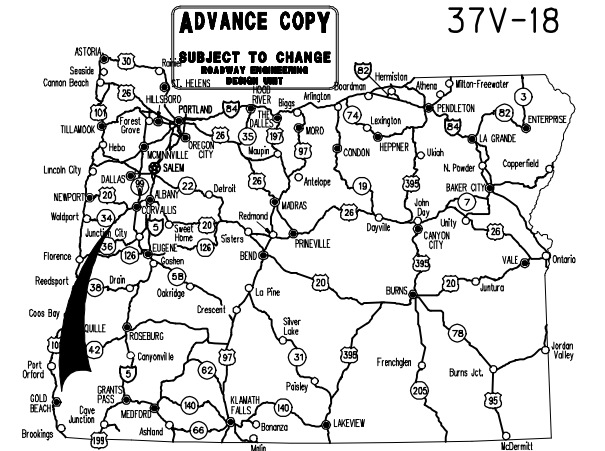
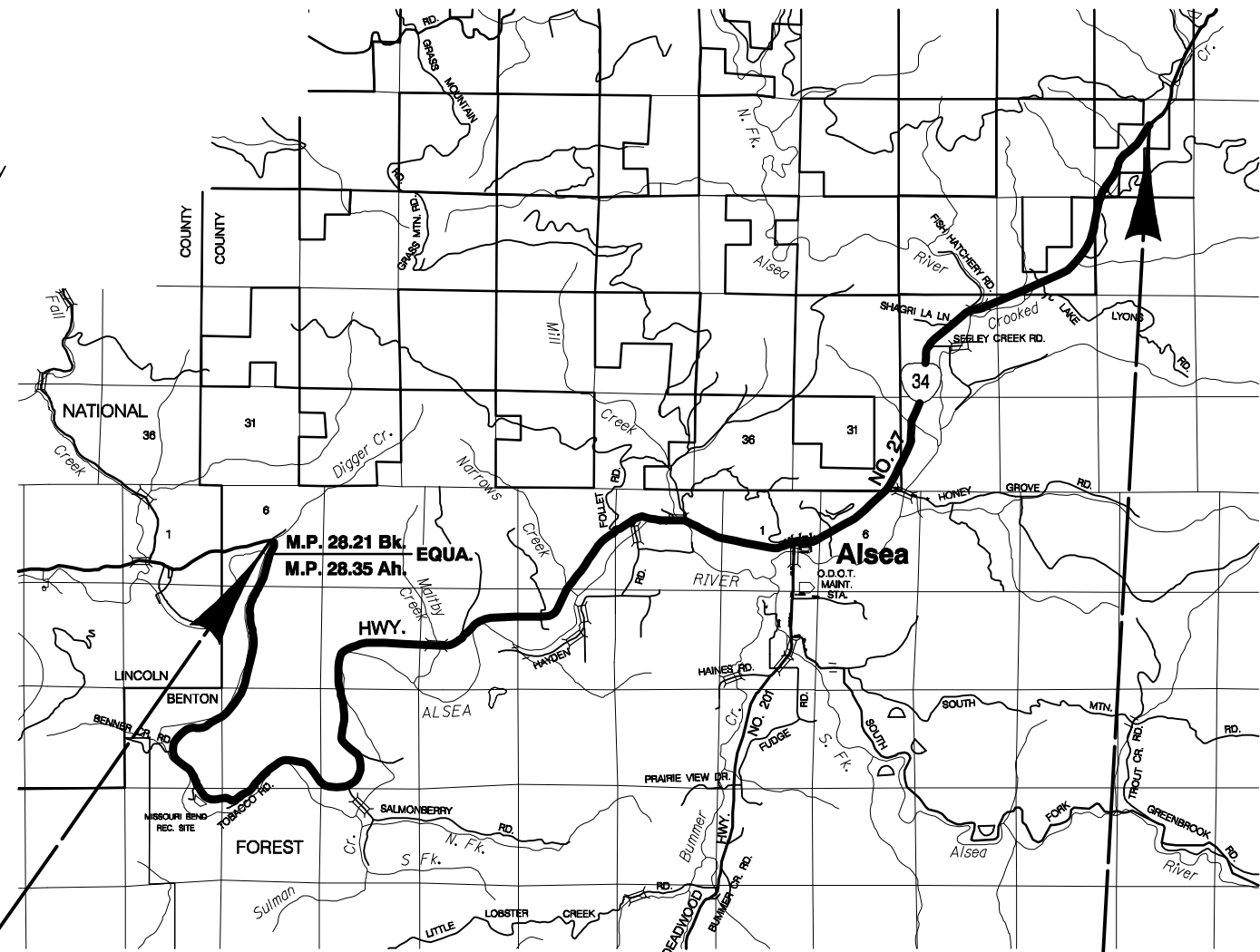

Overall Length Of Project - 28.28 km (17.57 Miles)

ATTENTION:
 Oregon Law Requires You To Follow Rules Adopted By The Oregon Utility Notification Center. Those Rules Are Set Forth In OAR 952-001-0010 Through OAR 952-001-0090. You May Obtain Copies Of The Rules By Calling The Center. (Note: The Telephone Number For The Oregon Utility Center Is (503) 232-1987.)

LET'S ALL
 WORK TOGETHER
 TO MAKE THIS
 JOB SAFE

OREGON TRANSPORTATION COMMISSION
 Stuart Foster CHAIRMAN
 Gail L. Achterman COMMISSIONER
 Mike Nelson COMMISSIONER
 Randall Papé COMMISSIONER
 John Russell COMMISSIONER
 Bruce A. Warner DIRECTOR OF TRANSPORTATION

REGISTERED PROFESSIONAL
 ENGINEER
 13,704

OREGON
 JULY 16, 1987
 CATHERINE M. NELSON
 Expires Dec. 31, 2004

Catherine M. Nelson
 TECHNICAL SERVICES MANAGING ENGINEER

OR34: DIGGER CR. - ALSEA MTN. SEC.
 ALSEA HIGHWAY
 BENTON COUNTY

FEDERAL HIGHWAY ADMINISTRATION	PROJECT NUMBER	SHEET NO.
OREGON DIVISION	X-STP-S027(3)	1



BEGINNING OF PROJECT
X-STP-S027(3)
STA. 45+383.5 (M.P. 28.2)

END OF PROJECT X-STP-S027(3)
STA. 73+659.6 (M.P. 45.77)

STATE OF OREGON
DEPARTMENT OF TRANSPORTATION

PLANS FOR PROPOSED PROJECT
GRADING, PAVING, & SIGNING

**I-5: NB EXIT RAMP AT
VAN DUYN RD. (COBURG INTCHGE.) SEC.
PACIFIC HIGHWAY**

LANE COUNTY
OCTOBER 2003

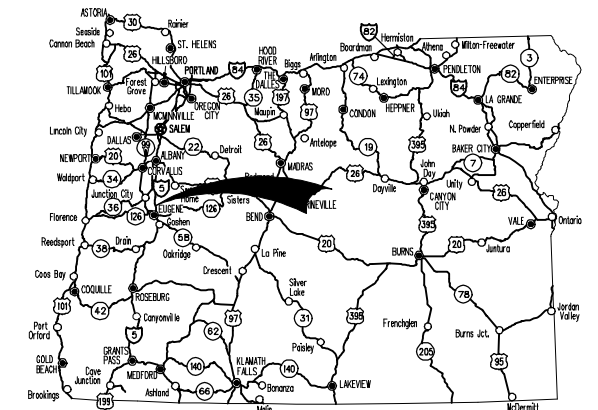

Overall Length Of Project - 0.72 km (0.45 Miles)

INDEX OF SHEETS	
SHEET NO.	DESCRIPTION
1	Title Sheet
1A	Index Of Sheets Cont'd. & Std. Drg. Nos.
2, 2A Thru 2A-4, Incl	Typical Sections
2B Thru 2B-3, Incl	Details
2C Thru 2C-10, Incl.	Traffic Control Plans
2D, 2D-2	Pipe Data
3	General Construction - "DL" Line
4, 4A	General Construction - "B" Line
4B	Profile - "B" Line
5, 5A	General Construction - "B" Line
5B	Profile - "B" Line
6	General Construction - "B" Line
6A	Profile - "B" Line

ATTENTION:
Oregon Law Requires You To Follow Rules Adopted By The Oregon Utility Notification Center. Those Rules Are Set Forth In OAR 952-001-0010 Through OAR 952-001-0090. You May Obtain Copies Of The Rules By Calling The Center. (Note: The Telephone Number For The Oregon Utility Center Is (503) 232-1987.)



**BEGINNING OF CONTACT PROJECT
STA. "DL" 0+229**

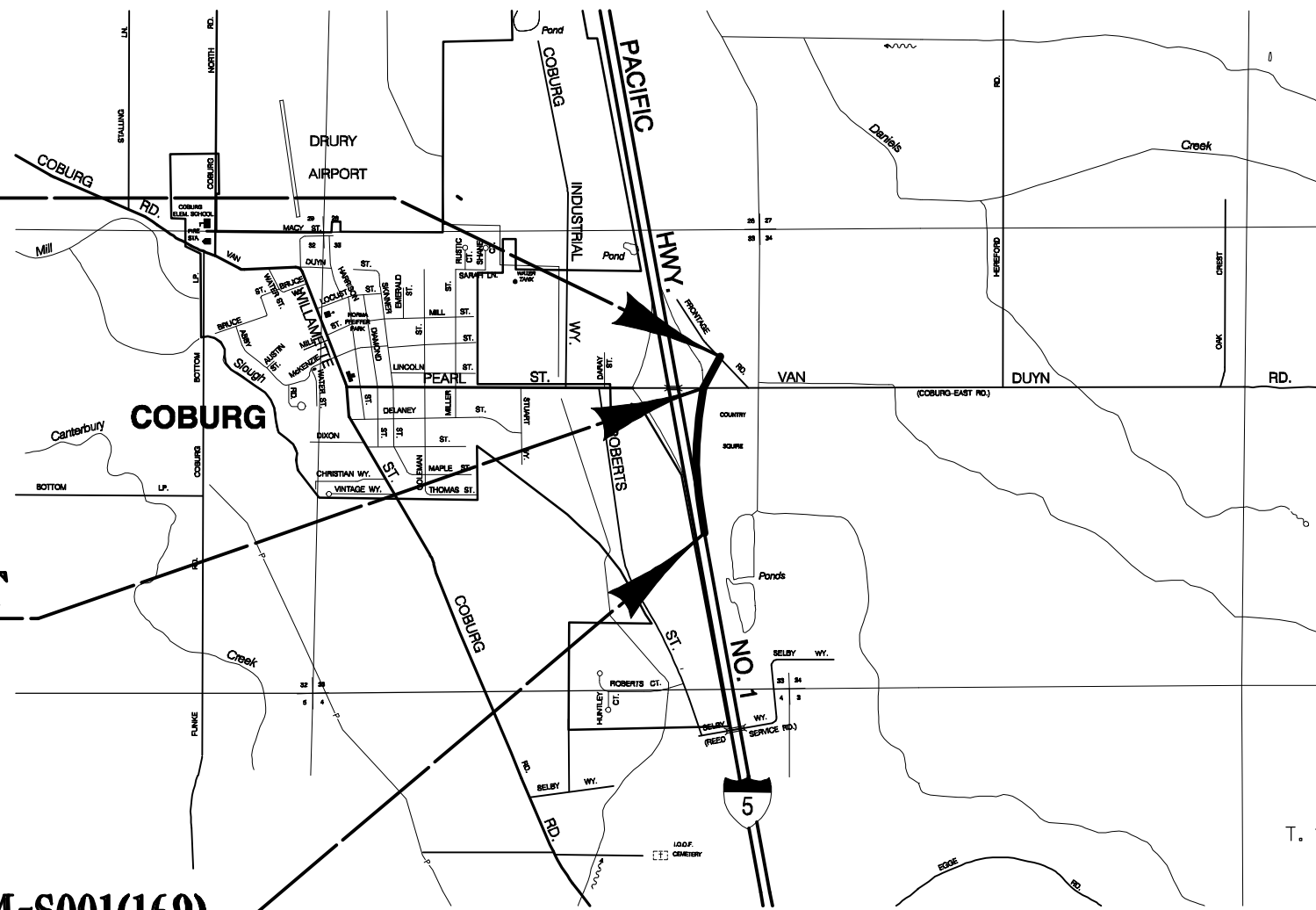

**IM-S001(169)
BEGINNING OF PROJECT
STA. "B" 7+511.74 (M.P. 199.40)**

**END OF PROJECT IM-S001(169)
STA. 8+232 (M.P. 198.95)**

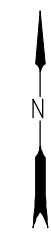

T. 16 S., R. 3 W., W.M.



OREGON TRANSPORTATION COMMISSION
Stuart Foster CHAIRMAN
Gail L. Achterman COMMISSIONER
Mike Nelson COMMISSIONER
Randall Papé COMMISSIONER
John Russell COMMISSIONER
Bruce A. Warner DIRECTOR OF TRANSPORTATION

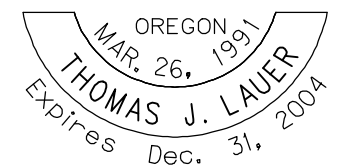
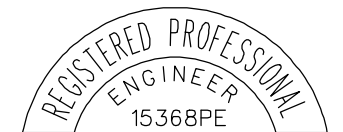

Thomas J. Lauer
ACTING TECHNICAL SERVICES MANAGING ENGINEER

**I-5: NB EXIT RAMP AT
VAN DUYN RD. (COBURG INTCHGE.) SEC.
PACIFIC HIGHWAY
LANE COUNTY**

FEDERAL HIGHWAY ADMINISTRATION	PROJECT NUMBER	SHEET NO.
OREGON DIVISION	IM-S001(169)	1

INDEX OF SHEETS, CONT'D.	
SHEET NO.	DESCRIPTION
PERMANENT PAVEMENT MARKINGS	
ST-1 Thru ST-3, Incl.	Striping Plan
GEO/HYDRO	
GHA-1 Thru GHA-3, Incl.	Erosion Control Plan
PERMANENT SIGNING	
S-6402, S-6403	Signing Plan
S-6404	Sign Details
S-6405, s-6406	Sign & Post Data Table
ILLUMINATION	
I-0953	Illumination Plan
I-0954	Light Pole Table & Details
TRAFFIC SIGNALS	
13207	Signal Plan Legend
13208	Pole Information
13209	Signal Plan
13210	Detector Plan

Standard Drg. Nos.

- RD210 - Exit Ramp Details
- RD300 - Circular Pipe Backfill/Compaction
- RD306 - Conc. Encasement, Cradle, & Cap Details
- RD312 - Subsurface Drains
- RD316 - Sloped Ends, Metal Pipe
- RD318 - Sloped Ends, Conc. Pipe
- RD320 - Paved End Slope
- RD326 - Coupling Bands
- RD336, RD342, RD344, RD346, RD356 } - Manholes
- RD364, RD368 - Concrete Inlets
- RD386 - Pipe Fill Height Tables
- RD400, RD405, RD410, RD415, RD420, RD425, RD440, RD450 } - Guardrails
- RD545 - Guardrail Conn. to Conc. Barrier
- RD580 - Precast Tall Conc. Barrier
- Tall Conc. Barrier to Curb Transition
- RD610 - Asphalt Pavement Details
- RD800, RD805 - Traffic Delineators
- RD815 - Chain Link Fence
- RD900, RD920, RD935, RD945 - Traffic Control Plans
- RD960 - Temp. Impact Attenuators
- RD1000 - Construction Entrances
- RD1015 - Inlet Protection
- RD1040 - Sediment Fences
- RD1055 - Temp. Scour Hole
- BR203 - Transition Conc. Br. Rail To Guardrail
- BR900 - Multi-Post Breakaway Sign Supports
- BR906 - Triangular Base Breakaway
- BR956, BR960 - Slip Base & Fixed Base Luminaire Supports
- BR963, BR966 - Traffic Signal Supports
- BR983 - Breakaway Sign & Luminaire Supports

Standard Drg. Nos. Contd.

- TM100 - Temp. Wood Post Sizing Charts
- TM105 - Orange Flag Board Mounting Details
- TM200, TM201, TM202, TM205 - Sign Installation Details
- TM206, TM207 - Sign Mounting Details
- TM211 - Signing Details
- TM214, TM215 - Perm. Wood Post Sizing Charts
- TM217 - Route Markers & Secondary Assemblies
- TM218 - Secondary Signing Mounting Details
- TM219 - Steel Pole Mounted Sign Details
- TM220 - Multi-Post Installations
- TM224 - Directional Sign Layout
- TM225 - Exit No. & Gore Signing Details
- TM230, TM231, TM232, TM233 - Mounting Details For Removable Legend
- TM300, TM301 - Illumination Cabinets
- TM310 - Illumination Details
- TM403 - Mast Arm Pole Details
- TM405 - Pole Foundations & Grounding
- TM406, TM407 - Vehicle Signal Details
- TM409, TM410 - Pedestrian Signals
- TM411 - Crosswalk Closure Details
- TM416 - Overhead Sign Details
- TM417, TM418 - Junction Boxes
- TM419 - Loop Details
- TM421 - Color Code Charts
- TM423, TM424, TM427, TM428 - Cabinets
- TM500, TM501, TM502 - Pavement Markings
- TM539 - Left Turn Pavement Markings



I-5: NB EXIT RAMP AT VAN DUYN RD. (COBURG INTCHGE.) SEC. PACIFIC HIGHWAY LANE COUNTY		
FEDERAL HIGHWAY ADMINISTRATION	PROJECT NUMBER	SHEET NO.
OREGON DIVISION	IM-S001(169)	1A

US97: SPRING CR. HILL - MODOC PT. (UNIT 1) SEC.
THE DALLES-CALIF. HWY., CHILOQUIN HWY., & CHILOQUIN SPUR
KLAMATH COUNTY
OCTOBER 2003

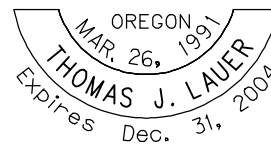

Thomas J. Lauer
 ACTING TECHNICAL SERVICES MANAGING ENGINEER

ATTENTION:
 Oregon Law Requires You To Follow Rules Adopted By The Oregon Utility Notification Center. Those Rules Are Set Forth In OAR 552-001-0010 Through OAR 552-001-0090. You May Obtain Copies Of The Rules By Calling The Center. (Notes The Telephone Number For The Oregon Utility Center Is (503) 232-1987.)

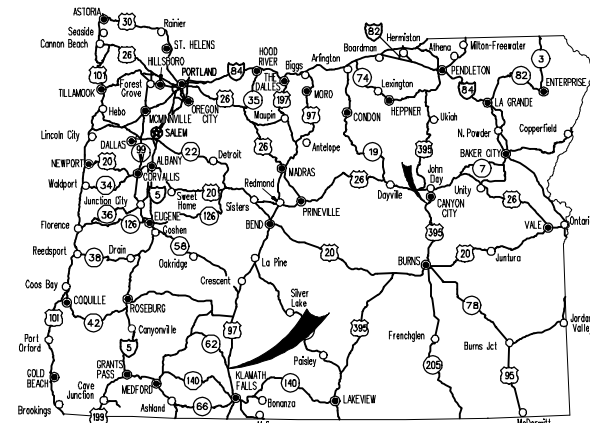

T 34-36 S.,
 R. 7 E., W.M.

Overall Length Of Project - 19.5 km (12.15 Miles)

END OF PROJECT

STA. "C" 0+260 (M.P. 0.16)

BEG. OF PROJECT

STA. "C" 5+619 (M.P. 3.46)

BEG. OF PROJECT

STA. "CS" 7+040 (M.P. Y4.39)

END OF PROJECT

STA. "CS" 7+273 (M.P. Y4.54)

END OF PROJECT

STA. "C" 8+560 (M.P. 5.29)

BEG. OF PROJECT

STA. "C" 0+000 (M.P. 0.00)

BEG. OF PROJECT

X-NH-OTIA-S000(191)

STA. 398+800 (M.P. 247.80)

END OF PROJECT

X-NH-OTIA-S000(191)

STA. 414+920 (M.P. 257.81)

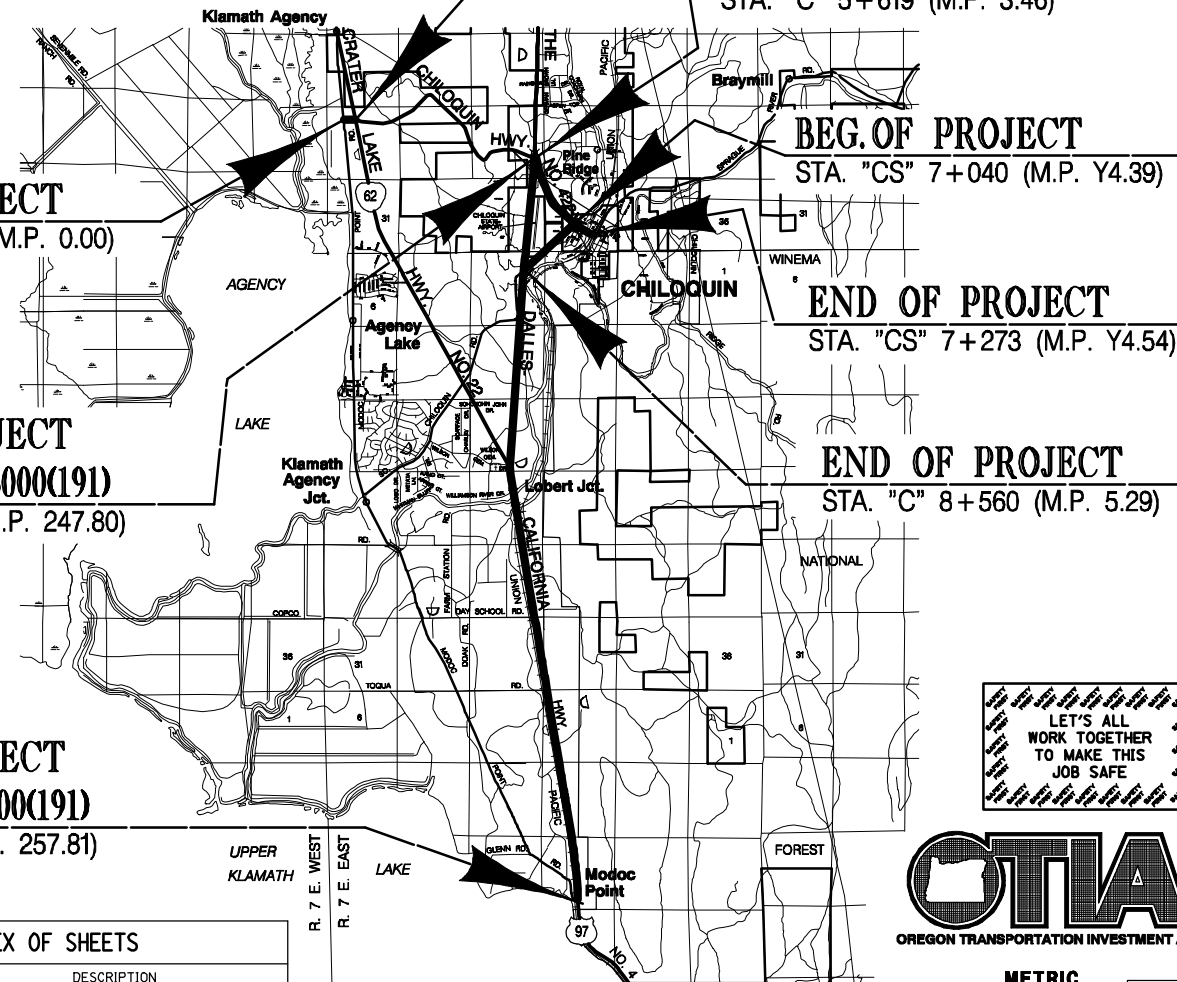

LET'S ALL
 WORK TOGETHER
 TO MAKE THIS
 JOB SAFE



INDEX OF SHEETS	
SHEET NO.	DESCRIPTION
1	Title Sheet
1A	Sheet Index Cont'd. & Standard Drg. Nos.

SHEET NO. 1

US97: SPRING CR. HILL - MODOC PT. (UNIT 1) SEC.
THE DALLES-CALIF. HWY., CHILOQUIN HWY., & CHILOQUIN SPUR
KLAMATH COUNTY

INDEX OF SHEETS, CONT'D.	
SHEET NO.	DESCRIPTION
2, 2A Thru 2A-10 Incl.	Typical Sections
2B Thru 2B-4 Incl.	Details
3, 4, 5	General Construction
PERMANENT PAVEMENT MARKINGS	
13258	Traffic Count/Classifier Legend
13259	Traffic Count/Classifier Installation

Standard Drg. Nos.

- RD100 - Mailbox Installations
- RD400, RD405, RD410, RD415, RD430 - Guardrail
- RD600 - Portland Cement Concrete Pavement
- RD800 - Traffic Delineators
- RD900, RD910, RD915, RD920, RD945, RD950 - Traffic Control Plans
- BR203 - Standard Transition Conc. Br. Rail To Guardrail
- TM100 - Temp. Wood Post Sizing Charts
- TM105 - Orange Flag Board Mounting Details
- TM417, TM418 - Traffic Signal Junction Boxes
- TM419 - Loop Details
- TM525 - Pavement Marking Details
- TM527, TM537, TM539, TM545, TM547, TM555 - Pavement Markings



SHEET NO. 1A

INDEX OF SHEETS	
SHEET NO.	DESCRIPTION
1	Title Sheet
1A	Index Of Sheets Cont'd. & Std. Drg. Nos.
2, 2A	Typical Sections
2B Thru 2B-4 Incl.	Details
2C Thru 2C-4, Incl.	Traffic Control Plan
2D	Erosion Control Plan
2E	Pipe Data
3	General Construction - "MC" Line
3A	Profile - "MC" Line
4, 4A	General Construction - "CGC" Line
4B	Profile - "CGC" Line
4C	Profile - "GWe" & "GW" Line

STATE OF OREGON
 DEPARTMENT OF TRANSPORTATION
 PLANS FOR PROPOSED PROJECT
GRADING, PAVING, SIGNING, & SIGNALS
I-5 AT COTTAGE GROVE INTCHGE. SEC.
PACIFIC HIGHWAY
 LANE COUNTY
 NOVEMBER 2003

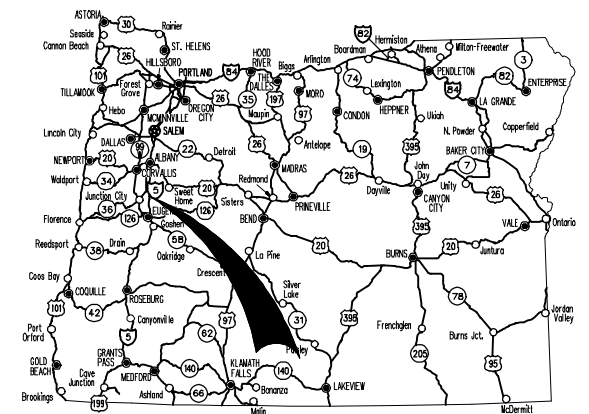

Overall Length Of Project - 0.75 km (0.47 Miles)

BEGINNING OF PROJECT X-IM-S001(165)
 STA. "MC" 12+664.324 (M.P. 175.03 = 3C175.03)

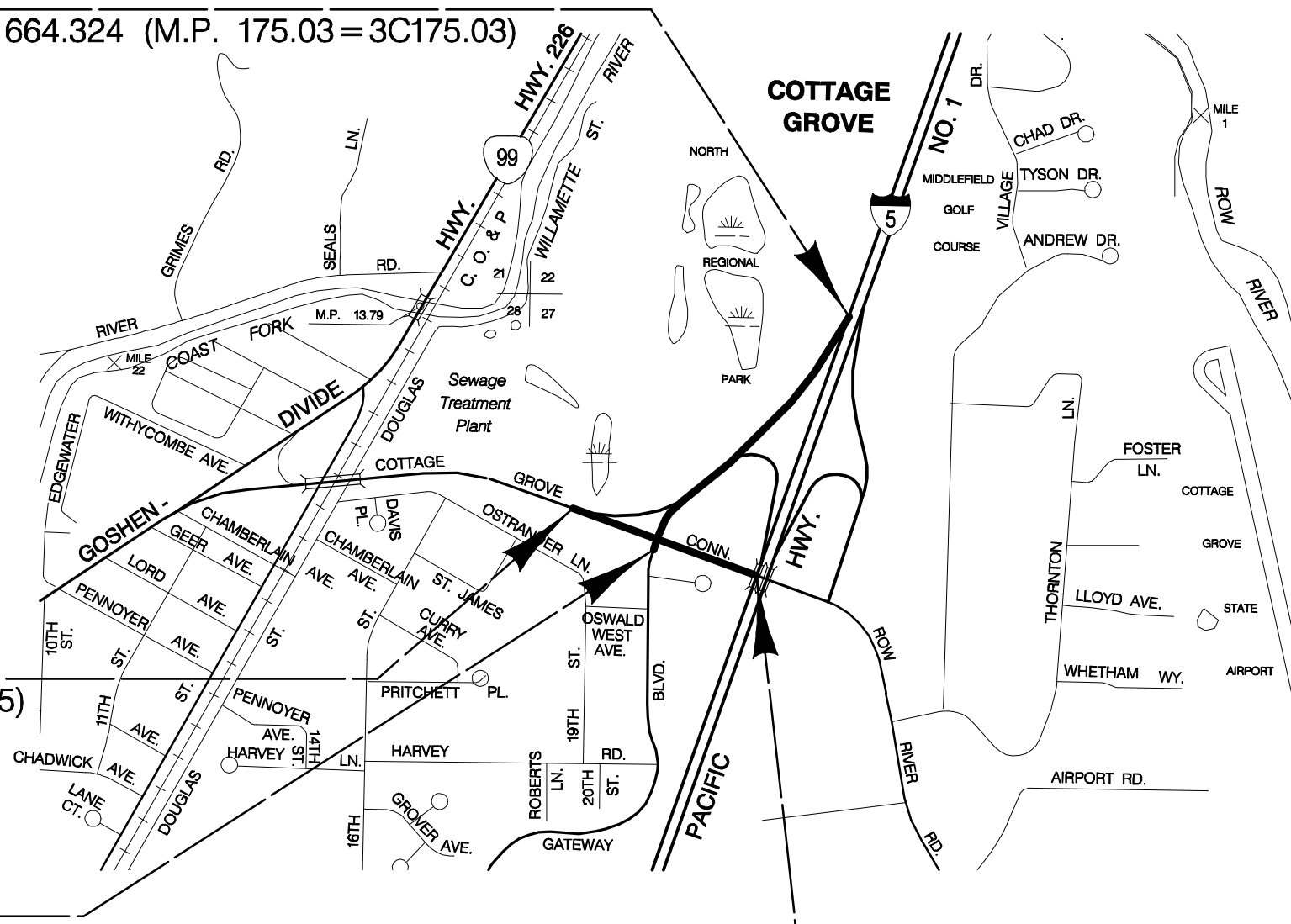

BEGINNING OF PROJECT
 STA. "CGC" 30+340 (M.P. 6C174.75)

END OF PROJECT
 STA. "GW" 40+030 (M.P. 3C175.34)

END OF PROJECT X-IM-S001(165)
 STA. "CGC" 30+700 (M.P. 1C174.74)

ATTENTION:
 Oregon Law Requires You To Follow Rules Adopted By The Oregon Utility Notification Center. Those Rules Are Set Forth In OAR 952-001-0010 Through OAR 952-001-0090. You May Obtain Copies Of The Rules By Calling The Center. (Note: The Telephone Number For The Oregon Utility Center Is (503) 232-1987.)



OREGON TRANSPORTATION COMMISSION
 Stuart Foster CHAIRMAN
 Gail L. Achterman COMMISSIONER
 Mike Nelson COMMISSIONER
 Randall Papé COMMISSIONER
 John Russell COMMISSIONER
 Bruce A. Warner DIRECTOR OF TRANSPORTATION

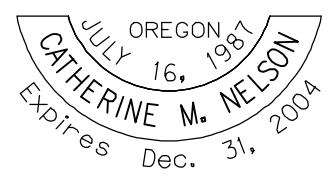
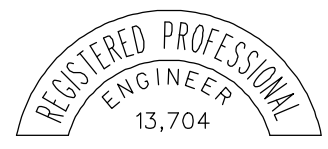

Catherine M. Nelson
 TECHNICAL SERVICES MANAGING ENGINEER

I-5 AT COTTAGE GROVE INTCHGE. SEC.
 PACIFIC HIGHWAY
 LANE COUNTY

FEDERAL HIGHWAY ADMINISTRATION	PROJECT NUMBER	SHEET NO.
OREGON DIVISION	X-IM-S001(165)	1

T. 20 S., R. 3 W., W.M.



INDEX OF SHEETS, CONT'D.	
SHEET NO.	DESCRIPTION
PERMANENT PAVEMENT MARKINGS	
ST-1, ST-2	Striping Plans
PERMANENT SIGNING	
XXXX1, XXXX2	Signing Plans
XXXX3	Sign Details
XXXX4, XXXX5	Sign & Post Data Tables
SIGNALS	
13260	Signal Plan Legend
13261	Pole Entrance Chart
13262	Signal Removal & Temp. Signal Plan
13263	Signal Plan
13264	Detector & Interconnect Plan

Standard Drg. Nos.

RD215, RD220	- Channelization & Intersection Details	TM100	- Temp. Wood Post Sizing Charts
		TM105	- Orange Flag Board Mounting Details
RD300	- Trench Backfill	TM200, TM201, TM202, TM205	- Sign Installation Details
RD302	- Street Cut	TM206, TM207	- Sign Mounting Details
RD318	- Sloped Ends For Conc. Pipe	TM211	- Signing Details
RD322	- Safety End Section Metal Pipe	TM214, TM215	- Perm. Wood Post Sizing Charts
RD360	- Manhole Frame Adjustment	TM216	- Sign Installation Br. Mount Details
RD366	- Conc. Inlets Type CG-1, CG-2, & Curb Inlet	TM217	- Route Markers & Secondary Assemblies
RD380, RD384, RD386	- Pipe Fill Height Tables	TM218	- Secondary Signing Mounting Details
RD400, RD405, RD415	- Guardrail	TM219	- Steel Pole Mounted Sign Details
RD420, RD450		TM223, TM224	- Directional Sign Layout
RD610	- Asphalt Pavement Details	TM225	- Exit No. & Gore Signing Details
		TM233	- Mounting Details For Removable Legend
RD700	- Curbs	TM400	- Temp. Signal Details
RD705	- Islands & Traffic Separators	TM403	- Mast Arm Pole Details
RD710	- Accessible Route Islands	TM404	- Span Wire Details
RD720	- Sidewalks	TM405	- Pole Foundations & Grounding
RD755	- Sidewalk Ramp Details	TM406, TM407, TM408	- Vehicle Signal Details
RD760	- Sidewalk Ramp Placement	TM409, TM410	- Pedestrian Signals
RD900, RD905,	- Traffic Control Plans	TM411	- Crosswalk Closure Details
RD910, RD945	- Barricades	TM415	- Mast Arm Mounted Warning Sign
RD950		TM416	- Overhead Sign Details
BR906	- Triangular Base Breakaway	TM417, TM418	- Junction Boxes
BR963, BR966	- Traffic Signal Supports	TM419	- Loop Details
		TM421	- Color Code Charts
		TM422	- Miscellaneous Details
		TM423	- Controller Cabinet & Related Details
		TM424	- Post & Pedestal Cabinets
		TM428	- Terminal Cabinets
		TM435	- Interconnect
		TM500, TM501, TM502	- Pavement Markings
		TM511	- Bike Lane Pavement Markings
		TM539	- Left Turn Pavement Markings



I-5 AT COTTAGE GROVE INTCHGE. SEC. PACIFIC HIGHWAY LANE COUNTY		
FEDERAL HIGHWAY ADMINISTRATION	PROJECT NUMBER	SHEET NO.
OREGON DIVISION	X-IM-S001(165)	1A

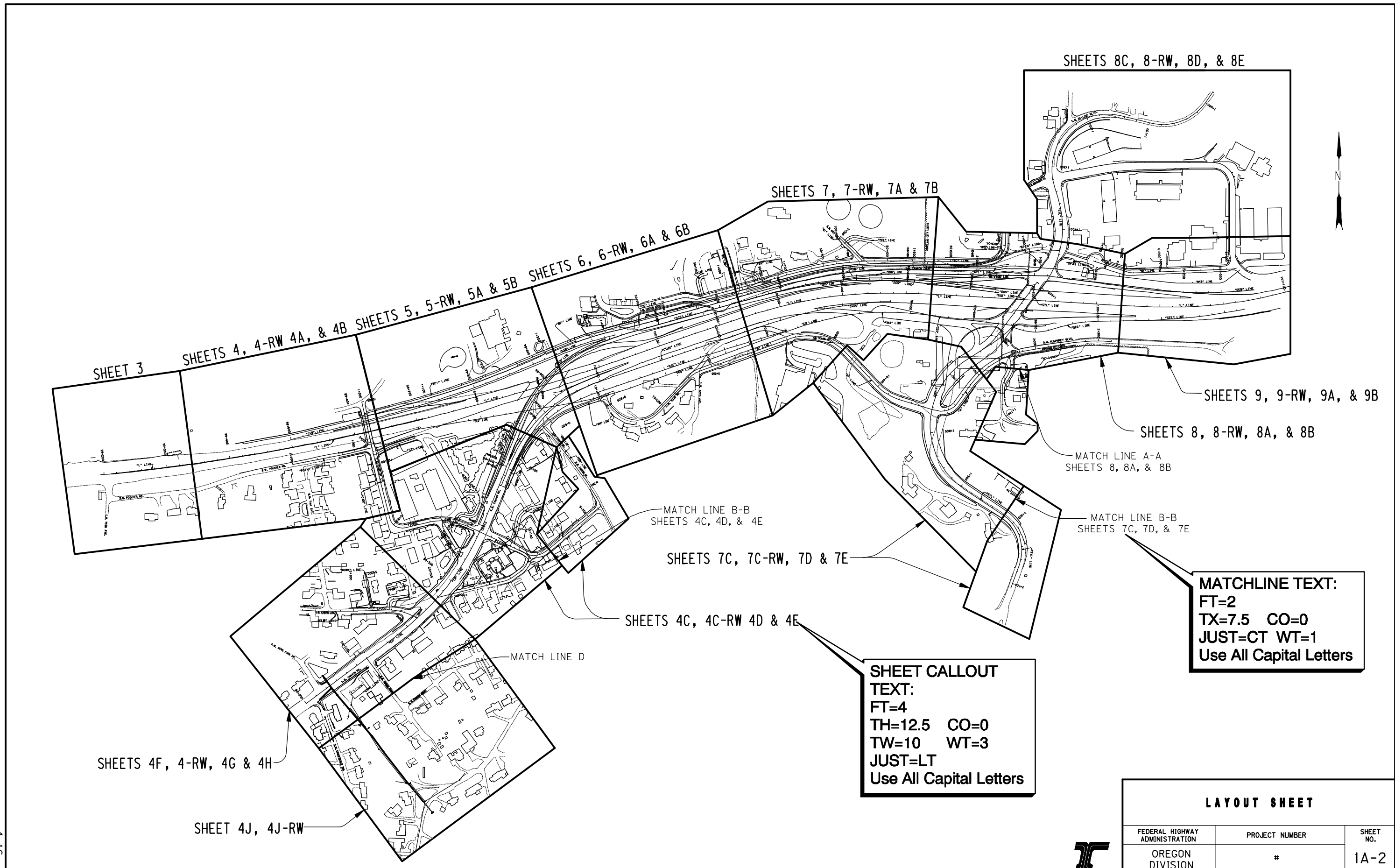

SHEET 3

SHEETS 4, 4-RW, 4A, & 4B

SHEETS 5, 5-RW, 5A & 5B

SHEETS 6, 6-RW, 6A & 6B

SHEETS 7, 7-RW, 7A & 7B

SHEETS 8C, 8-RW, 8D, & 8E

SHEETS 9, 9-RW, 9A, & 9B

SHEETS 8, 8-RW, 8A, & 8B

MATCH LINE A-A
SHEETS 8, 8A, & 8B

MATCH LINE B-B
SHEETS 4C, 4D, & 4E

MATCH LINE B-B
SHEETS 7C, 7D, & 7E

SHEETS 7C, 7C-RW, 7D & 7E

SHEETS 4C, 4C-RW, 4D & 4E

MATCH LINE D

SHEETS 4F, 4-RW, 4G & 4H

SHEET 4J, 4J-RW

MATCHLINE TEXT:
 FT=2
 TX=7.5 CO=0
 JUST=CT WT=1
 Use All Capital Letters

SHEET CALLOUT TEXT:
 FT=4
 TH=12.5 CO=0
 TW=10 WT=3
 JUST=LT
 Use All Capital Letters

LAYOUT SHEET		
FEDERAL HIGHWAY ADMINISTRATION	PROJECT NUMBER	SHEET NO.
OREGON DIVISION	#	1A-2



4-16