

**SLIDE CREEK - FRANKPORT SEC.
OREGON COAST HIGHWAY
CURRY COUNTY**

DETAILS

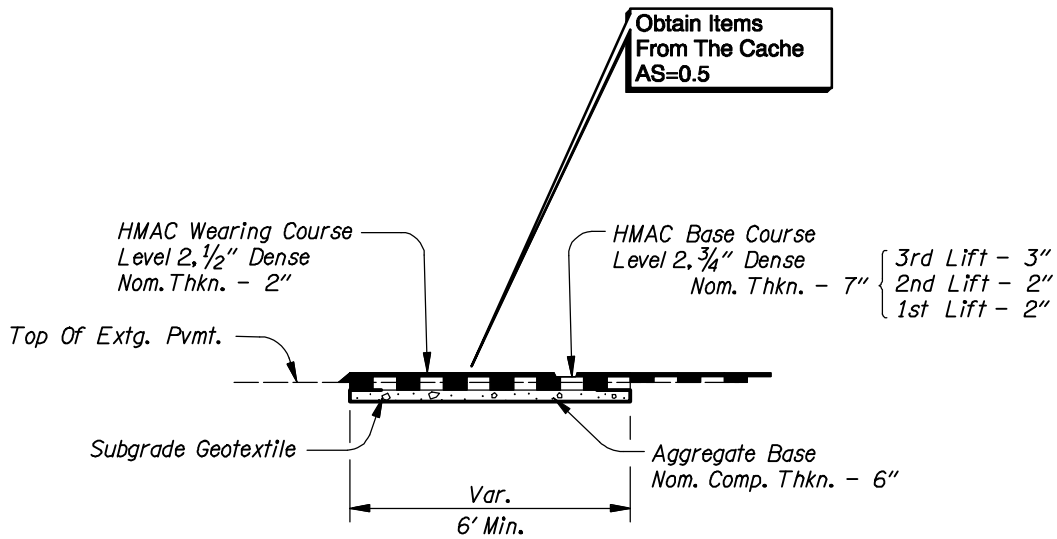

SUBGRADE STABILIZATION

(Locations As Directed)

15-3

31-MAY-2004 12:00

file:///p:\p\adot\stark\us\tech\enr\contractplans\road\design\examples\cpd\cpd.rpt

SHEET NO.

2A

**SLIDE CREEK - FRANKPORT SEC.
OREGON COAST HIGHWAY
CURRY COUNTY**

CONSTRUCTION DATA

CONSTRUCT CURB

**TABLE
LINEWORK:
CO=6
LC=0
WT=1**

| STA. To STA. | LT. | RT. | TYPE |
|---------------|-----|-----|----------|
| | | | DRAINAGE |
| 35+89 - 38+93 | ✓ | | 304' |
| 39+08 - 39+42 | ✓ | ✓ | 34' |
| 52+09 - 53+10 | ✓ | | 101' |
| | | | |
| | | | |
| | | | |
| | | | |

**TABLE TEXT:
FT=2
TX=7.5 CO=6
JUST=CC WT=1**

CONSTRUCT SLOPED END

**COLUMN TITLE
TEXT:
FT=2
TX=12.5 CO=6
JUST=CC WT=2**

| STA. | LT. | RT. | TYPE OF EXTG. PIPE | NO. REQD. |
|-------|-----|-----|-----------------------|--------------|
| 07+45 | ✓ | | 18" C.M.P. | 2 |
| 42+53 | | ✓ | 18" C.M.P. | 2 |
| 43+11 | | ✓ | 18" C.M.P. | 2 |
| | | | | |
| | | | | |
| | | | | |
| | | | | |

**TABLE TITLE:
FT=2
TX=15 CO=6
JUST=CB WT=2**

GUARDRAIL TABLE

I:\p\1\p\odot\stahar.us\tech\enr\contractplans\roaddesign\examples\sp\spart1 31-MAY-2004 12:00

| STA. To STA. | LT. | RT. | ADJUST | CONST. TYPE 2A | END TREATMENT | CONST. ANCHOR | WITH 8' POSTS |
|---------------|-----|-----|--------|-------------------|------------------|------------------|---------------------|
| 00+00 - 02+57 | | ✓ | 257' | | | | |
| 16+08 - 17+30 | | ✓ | | 122' | Type "C" | Type 1 | |
| 20+98 - 22+77 | | ✓ | | 179' | 2 -Type "C" | 2 -Type 1 | 96 |
| 30+29 - 31+72 | | ✓ | | 143' | Bury End - 2 | 2 - Type 1 Mod. | |
| | | | | | | | |
| | | | | | | | |
| | | | | | | | |

**CHECK MARK CELL:
AC=CHECK
AS=1
WT=1
Use ODOT.CEL
Cell Library**

15-4

SHEET
NO.

2B

**SLIDE CREEK - FRANKPORT SEC.
OREGON COAST HIGHWAY
CURRY COUNTY**

CONSTRUCTION DATA

APPROACH AND
MAILBOX LOCATIONS

| STA. | LT. | RT. | APPR. | MAIL BOX | WIDTH |
|-------|-----|-----|-------|----------|-------|
| 05+80 | ✓ | | ✓ | | 46' |
| 06+61 | ✓ | | ✓ | | 49' |
| 06+79 | | ✓ | ✓ | | 66' |
| 07+45 | ✓ | | ✓ | | 30' |
| 07+45 | | ✓ | ✓ | | 66' |
| 21+35 | ✓ | | | ✓ | 10' |
| 21+62 | ✓ | | ✓ | | 42' |
| 36+36 | | ✓ | ✓ | | 50' |
| 40+85 | | ✓ | ✓ | | 46' |
| 40+98 | | ✓ | | ✓ | 10' |
| 41+03 | ✓ | | ✓ | | 66' |
| 41+14 | ✓ | | | ✓ | 10' |
| 42+49 | ✓ | | | ✓ | 10' |
| 42+53 | | ✓ | ✓ | | 22' |
| 42+61 | ✓ | | ✓ | | 43' |
| 43+11 | | ✓ | ✓ | | 39' |
| 43+15 | | ✓ | | ✓ | 10' |
| 45+27 | ✓ | | | ✓ | 10' |
| 45+43 | ✓ | | ✓ | | 52' |
| 47+73 | | ✓ | ✓ | | 33' |
| | | | | | |
| | | | | | |
| | | | | | |

INST. MAILBOX SUPPORT

| STA. | LT. | RT. | SINGLE | MULTI. | PAPER |
|-------|-----|-----|--------|--------|-------|
| 21+35 | ✓ | | ✓ | | |
| 40+98 | | ✓ | | ✓ | |
| 41+14 | ✓ | | ✓ | | ✓ |
| 42+49 | ✓ | | | | ✓ |
| 43+15 | | ✓ | ✓ | | |
| 45+27 | ✓ | | ✓ | | ✓ |
| | | | | | |
| | | | | | |
| | | | | | |

I:\p\2004\stataar_us\tech\contractplans\road\design\examples\opdgn.pr1 31-MAY-2004 12:00

15-5

SHEET NO.

2B-2

15-5

24+00 25+00 26+00 27+00 28+00 29+00 30+00

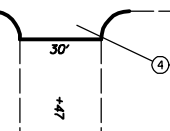
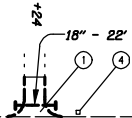

- ① Sta. 25+24, Lt.
Const. Appr.
Inst. 18" Culv. Pipe - 22'
5' Depth
Tr. Exc. - xx CY.
(See Drg. No. RD715)
- ② Sta. 32+52, Rt.
Const. Appr.
Inst. 12" Culv. Pipe - 20'
5' Depth
Tr. Exc. - xx CY.
- ③ Sta. 28+47, Rt.
Const. P.C. Conc. Dwy. Type "A"
(See Drg. No. RD715)
- ④ Inst. Single Wallbox Support - 3
Const. Conc. Collar - 3
(See Drg. No. RD100)

EXTG EDGE OF PAVEMENT:
CO=2 LC=3
WT=1

CONSTRUCTION CENTERLINE:
CO=3
LC=0 WT=5

CONSTRUCTION NOTE BUBBLE:
Use ODOT MENU/
FDPlans/Notes

CONSTRUCTION NOTE TEXT:
FT=24 TX=7.5
LS=5 CO=3
WT=2 JUST=LT
Or Use ODOT MENU/
FDPlans/Notes

MAJOR TIC:
CO=3
WT=3 LC=0

MINOR TIC:
CO=3
WT=2 LC=0

STATION TEXT:
FT=2 TX=12.5
CO=3 WT=3
JUST=CC

30+00 31+00 32+00 33+00 34+00 35+00 36+00

LANE WIDTH TEXT:
FT=24 TX=6.3
CO=3 WT=1
JUST=CC

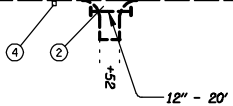

| | |
|---|-----------|
| OREGON DEPARTMENT OF TRANSPORTATION ROADWAY ENGINEERING SECTION | |
| PROJECT SEC. PROJECT HIGHWAY PROJECT COUNTY | |
| STRAIGHTLINE SHEETS | |
| | SHEET NO. |

15-6