



OREGON PREPARED

EMERGENCY
PREPAREDNESS
CONFERENCE

2 0 2 6



Welcome to the 2026 Oregon Prepared Conference.

It's an honor to come together again with emergency management professionals across Oregon—local, tribal, county, state, federal, nonprofit and private-sector partners—united by a shared commitment to preparedness, response, recovery and mitigation.

This past year challenged our state with extreme weather, wildfires and floods—each testing the strength and readiness of our emergency management system. Time and again, Oregon's emergency management community has risen to the occasion by working together, innovating under pressure and focusing on our mission of helping people before, during and after disasters. Additionally, we were faced with the roller coaster of federal funding issues which we know created challenges both in delivering emergency management programs and in maintaining the trust you have built within the communities you serve.

At OEM, we've been focusing on our “why” as we strengthen our partnerships and build a whole-community approach. This work led to updated Mission, Vision and Values:

- **Mission:** Lead collaborative, statewide efforts to support Oregon's communities before, during and after emergencies.
- **Vision:** A ready and resilient Oregon.
- **Values:** Service, Collaboration, Communication, Integrity and Leadership.

Over the next two days, we look forward to discussing Oregon's emergency management enterprise—what's working for you, where you need support, and where we're heading. This includes new investments in our crisis management system and the development of the Oregon Emergency Communication and Coordination Center (OEC3), the launch of our 24-hour Watch Center, and the rollout of our new grants management system.

We continue advancing our strategic goals of accountability, transparency, customer service, modernization and readiness—laying the foundation for a more connected, resilient and prepared Oregon.

Finally, this conference is more than professional development. It's an opportunity to connect, share and strengthen the partnerships that help our communities face adversity and succeed.

Thank you for your dedication, service and unwavering commitment. I look forward to what we will continue to build—together.



Erin McMahon
OEM Director



GENERAL INFORMATION



Welcome to our tenth annual Oregon Prepared Conference! Please review the information provided below about this year's event.

WIFI:

- **Network ID:** Sunriver events
- **Password:** SUNRIVEREVENTS!

REGISTRATION MATERIALS, CREDENTIALS AND MEALS:

- Conference credentials must be worn during all conference activities.
- Meals and plenary sessions will be held in the Homestead Ballroom.
- Evaluations for each session will be done via electronic survey.
- A survey for the full workshop will be emailed to each attendee.
- OEM has a photographer to capture images for future events.
- Media may be onsite.
- A group photo will be taken on Thursday from 1:15-1:30 immediately following lunch outside on the "Mt. Bachelor Lawn" outside of the Great Hall.
- Visit our exhibitor hall in the in the Great Hall Parking lot between Homestead and the Great Hall on Wednesday from 10-6pm and Thursday from 8-5pm. There will be a dedicated Exhibitor Social on Thursday from 12:15-1:15pm.
- Coffee will be available in the Exhibitor Hall for the durations listed above.

OPTIONAL THURSDAY EVENING SOCIAL:

- Join us Thursday evening from 6:30-9:00 p.m. in the Great Hall for games, a movie, karaoke and trivia.

TRANSPORTATION:

- Shuttle Service is available for any guest to ride to and from any location in Sunriver. You can call 541-593-1000 or text 541-444-0043.

OREGON PREPARED 2026

COMMUNICATION • COLLABORATION • COMMUNITY



SAFETY MESSAGE/PLAN

- Call 911 for police, fire or EMS emergencies.
- Report any injuries to OEM staff.
- A first-aid kit is located at the registration desk.
- Stay home or in your lodging at Sunriver if you suspect you are ill.

Urgent Care Bend South:

St. Charles Urgent Care
61250 SE Coombs Pl
Bend, OR 97702
541-706-5930

Urgent Care Sunriver:

High Desert Family Medicine
57067 Beaver Dr
Sunriver Village, OR 97707
541-593-5400

Hospital:

St. Charles Bend
2500 NE Neff Rd
Bend, Oregon 97701
541-382-4321

OREGON PREPARED 2026

COMMUNICATION • COLLABORATION • COMMUNITY

TUESDAY		APRIL 14	
	HOMESTEAD 1	HOMESTEAD 2	HOMESTEAD 3
12:00-6:00 P.M.	REGISTRATION DESK OPEN IN EXHIBITOR HALL		
1:00-5:00 P.M.	OEM Grants Software EMPG Workshop	Psychological First Aid (PFA) for Disaster Response	Home and Business Damage Assessment Training

WEDNESDAY		APRIL 15	
7:00 A.M.-3:00 P.M.	REGISTRATION DESK OPEN IN EXHIBITOR HALL		
8:00-9:15 A.M.	BREAKFAST PLENARY: OPENING CEREMONIES (HOMESTEAD)		
9:15-9:30 A.M.	BREAK		
	HERITAGE TRACK: PREPAREDNESS & MITIGATION	GREAT HALL TRACK: RESPONSE & OPERATIONS	LANDMARK TRACK: RECOVERY & RESILIENCE
9:30 - 10:30 A.M.	Exponential Collaboration: Getting the Most Out of Meetings	Using ArcGIS Storymaps to Inform and Educate	COADs & LTRGs as Infrastructure: Value, Opportunities, and Challenges as a Standing Partner in Oregon's Disaster System
10:30 - 10:45 A.M.	BREAK		
10:45 - 11:45 A.M.	Tribal Sovereignty and Cultural Protection in Emergency Management	EOC Building, Layout, Fixing, IMTs and Best Practices	Tai Chi Relaxation & Qi Gong Meditation for Emergency Managers' Self-Resilience
11:45 - 12:00 P.M.	BREAK		
12:00 - 1:30 P.M.	LUNCH PLENARY: CARRYING THE LEGACY FORWARD - THE TRANSITION OF THE OREGON EMERGENCY RESPONSE SYSTEM (OERS) TO OEM (HOMESTEAD)		
1:30 - 1:45 P.M.	BREAK		
1:45 - 2:45 P.M.	Virtual Call Centers Part 2: Building a Scalable AFN Evacuation Outreach Program	OSSA Type 3 Incident Management Team (IMT); How Type 3 IMTs Can Bridge the Mutual Aid Gap in a Time of Uncertainty	Adopting an Airport Friends and Relatives Center (FRC) Model for Post-Disaster Coordination and Reunification
2:45 - 3:00 P.M.	BREAK		
3:00 - 4:00 P.M.	Conducting a Community-Led THIRA with Research Modeling of the Oregon Coast as One Region	RADIOACTIVE WASTE IS COMING! What is Hanford, and Why Does Oregon Have a Role to Play?	Fragile by Design: When One Fiber Cut Shuts Down a County
4:15 - 5:00 P.M.		Local Emergency Manager Round Table (Invitation Only)	
5:00 - 6:00 P.M.	BREAK		
6:00 - 8:00 P.M.	KEYNOTE DINNER: AI IN EMERGENCY MANAGEMENT - BECAUSE YOUR TO DO LIST WASN'T LONG ENOUGH (HOMESTEAD)		

THURSDAY

APRIL 16

7:00 A.M. - 3:00 P.M.	REGISTRATION DESK OPEN IN EXHIBITOR HALL		
8:00 - 9:00 A.M.	BREAKFAST PLENARY: LEGISLATIVE PANEL DISCUSSION (HOMESTEAD)		
9:00 - 9:15 A.M.	BREAK		
	HERITAGE TRACK: PREPAREDNESS & MITIGATION	GREAT HALL TRACK: RESPONSE & OPERATIONS	LANDMARK TRACK: RECOVERY & RESILIENCE
9:15 - 10:15 A.M.	Grants That Strengthen Preparedness: SPIRE and EMPG Essentials	Drones on the Front Line: Real-World UAS Operations in Oregon Emergencies	DOGAMI Data's Role in Pre-Disaster Mitigation and Post-Disaster Recovery
10:15 - 10:30 A.M.	BREAK		
10:30 - 12:00 A.M.	Person-Centered Emergency Preparedness (P-CEP) Workshop	We're All in This Together: Building Energy Security at All Levels	Strategic Engagement: Leveraging the Right Method of Community Outreach to Inform Planning
12:00 - 1:15 P.M.	LUNCH: EXHIBITOR SOCIAL HOUR (HOMESTEAD)		
1:15 - 1:30 P.M.	GROUP PHOTO - MT. BACHELOR LAWN		
1:45 - 2:45 P.M.	Let's Level up Our Exercises, Together	Strengthening Rural Resilience Community & Livestock Pre-Registration and Resource Management Through Relief Compass	After the Fire: Wildfire Debris Management and Data Collection
2:45 - 3:00 P.M.	BREAK		
3:00 - 4:00 P.M.	Continuity Clue: A Fun Approach to Serious Preparedness	International Humanitarian Aid and Disaster Response: What its issues, strengths, and weaknesses might highlight in domestic emergency management	Community-Led Recovery: Rebuilding After Disaster with Empathy, Intention, and Resilience
4:15 - 5:00 P.M.		Tribal Emergency Management Caucus (Invitation Only)	
5:00 - 6:30 P.M.	DINNER ON YOUR OWN		
6:30 - 9:30 P.M.	SOCIAL NIGHT (GREAT HALL)		

FRIDAY

APRIL 17

8:00 - 9:00 A.M.	BREAKFAST PLENARY: INCIDENT MANAGEMENT TEAM PANEL (HOMESTEAD)		
9:00 - 9:15 A.M.	BREAK		
	HERITAGE TRACK: PREPAREDNESS & MITIGATION	GREAT HALL TRACK: RESPONSE & OPERATIONS	LANDMARK TRACK: RECOVERY & RESILIENCE
9:15 - 10:15 A.M.	Inclusive Whole-Community Preparedness Engagement	The Other Planning P: How Land Use Planning Creates Your Response Environments	Long-Term Large-Scale Permanent Disaster Recovery Housing: Lessons Learned from the 2020 Disasters
10:15 - 10:30 A.M.	BREAK		
10:30 - 11:30 A.M.	What Building an Educational Escape Room Taught Me About Emergency Preparedness Messaging	Understanding Special Districts and Community Lifelines	Building Public Health Preparedness and Resilience in Rural and Remote Communities
11:30 - 11:40 A.M.	BREAK		
11:40 - 12:00 P.M.	CLOSING SESSION		



SUNRIVER LODGE RESTAURANTS
 The Lodge Kitchen
 The Owl's Nest
 The Backyard Bar & Grill

HOMESTEAD

GREAT HALL

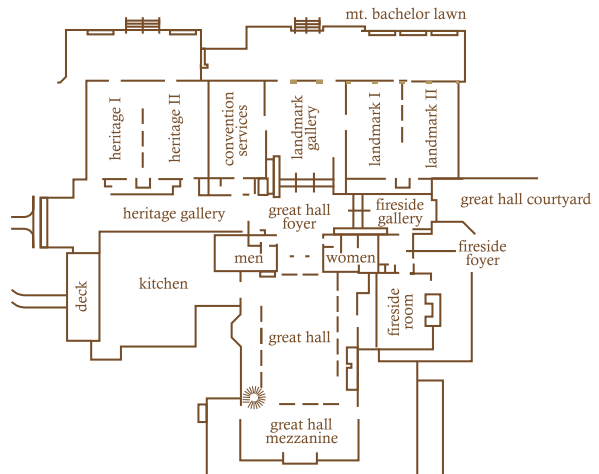
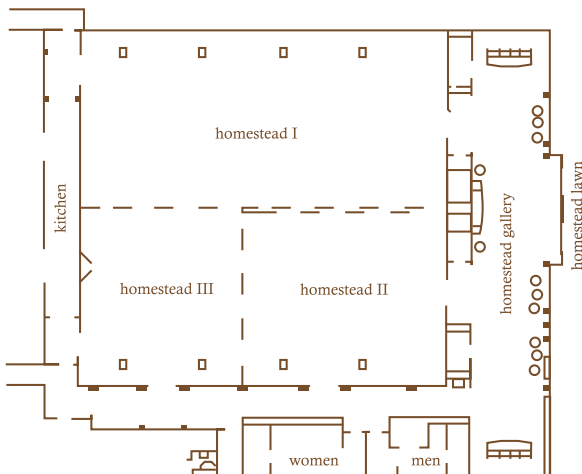

PRE-CONFERENCE ACTIVITIES

OEM Grants Software EMPG Workshop.....Homestead 1

- *Alaina Calhoun, Preparedness Director, Oregon Department of Emergency Management*
- *Bob Johansen, Business Analyst, Oregon Department of Emergency Management*
- *Tabitha Cunningham, Project Manager, Civix*

This hands-on training provides information about the new OEM Grants online portal for the Emergency Management Performance Grant (EMPG) module. This session will walk participants through the system’s core features, including cover application, project tracking, quarterly reports, reimbursement requests, document uploads, and reporting tools. Attendees will receive practical training, tips for navigating the interface, and guidance on transitioning from legacy systems. Whether you're a seasoned grant manager or new to the process, this session will equip you to confidently manage your FEMA grant using OEM Grants. Please bring a laptop to log into the sandbox mode of the system.

Psychological First Aid (PFA) for Disaster ResponseHomestead 2

- *Jeremiah Bridges, Behavioral Health Emergency Planner, Oregon Health Authority*
- *Michelle Morales-Hamilton, Behavioral Health Community Coordinator, Oregon Health Authority*

This course provides and overview of Emergency Behavioral Health Response and Recovery and Psychological First Aid (PFA) for Disaster Response.

Hour 1 – Behavioral Health in Oregon Disasters

- Behavioral health impacts of disasters in Oregon
- Populations most affected during emergencies
- How behavioral health supports disaster response and recovery
- Program development and future
- Where PFA fits within emergency response efforts

Hours 2–3: Psychological First Aid (PFA) Essentials

- Overview of Psychological First Aid
- Core PFA actions
- Practical interaction and engagement techniques
- Supporting survivors, responders, and communities
- Applying PFA in shelters and community settings

Hour 4: Discussion and Feedback

- Open Q and A
- What PFA looks like in the field
- Participant feedback and discussion
- Program questions and lessons learned

Home and Business Damage Assessment Training..... Homestead 3

- *Quinn Butler, Disaster Recovery Program Manager, Oregon Department of Emergency Management*
- *Amanda Fox, State Recovery Coordinator, Oregon Department of Emergency Management*
- *Daniel Stoelb, GIS Program Coordinator, Oregon Department of Emergency Management*

This course provides information about the State of Oregon’s home and business damage assessment process. This course will provide tools and best practices for emergency managers to properly assess home and business damage in the aftermath of a disaster. This course also reviews the FEMA Individual Assistance (IA) and U.S. Small Business Administration (SBA) disaster recovery programs and the necessary information to collect to meet federal disaster assistance criteria. The course will include a hands-on exercise using the Oregon Damage Assessment Survey 123 Tool to allow participants to practice collecting damage assessments as well as work through reviewing and approving submitted entries.

W E D N E S D A Y

A P R I L 15

Opening Ceremonies Plenary Session - Breakfast.....Homestead

Exponential Collaboration: Getting the Most Out of MeetingsHeritage

BREAKOUT: PREPAREDNESS & MITIGATION

• *Susan Trachsel, Assistant Emergency Manager, Lincoln County Sheriff’s Office*
Working together as a team always brings up the same challenges - unclear goals and miscommunication; unstructured meetings leaving you confused; frustration because internal challenges are not addressed; sudden changes in priorities; or compromise instead of clear decision making so people have different interpretations of what was just decided.

Participants will learn why most meetings don't work and a simple structure to improve them. Using this basic structure will allow you to leave a planning meeting with a clear decision and next-steps - without the need for more meetings. Using a workshop called the "Lightening Decision Jam", participants will discover valuable techniques to run a fun and fast workshop. Participants will practice with a scenario. Everyone will be involved in the process using an online platform, so bringing a laptop will help you get the most out of the session.

Using ArcGIS Storymaps to Inform and Educate.....Great Hall

BREAKOUT: RESPONSE & OPERATIONS

- *Daniel Stoelb, GIS Program Coordinator, Oregon Department of Emergency Management*

This session will cover the ArcGIS Storymaps tool and present how your agency can use these solutions to inform and educate your partners on key efforts and initiatives within your agency. Participants will see and hear about storymaps from the Oregon Department of Emergency Management and discuss how users can build a storymap for their agency.

COADs & LTRGs as Infrastructure: Value, Opportunities and Challenges as a Standing Partner in OR’s Disaster SystemLandmark

BREAKOUT: RECOVERY & RESILIENCE

- *Quinn Butler, Disaster Recovery Program Manager, Oregon Department of Emergency Management*
- *Matthew Havniear, Executive Director, Jackson County Community Long Term Recovery Group*

This session examines how Community Organizations Active in Disasters (COADs) and Long Term Recovery Groups (LTRGs) function as a standing partner in Oregon’s disaster system, focusing on practical use rather than structure. We expand our vocabulary beyond COADs and LTRGs to explore creative ways to build and support resilient community infrastructure at appropriate scales. Presenters will discuss how the state can support communities between disasters, and how emergency management and state partners can work with communities before, during, and after disasters to reduce coordination strain, improve handoffs after demobilization, and ensure community capacity is ready when the next event occurs.

Tribal Sovereignty and Cultural Protection in Emergency Management.....Heritage

BREAKOUT: PREPAREDNESS & MITIGATION

- *Danny Martinez, Emergency Manager, Confederated Tribes of Warm Springs*
- *Dr. Elissa Bullion*

This session will examine the legal and sovereign foundations that guide Tribal emergency response and land management. I will cover the Native American Graves Protection and Repatriation Act (NAGPRA) of 1990, specifically focusing on the protection of graves and sacred objects of cultural patrimony. I will also discuss why Tribal Law supersedes State law based on inherent Tribal Sovereignty confirmed by Treaties and Federal laws. If time permits, I will address why the 14th Amendment to the U.S. Constitution does not affect the status of Indian Nations. The primary objective is to provide context on why access to certain areas is restricted during wildfires and major disasters to protect these sovereign and cultural interests.



EOC Building, Layout, Fixing, IMTs and Best PracticesGreat Hall

BREAKOUT: RESPONSE & OPERATIONS

- *Greg Walsh, Director of Emergency Management, Marion County Emergency Management*

In this session I'll talk about EOCs I've seen in Private, City, and County emergencies. I'll discuss successful lay outs and what made them work, some unsuccessful set ups that required some fixing and reorganization. The integration of IMTs and individual members and contractors into teams, and how to ask for help, give guidance, and direction to supporting staff and teams. I'll close with some best practices, tips and tricks to having the right things on hand and a plan for your EOC to be ready for activation.

Tai Chi Relaxation & Qi Gong Meditation for Emergency

Managers' Self-ResilienceLandmark

BREAKOUT: RECOVERY & RESILIENCE

- *Rachelle Lambert, Owner of Ra Harmony Consulting*
- *Peter Van Buren, Sheng Zhen Maryland*

Emergency management is a demanding profession—requiring sharp focus, fast decision-making, and the ability to recover quickly from stressful incidents. At the Oregon Prepared Conference, where practitioners from tribal, local, state, federal, nonprofit, and private sectors come together to learn, share, and connect, this session offers a restorative experience designed for you—the resilient responder on the front lines.

In this interactive session, discover how Tai Chi Relaxation and Qi Gong Meditation, rooted in ancient mind-body traditions, can become powerful tools in your personal resilience toolkit. Through gentle movement, breath awareness, and focused attention, you'll learn techniques that help:

1. Reduce chronic stress and mental fatigue
2. Improve clarity and emotional balance during high-demand operations
3. Build long-term physical and psychological resilience

While emergency management often focuses on community-level preparedness and response, this session emphasizes the importance of self-preparedness—strengthening your own capacity to stay centered, clear-headed, and effective before, during, and after the challenges of disaster work. Participants of all experience levels are welcome, whether you're new to movement meditation or seeking ways to integrate wellness practices into your daily routine.

Come away with practical, adaptable techniques you can use beyond the conference—with tangible benefits for your health, performance, and overall well-being.

Carrying the Legacy Forward: The Transition of the Oregon Emergency Response System (OERS) to OEM, Plenary Session - Lunch..... Homestead

- William Chapman, Statewide Interoperability and Watch Center Manager, Oregon Department of Emergency Management
- Nic Luncsford, Senior Watch Specialist, Oregon Department of Emergency Management

Join William Chapman, OEM’s Statewide Interoperability and Watch Center Manager, and Nic Luncsford, OEM’s Senior Watch Specialist to learn about the historic transition of the Oregon Emergency Response System (OERS) from the Oregon State Police to the Oregon Department of Emergency Management. This session will highlight how the team is building toward a ready and resilient future while honoring decades of trusted response coordination. Attendees will gain insight into what is changing, what remains foundational, and how the legacy of OERS continues to shape Oregon’s modern emergency management posture. Join us for a forward-looking discussion on continuity, modernization, and safeguarding a system relied upon by responders and communities across the state.

Virtual Call Centers Part 2: Building a Scalable AFN Evacuation Outreach Program.....Heritage

BREAKOUT: PREPAREDNESS & MITIGATION

- Ashley Volz, Emergency Services Coordinator, Deschutes County Emergency Management

This implementation-focused session is Part 2 of last year’s presentation on virtual evacuation outreach call centers. Designed for those who attended the original session but welcoming newcomers, you’ll learn how to operationalize a process for contacting people with access and functional needs during evacuations and other emergencies. We’ll walk you through the process Deschutes County uses: data collection, mapping, activating your call team, placing and logging calls, and ensuring people receive the assistance they need during an evacuation. You’ll leave with ready-to-use resources including call scripts, call logs, call team training curriculum, a Medical Reserve Corps mission set, month-by-month project timelines, deployment logs, and an HSEEP-driven drill template to test your process. After years of building and refining this program, we’re excited to share proven tools and lessons learned so you can launch your own outreach capability this season.

OSSA Type 3 Incident Management Team (IMT): How Type 3 IMTs Can Bridge the Mutual Aid Gap in a Time of Uncertainty....Great Hall

BREAKOUT: RESPONSE & OPERATIONS

- Bryan Lee, Emergency Manager, Benton County
- Nick Vora, Emergency Manager, Union County

As Emergency Management in Oregon continues to evolve amid shrinking budgets and growing uncertainty from federal partners, mutual aid has become a critical tool for sustaining response and recovery capabilities. This session focuses on how mutual aid

can be operationalized through the development and use of a Type 3 Incident Management Team (IMT).

Attendees will gain a practical overview of how Type 3 IMTs fill the operational gap between local response and the cost and complexity of ordering a Complex IMT. The discussion will highlight how these teams can support Emergency Operations Centers, incident management, and recovery coordination across jurisdictions.

Members of the Oregon State Sheriffs' Association (OSSA) IMT will share practitioner-level insights, including real-world challenges, successes, and lessons learned from team development and deployment. The session will also cover what the OSSA IMT can provide to local jurisdictions, pathways for Emergency Management practitioners to participate, and key considerations for agencies interested in building or supporting a Type 3 IMT.

Adopting an Airport Friends and Relatives Center (FRC) Model for Post-Disaster Coordination and Reunification Landmark

BREAKOUT: RECOVERY & RESILIENCE

- *Nathan Lethgo, Emergency Management Specialist, Plans and Organization, Port of Portland*
- *Jason Hetherington, Emergency Management Specialist, Training and Exercise, Port of Portland*

After a disaster, families and friends arrive seeking answers. This session introduces the airport Family Reunification Center (FRC) model and provides a practical framework for integrating reunification strategies into your emergency plans.

Conducting a Community-Led THIRA with Research Modeling of the Oregon Coast as One Region Heritage

BREAKOUT: PREPAREDNESS & MITIGATION

- *Joseph Louis, Assistant Professor, School of Civil and Construction Engineering, OSU and Cascadia CoPes Hub*
- *Chonnapat Opanasopit, School of Civil and Construction Engineering, Oregon State University and Cascadia CoPes Hub*
- *Rachelle Lambert, Ra Harmony Consulting, Health, Wellness Education and Siuslaw Valley CERT*

Coastal communities in Washington, Oregon, and California sit on the front lines of some of the nation's most complex and interconnected natural hazards—from tsunamis and major earthquakes to landslides and wildfires. Preparing for these threats depends on strong, up-to-date Threat and Hazard Identification and Risk Assessments (THIRAs). Yet across Oregon's coast, many counties haven't been able to complete a THIRA due to limited staffing, funding constraints, and competing priorities. Even when they are conducted, THIRAs are often siloed by county, overlooking the shared risks and interdependencies that define coastal life.



This session explores an innovative, community-led effort to change that. Learn about a groundbreaking project piloting the first coast-wide THIRA for all seven Oregon coastal counties—built through partnerships with emergency managers, community-based organizations, volunteer groups, and local businesses. Grounded in existing research using islanding maps and community-informed hazard modeling, this initiative invites local knowledge to strengthen risk assessments by identifying critical community assets and vulnerabilities. Join us to see how this collaborative approach can transform coastal preparedness—and discover how you can contribute to and support this one-of-a-kind effort.

RADIOACTIVE WASTE IS COMING! What is Hanford, and Why Does Oregon Have a Role to Play?.....Great Hall

BREAKOUT: RESPONSE & OPERATIONS

- *Tom Sicilia, Hanford Hydrogeologist and Fuels Specialist, Oregon Department of Energy*

This session tells the story of how the world’s entry into the atomic age was made possible by the Pacific Northwest, and how the region still shoulders the burden of that work. The presentation will start at the Manhattan Project and continue through the multiple shipping campaigns of radioactive waste from Hanford which are headed our way in the next 5 years. Shipments will be a regular occurrence for the coming decades from I-82 to I-84 eastbound. What should you be aware of, what do first responders need to know, and who can answer questions from the public? Have questions about Hanford or radioactive waste? This one is for you.

Fragile by Design: When One Fiber Cut Shuts Down a County.....Landmark

- *Jeff Perkins, Public Safety Communication Specialist*

This session examines how single points of failure in communications infrastructure can cascade into widespread disruptions. Using Lake County, Oregon as a case study (Golden Fire 2023 and Elk Fire 2025), it highlights the risks of dependency on a single fiber span, the cascading impacts to 911, public safety radio, cellular, VOIP, healthcare, and commerce, and the multi-agency/private sector partnerships that responded. Attendees will also learn about the role of satellite technologies (Starlink, SatCOLT, T-Satellite) in restoring critical services and strengthening resilience planning.

Local Emergency Manager Round Table - Invitation-Only.....Great Hall

Session for county, city, and tribal emergency managers to have a direct conversation with Oregon Department of Emergency Management Leadership and each other. AI in Emergency Management (Because Your To-Do List Wasn’t Long Enough Already)



Keynote Dinner: AI in Emergency Management: Because Your To Do List Wasn't Long Enough Already.....Homestead

- Sarah K Miller, Associate Professor of Emergency Management, Pierce College

Dr. Sarah Miller is a Certified Emergency Manager (CEM) who holds a PhD from Capitol Technology University, where she studied the use of AI in emergency management. She is currently an Associate Professor and Chair of the Emergency Management program at Pierce College and has an active emergency management and cybersecurity consulting practice. She was a local emergency manager in Washington for 15 years and has been the Chair of IAEM's Emerging Technology Caucus twice, as well as being the Past-President of IAEM Region 10. She has spoken extensively about practical applications and considerations for AI in Emergency Management, including appearances at the International Atomic Energy Agency conference in Saudi Arabia and at the United Nations in Vienna, Austria. Her research and work focuses on practical applications, but also considers how AI is shaping the future of EM.

T H U R S D A Y

A P R I L 16

**Legislative Panel Discussion Plenary Session
Breakfast.....Homestead**

- Seiji Shiratori, Legislative Coordinator, Oregon Department of Emergency Management
- Erin McMahon, Director, Oregon Department of Emergency Management
- Senator Anthony Broadman, Oregon State Senate
- Representative Paul Evans, Oregon State House of Representatives

In this plenary panel, OEM Director, Erin McMahon and OEM Legislative Coordinator Seiji Shiratori will pose questions and moderate a discussion with Senator Anthony Broadman, and Representative Paul Evans on state government and emergency management policy..

Grants That Strengthen Preparedness: SPIRE and EMPG Essentials.....Heritage

BREAKOUT: PREPAREDNESS & MITIGATION

- Ari Nordquist, Grants Specialist, Oregon Department of Emergency Management
- Carole Sebens, EMPG/SPIRE Grants Coordinator, Oregon Department of Emergency Management

Learn how the State Preparedness and Incident Response Equipment (SPIRE) program provides equipment to address capability gaps and how Emergency Management Performance Grant (EMPG) program funding strengthens emergency management capabilities. This session covers eligibility, priorities, compliance, and strategies to use these programs effectively.

Drones on the Front Line: Real-World UAS Operations in Oregon EmergenciesGreat Hall

BREAKOUT: RESPONSE & OPERATIONS

- *Kenji Sugahara, Director, Oregon Department of Aviation*
- *Casey Varnum, Oregon Department of Transportation*

Drones are rapidly becoming indispensable tools for emergency response, infrastructure resilience, and public safety coordination. In this forward-leaning panel discussion, Kenji Sugahara, Director of the Oregon Department of Aviation and a national leader in advanced air mobility and drone policy, moderates a practical conversation with Casey Varnum of the Oregon Department of Transportation and Jeff Pricher, Fire Chief of the Scappoose Fire District. Together, they will explore how drones are deployed during landslides, floods, wildfires, structure fires, search and rescue missions and major roadway incidents.

This session will provide concrete operational examples of how ODOT uses UAS for rapid damage assessment, geospatial mapping, and infrastructure monitoring after severe weather and natural disasters. Attendees will also hear how Scappoose Fire integrates drones into fire operations, search efforts, crash documentation, and hazardous materials response — and what it takes to build and sustain a successful public safety drone program.

Moderated from a statewide aviation and policy perspective, the discussion will bridge strategy and field execution. Participants will gain practical lessons learned, implementation considerations, and real-world insights that can help agencies strengthen situational awareness, reduce responder risk, and improve decision-making during high-consequence events.

This is not a theoretical conversation, but an operational look at how drones are being used today with lessons your agency can take back and apply immediately.

DOGAMI Data’s Role in Pre-Disaster Mitigation and Post-Disaster RecoveryLandmark

BREAKOUT: RECOVERY & RESILIENCE

- *Laura Gabel, Geologist, Oregon Department of Geology and Mineral Industries*

Geologic events like volcanic eruptions, landslides, floods, earthquakes, and tsunamis are the result of naturally occurring Earth processes. When these processes affect humans and the built environment (assets), they become natural hazards. A natural hazard risk assessment is the characterization of the intersection of geologic events and assets. One of DOGAMI’s primary objectives is to assist Oregon communities to reduce risk and become more resilient to geologic hazards. We do this by identifying and mapping the hazards and community assets and then using those data to perform exposure and risk assessments. These assessments can be used to provide justification for pre-disaster mitigation funding and for post-disaster recovery planning. Examples include the identification of critical facilities and key infrastructure (e.g. police station, hospital,

school, bridge, dam, substation, etc), land use planning (understanding how land and the built environment may be affected and what the economic impacts might be), and population (understanding the number and distribution of potential injuries and fatalities). DOGAMI has published exposure and risk assessments across Oregon, partnering directly with communities to ensure that scientific results are clear and can be effectively used to meet risk-reduction goals and build resiliency into all Oregon communities.

Person-Centered Emergency Preparedness (P-CEP) WorkshopHeritage

BREAKOUT: PREPAREDNESS & MITIGATION

- *Kayla Thompson, Community Preparedness Coordinator, Oregon Department of Emergency Management*
- *Erin Taylor, Executive Director, Upstream Access*

This interactive 90-minute session introduces emergency managers and professionals to the Person-Centered Emergency Preparedness (P-CEP) curriculum through an applied, practice-based approach. Participants will explore each section of the P-CEP Capability Wheel and examine how its core capacities align with Access and Functional Needs (AFN) planning and operations. Through guided discussion and real-world scenarios, attendees will learn concrete ways to connect P-CEP capabilities to AFN responsibilities and strengthen whole-community emergency planning.

We're All in This Together: Building Energy Security at All LevelsGreat Hall

BREAKOUT: RESPONSE & OPERATIONS

- *Traci Naile, Energy Security Manager, Oregon Department of Energy*
- *Lisa Gorsuch, Energy Security Manager, Oregon Public Utility Commission*

Join us to share information and support evolution of the Oregon Energy Security Plan. This session will include a panel discussion with Oregon energy sector providers, Oregon Department of Energy, and Oregon Public Utility Commission. Session participants also will engage in small-group discussions with panelists about energy threats, mitigation efforts, energy incident preparedness and response, and the Oregon Energy Security Plan. We will work together to better understand Oregon's energy threat landscape, best practices for energy security planning and coordination, and energy-related exercises at all levels of disaster response and recovery. We look forward to a great discussion!

Strategic Engagement: Leveraging the Right Method of Community Outreach to Inform PlanningLandmark

BREAKOUT: RECOVERY & RESILIENCE

- *Francis Pastorelle, Disaster Management Program Coordinator, Clackamas County Disaster Management and Health, Housing and Human Services*
- *Stephanie Coleman, Clackamas County Health Housing and Human Services*
- *Emily Murkland, Clackamas County Disaster Management*

Community input in emergency planning is essential to meet the diverse needs of government agencies, local organizations, and community members. However, different plans and projects call for different kinds and levels of engagement, so using a “one size fits all” approach to engagement may lead to data being missed or partners’ time being misspent. In this 90-minute workshops, three community planners from Clackamas County will discuss three distinct methods of strategic community engagement they utilized while developing two county emergency plans and a public outreach campaign in 2025. The workshop will include an opportunity for participants to apply the presentation content to their own projects, utilizing the same engagement tool adopted by facilitators. Exhibitor Social

Exhibitor Social LunchHomestead Ballroom/Great Hall

An opportunity for attendees to enjoy their meal, interact with our conference exhibitors, and network!

Group Photo Mt. Bachelor Lawn

MEET ON LAWN AREA DOWN FROM THE GREAT HALL DECK/FIRE PIT

Let’s Level Up Our Exercises, TogetherHeritage

BREAKOUT: PREPAREDNESS & MITIGATION

- *Robert Quinn, State Exercise Officer, Oregon Department of Emergency Management*
- *Zach Glenn, Exercise Specialist, Oregon Department of Emergency Management*

We can all acknowledge that the exercise events we host routinely struggle to truly make an impact on policies, plans, expectations, priorities, or the participants. Why is that? Well, the OEM Exercise Program thinks a lot of this comes down the small details in the design process, and generally the entire after-action process as we know it. So come hang with the ExForce as we collectively work to improve the exercise events occurring around Oregon. This session will offer opportunities for improvement from the ExForce, opportunities for improvement from the audience, and ensure participants leave with a suite of options for supporting their upcoming exercise events.

Strengthening Rural Resilience Community & Livestock Pre-Registration and Resource Management Through Relief Compass.....Great Hall

BREAKOUT: RESPONSE & OPERATIONS

- *Joe Bucher, Vice President of Technology, Relief Compass*
- *Erin Taylor, Executive Director, Upstream Access*
- *Karla Hoggan, President, Oregon Livestock Council*

In rural and agricultural regions, disasters create dual challenges: protecting populations disproportionately affected residents and safeguarding the livestock and livelihoods that sustain communities. This session highlights an innovative partnership approach that

combines community-driven preparedness with modern resource-management technology.

Representatives from the Oregon Livestock Council will share how they are proactively pre-registering their most disproportionately affected community members and their livestock in the event of a disaster to ensure faster, safer evacuations and better coordinated support during emergencies. Participants will learn how this model improves situational awareness, reduces response time, and strengthens resilience in high-risk areas.

In addition, Upstream Access will demonstrate how their organization provides critical resources and services to support these communities before, during, and after disasters. The session will show how these efforts are amplified by using Relief Compass, a centralized platform that enables efficient warehouse operations, donation management, distribution tracking, and real-time resource coordination across multiple partners.

After the Fire: Wildfire Debris Management and Data Collection.....Landmark

BREAKOUT: RECOVERY & RESILIENCE

- *Sarah Behrman, GIS Coordinator, Oregon Department of Environmental Quality*
- *Bryn Thoms, Project Manager, Oregon Department of Environmental Quality*

When a wildfire destroys neighborhoods, recovery is a complex and multi-phase process that spans months. In this session, we'll share lessons learned from recent wildfires in nine Oregon counties. Learn best practices for managing debris and collecting data in each phase of recovery, starting with property owners opting in to a coordinated recovery, continuing through removal of household hazardous waste, ash, and debris, and ending with property owners receiving letters confirming that their land is ready for rebuilding. We'll cover right-of-entry forms, data dashboards to keep residents and responders informed, field data collection methods, general information about waste streams, processing of those wastes, various permit requirements and/or waivers, and briefly present sampling and analysis for confirmation of waste removal.

Continuity Clue: A Fun Approach to Serious Preparedness.....Heritage

BREAKOUT: PREPAREDNESS & MITIGATION

- *Shalynn Robinette, State Continuity Program Coordinator, Oregon Department of Emergency Management*

Exercising and Testing your continuity plan doesn't have to be stressful! This interactive session introduces Continuity Clue, a board game designed for state and local agencies to exercise their Continuity of Operations Plans in a fun, engaging way. Participants will explore how gamification can reinforce essential continuity concepts, improve team collaboration, and identify gaps in preparedness—all while reducing the pressure of traditional exercises. Join us to learn how this innovative tool can transform your continuity training approach. (OEM has several copies of the game to check out and can even provide a game facilitator for your agency if requested).

International Humanitarian Aid and Disaster Response: Issues, Strengths and WeaknessesGreat Hall

BREAKOUT: RESPONSE & OPERATIONS

- *Peter Lundgren, Portland Metro Regional Coordinator, Oregon Department of Emergency Management*

The international humanitarian response ecosystem exists to fill gaps that are not dissimilar from those experienced by domestic disaster response and emergency management. There are many significant and valid criticisms of that global ecosystem, but the experience found within may still hold valuable insight for how domestic emergency management can continue to evolve. This presentation largely stems from personal experience over the last twenty plus years working internationally within the UN system, with Doctors Without Borders, and with other nonprofit disaster response organizations, as well as a graduate academic study of humanitarian action.

Community-Led Recovery: Rebuilding After Disaster with Empathy, Intention, and Resilience..... Landmark

BREAKOUT: RECOVERY & RESILIENCE

- *Matt Talley, Senior Vice President of Resilience and Emergency Management, AtkinsRealis*
- *Jamelyn Austin Trucks, National Practice Director of Resilience and Emergency Management, AtkinsRealis*

On January 7, Pacific Palisades experienced a devastating wildfire that forced rapid evacuations, claimed lives, and destroyed entire neighborhoods. For more than 6,000 families, everything changed overnight. What followed was not just physical loss, but shock, grief, and the complex challenge of rebuilding lives and communities. This session explores what effective, community-led disaster recovery truly requires. Drawing on real-world recovery experience and lessons from major disasters such as 9/11, the presentation examines the stages of grief survivors face, the tension between political urgency and thoughtful rebuilding, and the common fallacy that faster recovery always means better outcomes. Participants will learn how empathetic leadership, community alignment, and intentional decision-making can transform recovery into a once-in-a-generation opportunity to rebuild safer, stronger, and more resilient communities. The session emphasizes placing disaster survivors at the center of recovery efforts, coordinating across public and private sectors, and translating recovery lessons into long-term preparedness. Designed for leaders, practitioners, and decision-makers, this session aims to inspire a shift from simply restoring what was lost to building communities that are better prepared for the risks ahead.

Tribal Emergency Management Caucus - Invitation-Only.....Great Hall

An exclusive session for Tribal emergency management professionals to engage in an open dialogue with OEM leadership. This invitation-only opportunity provides a platform to share information, discuss key topics, and ask questions.

Dinner on Your Own

Social Night.....Homestead

Connect with fellow attendees during this evening of entertainment and competition. Activities will include karaoke, trivia, disaster movie heckling, a mobile escape room, and more. Snacks and beverages will be available for the duration of the social night.

FRIDAY

APRIL 17

Incident Management Team Panel, Plenary - Breakfast.....Homestead

This plenary session will feature a panel with representatives from the Department of the State Fire Marshal (OSFM), Department of Forestry (ODF), and the Oregon State Sheriffs' Association (OSSA) Emergency Management Command Council (EMCC). This panel will discuss Incident Management Teams (IMTs) within Oregon and how they work. This session will offer participants a chance to learn how Oregon's IMTs operate across disciplines, the complexities of coordination during incidents, and how each are refining processes to support communities statewide.

Inclusive Whole-Community Preparedness Engagement.....Heritage

BREAKOUT: PREPAREDNESS & MITIGATION

- *Kayla Thompson, Community Preparedness Coordinator, Oregon Department of Emergency Management*

This session introduces OEM’s Be 2 Weeks Ready Program and its development of accessible and inclusive preparedness outreach through Cooking without Power workshops, the Communities Prepared for Disasters webinar series, and community-specific presentations. Attendees will learn how to get involved with the Be 2 Weeks Ready program and the different ways that OEM’s Community Preparedness Program can support outreach in their communities.

The Other Planning P: How Land Use Planning Creates Your Response EnvironmentGreat Hall

BREAKOUT: RESPONSE AND OPERATIONS

- *Althea Sullivan, Emergency Manager, City of Eugene*

This session will provide a primer on land use regulations and the role they play in shaping our communities. With scenario-based learning, the post disaster built environment will be explored in the context of regulations that were at play when it developed. Attendees will leave with ideas and strategies to integrate hazard planning with local regulations to build more resilient communities.

Long-Term Large-Scale Permanent Disaster Recovery Housing: Lessons Learned from the 2020 DisasterLandmark

BREAKOUT: RECOVERY & RESILIENCE

- *Neil Barrett, External Affairs Officer, Oregon Housing and Community Services - Disaster Recovery & Resilience*
- *Chelsea Catto, Assistant Director of Policy and Infrastructure; Oregon Housing and Community Services – Disaster Recovery and Resilience*
- *Nathan Oetting, Program Analyst; Oregon Housing and Community Services – Disaster Recovery and Resilience*

Join us for a session to dive into how The State of Oregon navigated the devastating 2020 Labor Day Wildfire and Straight-line wind disasters, specifically how Oregon utilized state and federal funding to create housing for nearly 2,700 of the most in need Oregonians. You will leave this session with a clearer understanding of the housing impacts from the 2020 Disasters, how it affected Oregonians, and what the state undertook to support the housing recovery of individuals and communities in need. This was the first time Oregon had seen a disaster with housing loss at this scale. It has required both state and federal funding to provide support for some of the most vulnerable disaster-affected Oregonians. We'll talk through how the different funding sources led to the development, design and implementation of recovery programs. Time will also be spent comparing and contrasting the differences in funding types as well as lessons learned.

What Building an Educational Escape Room Taught Me About Emergency Preparedness MessagingHeritage

BREAKOUT: PREPAREDNESS & MITIGATION

- *Tyler Robinson, Side Quest Escape Games*

Learn how entertaining, game-based learning can increase engagement, improve retention, and boost preparedness at both the individual and community levels. Shaky Grounds Cafe, a mobile escape room that teaches real-world emergency skills, creates “ah-ha” moments that help players internalize lessons through curiosity, problem-solving, and self-guided discovery. The game was developed around the guiding design philosophy Entertain Engage Educate Empower, showing how leading with fun builds trust and attention, opens the door for meaningful preparedness messaging, and helps individuals and communities become more resilient.



Understanding Special Districts and Community Lifelines.....Great Hall

BREAKOUT: RESPONSE & OPERATIONS

- *Beth McGinnis, Emergency Manager, Clean Water Services*
- *Meghan Howk, CHES, Risk Management Consultant, Special District Association of Oregon*

Learn how to help build relationships and awareness in the Oregon EM community about the unique space Special Districts occupy in community lifelines. We want to highlight unique governance models and relationships between cities, multi-county regional districts, and their county and state EM partners.

Building Public Health Preparedness and Resilience in Rural and Remote Communities.....Landmark

BREAKOUT: RECOVERY & RESILIENCE

- *Jordan Boustead, Disaster Preparedness and Response Manager, Medical Teams International*
- *Sarah Rawlins, Health Advisor, Medical Teams International*

Medical Teams International, an Oregon-based healthcare NGO, spent the last two years piloting a disaster preparedness initiative in partnership with public health agencies and emergency management departments in Clackamas and Union Counties. Our pilot project consisted of several components designed to strengthen community preparedness, particularly as it relates to marginalized communities and Access and Functional Needs (AFN) individuals. Our purpose was to forge key partnerships, identify vulnerabilities in community disaster preparedness, and develop common objectives aimed at addressing these vulnerabilities. We hosted and/or participated in more than 20 emergency preparedness trainings, exercises, and educational events across Oregon. Through these events, 300+ individuals were given the training and resources to support their fellow community members during disasters. Learn how Medical Teams International partnered with over 30 statewide agencies and stakeholders to overcome common barriers and increase resiliency in predominantly rural Oregon communities.

Closing Session.....Homestead



OREGON PREPARED CONFERENCE PHOTOGRAPHY: RANDY HAMAR, CREATIVE DIRECTOR, OREGON DEPARTMENT OF EMERGENCY MANAGEMENT

OREGON PREPARED



EMERGENCY PREPAREDNESS CONFERENCE