

## Oregon State Public Health Laboratory



### Rectal Swab Collection – Patient Instructions

1. Wash your hands.
2. Undress and get into a comfortable position so you can balance while you collect the sample.

3. Open the kit package part of the way.  
Pull out the **blue** swab. Throw the white swab away.  
Do not lay down the swab or touch the soft tip.

\*Ask for a new kit package if you lay the swab down or touch the soft tip.

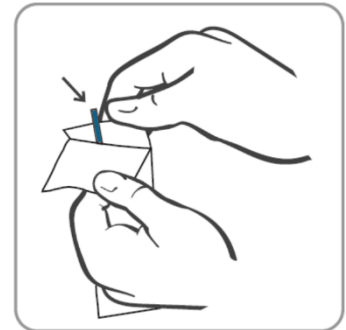

4. Hold the **blue** swab as shown, with your fingers over the score line (black line) on the swab.

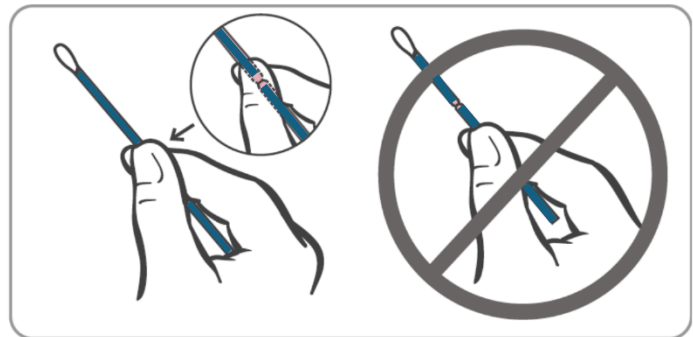

5. Carefully insert the swab into the rectum, about 1-2 inches.  
Gently rotate the swab clockwise for 5 to 10 seconds.  
Pull the swab out without touching your skin.

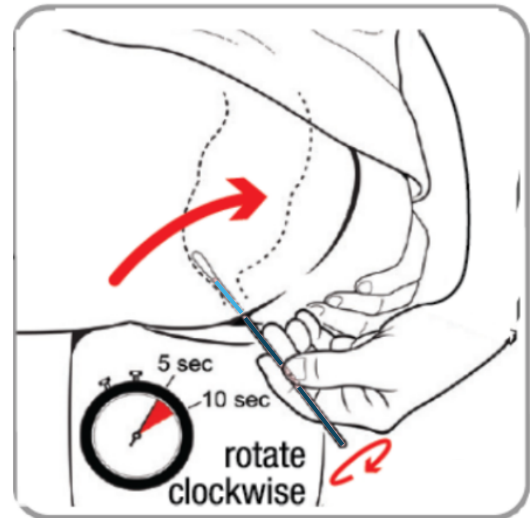

6. Hold onto the swab.  
Unscrew the cap from the tube.  
Do not spill the liquid out of the tube.

\*Ask for a new kit package if liquid spills out of the tube.

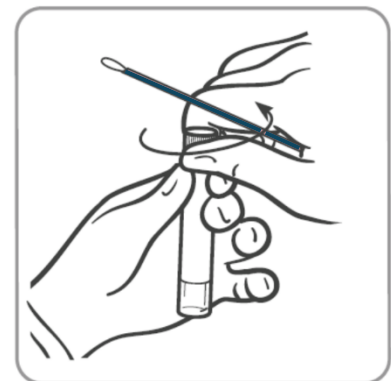

7. Put the swab into the tube so the score line (black line) is at the top of the tube.

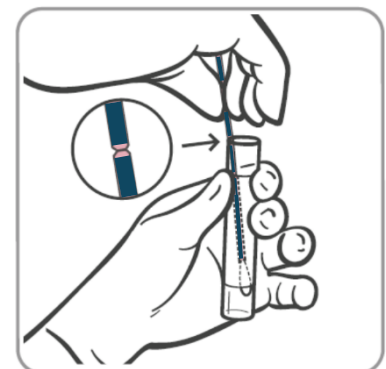

8. Carefully break the swab at the score line (black line) against the side of the tube.  
Throw away the top the swab that broke off.  
Leave the rest of the swab inside the tube.

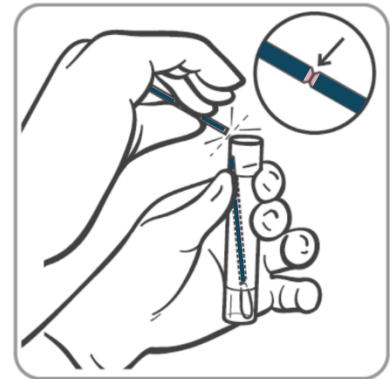

9. Tightly screw the cap onto the tube as shown to the right.

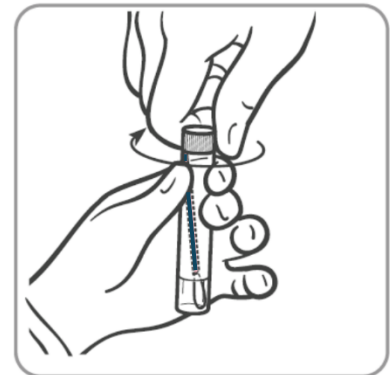

10. Put your clothes back on and return the tube to your health care provider.