

LIBRARY  
OREGON DEPARTMENT OF GEOLOGY  
AND MINERAL INDUSTRIES  
SUITE 965  
800 NE OREGON STREET # 28  
PORTLAND, OREGON 97232

P-12

Blue River Dist.  
T15S R.4E.  
Lane County  
Tube 67

Sheet #6

GOLD REEF 425

DEMOCRAT 737  
HAPPY JACK 737  
COXEY 737  
REPUBLICAN 737

T.15S.  
T.16S.

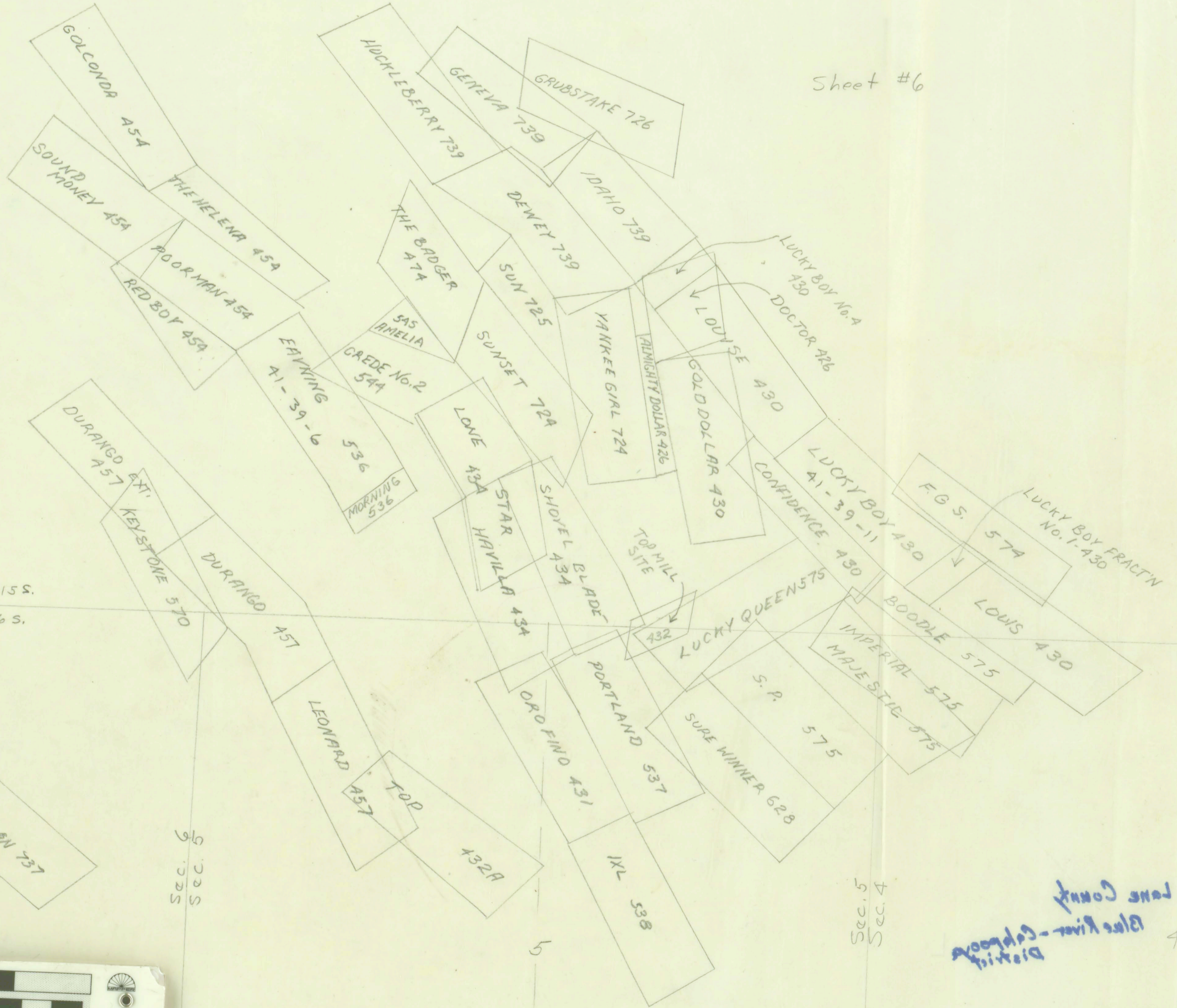

Sec. 6  
Sec. 5

Sec. 5  
Sec. 4

Lane County  
Blue River - Calhoon  
District

