

Township N^o 35 South Range N^o 9 West of the Willamette Meridian, Oregon.

G F E D C B A

S. 89° 51' W.

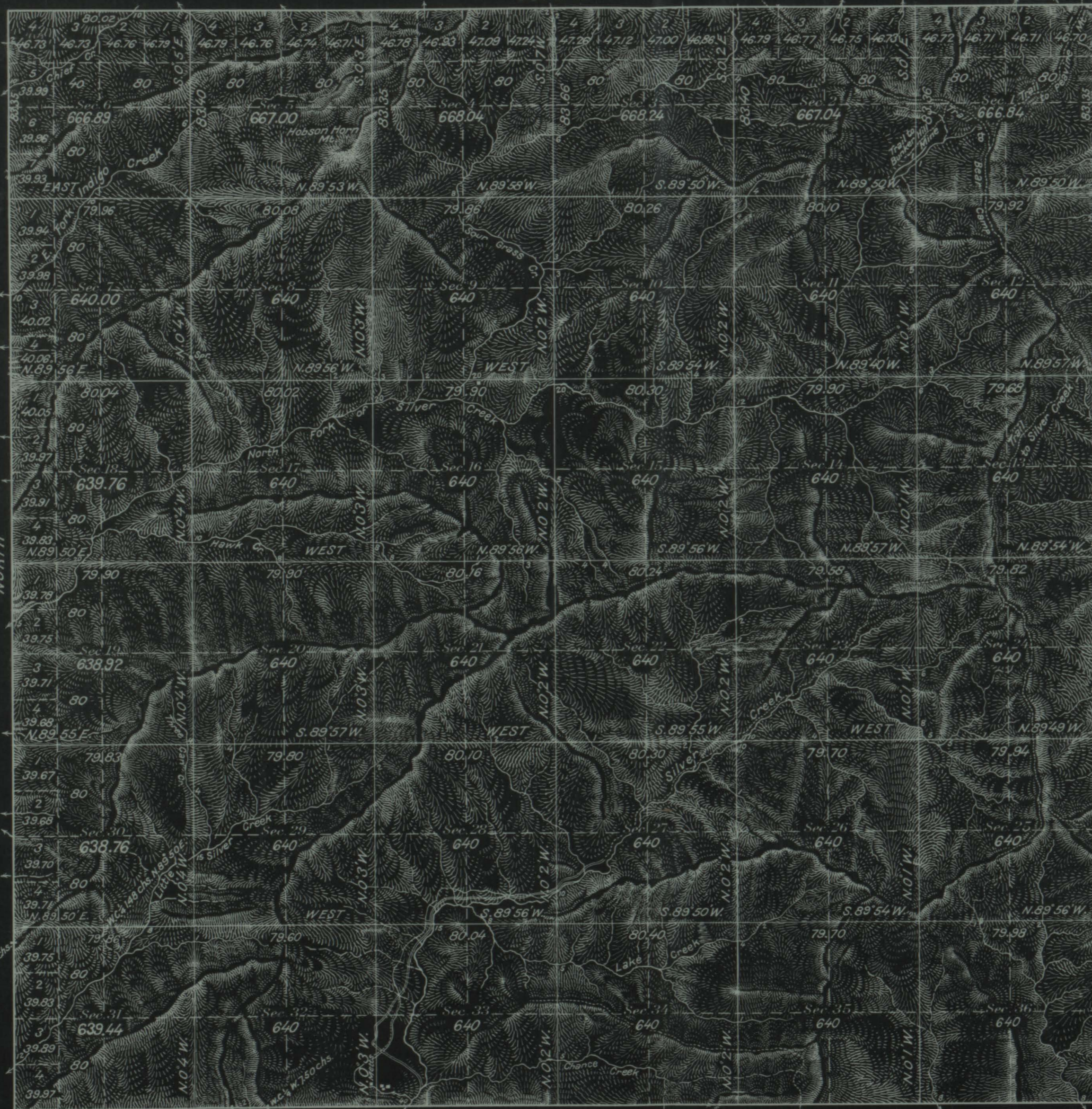

431683

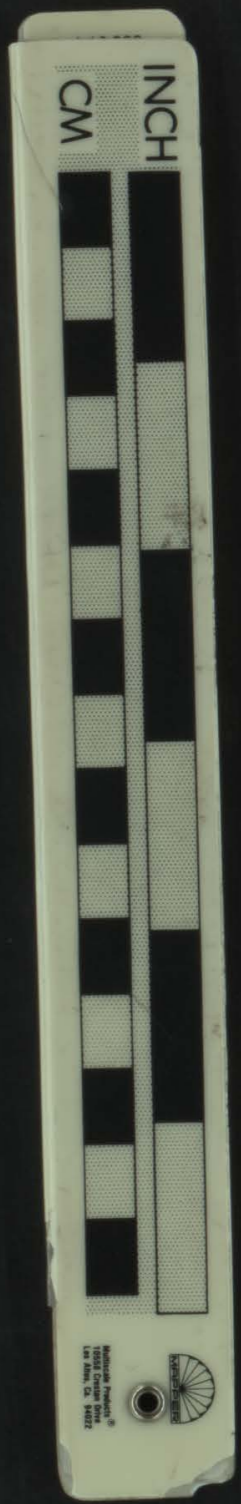

Areas in Acres	
Public Land	23200.93
Indian Reservation	
Indian Allotments	
Mineral Claims	
Water Surface	
Total Area	23200.93

Scale 40 Chains to an inch
 Mean Magnetic Declination 21° E
 Latitude 42° 28' N. At S.E. Cor. of Tp.
 Longitude 123° 41' W.

Surveys Designated	By Whom Surveyed	Group			When Surveyed	
		No.	Date of Instructions	Mls. chs. fks.	Began	Completed
6 th Sub. Part S., N. & W. Bars	Fred W. Rodolf and Gerald A. Sorrels	34	Oct. 7 th , 1916.	18 03 37	May 22, 1918	June 16, 1918
Subdivisional Lines.	"	"	"	60 16 04	"	July 13, "
East Boundary	Campbell & Daley	33	Sept. 22, 1916.		1917	

The above map of Township No. 35 South Range No. 9 West of the Willamette Meridian Oregon is strictly conformable to the field notes of the survey thereof on file in this office, which have been examined and approved

U. S. Surveyor General's Office.
 Portland, Oregon February 5, 1919.

Edward J. Worth
 Surveyor General of Oregon.

Table with 4 columns and 10 rows. The table contains faint, illegible text, possibly representing a list or schedule. The columns are separated by vertical lines, and the rows are separated by horizontal lines.

1000



35