

MAXWELL, HIGHLAND AND BAISLEY-ELKHORN MINES  
SHOWING ADDITIONS, COLORING, ETC.  
BY JOHN ARTHUR MARCH-1954

*John Arthur*

Plan of  
Maxwell, Highland & Baisley-Elkhorn Mines  
In T. 8 S., R. 37 & 38 E., Baker Co., Oregon  
Scale 1 in = 600 ft.  
Compiled by O.E. Metzger & F.R. Mellis  
Baker, Oregon, Oct. 1st 1916  
Traced & brought to date by P. Henderson \*\*  
Sept 1937

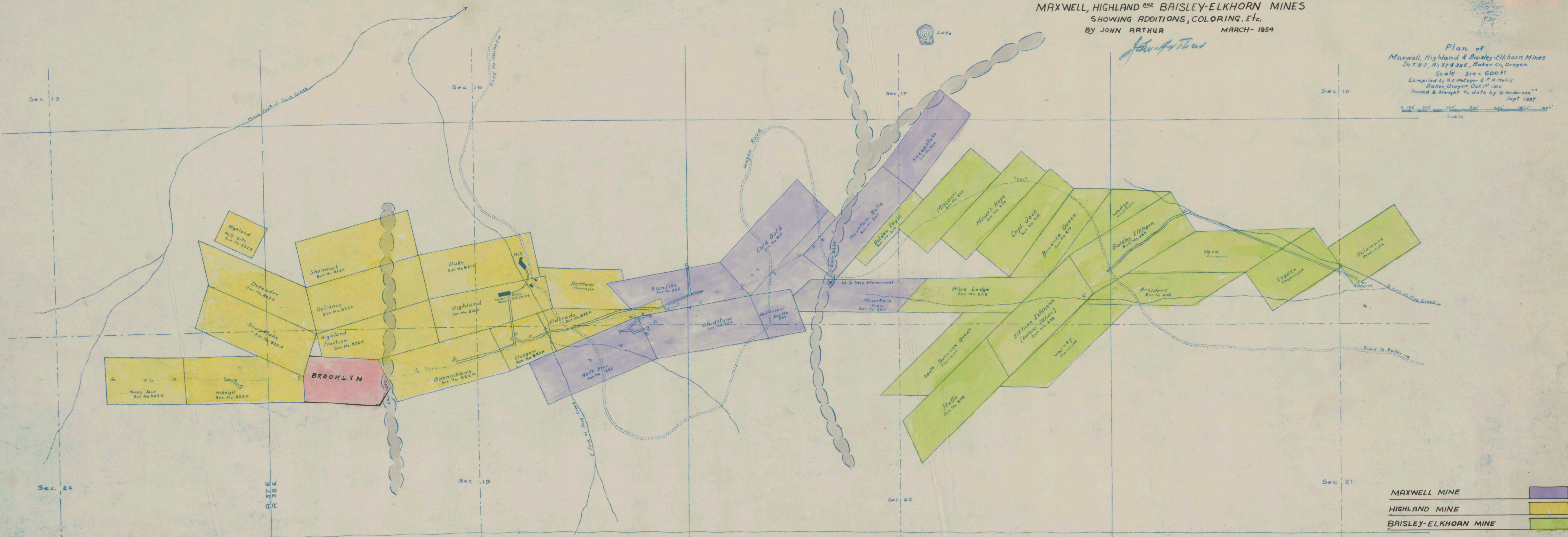
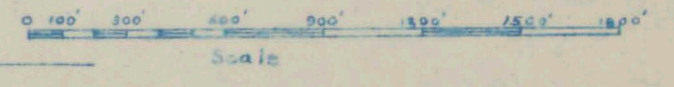

MAXWELL MINE	
HIGHLAND MINE	
BAISLEY-ELKHORN MINE	