

File 10-12

File 10-15

File 10-15

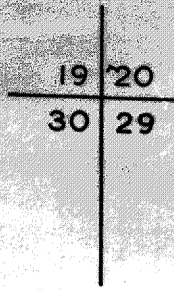

WOODARD CLAIMS

T. 6 S. - R. 44 E.

SCALE 500' = 1"

D.W.C. NELSON, M.E.

TRACED FROM PRINT BY
N.S. WAGNER AUG. 1947

Overprint shows the Dunham Miles claims (shaded in green) and the claims of the Oliver property as currently owned and re-located and as leased by the East Eagle Mining Company, and as based on information given by the East Eagle Mining Company.

BAKER CO. ?

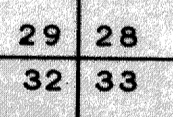
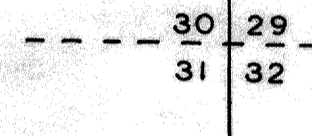
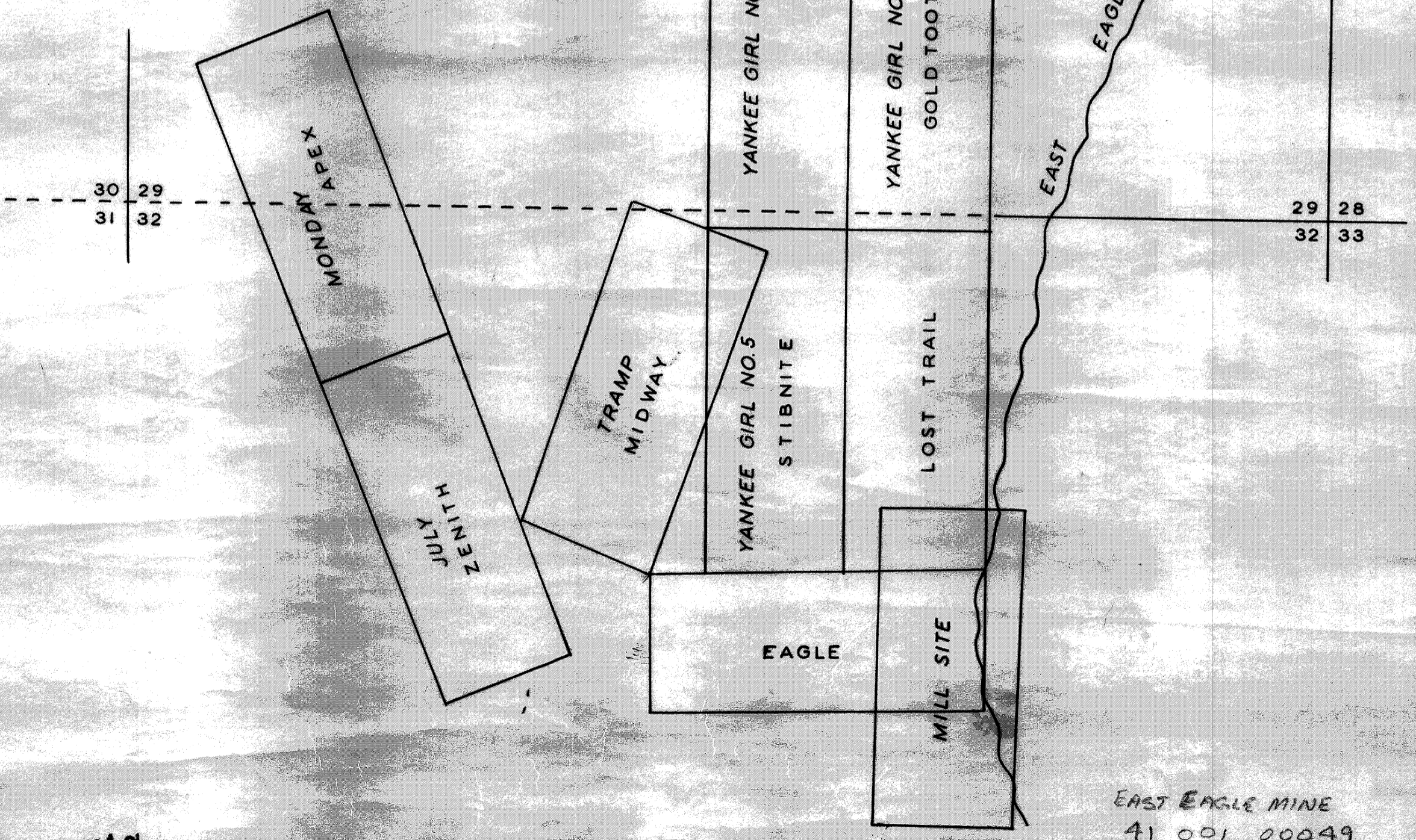

Moogorag

EAST EAGLE MINE
41 001 00049

File 10-12