

122

SURVEY NO. 122  
Mineral District No. 1

# PLAT

OF THE CLAIM OF  
James P. Faull

James P. Faull Quartz Mine

No organized Mining District Baker County Oregon.

Surveyed by Charles M. Foster

U. S. Deputy Surveyor.

Containing 20.64

Acres.

Scale 200

Feet to an Inch.

Variation 20° E.

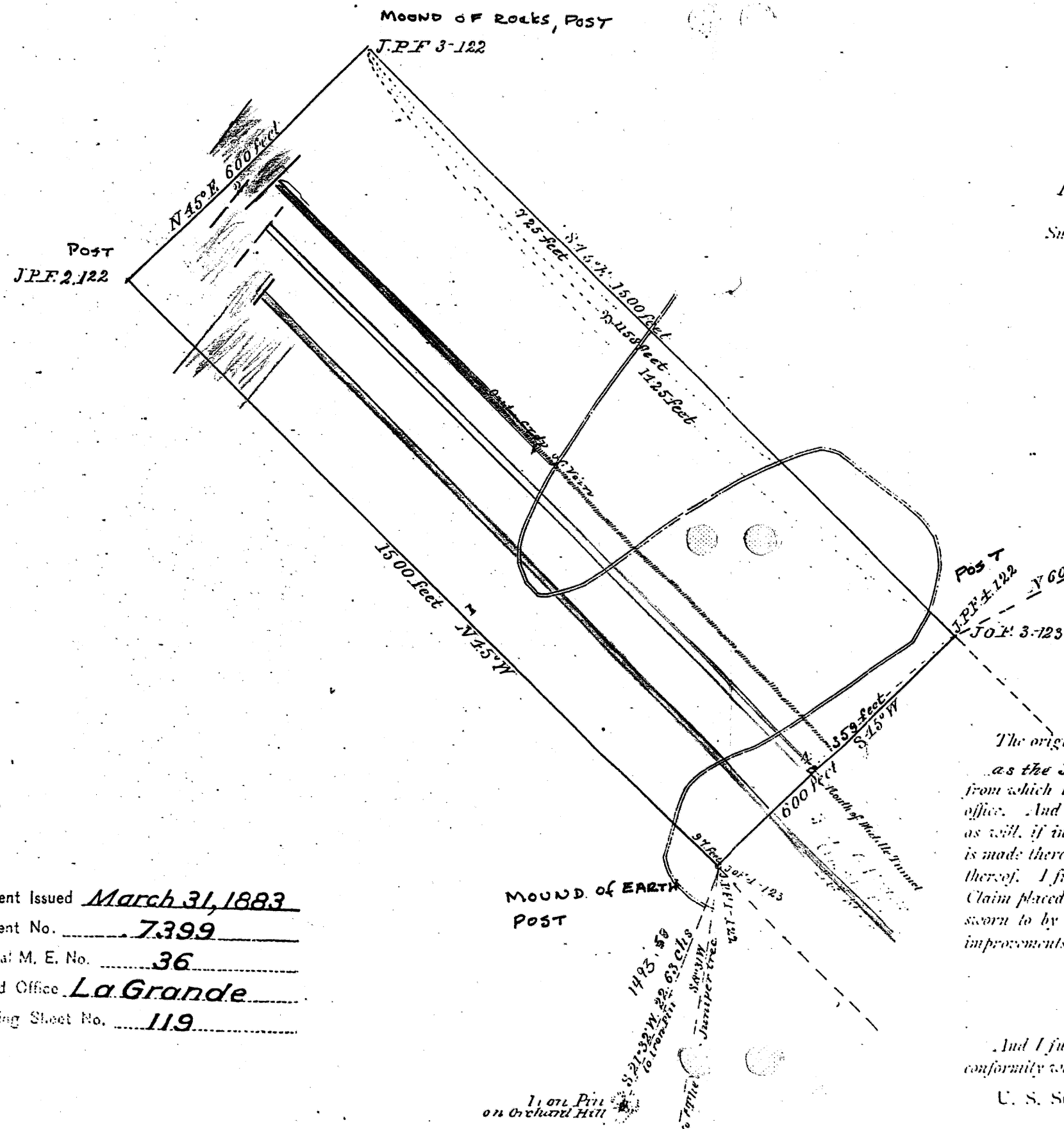

Patent Issued March 31, 1883  
 Patent No. 7399  
 Serial M. E. No. 36  
 Land Office La Grande  
 Mining Sheet No. 119

The original Field Notes of survey of the Mining claim of James P. Faull known as the James P. Faull's Quartz Mine from which this Plat has been made, have been examined and approved, and are on file in this office. And I hereby certify that they furnish such an accurate description of said Mining Claim as will, if incorporated into a patent, serve fully to identify the premises, and that such reference is made therein to natural objects and permanent monuments as will perpetuate and fix the locus thereof. I further certify that the value of the labor and improvements upon the said Mining Claim placed thereon by the applicant or his grantors, is not less than Five Hundred Dollars, as sworn to by the Deputy Surveyor, and affidavits of two disinterested witnesses, and that said improvements consist of Tunnels, Shafts and Stoops made in rock,

And I further certify that this is a correct Plat of said Mining Claim or premises, made in conformity with said original Field Notes of survey thereof.

U. S. SURVEYOR GENERAL'S OFFICE,  
 PORTLAND, OREGON.

August 29 1881

*James C. Tolman*  
 U. S. Surveyor-General for Oregon.