

TOWNSHIP 12 SOUTH RANGE 41 EAST.

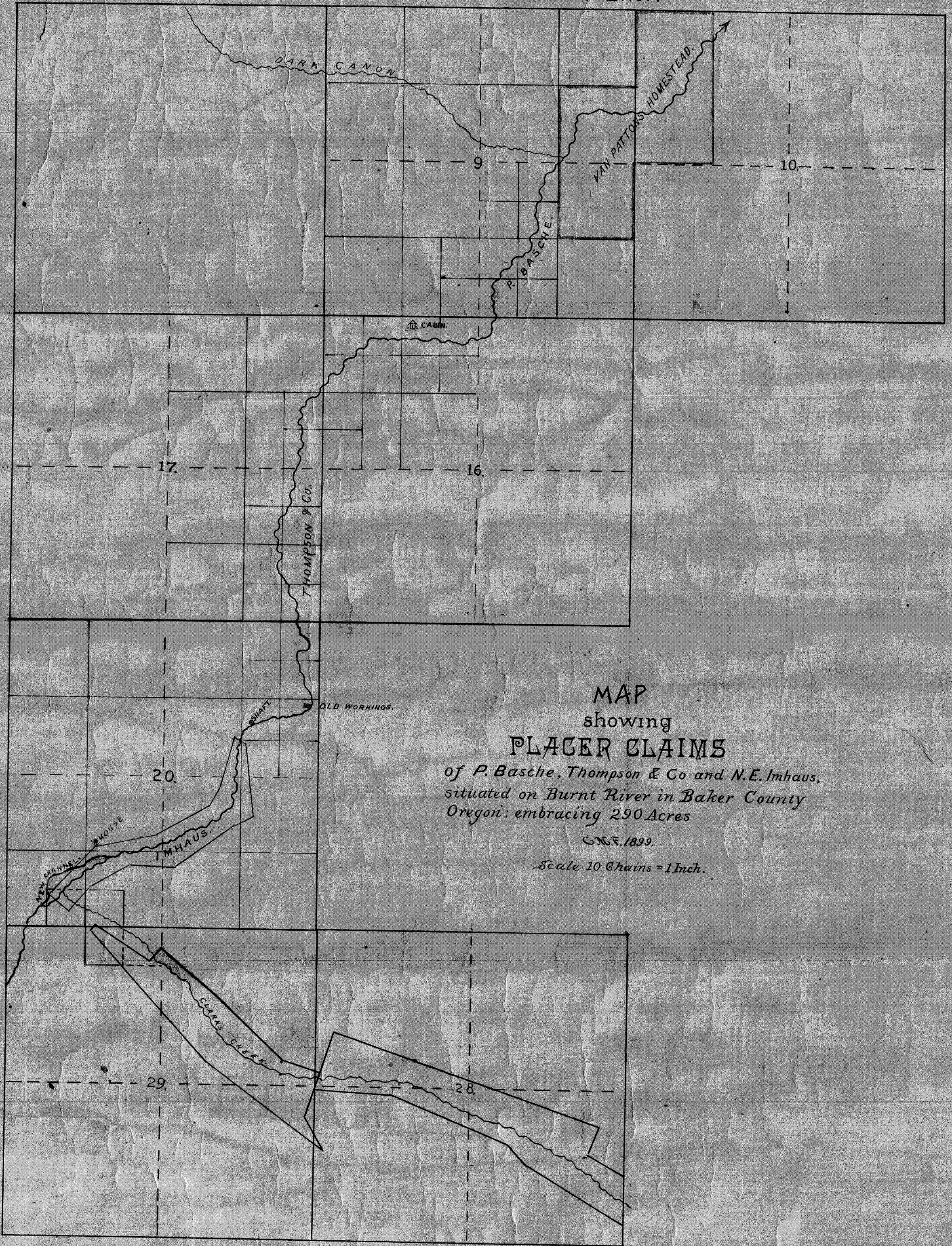

MAP
showing
PLACER CLAIMS
of P. Basche, Thompson & Co and N.E. Imhaus,
situated on Burnt River in Baker County
Oregon: embracing 290 Acres

C.M.F. 1899.

Scale 10 Chains = 1 Inch.