

**PLAN**  
Scale: 1"=5'

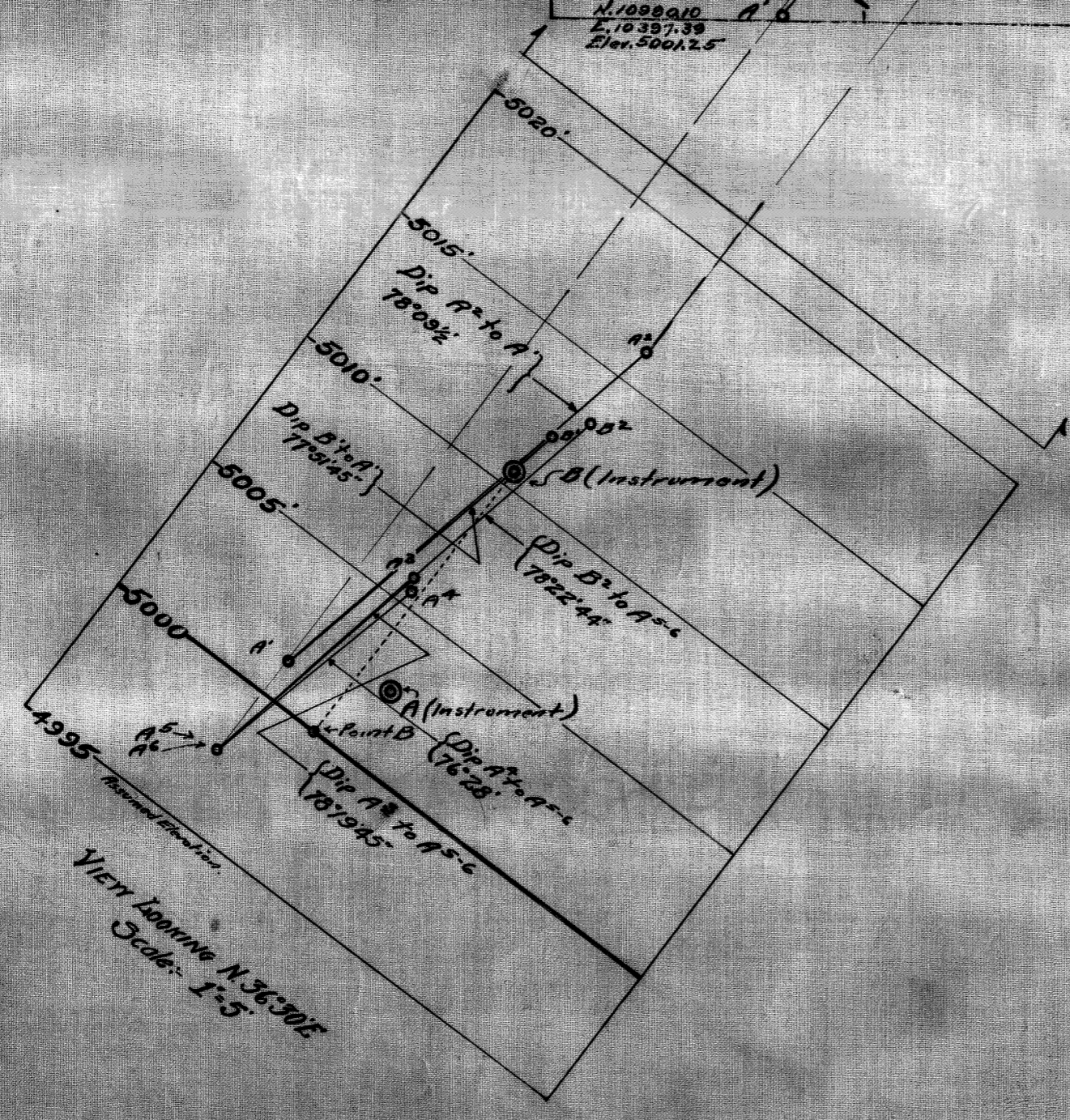

**Vein Section**  
Scale: 1"=5'

**PLAN AND SECTION**  
SHOWING POINTS ON  
**VEIN**  
IN BUFFALO MINE, OF  
GRANT COUNTY, ORE.  
Scale: 1"=5'

To Accompany Map Showing Traverse on Buffalo Claim Surveyed by Phil H. Anderson, Oct. 9-11-1925. This Section and PLAN Supercedes the data relative to 'Dip' of Vein on the above mentioned Map. Coordinates shown hereon are referred to the same initial point and Meridians as those shown on above mentioned Map. The Azimuths of Courses B to C and Course C to D were transposed on said Maps. Hence the positions of said points, as shown thereon, are erroneous. Baker, Oregon, Nov. 6-1925. Phil H. Anderson

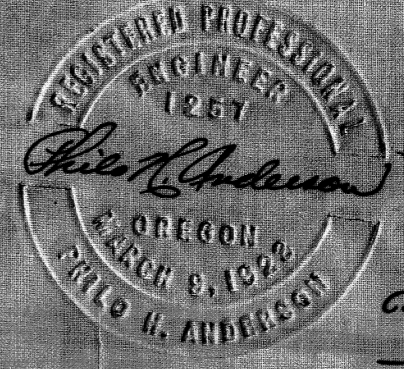

Calculations checked by:  
*Geo. J. Dale*  
Gladstone, Oregon