

Township 11 South Range 43 East.

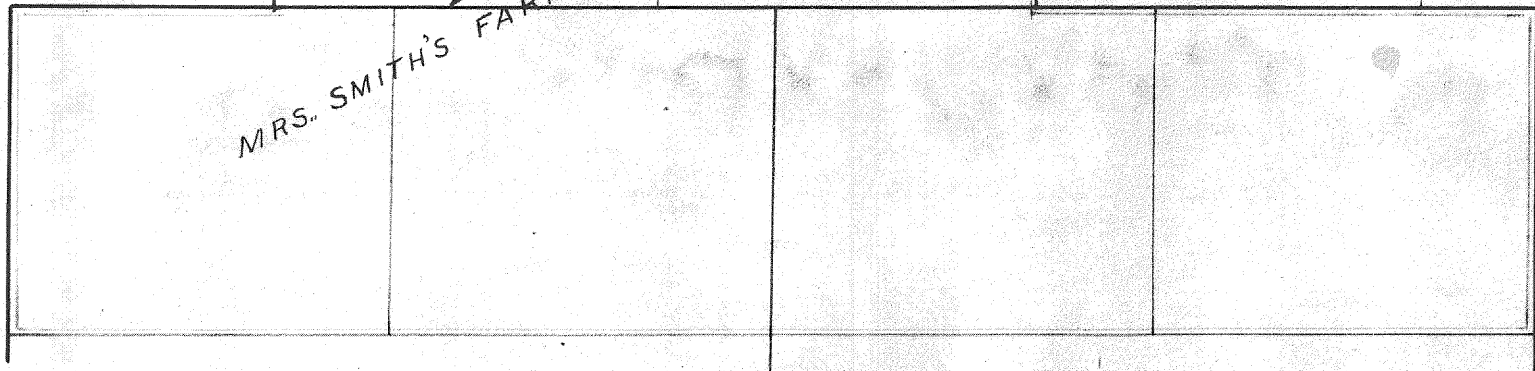
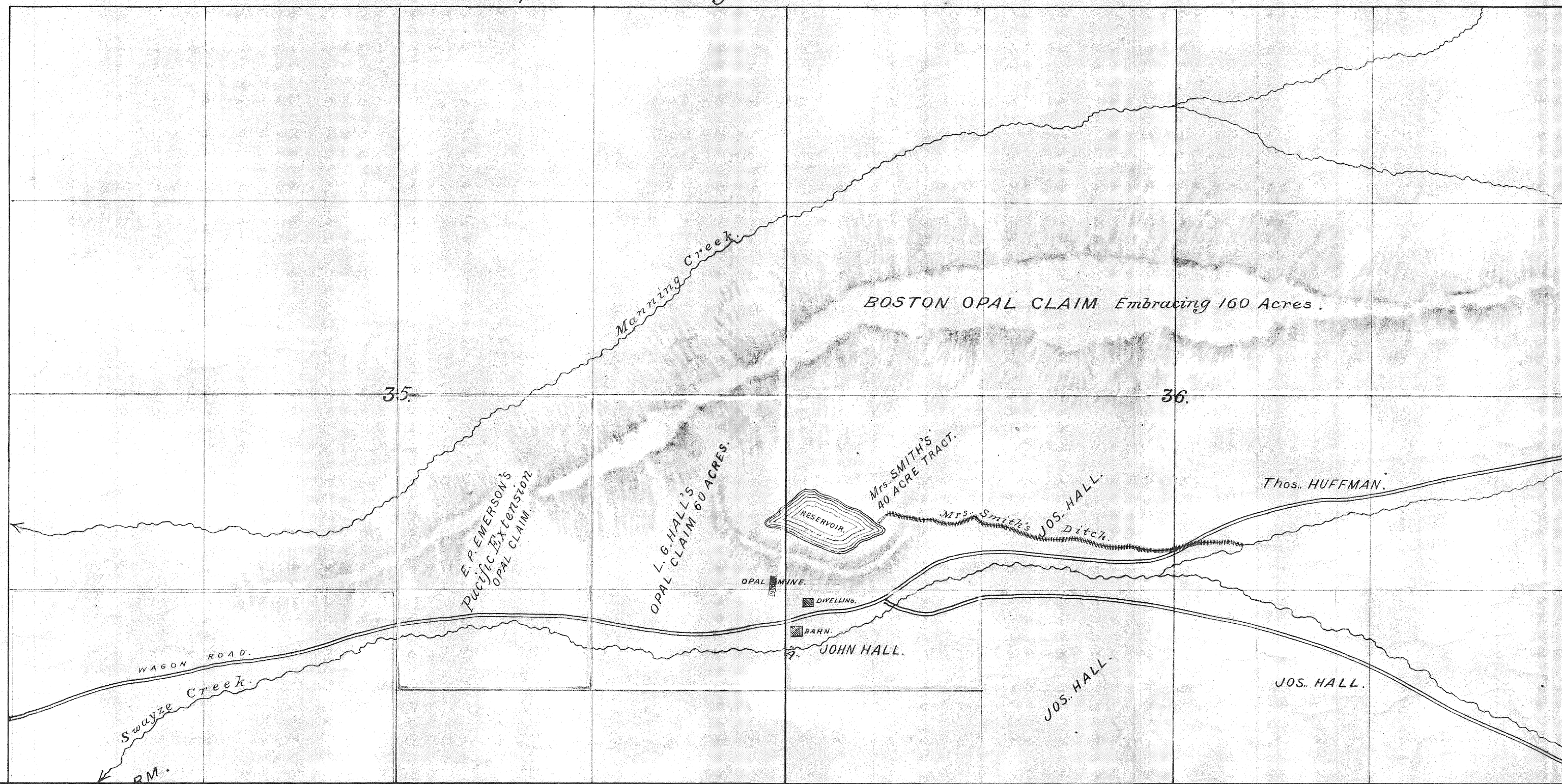

REFERENCES

Point A is 75 Feet lower than Reservoir.
Summit of Mountain on the Boston Claim is 300 ft above Reservoir.

MAP
OF THE
**PACIFIC
OPAL MINES**

situated on Sections 35 and 36 in Township 11 S.
Range 43. East, also showing adjacent lands and
improvements. Baker County State of Oregon.

Drawn April 17th 1897.
by C.M. Foster Sur.
Scale 10 Chs. = 1 Inch.