

11-18-50
SCHLUMBERGER

SCHLUMBERGER DIRECTIONAL SURVEY

RECEIVED P110
NOV 24 1980
FENIX & SCISSON INC.
AMERICAN SURVEYING

OLD MILD FLRT #79

OLD MILD FLRT AREA FIELD

CLATSOP COUNTY, OREGON

RUN NO. 1 118.0 - 1189.0 15-PLUG-80 4764
RUN NO. 2 1206.0 - 5928.0 29-SEF-80 4765

SURVEY IS TIED-IN TO RUN NO. ONE AT 1189.0 FT

TANGENTIAL METHOD

JOB REFERENCE NUMBER 4765

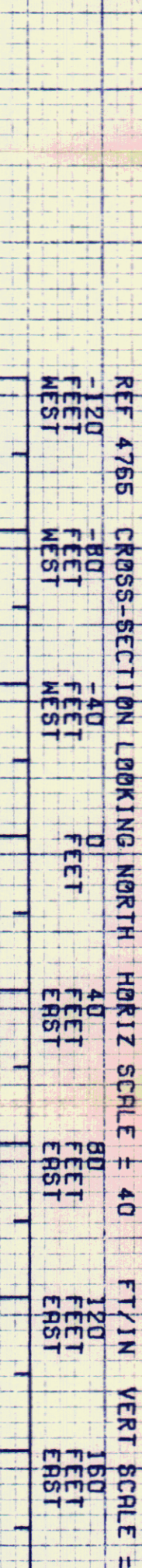
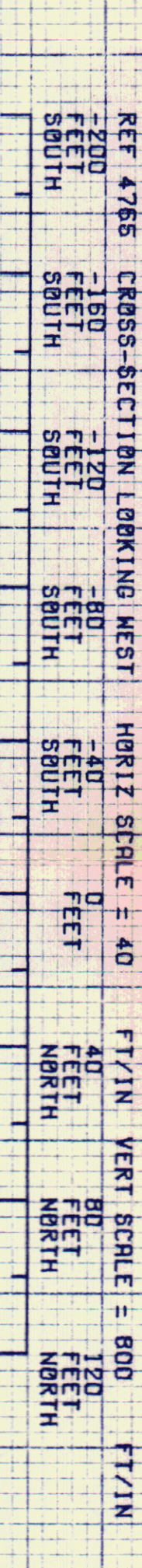
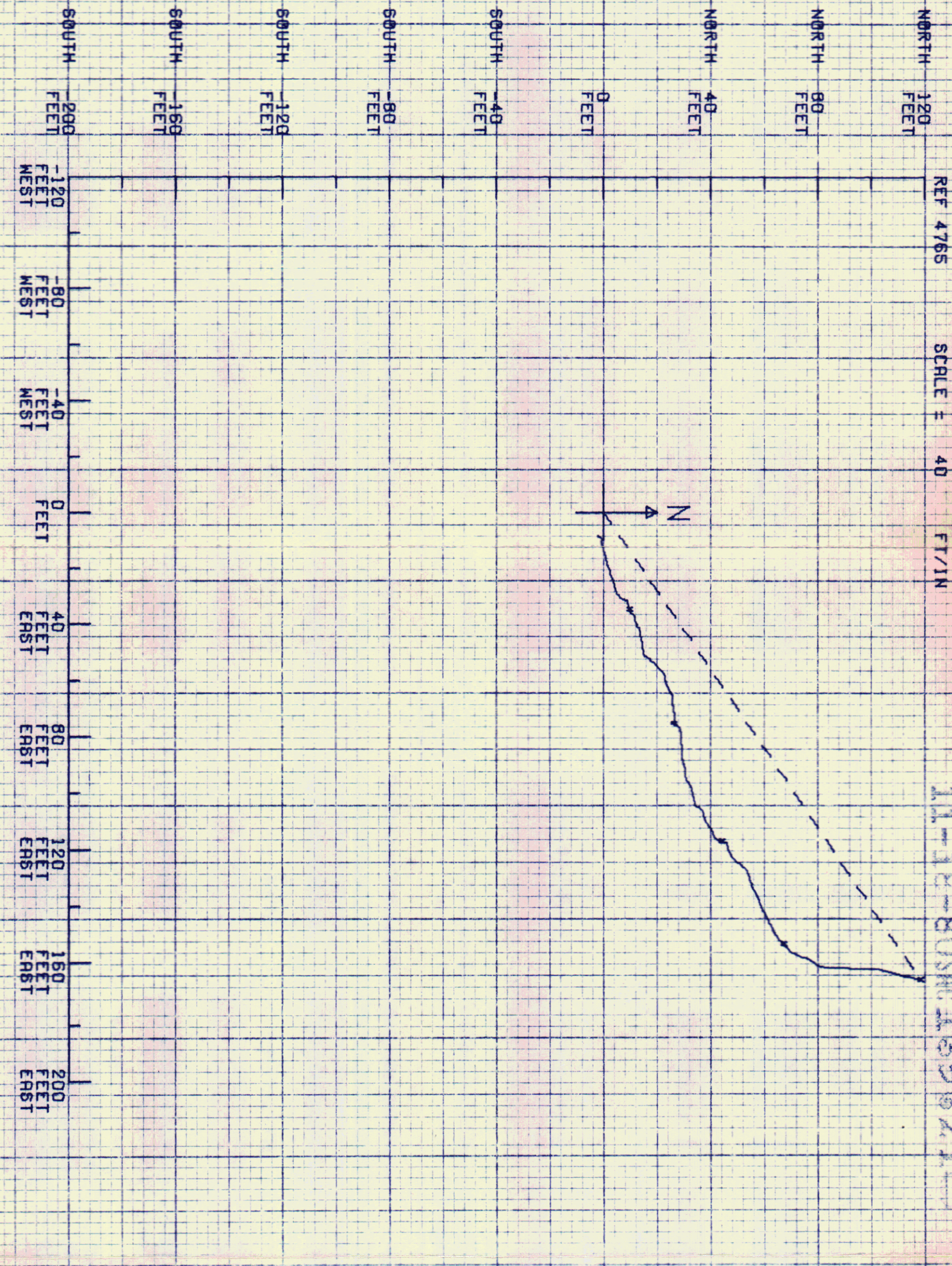
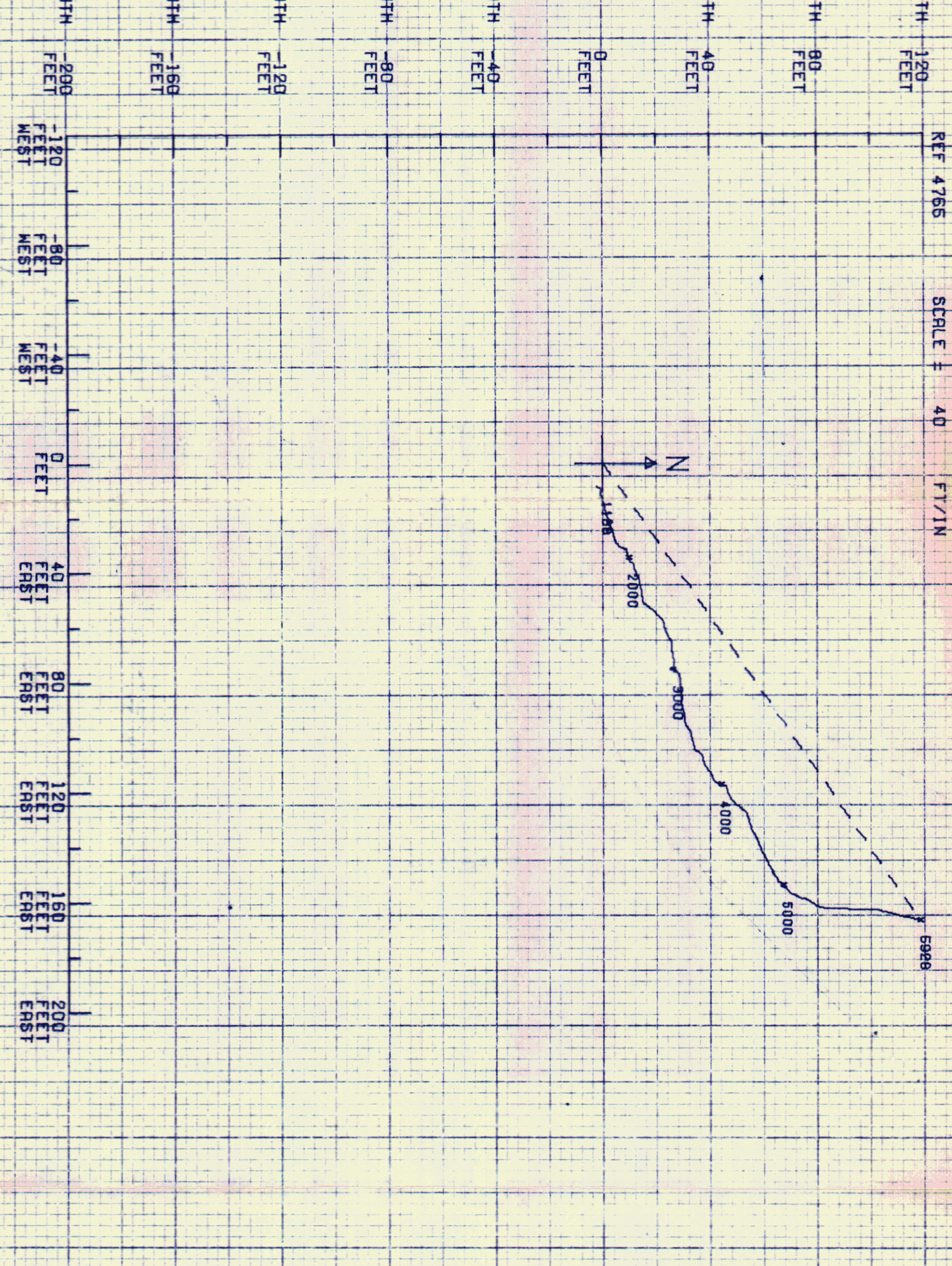

11-18-50
SCHLUMBERGER

TANGENTIAL METHOD

BOTTOM HOLE LOCATION

COURSE LENGTH 204.4 FEET

COURSE AZIMUTH 54.5 DEG.

MEASURED DEPTH 5928.0 FEET

TRUE VERTICAL DEPTH 5922.2 FEET

DISTANCE NORTH 118.6 FEET

DISTANCE EAST 166.5 FEET

REF 4765