

Company General Petroleum Corporation

Lease Long Bell Well No. 1

Sec. 27, T. 20S, R. JOW WM

Location Douglas Co., Oregon

Elevation 48.05 Datum B.L.M.

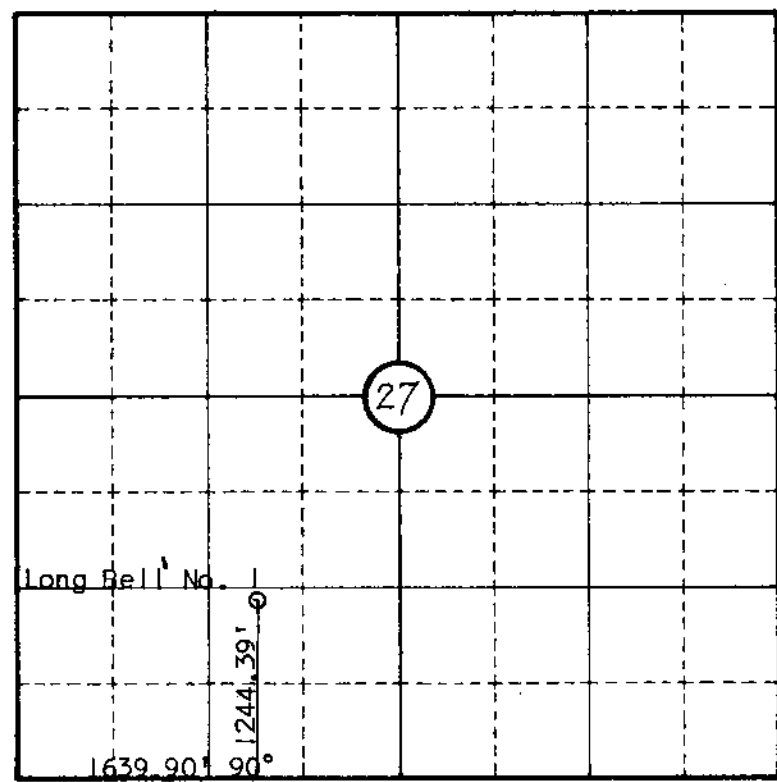

Scale - 4 inches equal 1 mile S. 88° 48' E (Per Twns. Plat 1954)

This is to certify that the above plat was prepared from field notes of actual surveys made by me or under my supervision and that the same are true and correct to the best of my knowledge and belief.

SEAL

REGISTERED  
OREGON  
LAND SURVEYOR

*Wm E Meek*

Registered Land Surveyor

*Wm E Meek*  
SEPT. 11, 1953  
*Wm E. Meek*  
302

Surveyed July 11, 1957