

Region 5 District 13

ENTERPRISE-LEWISTON HIGHWAY No. 11

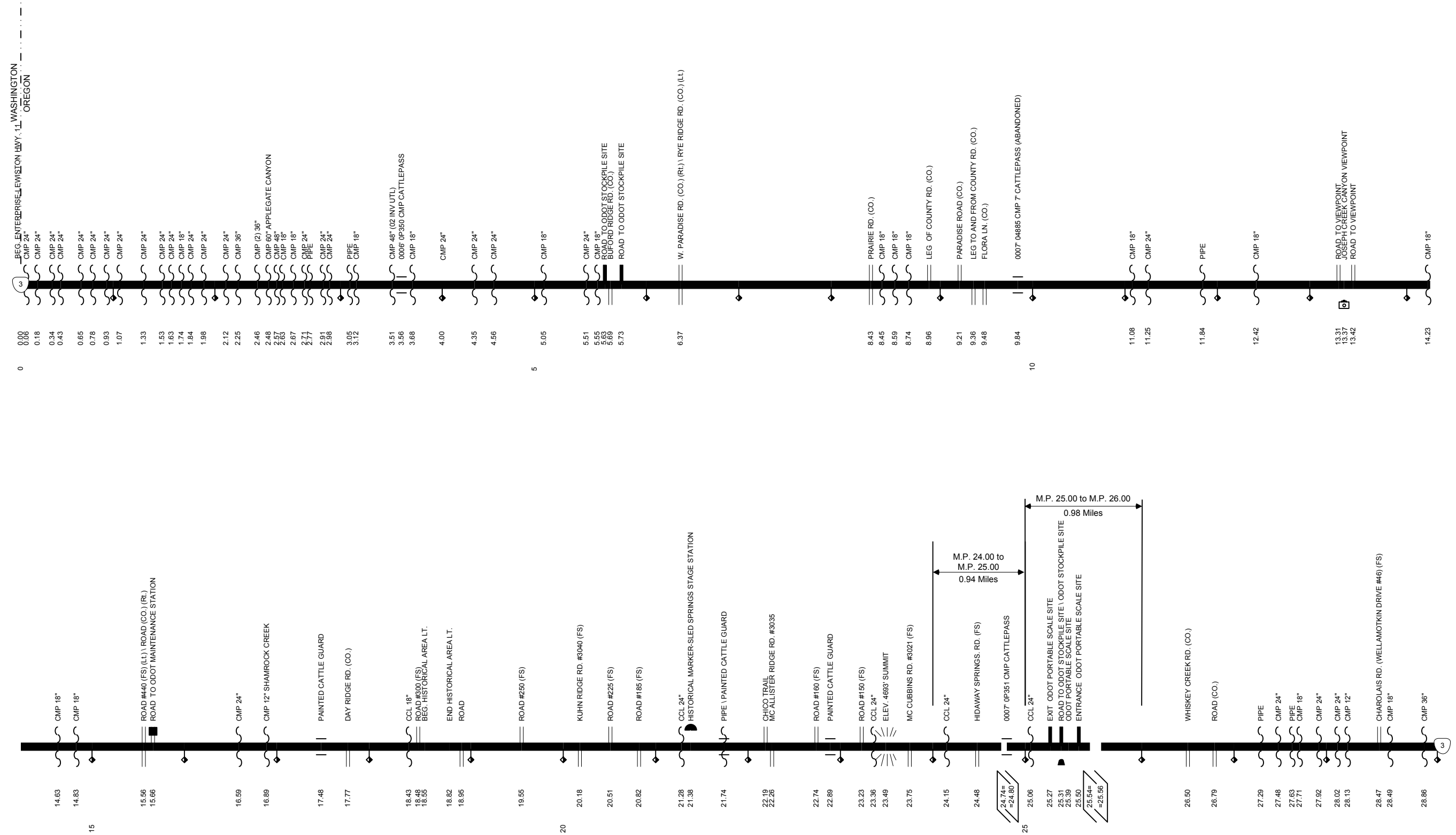

Region 5 District 13

ENTERPRISE-LEWISTON HIGHWAY No. 11

Sheet 2 of 2
 January 2006

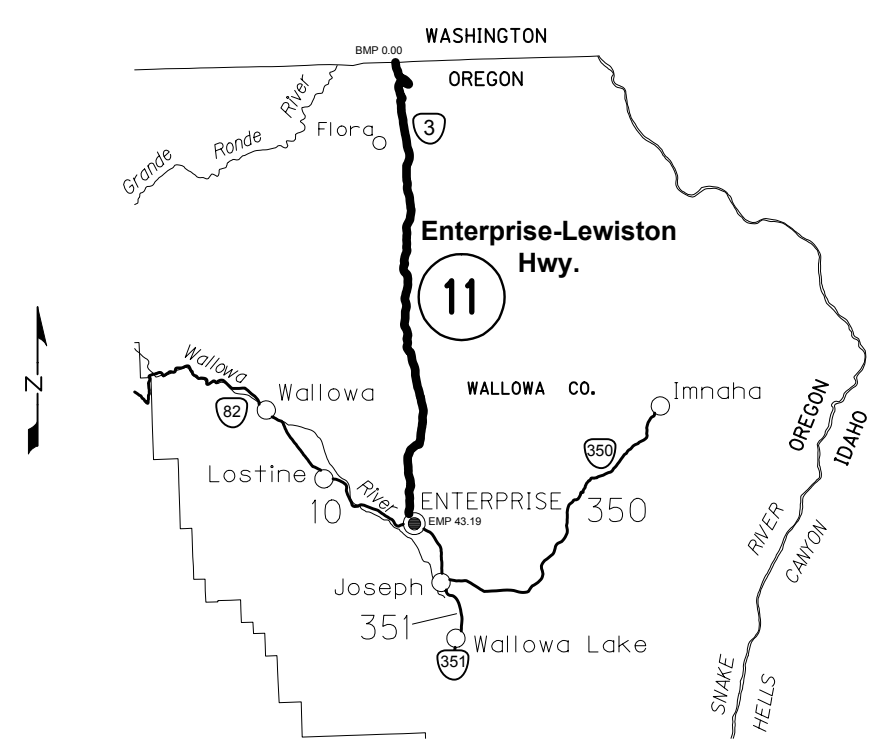
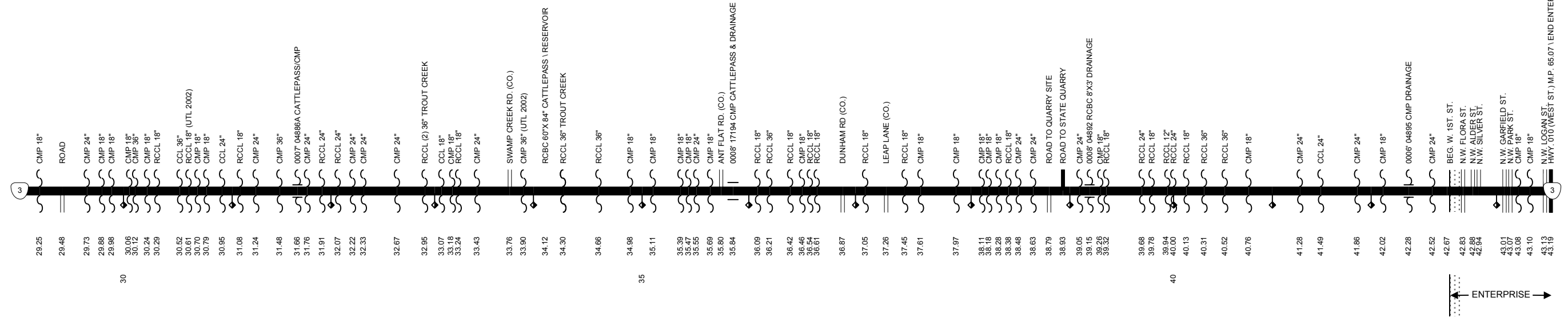

EQUATIONS: M.P. 24.74 = M.P. 24.80 M.P. 25.54 = M.P. 25.56	STATE HIGHWAY NO. 11		Urban Area
	TOTAL MILEAGE	43.11	
DUPLICATE MILEAGE: None	Located Line	0.00	0.00
	Temporary Route	0.00	0.00
	Existing Highway	43.11	0.00
Note: Jurisdiction of intersecting local roads as of: Wallowa Co. 2005	ADDITIONAL MILEAGE	0.00	
	Connections	0.00	
	Frontage Roads	0.00	
	EXCLUDED MILEAGE	0.00	
	Roadway 2	0.00	