

NOTE: Milepoints on Straightline Chart are not to scale.

Region 2 District 4

ALSEA HIGHWAY No. 27

Sheet 1 of 4
 March 2009

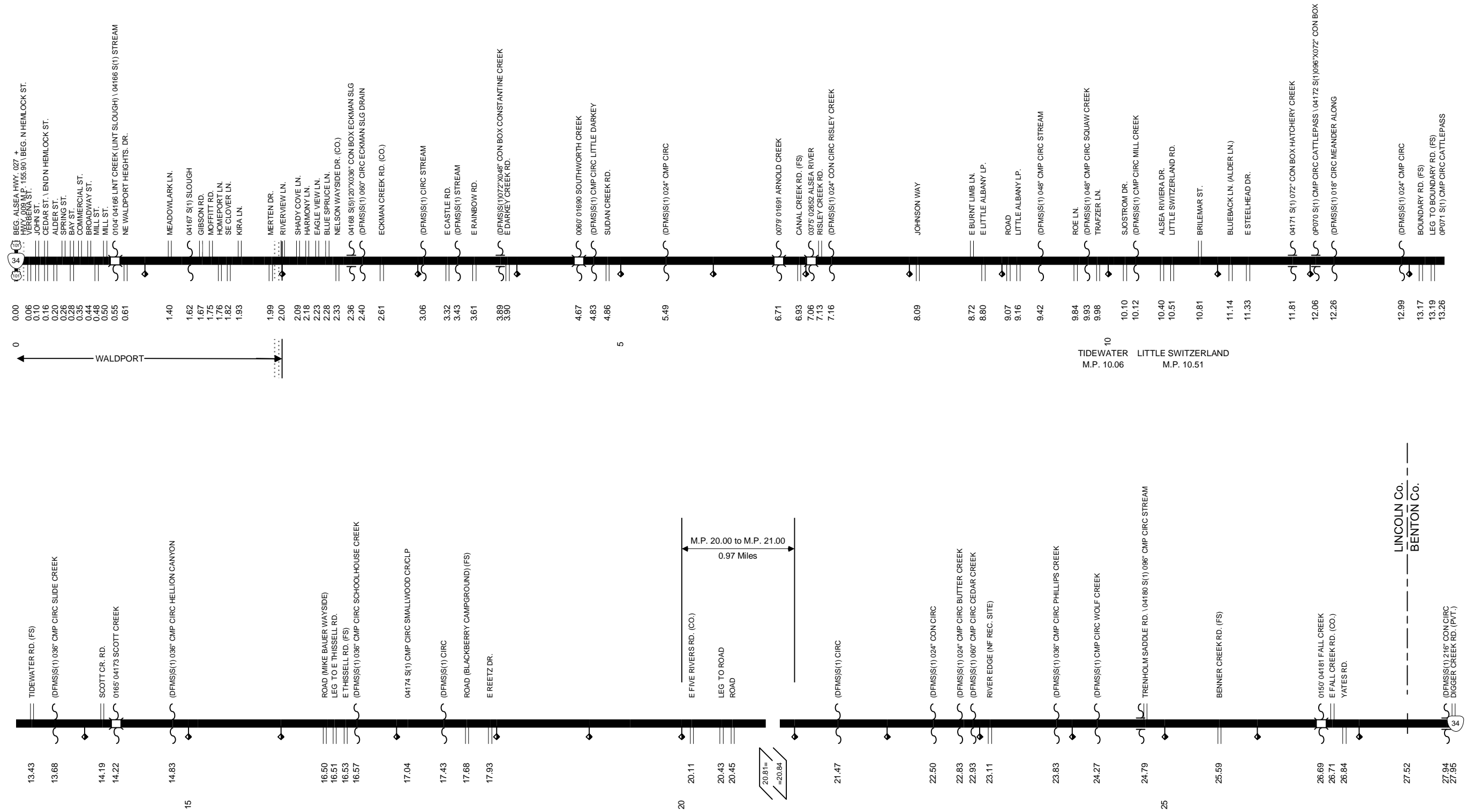

Region 2 District 4

ALSEA HIGHWAY No. 27

Sheet 3 of 4
 March 2009

54.53	0120 01259 ROCK CREEK
54.56	ROCK CREEK RD.
54.85	(DFMS)S(1)048"X072" CON BOX CATTLEPASS
55.15	(DFMS)S(1) CIRC \ MILEPOINT 55.00
55.35	02983 S(1)072"X036" CON BOX WATKINS CREEK
55.42	HENKLE WAY (CO.)
55.45	(DFMS)S(1)048" CON CIRC \ FORRESTS PL
55.53	KNOWLTON LN.
55.60	PLEASANT VALLEY CEMETERY RD. (PUB.)
55.76	GRAY CREEK LN. (PVT.)
55.91	(DFMS)S(1)036" CMP CIRC GRAY CREEK
56.00	CHESH LN.
56.08	(DFMS)S(1)024" CON CIRC
56.13	(DFMS)S(1)024" CON CIRC
56.20	(DFMS)S(1)024" CON CIRC
56.26	MC GARRY LN.
56.48	02985 S(1)072"X036" CON BOX GELLATLY CREEK
56.55	(DFMS)S(1) CIRC
56.86	BEVINS PARK LN.
56.87	STOUDER WAY
57.07	(DFMS)S(1)024" CON CIRC
57.13	(DFMS)S(1)060" CMP CIRC BOUNDS CREEK
57.29	(DFMS)S(1) CIRC
57.55	HARTLESS HILL LN. (PVT.)
57.67	ROAD (OREGON DEPT. OF FORESTRY)
57.75	ROAD (OREGON DEPT. OF FORESTRY) (L.I.) \ FIRECREEK LN. (RL)
57.76	(DFMS)S(1)024" CMP CIRC
57.94	GELLATLY WAY (CO.) \ (DFMS)S(1)060" CMP CIRC BLAIR CREEK
58.00	GRANGE HALL RD. (CO.)
58.03	OLD PEAK RD. (CO.)
58.06	STOVALL LN. (PUB.)
58.23	
58.43	0223 00771 MARYS RIVER (FLYNN BRIDGE)
58.50	027AE CONN. M.P. 49.50
58.54	LEG FROM HWY. 033
58.56	HWY. 033 M.P. 49.73 \ END ALSEA HWY. 027

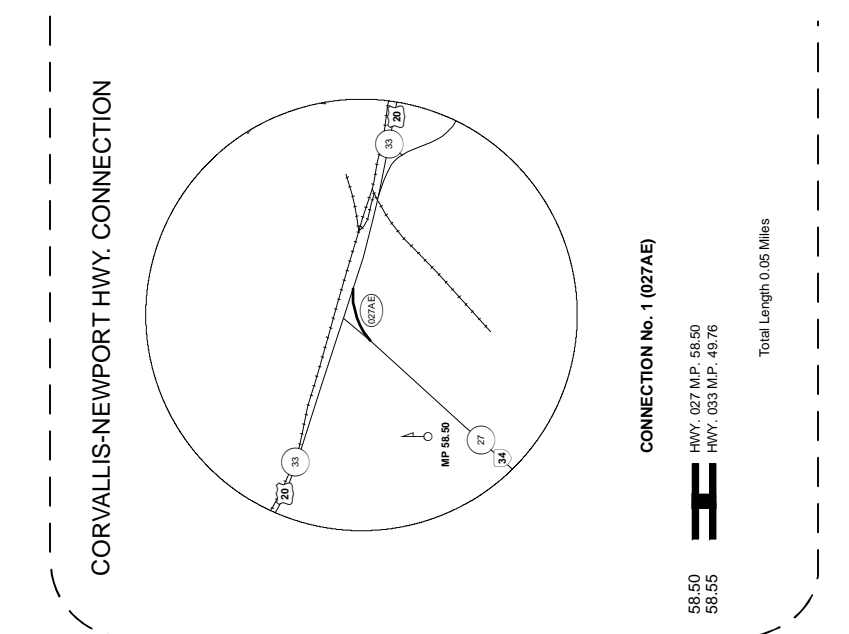
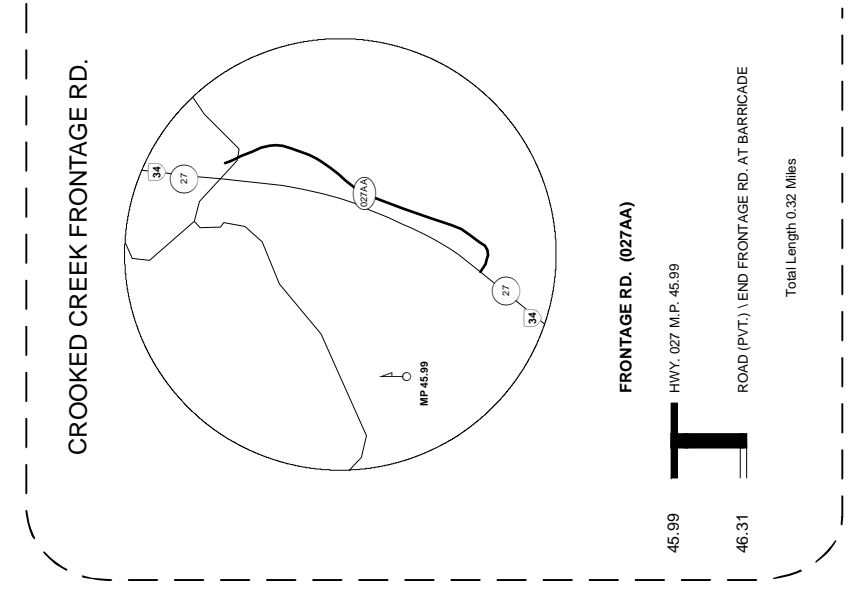

Region 2 District 4

ALSEA HIGHWAY No. 27

Sheet 4 of 4
 March 2009



Legend

- State Highway No. 27
- State Highways
- City Limit
- County Boundary

⬢	⬢	⬢	Interstate, US Route, State Route Markers
⊙	⊙	⊙	State Highways

0 3 6 12 Miles

		Urban Area	
EQUATIONS:			
M.P. 20.81 - 20.84	LOSS		
	-0.03 Miles		
M.P. 28.21 - 28.35	-0.14 Miles		
M.P. 48.65 - 50.43	-1.78 Miles		
	Total	-1.95 Miles	
DUPLICATE MILEAGE:			
None			
Note:			
Jurisdiction of intersecting local roads as of:			
Lincoln County	2008		
Benton County	2007		
TOTAL MILEAGE	56.61	0.56	
Located Line	0.00	0.00	
Temporary Route	0.00	0.00	
Existing Highway	56.61	0.56	
ADDITIONAL MILEAGE			
Connections	0.05		
Frontage Roads	0.32		
EXCLUDED MILEAGE			
Located Line	0.00		
Temporary Route	0.00		
Roadway 2	0.00		