

Region 1 District 2B / Region 2 District 3

CASCADE HWY SOUTH HIGHWAY No. 160

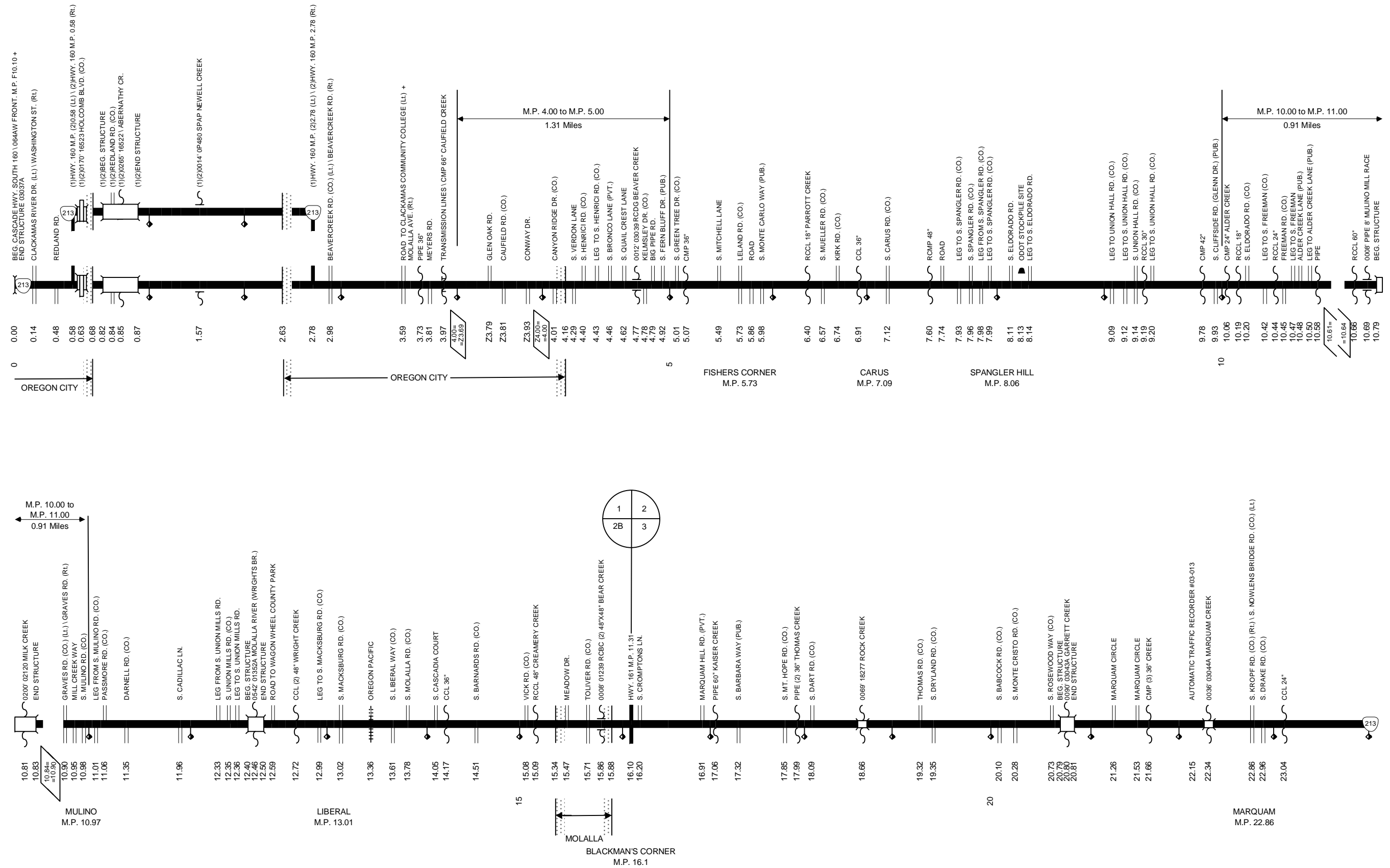

Region 2 District 3

CASCADE HWY SOUTH HIGHWAY No. 160

Sheet 2 of 3
 November 2007

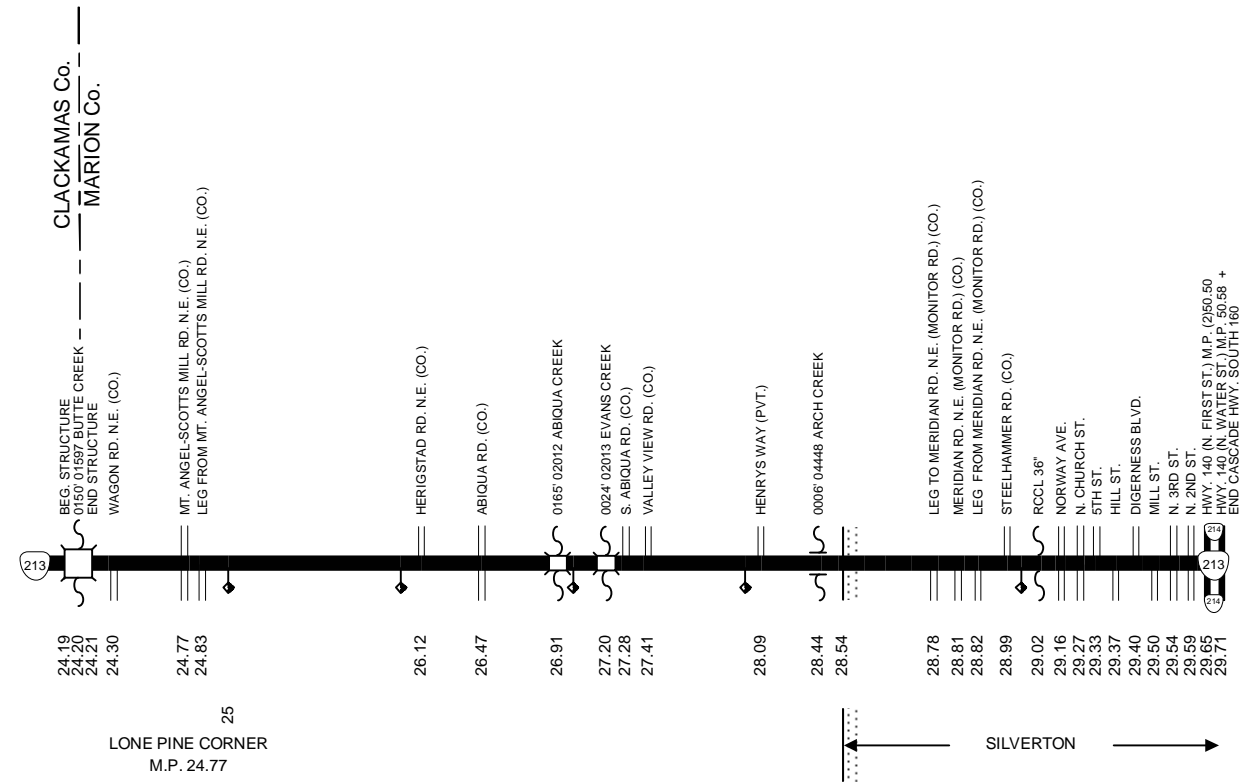

Region 1 District 2B / Region 2 District 3

CASCADE HWY SOUTH HIGHWAY No. 160

Sheet 3 of 3
November 2007

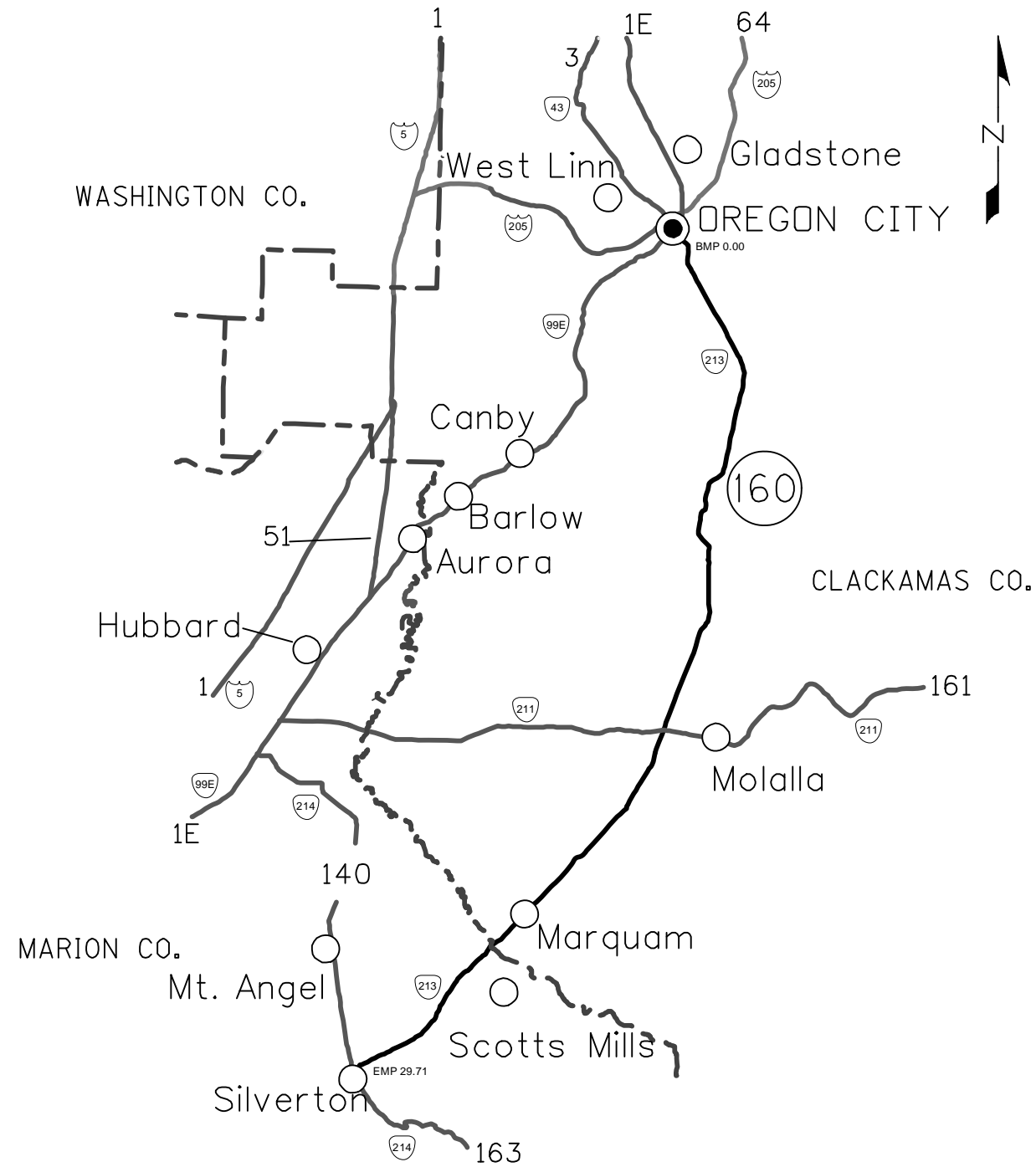

		Urban Area			
EQUATIONS: M.P. 23.69 = 24.00 M.P. 10.61 = 10.64 M.P. 10.84 = 10.90 Total DUPLICATE MILEAGE: None Note: Jurisdiction of intersecting local roads as of: Clackamas Co. 2005 Marion Co. 2005	LOSS	GAIN	TOTAL MILEAGE	29.93	9.41
	0.00	0.31	Located Line	0.00	0.00
	0.03		Temporary Route	0.00	0.00
	0.06		Existing Highway	29.93	9.41
	0.09	0.31	ADDITIONAL MILEAGE	0.00	
			Connections	0.00	
			Frontage Roads	0.00	
			EXCLUDED MILEAGE	2.20	
			Located Line	0.00	
			Temporary Route	0.00	
		Roadway 2	2.20		