



Oregon

Theodore R. Kulongoski, Governor

Department of Transportation

Technical Services
Roadway Engineering Section
355 Capitol Street NE, Room 222
Salem, OR 97301-3871
Telephone 503-986-3714
FAX 503-986-3749

DATE: October 21, 2009

Addenda No. 1

TO: PLAN HOLDERS

PREPARED BY: *Randy Henderson*

APPROVED BY: *Randy Henderson* P.E.

SUBJECT: OR99W Locke Creek Bridge Section
Pacific Highway West
Benton County
Bridges and Structures Project
(Bids to be opened and read November 5, 2009)

The following changes are made to the Project Bid Booklet:

1. The following changes are made to the Project Bid Items:

a. Quantity and Unit changes:

<u>Number</u>	<u>Item</u>	<u>Unit</u>		<u>Quantity</u>	
		<u>Original</u>	<u>New</u>	<u>Original</u>	<u>New</u>
0590	AGGREGATE SUBBASE	CUYD	TON	1,076	1,961
0600	AGGREGATE BASE	CUYD	TON	1,206	2,198

b. Quantity changes:

<u>Number</u>	<u>Item</u>	<u>Quantity</u>	
		<u>Original</u>	<u>New</u>
0340	GENERAL EXCAVATION	4,659	3,605

c. Deleted items:

<u>Number</u>	<u>Item</u>
0490	PILE LOAD TEST (STATIC)

d. Added items:

<u>Number</u>	<u>Item</u>	<u>Unit</u>	<u>Quantity</u>
0990	REINFORCED PILE TIPS	EACH	24
1000	SAW CUT TEXTURING	SQYD	292

Make a copy of and use the new attached Bid Sheets. A Bid **not** including these new Bid Sheets **will be rejected as non-responsive**.

The following changes are made to the Project Special Provisions:

1. Subsection 01092.80 Measurement - This subsection is replaced with the following subsection:

01092.80 Measurement - No measurement of quantities will be made for work performed under this Section. The estimated quantities of materials are:

Item	Quantity
Blended Compost and Topsoil Mixture	250 Cu. Yd.
Loose Riprap, Class 50 (Dispersion Blanket)	12 Cu. Yd.
Ditch Excavation	1,054 Cu. Yd.

The following changes are made to the Project Plans:

1. Plan sheets 3A, 4A, and 4C are replaced with revised plan sheets 3A, 4A, and 4C.

These changes will be included in the Contract for this Project. It is understood that your Bid will be submitted accordingly.

Make copies of the new Bid Sheets to replace the Special Provisions Bid Schedule Sheets.

_____:_____

Attachments: New Bid Sheets
Revised Plan Sheets

BID SCHEDULE

CONTRACT ID: 14135

PROJECT: OR99W: LOCKE CREEK BRIDGE
REPLACEMENT PROJECT

PROJECT KEY: 14839

ADDENDUM NUMBER: 1

ITEM NO	ITEM DESCRIPTION	QUANTITY AND UNITS	UNIT PRICE (IN FIGURES)	BID AMOUNT (IN FIGURES)
---------	------------------	--------------------	----------------------------	----------------------------

SECTION 0001 TEMPORARY FEATURES AND APPURTENANCES

0010	0100-0100000T ON-THE-JOB TRAINING	600.00 HOUR		
0020	0210-0100000A MOBILIZATION	ALL LS		
0030	0225-0100000A TEMPORARY PROTECTION AND DIRECTION OF TRAFFIC	ALL LS		
0040	0225-0102000J TEMPORARY SIGNS	438.00 SQFT		
0050	0225-0105000E TEMPORARY BARRICADES, TYPE III	2.00 EACH		
0060	0225-0126000F TEMPORARY CONCRETE BARRIER, REFLECTORIZED	1,231.00 FOOT		
0070	0225-0132000F MOVING TEMPORARY CONCRETE BARRIER	2,671.00 FOOT		
0080	0225-0133000E TEMPORARY IMPACT ATTENUATOR	2.00 EACH		
0090	0225-0134000E TEMPORARY IMPACT ATTENUATOR, NARROW SITE SYSTEM	1.00 EACH		
0100	0225-0136000E MOVING TEMPORARY IMPACT ATTENUATORS	6.00 EACH		
0110	0225-0141100E REFLECTIVE BARRIER PANELS	75.00 EACH		
0120	0225-0141200E REPAIR TEMPORARY IMPACT ATTENUATOR	3.00 EACH		

BID SCHEDULE

CONTRACT ID: 14135

PROJECT: OR99W: LOCKE CREEK BRIDGE
REPLACEMENT PROJECT

PROJECT KEY: 14839

ADDENDUM NUMBER: 1

ITEM NO	ITEM DESCRIPTION	QUANTITY AND UNITS	UNIT PRICE (IN FIGURES)	BID AMOUNT (IN FIGURES)
0130	0225-0141300E REPAIR TEMPORARY IMPACT ATTENUATOR, NARROW SITE SYSTEM	EACH	1.00	
0140	0225-0145000E TEMPORARY PLASTIC DRUMS	EACH	62.00	
0150	0225-0148000E TEMPORARY REFLECTIVE PAVEMENT MARKERS	EACH	68.00	
0160	0225-0153000F TEMPORARY STRIPING	FOOT	12,420.00	
0170	0225-0154000F STRIPE REMOVAL	FOOT	11,154.00	
0180	0225-0164000E PORTABLE CHANGEABLE MESSAGE SIGNS	EACH	2.00	
0190	0225-0168000T FLAGGERS	HOUR	200.00	
0200	0225-0168100E FLAGGER STATION LIGHTING	EACH	2.00	
0210	0225-0169000E TRAFFIC CONTROL SUPERVISOR	EACH	70.00	
0220	0280-0100000A EROSION CONTROL	LS	ALL	
0230	0280-0106000E CHECK DAM	EACH	17.00	
0240	0280-0113000F SEDIMENT FENCE, UNSUPPORTED	FOOT	2,082.00	
0250	0290-0100000A POLLUTION CONTROL PLAN	LS	ALL	

BID SCHEDULE

CONTRACT ID: 14135

PROJECT: OR99W: LOCKE CREEK BRIDGE
REPLACEMENT PROJECT

PROJECT KEY: 14839

ADDENDUM NUMBER: 1

ITEM NO	ITEM DESCRIPTION	QUANTITY AND UNITS	UNIT PRICE (IN FIGURES)	BID AMOUNT (IN FIGURES)
0260	0290-0102000A WORK CONTAINMENT PLAN AND SYSTEM	LS ALL		

SECTION 0002 ROADWORK

0270	0305-0100000A CONSTRUCTION SURVEY WORK	LS ALL		
0280	0310-0100000F REMOVAL OF PIPES	FOOT 31.00		
0290	0310-0103000J REMOVAL OF SURFACINGS	SQYD 104.00		
0300	0310-0112000A REMOVAL OF FENCES	LS ALL		
0310	0310-0113000A REMOVAL OF GUARDRAIL	LS ALL		
0320	0310-0119000F ASPHALT PAVEMENT SAW CUTTING	FOOT 1,200.00		
0330	0320-0100000R CLEARING AND GRUBBING	ACRE 0.70		
0340	0330-0105000K GENERAL EXCAVATION	CUYD 3,605.00		
0350	0350-0105000J SUBGRADE GEOTEXTILE	SQYD 4,261.00		
0360	0390-0105000K LOOSE RIPRAP, CLASS 50	CUYD 4.00		
0370	0390-0111000K LOOSE RIPRAP, CLASS 200	CUYD 343.00		

SECTION 0003 DRAINAGE

BID SCHEDULE

CONTRACT ID: 14135

PROJECT: OR99W: LOCKE CREEK BRIDGE
REPLACEMENT PROJECT

PROJECT KEY: 14839

ADDENDUM NUMBER: 1

ITEM NO	ITEM DESCRIPTION	QUANTITY AND UNITS	UNIT PRICE (IN FIGURES)	BID AMOUNT (IN FIGURES)
0380	0445-010012AF 12 INCH CULVERT PIPE, 5 FT DEPTH	79.00 FOOT		
0390	0445-010018AF 18 INCH CULVERT PIPE, 5 FT DEPTH	64.00 FOOT		
0400	0445-0700120E SLOPED END SECTIONS, 12 INCH	4.00 EACH		
0410	0445-0700180E SLOPED END SECTIONS, 18 INCH	1.00 EACH		

SECTION 0004 BRIDGE #20799

0420	0501-0100000A BRIDGE REMOVAL WORK	ALL LS		
0430	0510-0100000A SHORING, CRIBBING AND COFFERDAMS	ALL LS		
0440	0510-0101000A STRUCTURE EXCAVATION	ALL LS		
0450	0510-0108000A GRANULAR STRUCTURE BACKFILL	ALL LS		
0460	0520-0100000A FURNISH PILE DRIVING EQUIPMENT	ALL LS		
0470	0520-0111000F FURNISH HP 14 X 73 STEEL PILES	720.00 FOOT		
0480	0520-0210000E DRIVE HP 14 X 73 STEEL PILES	24.00 EACH		
0490	0000-0100000A DELETED BID ITEM	ALL LS	0.00	0.00

BID SCHEDULE

CONTRACT ID: 14135

PROJECT: OR99W: LOCKE CREEK BRIDGE
REPLACEMENT PROJECT

PROJECT KEY: 14839

ADDENDUM NUMBER: 1

ITEM NO	ITEM DESCRIPTION	QUANTITY AND UNITS	UNIT PRICE (IN FIGURES)	BID AMOUNT (IN FIGURES)
0500	0530-0100000A REINFORCEMENT	LS ALL		
0510	0540-0302000A GENERAL STRUCTURAL CONCRETE, CLASS 4000	LS ALL		
0520	0540-0307000A GENERAL STRUCTURAL CONCRETE, CLASS HPC4000	LS ALL		
0530	0545-0100000J REINFORCED CONCRETE BRIDGE END PANELS	SQYD 405.00		
0540	0550-0136000F 18 INCH PRECAST PRESTRESSED SLABS	FOOT 718.00		
0550	0581-0100000E BRIDGE DRAINS	EACH 2.00		
0560	0587-0120000A TYPE "F" CONCRETE RAIL	LS ALL		
0570	0589-0100000A UTILITY ATTACHMENT ON STRUCTURES	LS ALL		

SECTION 0005 BASES

0580	0620-0120000J COLD PLANE PAVEMENT REMOVAL, 2 INCHES DEEP	SQYD 3,955.00		
0590	0641-0100000M AGGREGATE SUBBASE	TON 1,961.00		
0600	0641-0102000M AGGREGATE BASE	TON 2,198.00		

SECTION 0006 WEARING SURFACES

BID SCHEDULE

CONTRACT ID: 14135

PROJECT: OR99W: LOCKE CREEK BRIDGE
REPLACEMENT PROJECT

PROJECT KEY: 14839

ADDENDUM NUMBER: 1

ITEM NO	ITEM DESCRIPTION	QUANTITY AND UNITS	UNIT PRICE (IN FIGURES)	BID AMOUNT (IN FIGURES)
0610	0745-0302000M LEVEL 3, 1/2 INCH DENSE HMAC	2,142.00 TON		
0620	0745-0640000M PG 70-22 ASPHALT IN HMAC	128.00 TON		
0630	0749-0110000E ASPHALT APPROACHES	4.00 EACH		

SECTION 0007 PERMANENT TRAFFIC SAFETY AND GUIDANCE DEVICES

0640	0810-0104000F GUARDRAIL, TYPE 2A	664.00 FOOT		
0650	0810-0107000F GUARDRAIL, TYPE 3	37.50 FOOT		
0660	0810-0109000F GUARDRAIL, TYPE 4	12.50 FOOT		
0670	0810-0120000E GUARDRAIL ANCHORS, TYPE 1 MODIFIED	4.00 EACH		
0680	0810-0122000E GUARDRAIL END PIECES, TYPE B	4.00 EACH		
0690	0810-0126000E GUARDRAIL TRANSITION	4.00 EACH		
0700	0810-0131000E GUARDRAIL TERMINALS, NON-FLARED, TEST LEVEL 2	4.00 EACH		
0710	0840-0102000E DELINEATORS, TYPE 2	11.00 EACH		
0720	0840-0104100E DELINEATORS, TYPE 4 ALTERNATE 1	8.00 EACH		

BID SCHEDULE

CONTRACT ID: 14135

PROJECT: OR99W: LOCKE CREEK BRIDGE
REPLACEMENT PROJECT

PROJECT KEY: 14839

ADDENDUM NUMBER: 1

ITEM NO	ITEM DESCRIPTION	QUANTITY AND UNITS	UNIT PRICE (IN FIGURES)	BID AMOUNT (IN FIGURES)
0730	0840-0106000E MILEPOST MARKER POSTS	4.00 EACH		
0740	0855-0102000E BI-DIRECTIONAL YELLOW TYPE 1 MARKERS	58.00 EACH		
0750	0860-0200000F LONGITUDINAL PAVEMENT MARKINGS - PAINT	7,345.00 FOOT		
0760	0867-0103000E PAVEMENT LEGEND, TYPE B: ARROWS	2.00 EACH		
0770	0867-0107000E PAVEMENT LEGEND, TYPE B: "ONLY"	1.00 EACH		
0780	0867-0111000E PAVEMENT LEGEND, TYPE B: "SCHOOL"	1.00 EACH		
0790	0867-0145000J PAVEMENT BAR, TYPE B	135.00 SQFT		

SECTION 0008 PERMANENT TRAFFIC CONTROL AND ILLUMINATION SYSTEMS

0800	0905-0100000A REMOVE EXISTING SIGNS	ALL LS		
0810	0905-0101000A REMOVE AND REINSTALL EXISTING SIGNS	ALL LS		
0820	0910-0100000K WOOD SIGN POSTS	444.00 FBM		
0830	0920-0100000A SIGN SUPPORT FOOTINGS	ALL LS		
0840	0930-0112000A TRIANGULAR BASE BREAKAWAY SIGN SUPPORTS	ALL LS		

BID SCHEDULE

CONTRACT ID: 14135

PROJECT: OR99W: LOCKE CREEK BRIDGE
REPLACEMENT PROJECT

PROJECT KEY: 14839

ADDENDUM NUMBER: 1

ITEM NO	ITEM DESCRIPTION	QUANTITY AND UNITS	UNIT PRICE (IN FIGURES)	BID AMOUNT (IN FIGURES)
0850	0930-0117000A PERFORATED STEEL SQUARE TUBE SIGN SUPPORTS	LS ALL		
0860	0940-0113000J TYPE "G" SIGNS IN PLACE	SQFT 26.00		
0870	0940-0124000J TYPE "W1" SIGNS IN PLACE	SQFT 24.00		
0880	0940-0134000J TYPE "Y1" SIGNS IN PLACE	SQFT 62.00		
0890	0940-0135000J TYPE "Y2" SIGNS IN PLACE	SQFT 9.00		
0900	0940-0141000J TYPE "YG" SIGNS IN PLACE	SQFT 12.75		
0910	0950-0101000A REMOVAL OF ELECTRICAL SYSTEMS	LS ALL		
0920	0990-0103000A LOOP DETECTOR INSTALLATION	LS ALL		

SECTION 0009 RIGHT-OF-WAY DEVELOPMENT AND CONTROL

0930	1030-0102000E SEEDING MOBILIZATION	EACH 1.00		
0940	1030-0115000R WETLAND SEEDING, MIX NO. 2	ACRE 0.50		
0950	1030-0118000R WATER QUALITY SEEDING	ACRE 0.10		
0960	1070-0100000E SINGLE MAILBOX SUPPORTS	EACH 1.00		

BID SCHEDULE

CONTRACT ID: 14135

PROJECT: OR99W: LOCKE CREEK BRIDGE
REPLACEMENT PROJECT

PROJECT KEY: 14839

ADDENDUM NUMBER: 1

ITEM NO	ITEM DESCRIPTION	QUANTITY AND UNITS	UNIT PRICE (IN FIGURES)	BID AMOUNT (IN FIGURES)
0970	1070-0103000E REMOVE AND REINSTALL MAILBOX SUPPORTS	EACH 1.00		
0980	1092-0100000A WATER QUALITY SWALE	LS ALL		

SECTION 0010 ADDED BID ITEMS

0990	0520-0330000E REINFORCED PILE TIPS	EACH 24.00		
1000	0540-0401000J SAW CUT TEXTURING	SQYD 292.00		
	TOTAL BID			

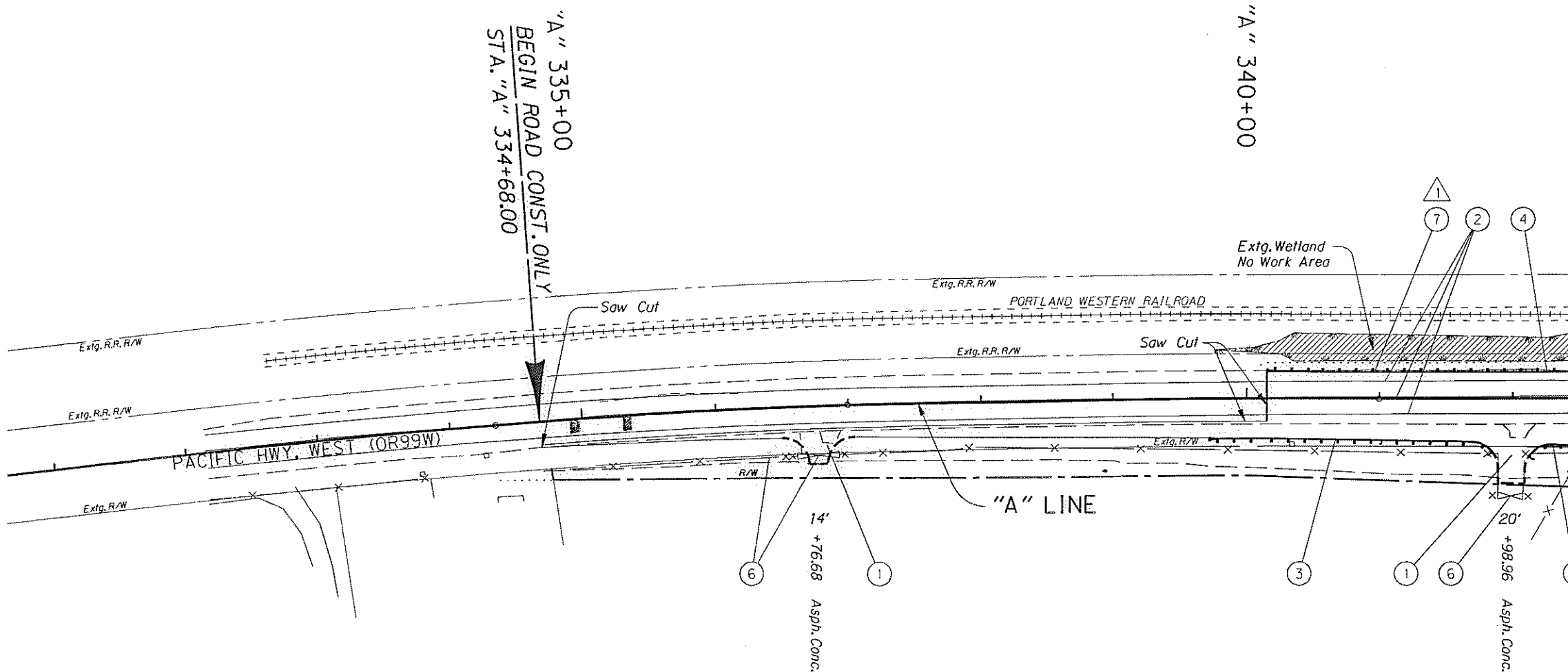

- ① Construct Type "A-1" Roadway Approach - 2
(See Drg. RD715)
- ② Remove Extg. Striping
Install Permanent Striping
(For Details, See Shfts. ST-1 Thru ST-3)
- ③ Sta. "A" 339+71.90, 30.7' Rt. To Sta. "A" 341+83.14, 38.6' Rt.
Construct Guardrail - 188' (Type 2A)
Construct Guardrail Terminal, Non-Flare (Test Level 2) - 25'
Install Type 1 Modified Anchor
Install Type B End Piece
(See Drgs. RD400, RD405, RD415, RD420 & RD450)
- ④ Sta. "A" 340+15.00, 20.6' Lt. To Sta. "A" 342+74.93, 20.0' Lt.
Remove Extg. Guardrail - 153' ±
Construct Guardrail - 223.5' (Type 2A)
- 12.5' (Type 3)
Construct Guardrail Terminal, Non-Flare (Test Level 2) - 37.5'
Construct Guardrail To Conc. Bridge Rail Transition
(See Drgs. RD410, RD440 & BR203)
- ⑤ Sta. "A" 342+13.34, 45.7' Rt. To Sta. "A" 342+67.55, 41.1' Rt.
Remove Extg. Guardrail - 116' ±
Construct Guardrail - 28' (Type 2A)
- 12.5' (Type 3)
Install Type 1 Modified Anchor
Install Type B End Piece
Construct Guardrail To Conc. Bridge Rail Transition
- ⑥ Sta. "A" 334+87, Rt. To Sta. "A" 342+56, Rt.
Remove Extg. Fence & Gates Within R/W
- ⑦ Sta. "A" 340+15.00 To Sta. "A" 342+63.00, Lt.
Remove Extg. Surfacing - 38 Sq. Yds.
- △ 1 Revised 10-20-2009,
Revised Terminology, Note 7

REVISIONS	
△ 1	Revised 10-20-2009 Addendum #1

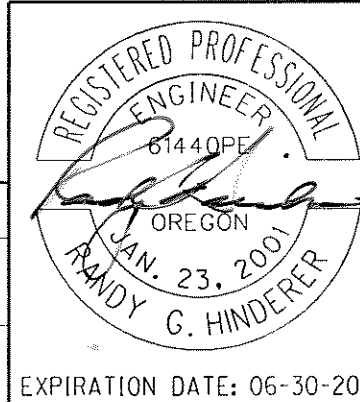

OREGON DEPARTMENT OF TRANSPORTATION	
LOCHNER CONSULTING ENGINEERS AND PLANNERS 2001 Front St. NE Suite 120 Salem, Oregon 97301 Phone (503) 586-0100 FAX (503) 589-9518	
OR99W: LOCKE CREEK BRIDGE REPLACEMENT PROJECT	
PACIFIC HIGHWAY WEST BENTON COUNTY	
Reviewed By - Randy G. Hinderer Designed By - Chee Yeun Lay Drafted By - Ryan Berger	
GENERAL CONSTRUCTION	SHEET NO. 3A



END ROAD CONST. ONLY
STA. "A" 348+29.70

"A" 350+00

+03.00
+51.00
"A" 345+00

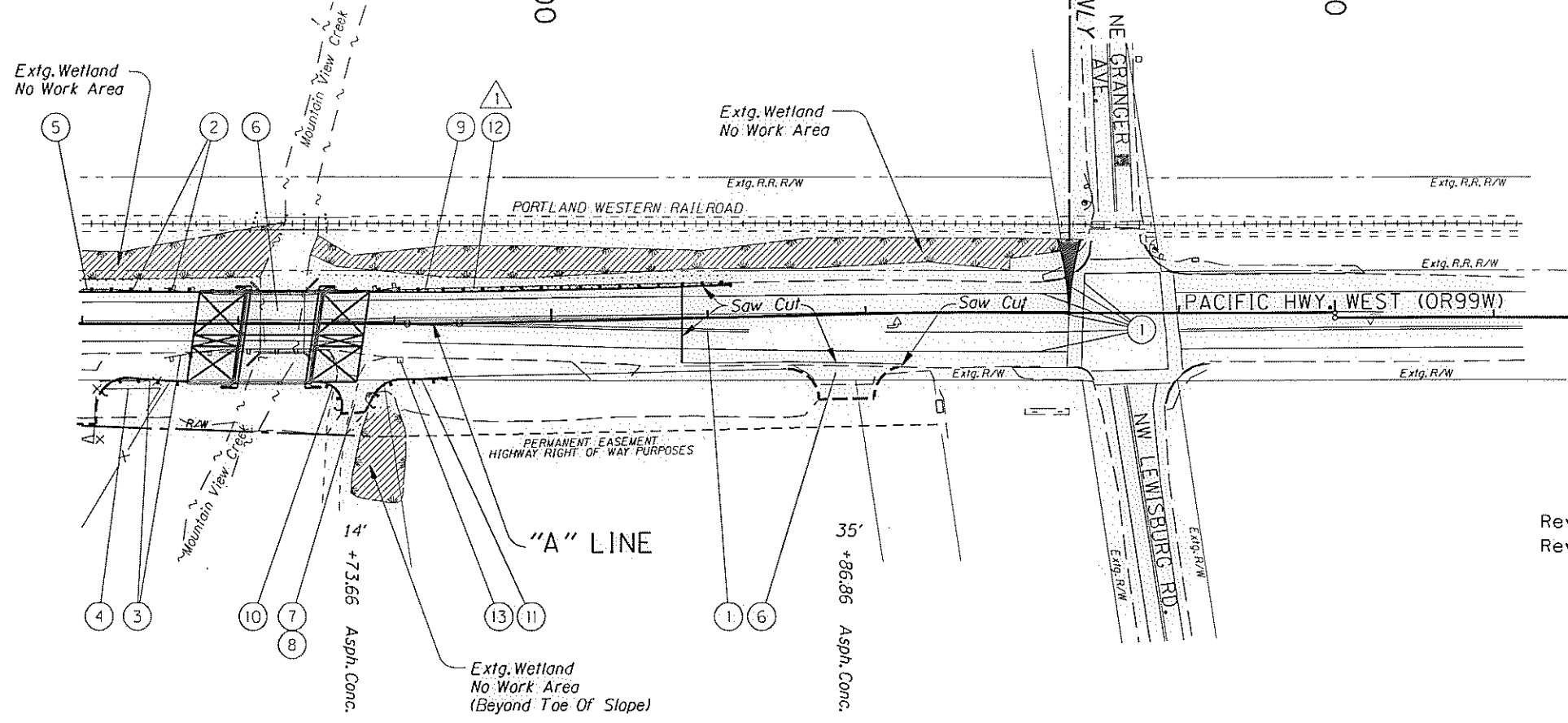

- ① See Note 2, Sht. 3A.
- ② See Note 4, Sht. 3A.
- ③ See Note 5, Sht. 3A.
- ④ See Note 6, Sht. 3A.
- ⑤ See Note 7, Sht. 3A.
- ⑥ Bridge No. 20799
Remove Extg. Bridge
Construct Structure - 107.3'
Rdwy. Width 60' With 0' Walk
And Reinf. Panel At Bridge Ends
(For Details, See Bridge Plans)
- ⑦ Construct Type "A-1" Roadway Approach - 2
- ⑧ Reconstruct Extg. Dwy. Within Right Of Way Limits
(See Drg. RD715)
- ⑨ Sta. "A" 343+84.12, 20.0' Lt. To Sta. "A" 346+15.71, 21.2' Lt.
Construct Guardrail - 193.5' (Type 2A)
Construct Guardrail - 12.5' (Type 3)
Construct Guardrail Terminal, Non-Flare (Test Level 2) - 25'
Construct Guardrail To Conc. Bridge Rail Transition
- ⑩ Sta. "A" 343+45.72, 37.3' Rt. To Sta. "A" 343+66.76, 53.4' Rt.
Construct Guardrail - 12.5' (Type 4)
Install Type 1 Modified Anchor
Install Type B End Piece
Construct Guardrail To Conc. Bridge Rail Transition
(See Detail, Sht. 2B)
- ⑪ Sta. "A" 343+84.76, 50.1' Rt. To Sta. "A" 344+33.40, 35.4' Rt.
Construct Guardrail - 31' (Type 2A)
Construct Guardrail Terminal, Non-Flare (Test Level 2) - 25'
Install Type 1 Modified Anchor
Install Type B End Piece
- ⑫ Sta. "A" 343+84.00 To Sta. "A" 346+15.00, Lt.
Remove Extg. Surfacing - 66 Sq. Yds.
- ⑬ Sta. "A" 344+03.74, 27.1' Rt.
Relocate Existing Mail Box
Remove Existing Mail Box Support
Install New Mailbox Support
Contractor To Coordinate With United States Postal Service
For Relocation
(See Drg. RD100, RD101)

Revised 10-20-2009,
Revised Terminology, Note 12

REVISIONS	
⚠	Revised 10-20-2009 Addendum #1

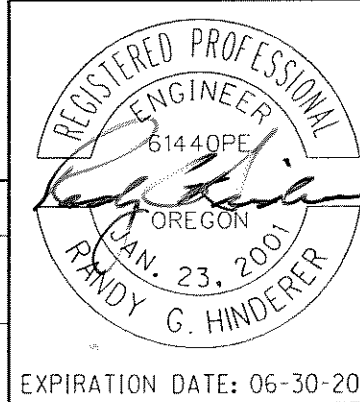

EXPIRATION DATE: 06-30-2011

OREGON DEPARTMENT OF TRANSPORTATION	
LOCHNER CONSULTING ENGINEERS AND PLANNERS 2001 Front St. NE Suite 120 Salem, Oregon 97301 Phone (503) 586-0100 FAX (503) 589-9538	
OR99W: LOCKE CREEK BRIDGE REPLACEMENT PROJECT	
PACIFIC HIGHWAY WEST BENTON COUNTY	
Reviewed By - Randy G. Hinderer Designed By - Chee Yeun Lay Drafted By - Ryan Berger	
GENERAL CONSTRUCTION	SHEET NO. 4A

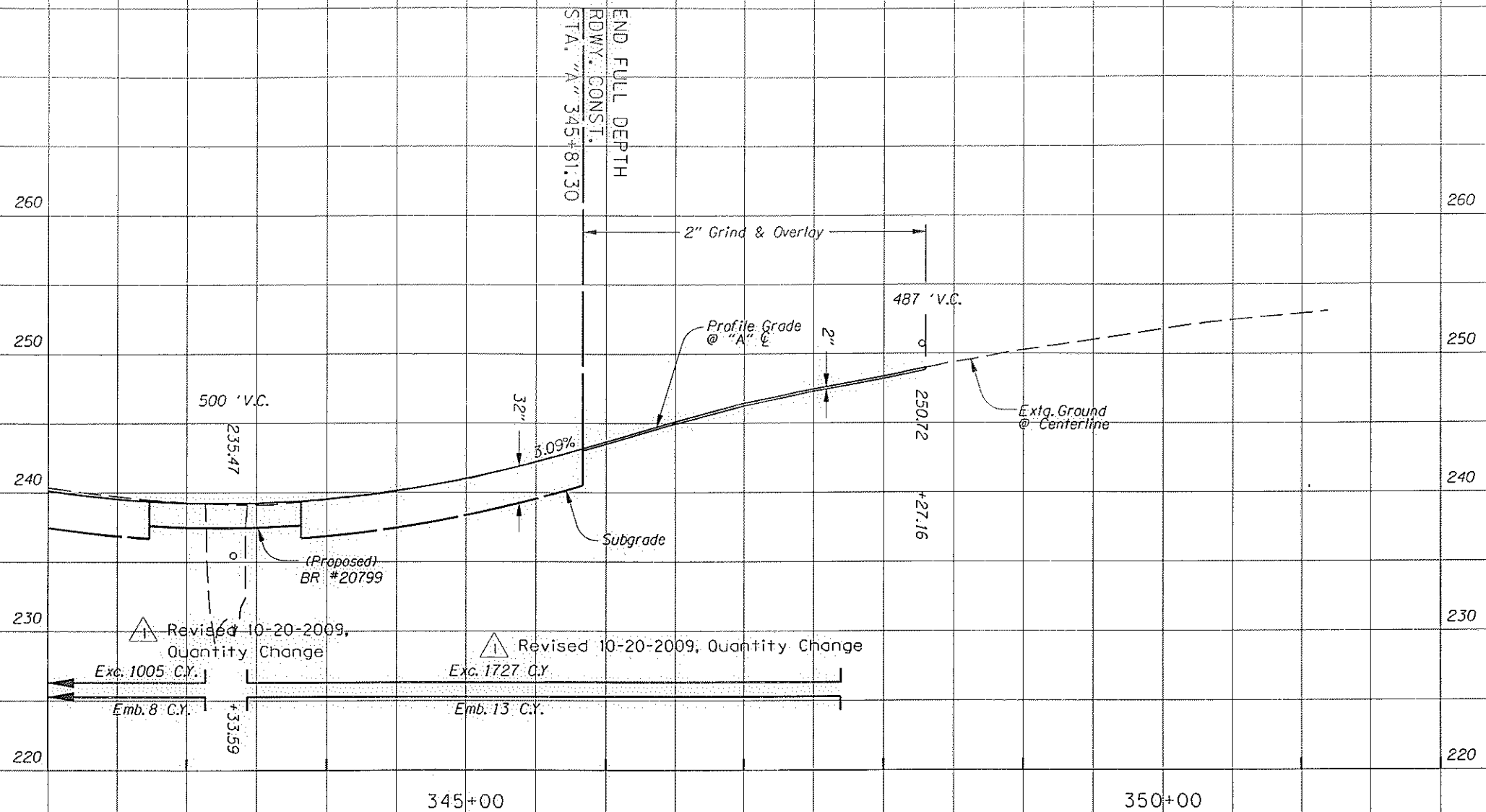

REVISIONS	
△	Revised 10-20-2009 Addendum #1

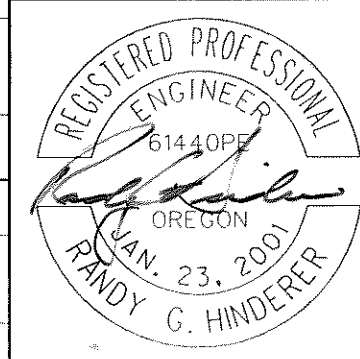

OREGON DEPARTMENT OF TRANSPORTATION

LOCHNER
CONSULTING ENGINEERS AND PLANNERS
2001 Front St. NE Suite 120 Salem, Oregon 97301
Phone (503) 586-0100 FAX (503) 586-9538

OR99W: LOCKE CREEK BRIDGE REPLACEMENT PROJECT

PACIFIC HIGHWAY WEST
BENTON COUNTY

Reviewed By - Randy G. Hinderer
Designed By - Chee Yuen Lay
Drafted By - Ryan Berger

PROFILE

SHEET NO.
4C